



# APPLICATION

## FOR PERCOLATION TESTING AND SITE EVALUATION

TEST DATE(S) \_\_\_\_\_ TEST TIME \_\_\_\_\_ APP 521599

AGENCY REVIEW: \_\_\_\_\_ DATE 12/1/04

DO NOT WRITE ABOVE THIS LINE

I HEREBY APPLY FOR THE NECESSARY TESTING/EVALUATION PRIOR TO ISSUANCE OF SEWAGE DISPOSAL SYSTEM PERMIT(S) TO:

CHECK AS NEEDED:

- CONSTRUCT NEW SEPTIC SYSTEM(S)
- REPAIR/ADD TO AN EXISTING SEPTIC SYSTEM
- REPLACE AN EXISTING SEPTIC SYSTEM

CHECK AS NEEDED:

- NEW STRUCTURE(S)
- ADDITION TO AN EXISTING STRUCTURE
- REPLACE AN EXISTING STRUCTURE

CHECK ONE:

- CREATE NEW LOT(S)
- BUILD ON AN EXISTING LOT IN A SUBDIVISION
- BUILD ON AN EXISTING PARCEL OF RECORD

IS THE PROPERTY WITHIN 2500' OF ANY RESERVOIR?

- YES
- NO

THE TYPE OF STRUCTURE IS:

- RESIDENTIAL WITH \_\_\_\_\_ PROPOSED BEDROOMS IN THE COMPLETED STRUCTURE (NOTE **UNKNOWN** IF APPROPRIATE)
- COMMERCIAL (PROVIDE DETAIL OF NUMBERS AND TYPES OF EMPLOYEES/ CUSTOMERS ON ACCOMPANYING PLAN)
- INSTITUTIONAL/GOVERNMENT (PROVIDE DETAIL OF NUMBERS AND TYPES OF EMPLOYEES/USERS ON ACCOMPANYING PLAN)

PROPERTY OWNER(S) Clements

DAYTIME PHONE \_\_\_\_\_ CELL \_\_\_\_\_ FAX \_\_\_\_\_

MAILING ADDRESS 12505 Indian Hill Drive Sykesville MD 21787  
STREET CITY/TOWN STATE ZIP

APPLICANT South Carroll Backhoe

DAYTIME PHONE 410-875-4197 CELL 410-596-3618 FAX 410-875-0326

MAILING ADDRESS 4410 Gaten Bottom Rd Westminster MD 21157  
STREET CITY/TOWN STATE ZIP

APPLICANT'S ROLE: DEVELOPER BUILDER BUYER RELATIVE/FRIEND REALTOR CONSULTANT

PROPERTY LOCATION  
SUBDIVISION/PROPERTY NAME \_\_\_\_\_ LOT NO. \_\_\_\_\_

PROPERTY ADDRESS 12505 Indian Hill Drive  
STREET TOWN/POST OFFICE

TAX MAP PAGE(S) \_\_\_\_\_ GRID \_\_\_\_\_ PARCEL(S) \_\_\_\_\_ PROPOSED LOT SIZE \_\_\_\_\_

AS APPLICANT, I UNDERSTAND THE FOLLOWING: THE SYSTEM INSTALLED SUBSEQUENT TO THIS APPLICATION IS ACCEPTABLE ONLY UNTIL PUBLIC SEWERAGE IS AVAILABLE. THIS APPLICATION IS COMPLETE WHEN ALL APPLICABLE FEES AND A SUITABLE SITE PLAN HAVE BEEN RECEIVED. I ACCEPT THE RESPONSIBILITY FOR COMPLIANCE WITH ALL M.O.S.H.A. AND "MISS UTILITY" REQUIREMENTS. APPROVAL IS BASED UPON SATISFACTORY REVIEW OF A PERC CERTIFICATION PLAN.

TEST RESULTS WILL BE MAILED TO APPLICANT. [Signature]  
SIGNATURE OF APPLICANT

HOWARD COUNTY HEALTH DEPARTMENT, BUREAU OF ENVIRONMENTAL HEALTH, WELL AND SEPTIC PROGRAM  
3525-H ELLICOTT MILLS DRIVE, ELLICOTT CITY, MARYLAND 21043-4544 (410) 313-1771 FAX (410) 313-2648  
TDD (410) 313-2323 TOLL FREE 1-877-4MD-DHMH

A/P (A)

4'-6' Br Cl Loam Trace Rock

9.5' Red Br Si Cl Loam Trace Rock

12' Caving

Water

(B)

Br Cl Loam

~70% Shale

With Vertical

75' Water

(C)

3' Red Br Cl Loam Trace Rock

Or Br Si Loam

Massive Structure

Trace Rock

6' Hard Bottom

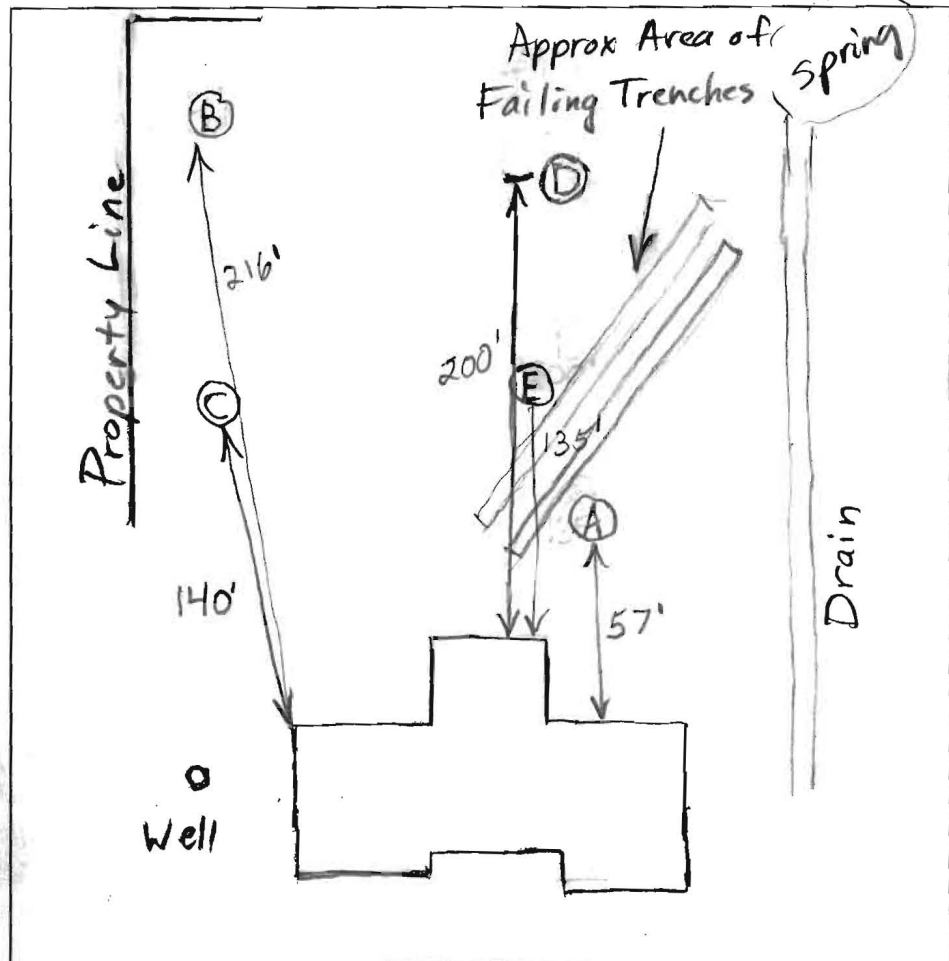

(D)

Red Br Cl Loam

Trace Rock

4.5' >50% Rock Hard Bottom

5'

(E)

Red Br Cl Loam Trace Rock

4'

Red Br Si Cl Loam Trace Rock

6' Caving

7.5' Water

(F)

1' Topsoil

Br Si Cl Loam Granular Structure

~10% Rock

5'

>50% Rock

6' Caving

7' Water

Indian Hill Drive

DATE	TEST #	DEPTH	START	BREAK	STOP	TIME OF	P/F/H
2/15/04	A	15.5' V		1" DROP	2" DROP	2nd INCH	
	B	7.5' V					
	C	3.5' / 6' V	11:23	~1/16" in 15 Minutes			
	D	5' V					
	E	7.5' V					
2/16/04	F	2' / 7' V	10:17:30	10:30	10:30	10:45	15

REMARKS \_\_\_\_\_

SANITARIAN B. Baker BACKHOE \_\_\_\_\_ OTHERS \_\_\_\_\_

TEST HOLES USED IN SDA \_\_\_\_\_ AVG. PERC TIME \_\_\_\_\_ SQ. FT/BR \_\_\_\_\_

TRENCH WIDTH \_\_\_\_\_ INLET DEPTH \_\_\_\_\_ MAX. BOT DEPTH \_\_\_\_\_ EFFECTIVE SW \_\_\_\_\_

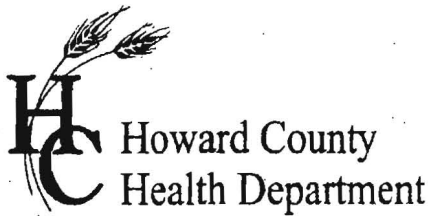

"RIR"

# APPLICATION

## FOR PERCOLATION TESTING AND SITE EVALUATION

TEST DATE(S) \_\_\_\_\_ TEST TIME \_\_\_\_\_ @P 521599

AGENCY REVIEW: \_\_\_\_\_ DATE \_\_\_\_\_

DO NOT WRITE ABOVE THIS LINE

I HEREBY APPLY FOR THE NECESSARY TESTING/EVALUATION PRIOR TO ISSUANCE OF SEWAGE DISPOSAL SYSTEM PERMIT(S) TO:

CHECK AS NEEDED:

- CONSTRUCT NEW SEPTIC SYSTEM(S)
- REPAIR/ADD TO AN EXISTING SEPTIC SYSTEM
- REPLACE AN EXISTING SEPTIC SYSTEM

CHECK AS NEEDED:

- NEW STRUCTURE(S)
- ADDITION TO AN EXISTING STRUCTURE
- REPLACE AN EXISTING STRUCTURE

CHECK ONE:

- CREATE NEW LOT(S)
- BUILD ON AN EXISTING LOT IN A SUBDIVISION
- BUILD ON AN EXISTING PARCEL OF RECORD

IS THE PROPERTY WITHIN 2500' OF ANY RESERVOIR?

- YES
- NO

THE TYPE OF STRUCTURE IS:

- RESIDENTIAL WITH \_\_\_\_\_ PROPOSED BEDROOMS IN THE COMPLETED STRUCTURE (NOTE **UNKNOWN** IF APPROPRIATE)
- COMMERCIAL (PROVIDE DETAIL OF NUMBERS AND TYPES OF EMPLOYEES/ CUSTOMERS ON ACCOMPANYING PLAN)
- INSTITUTIONAL/GOVERNMENT (PROVIDE DETAIL OF NUMBERS AND TYPES OF EMPLOYEES/USERS ON ACCOMPANYING PLAN)

PROPERTY OWNER(S) \_\_\_\_\_

DAYTIME PHONE 12505 India CELL \_\_\_\_\_ FAX \_\_\_\_\_

MAILING ADDRESS 12505 Indian Hill Drive  
STREET CITY/TOWN STATE ZIP

APPLICANT \_\_\_\_\_

DAYTIME PHONE \_\_\_\_\_ CELL \_\_\_\_\_ FAX \_\_\_\_\_

MAILING ADDRESS \_\_\_\_\_  
STREET CITY/TOWN STATE ZIP

APPLICANT'S ROLE: DEVELOPER BUILDER BUYER RELATIVE/FRIEND REALTOR CONSULTANT

PROPERTY LOCATION  
SUBDIVISION/PROPERTY NAME \_\_\_\_\_ LOT NO. \_\_\_\_\_

PROPERTY ADDRESS \_\_\_\_\_  
STREET TOWN/POST OFFICE

TAX MAP PAGE(S) \_\_\_\_\_ GRID \_\_\_\_\_ PARCEL(S) \_\_\_\_\_ PROPOSED LOT SIZE \_\_\_\_\_

AS APPLICANT, I UNDERSTAND THE FOLLOWING: THE SYSTEM INSTALLED SUBSEQUENT TO THIS APPLICATION IS ACCEPTABLE ONLY UNTIL PUBLIC SEWERAGE IS AVAILABLE. THIS APPLICATION IS COMPLETE WHEN ALL APPLICABLE FEES AND A SUITABLE SITE PLAN HAVE BEEN RECEIVED. I ACCEPT THE RESPONSIBILITY FOR COMPLIANCE WITH ALL M.O.S.H.A. AND "MISS UTILITY" REQUIREMENTS. APPROVAL IS BASED UPON SATISFACTORY REVIEW OF A PERC CERTIFICATION PLAN.

TEST RESULTS WILL BE MAILED TO APPLICANT. \_\_\_\_\_  
SIGNATURE OF APPLICANT

HOWARD COUNTY HEALTH DEPARTMENT, BUREAU OF ENVIRONMENTAL HEALTH, WELL AND SEPTIC PROGRAM  
3525-H ELLICOTT MILLS DRIVE, ELLICOTT CITY, MARYLAND 21043-4544 (410) 313-1771 FAX (410) 313-2648  
TDD (410) 313-2323 TOLL FREE 1-877-4MD-DHMH

AP (G)

Red Br Si  
Cl Loam  
Granular  
Structure  
~15%  
Rock ↓

4.5'

Water  
Seepage

8'

Water

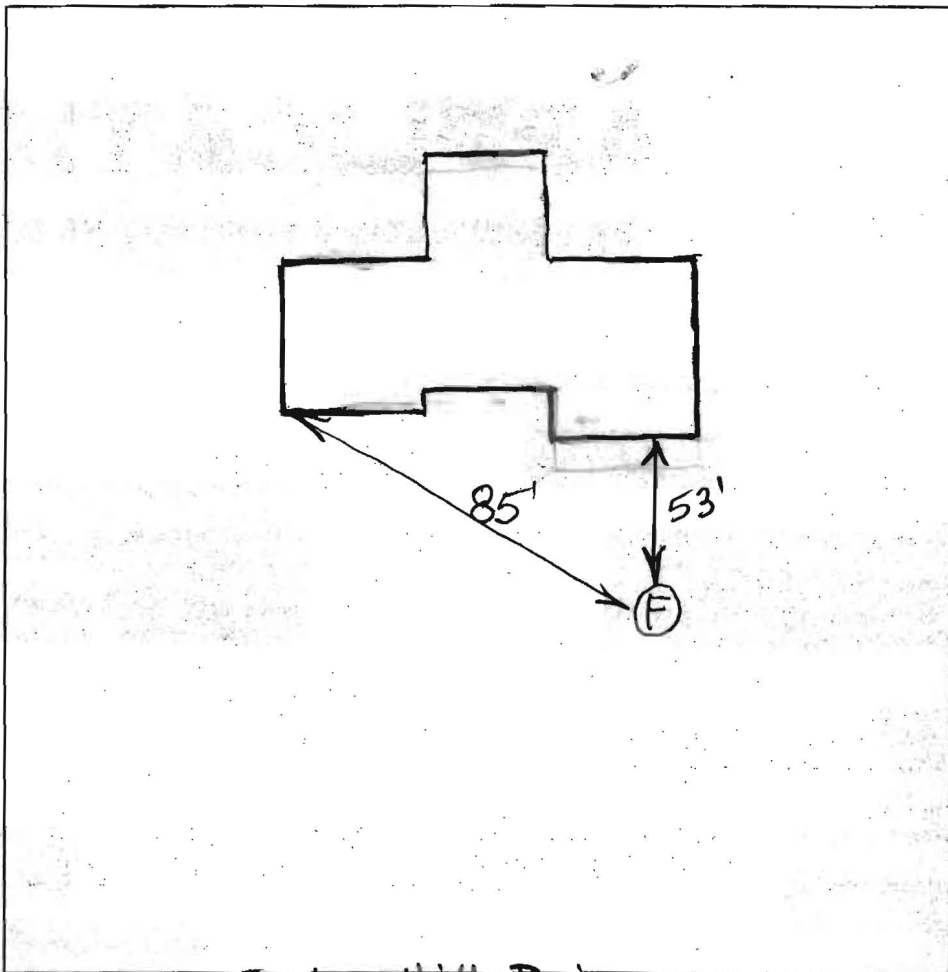

Indian Hill Drive

DATE	TEST #	DEPTH	START	BREAK 1" DROP	STOP 2" DROP	TIME OF 2nd INCH	P/F/H
12/16/04	G	2' 8" V	10:43	10:45	10:53	8	

REMARKS \_\_\_\_\_

SANITARIAN B. Baker BACKHOE \_\_\_\_\_ OTHERS \_\_\_\_\_

TEST HOLES USED IN SDA \_\_\_\_\_ AVG. PERC TIME \_\_\_\_\_ SQ. FT/BR \_\_\_\_\_

TRENCH WIDTH \_\_\_\_\_ INLET DEPTH \_\_\_\_\_ MAX. BOT DEPTH \_\_\_\_\_ EFFECTIVE S/W \_\_\_\_\_

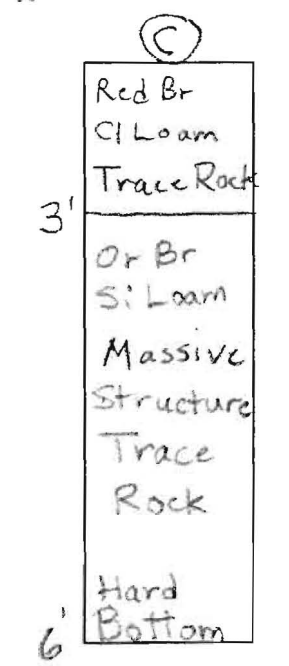
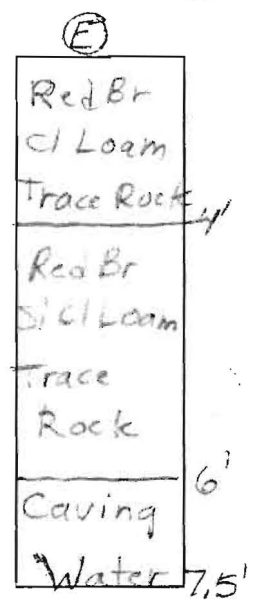
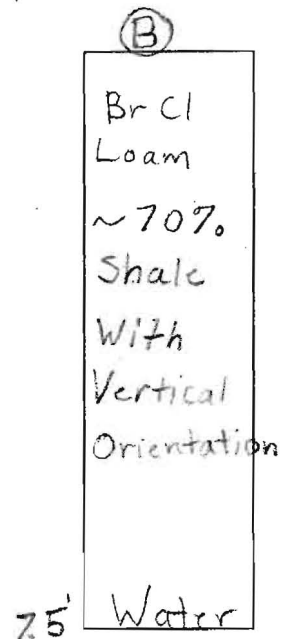
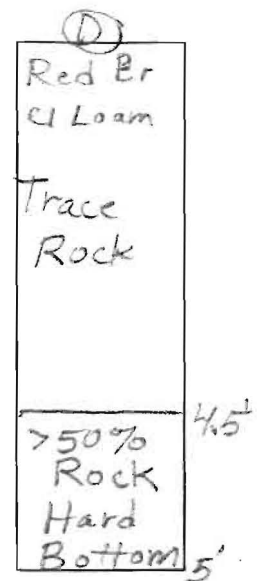
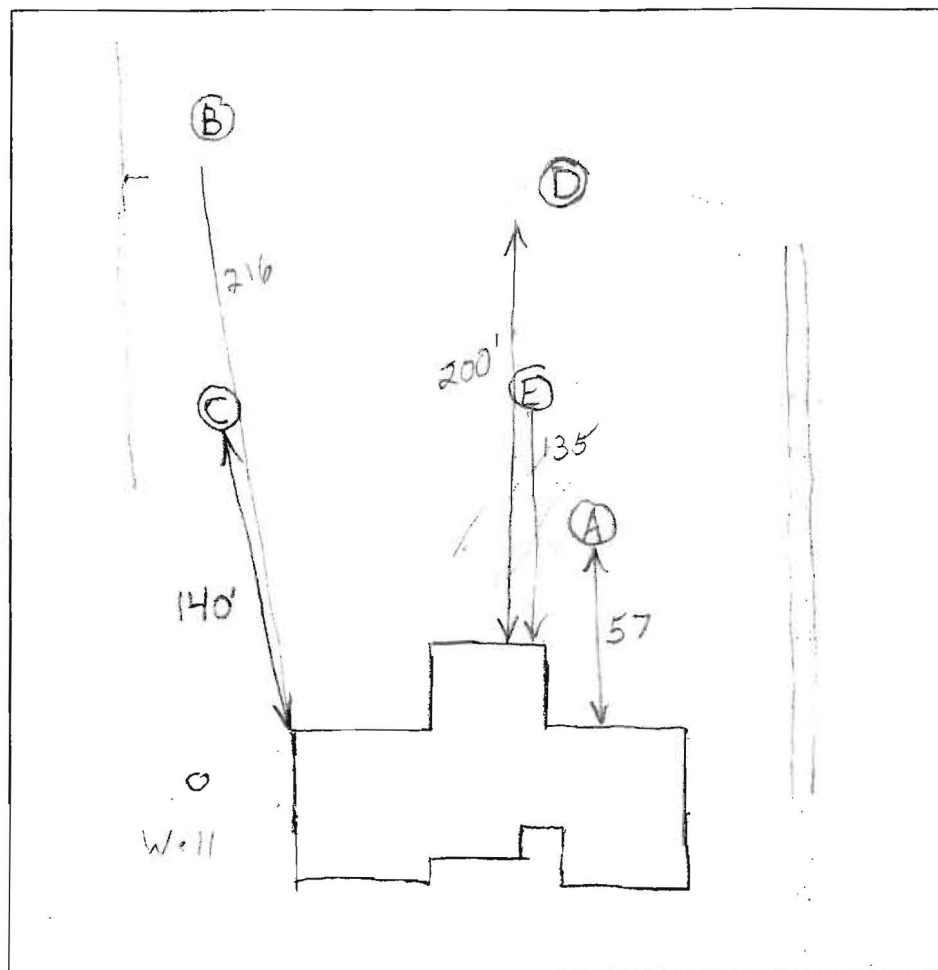
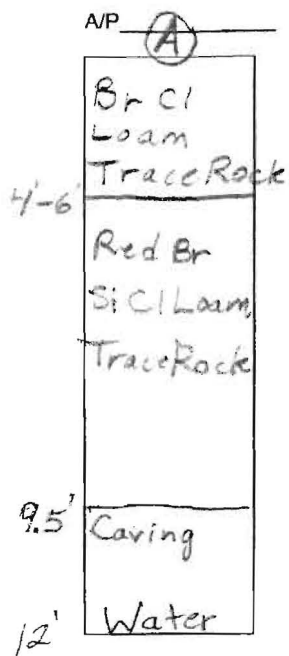

DATE	TEST #	DEPTH	START	BREAK 1" DROP	STOP 2" DROP	TIME OF 2nd INCH	P/F/H
12/15/04	A	15.5 V					
	B	7.5 V					
	C	3.5/6 V	11:23	~1/16" in 15 Minutes			
	D	5 V					
	E						

REMARKS \_\_\_\_\_

SANITARIAN \_\_\_\_\_ BACKHOE \_\_\_\_\_ OTHERS \_\_\_\_\_

TEST HOLES USED IN SDA \_\_\_\_\_ AVG. PERC TIME \_\_\_\_\_ SQ. FT/BR \_\_\_\_\_

TRENCH WIDTH \_\_\_\_\_ INLET DEPTH \_\_\_\_\_ MAX. BOT DEPTH \_\_\_\_\_ EFFECTIVE SW \_\_\_\_\_



Site Sketch

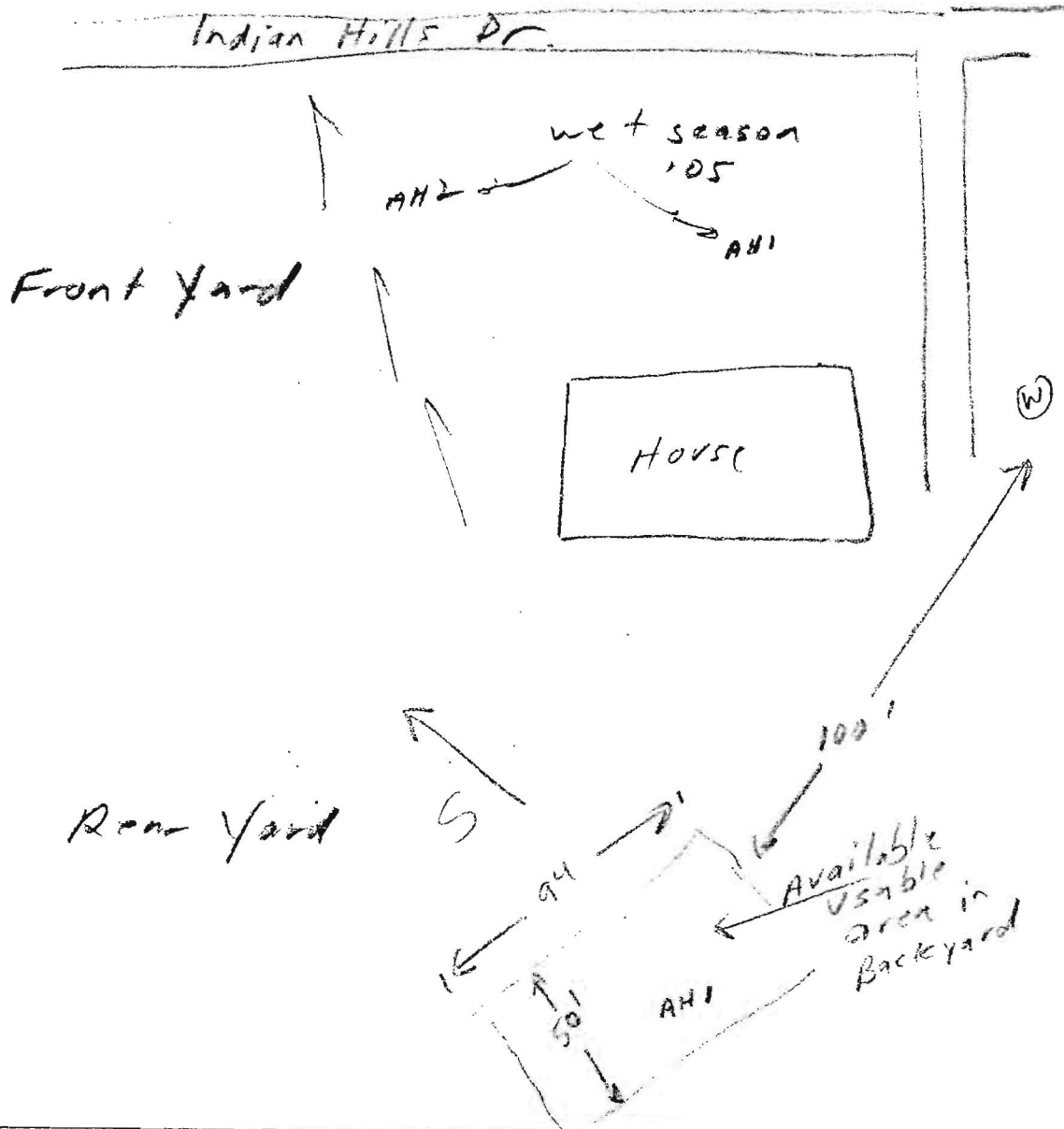

NAME: Thomas Clements

COUNTY: Howard

DATE: 2-05

**Notes: Show the following items:**

1. Property boundaries and dimensions.
2. Hand auger holes (AH), test pits (TP), boring (B) and tests (T).
3. Slope percent and direction.
4. Existing and proposed buildings, driveway, swimming pool, basements and right of ways on property.
5. Existing and proposed wells, septic systems, sewage disposal areas, ditches, water bodies and permanent stormwater control structures on property and within 150 feet of property lines.

Auger hole 1  
Front yard

Wet season '05

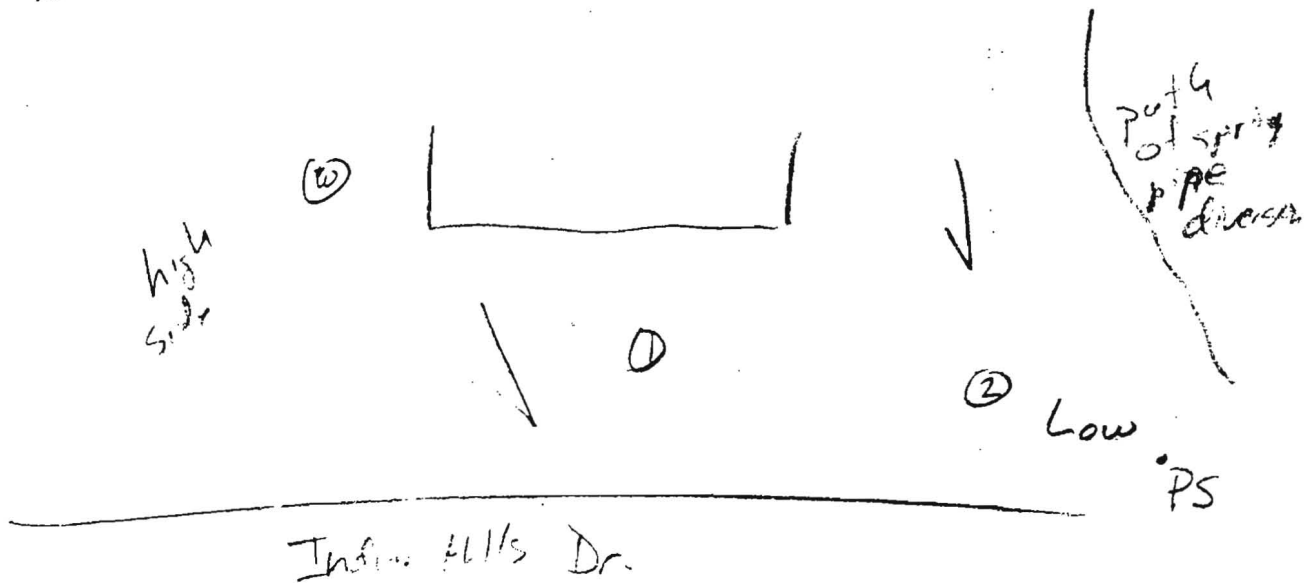
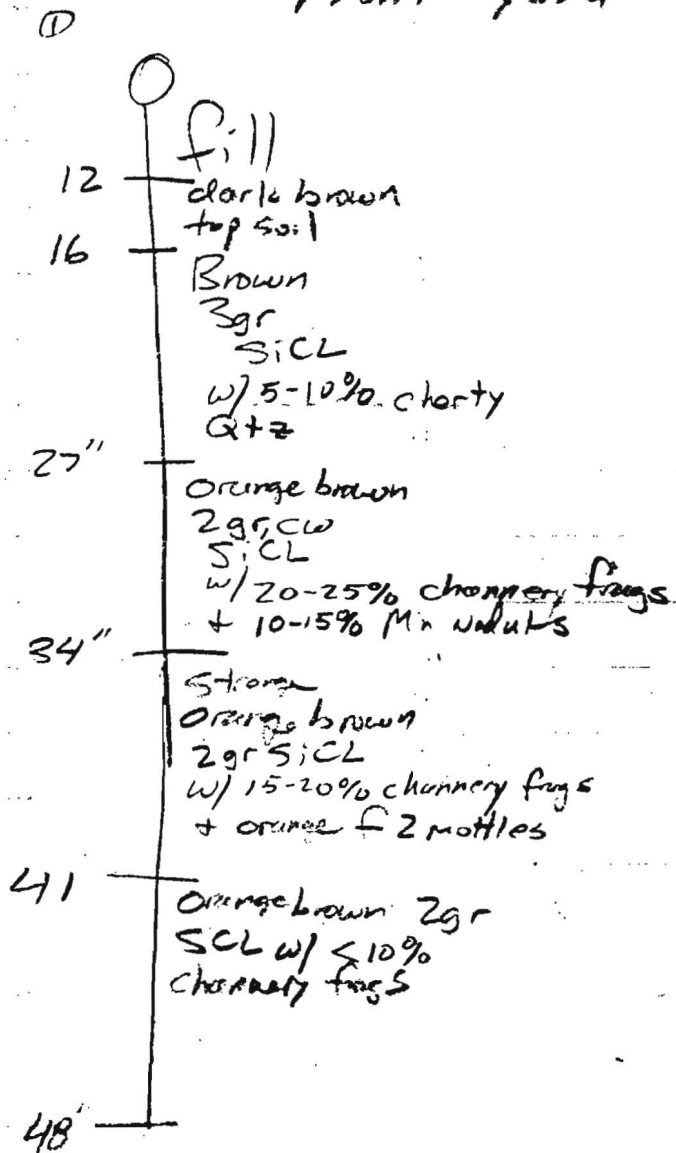

## Procedure for Proper Puraflo® Module Dosage (See Back of Page for Timer Diagram)

### Draw Down:

1. After checking the control panel to determine that it has been wired correctly, run the pump with the manual switch for approximately one minute to push a head of effluent (water) through the force main to the modules.
2. Measure the depth of water in the pump tank.  
*Example: Distance from mark to water = 38 inches.*
3. Using the second hand on your watch (or a stopwatch) run the pump with the manual switch for a timed 60 seconds.
4. Again, measure the depth of the water in the pump tank.  
*Example: Distance from mark to water = 40 inches. 2" of water was pumped in 60 seconds.*
5. Determine the volume of water drawn from the tank by multiplying the tank volume per inch times the inches of water drawn from the tank.

*Example: 1000 gal tank = 20 gal. per inch (provided by manufacturer of tank)  
x 2 inches of fluid drawn from tank  
40 gallons of fluid drawn from tank*

*Divide 60 seconds into the 40 gallons drawn from the tank.  $40 \div 60 = .6666$  or  $.67$  gallons of fluid per second (g/s) the pump is pushing to the modules. If the engineer/designer wants a dose of 10 gallons per module and this is a four module system. We need 40 gallons pushed to the modules at  $.67$  g/s. Divide  $.67$  gallon per second into 40 gallons to determine how many seconds the pump must run.  $40 \div .67 = 59.7$  seconds run. (Round to 60 seconds)*

*Second Example: The engineer/designer wants a dose of 9.5 gallons per module for a 6 module system. We need 57 gallon dose ( $6 \times 9.5$ ). Remember that the pump is pushing  $.67$  g/s.  $57 \text{ gal} \div .67 = 85$  seconds run time.*

### Setting the Timer:

1. The timer unit outer bezel green pointer (off) on the 2 on the timer dial. (Upper right hand window calibration on minutes for testing.)
2. Set the timer unit inner bezel red pointer (run) on the desired seconds run time. (Remember that each tick mark on the timer dial represents three (3) seconds.) (Lower right hand window calibration remains on minutes.)
3. Measure the water in the pump tank (record the measurement)
4. With all switches in the control panel in the Off position, turn the pump **SWITCH TO AUTOMATIC.**
5. Check the second hand of your watch, **THEN TURN THE 10 AMP AND 20 AMP BREAKERS ON THE** green light (off) will come on in the top left of the timer box. (This will indicate that the floats are wired correctly). Wait and the timer switch should automatically engage the pump after two minutes off time has elapsed.
6. The pump should run the exact number of seconds that are set on the timer dial.
7. When the pump switch automatically stops the pump, turn breakers and auto/manual switch to the off position in the breaker box.
8. Measure the water in the pump tank and record the measurement.
9. Use step #5 to determine whether the draw down and module dosage criteria has been achieved. Repeat this procedure, if necessary, to achieve the necessary draw down/module dosage.
10. **Remember!** Return the upper right side window of the timer unit to the Hrs. calibration (off time) before final system set up for operation.

This procedure written by James Wickham Smith for reference by installers 11-27-2002.

Questions? Call 1-804-725-3384

Auger hole 2

#2 Front yard

wet season  
'05

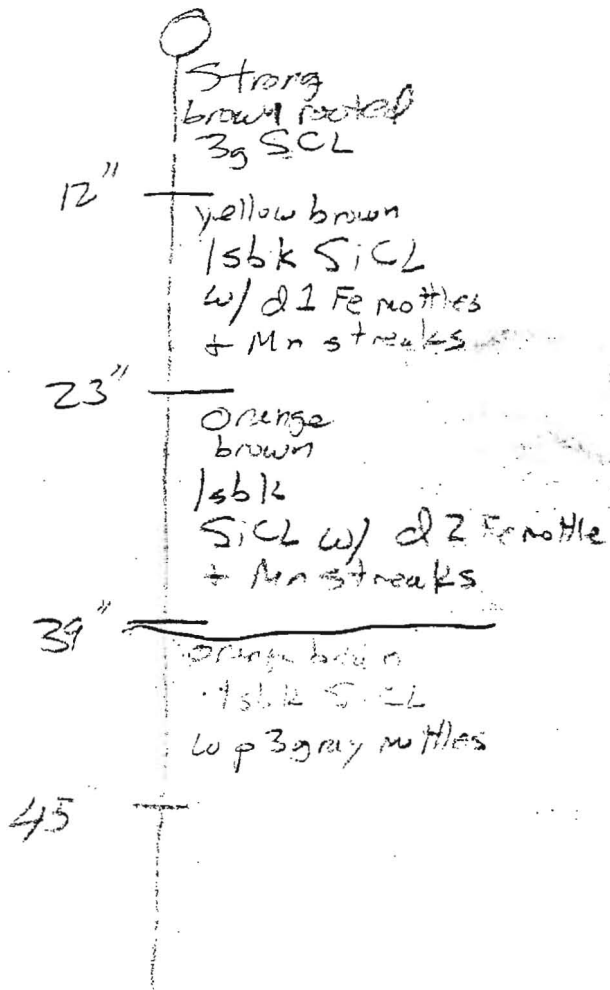

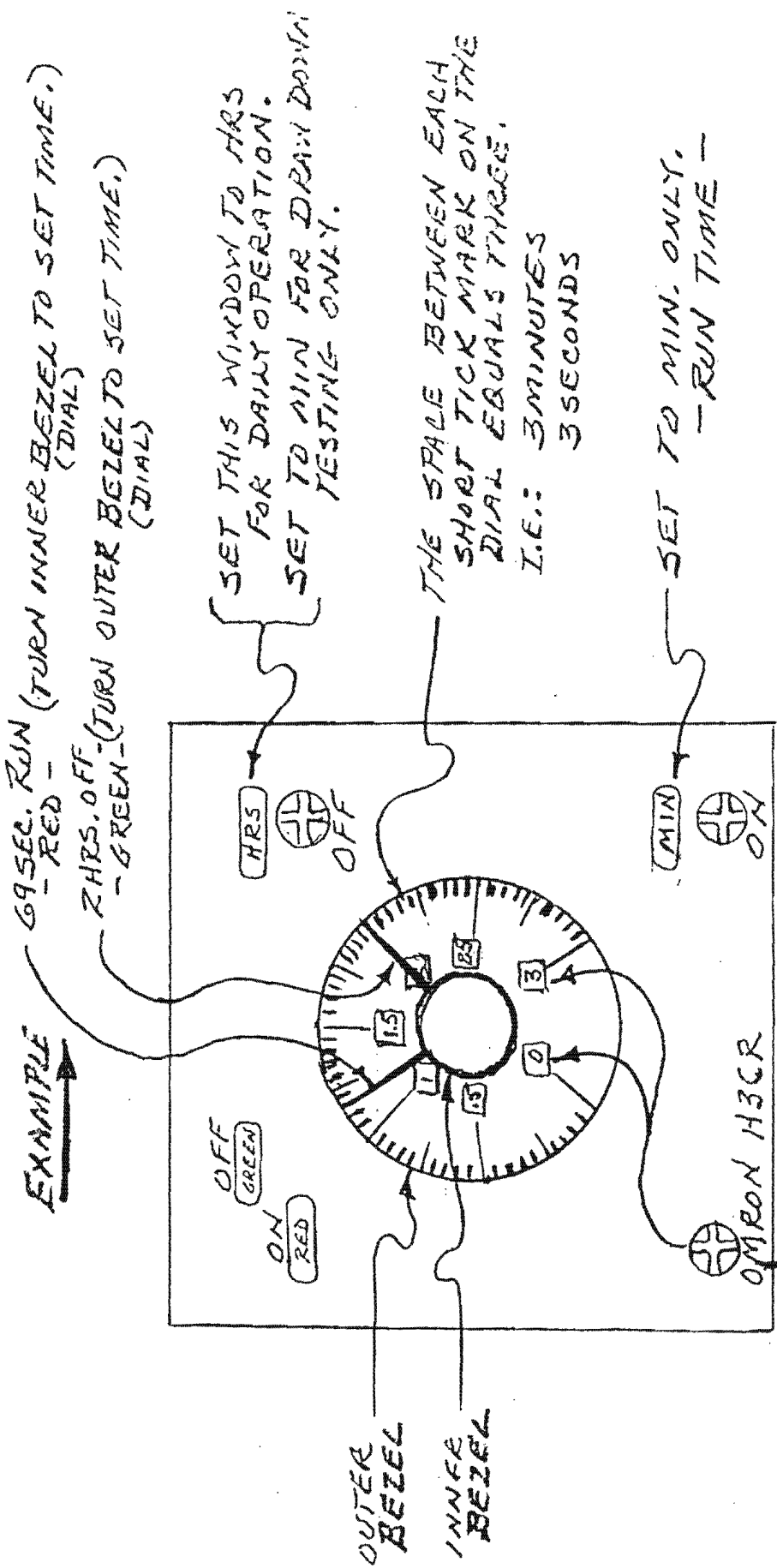

EXAMPLE →

69 SEC. RUN (TURN INNER BEZEL TO SET TIME.)  
- RED - (DIAL)

2 HRS. OFF. (TURN OUTER BEZEL TO SET TIME.)  
- GREEN - (DIAL)

SET THIS WINDOW TO HRS FOR DAILY OPERATION.  
SET TO MIN FOR DRAW DOWN TESTING ONLY.

THE SPACE BETWEEN EACH SHORT TICK MARK ON THE DIAL EQUALS THREE. I.E.: 3 MINUTES 3 SECONDS

SET TO MIN. ONLY. - RUN TIME -

TURN CALIBRATION SCREEN UNTIL 0 - 3 APPEARS IN WINDOWS ON DIAL PLATE

# TURFLO DRAWDOWN WORKSHEET FOR \_\_\_\_\_

DRAW # **5** **START POSITION ON WATCH DIAL.**  
 TO = \_\_\_\_\_ " FOR COUNTY \_\_\_\_\_  
 FROM = \_\_\_\_\_ " # **6** R. DESIRED DOSE \_\_\_\_\_ ÷ \_\_\_\_\_ PUMP FLOW = \_\_\_\_\_ SEC. RUN  
 AMOUNT DRAWN = \_\_\_\_\_ " 1. ACTUAL DOSE \_\_\_\_\_ ÷ \_\_\_\_\_ SEC. RUN = \_\_\_\_\_ PUMP FLOW  
 TYPE: \_\_\_\_\_ OFF: \_\_\_\_\_ = SET RUN: \_\_\_\_\_ = SET  
 " : \_\_\_\_\_ = ACTUAL " : \_\_\_\_\_ = ACTUAL  
 TANK VOL./IN. = \_\_\_\_\_ GAL. DOSE

DRAW # **4** **START POSITION ON WATCH DIAL.**  
 TO = \_\_\_\_\_ " FOR \_\_\_\_\_ R. DESIRED DOSE \_\_\_\_\_ ÷ \_\_\_\_\_ PUMP FLOW = \_\_\_\_\_ SEC. RUN  
 FROM = \_\_\_\_\_ " # **5** 1. ACTUAL DOSE \_\_\_\_\_ ÷ \_\_\_\_\_ SEC. RUN = \_\_\_\_\_ PUMP FLOW  
 AMOUNT DRAWN = \_\_\_\_\_ " = \_\_\_\_\_ X \_\_\_\_\_ TANK VOL./IN. = \_\_\_\_\_ GAL. DOSE  
 TYPE: \_\_\_\_\_ OFF: \_\_\_\_\_ = SET RUN: \_\_\_\_\_ = SET  
 " : \_\_\_\_\_ = ACTUAL " : \_\_\_\_\_ = ACTUAL

DRAW # **3** **START POSITION ON WATCH DIAL.**  
 TO: \_\_\_\_\_ " FOR \_\_\_\_\_ R. DESIRED DOSE \_\_\_\_\_ ÷ \_\_\_\_\_ PUMP FLOW = \_\_\_\_\_ SEC. RUN  
 FROM = \_\_\_\_\_ " # **4** 1. ACTUAL DOSE \_\_\_\_\_ ÷ \_\_\_\_\_ SEC. RUN = \_\_\_\_\_ PUMP FLOW  
 AMOUNT DRAWN = \_\_\_\_\_ " = \_\_\_\_\_ X \_\_\_\_\_ TANK VOL./IN. = \_\_\_\_\_ GAL. DOSE  
 TYPE: \_\_\_\_\_ OFF: \_\_\_\_\_ = SET RUN: \_\_\_\_\_ = SET  
 " : \_\_\_\_\_ = ACTUAL " : \_\_\_\_\_ = ACTUAL

DRAW # **2** **START POSITION ON WATCH DIAL.**  
 TO: \_\_\_\_\_ " FOR \_\_\_\_\_ R. DESIRED DOSE \_\_\_\_\_ ÷ \_\_\_\_\_ PUMP FLOW = \_\_\_\_\_ SEC. RUN  
 FROM: \_\_\_\_\_ " # **3** 1. ACTUAL DOSE \_\_\_\_\_ ÷ \_\_\_\_\_ SEC. RUN = \_\_\_\_\_ PUMP FLOW  
 AMOUNT DRAWN = \_\_\_\_\_ " = \_\_\_\_\_ X \_\_\_\_\_ TANK VOL./IN. = \_\_\_\_\_ GAL. DOSE  
 TYPE: \_\_\_\_\_ OFF: \_\_\_\_\_ = SET RUN: \_\_\_\_\_ = SET  
 " : \_\_\_\_\_ = ACTUAL " : \_\_\_\_\_ = ACTUAL

DRAW # **1** **START POSITION ON WATCH DIAL.**  
 TO \_\_\_\_\_ " FOR \_\_\_\_\_ R. DESIRED DOSE \_\_\_\_\_ ÷ \_\_\_\_\_ PUMP FLOW = \_\_\_\_\_ SEC. RUN  
 FROM \_\_\_\_\_ " # **2** 1. ACTUAL DOSE \_\_\_\_\_ ÷ \_\_\_\_\_ SEC. RUN = \_\_\_\_\_ PUMP FLOW  
 AMOUNT DRAWN = \_\_\_\_\_ " = \_\_\_\_\_ X \_\_\_\_\_ TANK VOL./IN. = \_\_\_\_\_ GAL. DOSE  
 TYPE: \_\_\_\_\_ OFF: \_\_\_\_\_ = SET RUN: \_\_\_\_\_ = SET  
 " : \_\_\_\_\_ = ACTUAL " : \_\_\_\_\_ = ACTUAL

**NOTES:**  
 1. DOSE GAL. ÷ SEC. RUN = GAL. PUMP FLOW PER SEC.  
 2. DESIRED DOSE GAL. ÷ PUMP FLOW GAL. SEC. = SEC. RUN.

A = AUTOMATIC  
 M = MANUAL

PURAFLO DRAWDOWN WORKSHEET FOR \_\_\_\_\_

TO = \_\_\_\_\_ " FOR COUNTY \_\_\_\_\_

DRAW # (5) FROM = \_\_\_\_\_ " # (6) 2. DESIRED DOSE \_\_\_\_\_ ÷ \_\_\_\_\_ PUMP FLOW = \_\_\_\_\_ SEC. RUN = \_\_\_\_\_ PUMP FLOW

AMOUNT DRAWN = \_\_\_\_\_ " 1. ACTUAL DOSE \_\_\_\_\_ ÷ \_\_\_\_\_ SEC. RUN = \_\_\_\_\_ PUMP FLOW

START POSITION ON WATCH DIAL. TYPE: \_\_\_\_\_ OFF: \_\_\_\_\_ = SET RUN: \_\_\_\_\_ = SET  
" : \_\_\_\_\_ = ACTUAL " : \_\_\_\_\_ = ACTUAL

TANK VOL./IN. = \_\_\_\_\_ GAL. DOSE

TO = \_\_\_\_\_ " FOR COUNTY \_\_\_\_\_

DRAW # (4) FROM = \_\_\_\_\_ " # (5) 2. DESIRED DOSE \_\_\_\_\_ ÷ \_\_\_\_\_ PUMP FLOW = \_\_\_\_\_ SEC. RUN = \_\_\_\_\_ PUMP FLOW

AMOUNT DRAWN = \_\_\_\_\_ " 1. ACTUAL DOSE \_\_\_\_\_ ÷ \_\_\_\_\_ SEC. RUN = \_\_\_\_\_ PUMP FLOW

START POSITION ON WATCH DIAL. TYPE: \_\_\_\_\_ OFF: \_\_\_\_\_ = SET RUN: \_\_\_\_\_ = SET  
" : \_\_\_\_\_ = ACTUAL " : \_\_\_\_\_ = ACTUAL

TANK VOL./IN. = \_\_\_\_\_ GAL. DOSE

TO: \_\_\_\_\_ " FOR COUNTY \_\_\_\_\_

DRAW # (3) FROM = \_\_\_\_\_ " # (4) 2. DESIRED DOSE \_\_\_\_\_ ÷ \_\_\_\_\_ PUMP FLOW = \_\_\_\_\_ SEC. RUN = \_\_\_\_\_ PUMP FLOW

AMOUNT DRAWN = \_\_\_\_\_ " 1. ACTUAL DOSE \_\_\_\_\_ ÷ \_\_\_\_\_ SEC. RUN = \_\_\_\_\_ PUMP FLOW

START POSITION ON WATCH DIAL. TYPE: \_\_\_\_\_ OFF: \_\_\_\_\_ = SET RUN: \_\_\_\_\_ = SET  
" : \_\_\_\_\_ = ACTUAL " : \_\_\_\_\_ = ACTUAL

TANK VOL./IN. = \_\_\_\_\_ GAL. DOSE

TO: \_\_\_\_\_ " FOR COUNTY \_\_\_\_\_

DRAW # (2) FROM = \_\_\_\_\_ " # (3) 2. DESIRED DOSE \_\_\_\_\_ ÷ \_\_\_\_\_ PUMP FLOW = \_\_\_\_\_ SEC. RUN = \_\_\_\_\_ PUMP FLOW

AMOUNT DRAWN = \_\_\_\_\_ " 1. ACTUAL DOSE \_\_\_\_\_ ÷ \_\_\_\_\_ SEC. RUN = \_\_\_\_\_ PUMP FLOW

START POSITION ON WATCH DIAL. TYPE: \_\_\_\_\_ OFF: \_\_\_\_\_ = SET RUN: \_\_\_\_\_ = SET  
" : \_\_\_\_\_ = ACTUAL " : \_\_\_\_\_ = ACTUAL

TANK VOL./IN. = \_\_\_\_\_ GAL. DOSE

TO \_\_\_\_\_ " FOR COUNTY \_\_\_\_\_

DRAW # (1) FROM \_\_\_\_\_ " # (2) 2. DESIRED DOSE \_\_\_\_\_ ÷ \_\_\_\_\_ PUMP FLOW = \_\_\_\_\_ SEC. RUN = \_\_\_\_\_ PUMP FLOW

AMOUNT DRAWN \_\_\_\_\_ " 1. ACTUAL DOSE \_\_\_\_\_ ÷ \_\_\_\_\_ SEC. RUN = \_\_\_\_\_ PUMP FLOW

START POSITION ON WATCH DIAL. TYPE: \_\_\_\_\_ OFF: \_\_\_\_\_ = SET RUN: \_\_\_\_\_ = SET  
" : \_\_\_\_\_ = ACTUAL " : \_\_\_\_\_ = ACTUAL

TANK VOL./IN. = \_\_\_\_\_ GAL. DOSE

NOTES: 1. DOSE GAL. ÷ SEC. RUN = GAL. PUMP FLOW PER SEC.  
A = AUTOMATIC 2. DESIRED DOSE GAL. ÷ PUMP FLOW GAL. SEC. = SEC. RUN.  
M = MANUAL

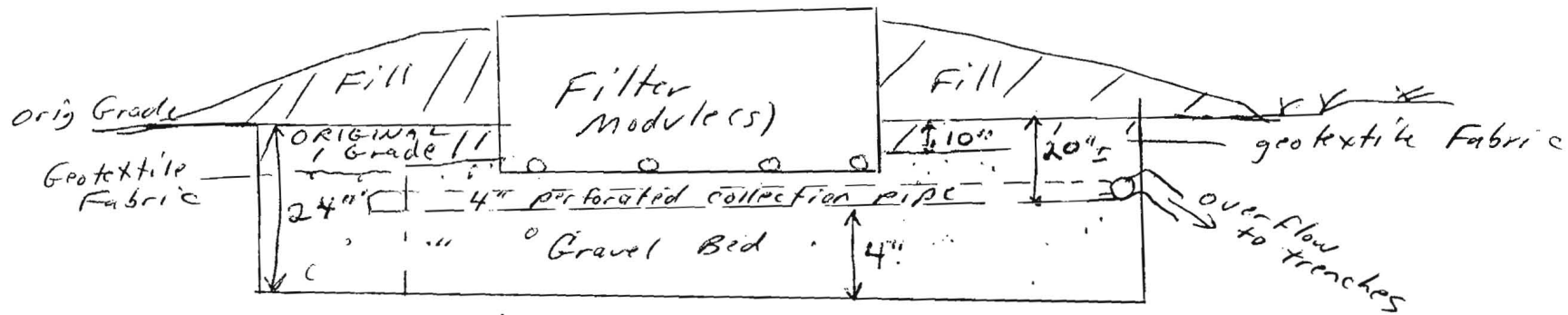

peat Filter Cross Section

SCALE	APPROVED BY: <i>Clements Property</i>	DRAWN BY
DATE		REVISED

DEPARTMENT OF THE ENVIRONMENT  
 201 WEST PRESTON STREET • BALTIMORE, MARYLAND 21201

DRAWING NUMBER