

MARYLAND DEPARTMENT OF THE ENVIRONMENT, WATER MANAGEMENT ADMINISTRATION
 1800 Washington Blvd., Baltimore, Maryland 21230 (410) 537-3784

 WATER WELL ABANDONMENT-SEALING REPORT FORM

SUBMIT COPIES OF COMPLETED FORM TO:

- * COUNTY ENVIRONMENT AGENCY (contact MDE, WMA if address needed)
- * WELL OWNER
- * MDE, WATER MANAGEMENT ADMINISTRATION, WELL PROGRAM

DATE WELL ABANDONED: 10/15/2007 (month/day/year)

* PERMIT NUMBER OF ABANDONED WELL (if any) _____

* PERMIT NUMBER OF REPLACEMENT WELL _____

* PERSON ABANDONING WELL: WESLEY WHITE

WELL DRILLERS LICENSE NUMBER: _____

CIRCLE: MWD/MSD/MGD

* OWNER'S NAME: _____

SITE LOCATION MAP

* WELL LOCATION:
 COUNTY: HOWARD
 NEAREST TOWN: CLARKSVILLE
 TAX MAP _____ BLOCK _____ PARCEL _____
 SUBDIVISION: _____
 SECTION: _____ LOT: _____
 NEAREST ROAD: SKUNK HILL TRAIL

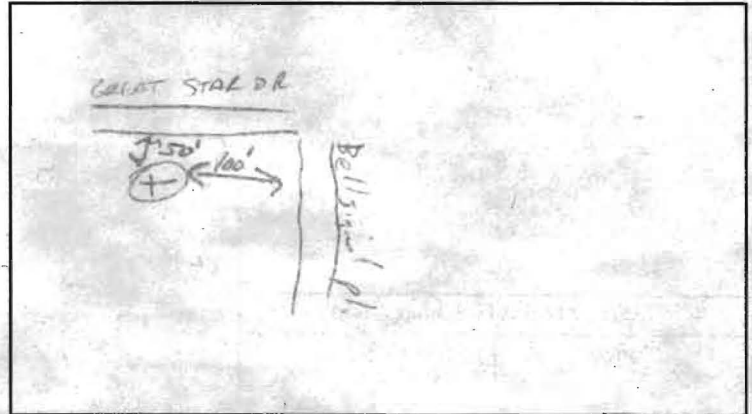

* TYPE OF WELL BEING ABANDONED:

- DRILLED JETTED
- BORED/AUGERED HAND DUG
- OTHER (specify) _____

* USE CODE:

- DOMESTIC MUNICIPAL/PUBLIC
- IRRIGATION INDUSTRIAL
- TEST/OBSERVATION GEOTHERMAL

* TYPE OF CASING:

- STEEL PLASTIC
- CONCRETE OTHER (specify) _____

* SIZE OF CASING: 4" INCHES IN DIAMETER

* DEPTH OF WELL: 35' FEET DEEP

* WAS ANY CASING REMOVED? YES NO
 if yes, length removed, in feet: 35'

* WAS CASING RIPPED OR PERFORATED? YES NO

LOG OF SEALING MATERIAL

MATERIAL	FEET	
	FROM	TO
Cement/bentonite grout mix	0	35'
VOLUME OF MATERIAL USED		

Samuel A. Connelly
 SIGNATURE-MASTER WELL DRILLER OR SUPERVISING SANITARIAN

MGD 108
 LICENSE #

MWD/MSD/MGD
 CIRCLE ONE

10/16/2007
 DATE