

APPLICATION

SEWAGE DISPOSAL TESTING

MARYLAND STATE DEPARTMENT OF HEALTH

A 11443

P _____

HOWARD COUNTY 1588

ELLICOTT CITY

DISTRICT 1

DATE 2/20/66

~~3 bedrooms - Septic Tank~~ 2 septic tanks

2 dry wells - Each 9 ft in dia. by 6 ft deep below the inlet pipe. Bottom of dry wells to be no deeper than 9 ft below original grade. First dry well to be located 190 ft from front lot line and 45 ft from left side lot line as seen when facing lot from Evergreen Way. Dry wells to be 40 ft apart measured at the

4 bedrooms - Septic Tank 1500 gallons
2 dry wells - Each 11 ft in dia by 6 feet deep below the inlet pipe located same as above with same restrictions

TO: THE COUNTY HEALTH OFFICER
ELLICOTT CITY, MARYLAND

I, HEREBY, APPLY FOR THE NECESSARY TESTS IN ORDER TO CONSTRUCT OR RECONSTRUCT A SEWAGE DISPOSAL SYSTEM.

PROPERTY OWNER Coxwell, Inc.

ADDRESS Chatham Rd., Ellicott City, MD PHONE HO 9-2677

PROPERTY LOCATION:

SUBDIVISION Green Henge LOT NO. 35, 888

ROAD AND DESCRIPTION COAST SYSTEMS WAY & URBAN ROAD

OCCUPANT _____ PHONE _____

PERSON TO CONSTRUCT SYSTEM _____

ADDRESS _____ PHONE _____

SIZE OF LOT 82' x 266' x 220' x 268' TYPE BLDG 3 AD

IF NOT SINGLE RESIDENCE DESCRIBE _____

SIGNATURE OF APPLICANT /s/ Carl C. Hall, President

APPROVED BY J. H. Kibrose FOR 2 dry wells DATE 2/20/66

REJECTED BY _____ FOR _____ DATE _____

HOLD PENDING FURTHER TESTS _____ DATE _____

REASONS FOR REJECTION OR HOLDING _____

THIS IS NOT A PERMIT

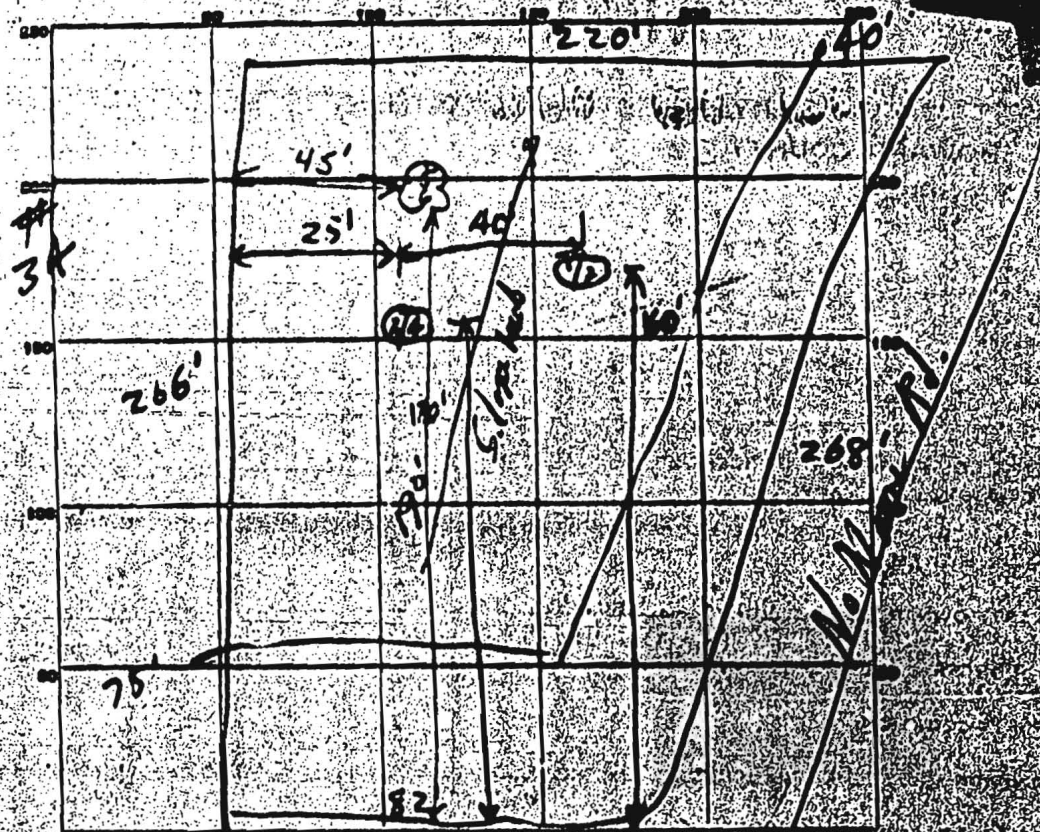

Emergency Way

DATE	TEST NO.	DEPTH	FEET - WET START	FEET - DRY END	TEST - 1" STOP START	TEST - 1" STOP STOP	TIME
6/21/66	1	9 ft.	221	2:22	2:22	2:24	2 min.
	2	5 ft.	2:20	2:22	2:22	2:24	2 min.
	3	1 1/2 ft.	2:26	2:28	2:28	2:31	3 min.
	4	8 1/2 ft.	2:26	2:40	2:40	Overrun 2nd hole	
6/24/66	5	8 ft.	10:38	10:42	10:42	10:52	10 min.
	6	4 ft.	10:40	10:43	10:43	10:47	4 min.

As shown
9 min
Darth hole
about 3'

SOIL AUGER FINDING: *Must dig down to 13 ft. or deeper - RF #35*
 TESTED BY: *6/29/66 JHK - no water at 10'*
 REMARKS: *(5, 6) hole must be dug to 13 or 14 ft. - JHK*
limit of backfill was 10'

LOT 35 SEC. 3 BLOCK C
CREE HENCE

222-36

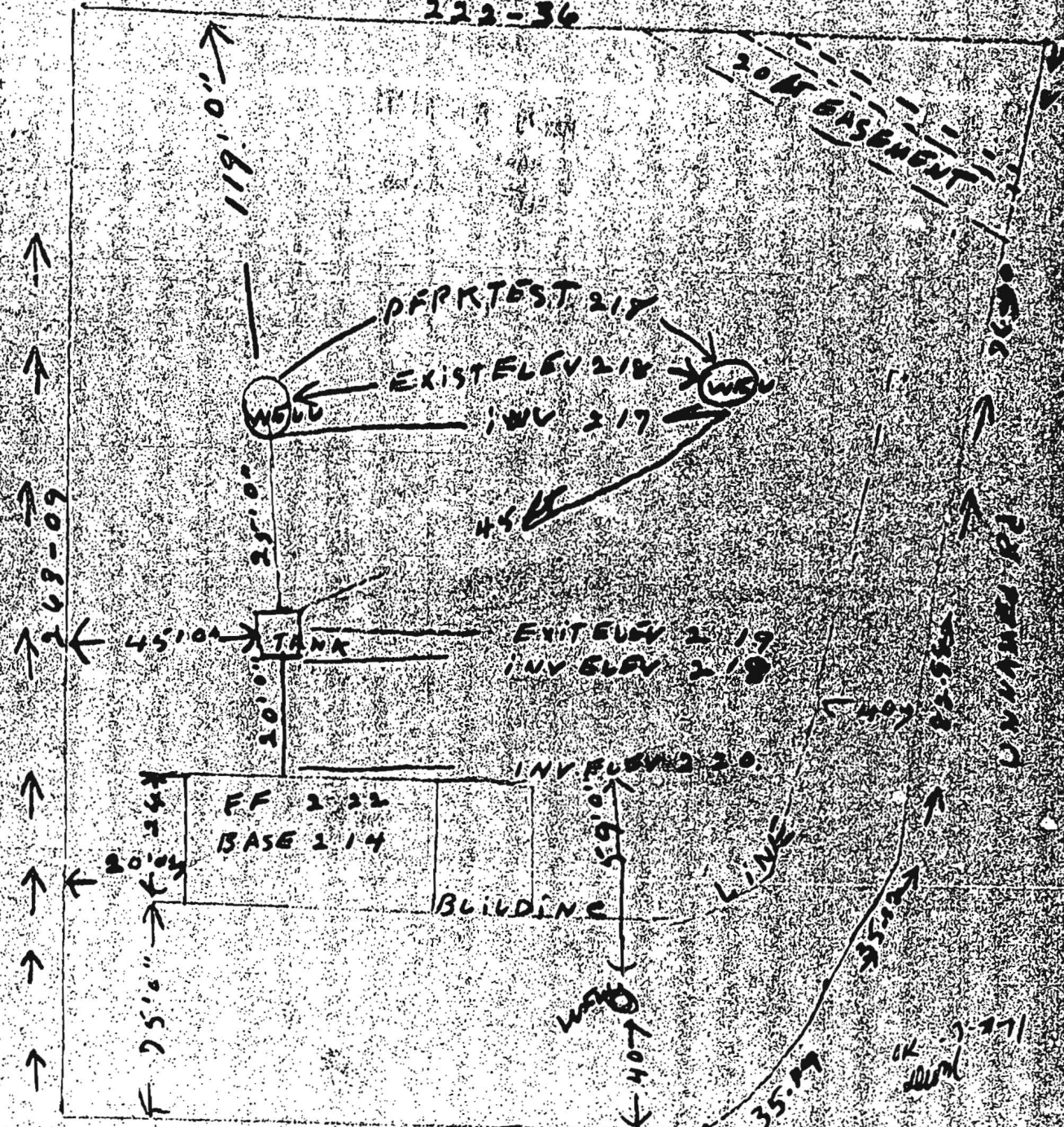

82'00
EVERCREENE RD

N E Byrd
409 W. ...
South ...

Water Levels Were Unusually High When Holes Were Dug

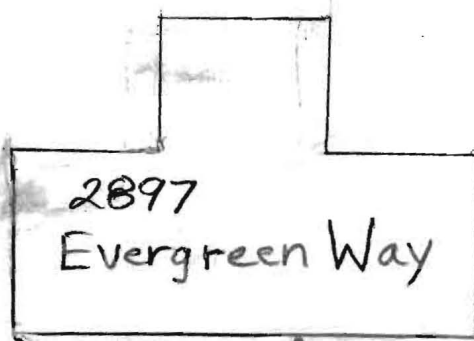

- (A) Br Sa Cl
Loam, Dense
2.5'-3'
- Brig and
Br Med
Loamy Sa
- 8' Water
- 9' Hard Bottom
- (B) Br Sa Cl
Loam, Fairly Dense
2.5'-3'
- Br Sa
Loam, Some
Clay
3.5'-4'
- Br Loamy
Sa
5-10%
Rock
- 7.5' Water
- 9' Seepage
- 9.5' Water

DATE	TEST #	DEPTH	START	BREAK 1" DROP	STOP 2" DROP	TIME OF 2ND INCH	P/F/H
5/22/2014	A	3.5' / 9'	11:47	11:48:30	11:51:30	3	
	B	2.5' / 7.5'	12:07:30	- Pulled, Slow			
		3.25	12:15	- Pulled, Some Movement			
		4'	12:24:30	12:30:45	12:43	17	

REMARKS Holes Dug Near New Trench Locations
 SANITARIAN B. Baker BACKHOE R. Heaps OTHERS _____
 TEST HOLES USED IN SDA _____ AVG. PERC TIME _____ SQ. FT/BR _____
 TRENCH WIDTH _____ INLET DEPTH _____ MAX. BOT DEPTH _____ EFFECTIVE S/W _____