

Temp ID# 03-297934



APPLICATION

FOR PERCOLATION TESTING AND SITE EVALUATION

TEST DATE(S) _____ TEST TIME _____

APP 523255

AGENCY REVIEW: _____

DATE 9/6/05

DO NOT WRITE ABOVE THIS LINE

I HEREBY APPLY FOR THE NECESSARY TESTING/EVALUATION PRIOR TO ISSUANCE OF SEWAGE DISPOSAL SYSTEM PERMIT(S) TO:

CHECK AS NEEDED:

- CONSTRUCT NEW SEPTIC SYSTEM(S)
- REPAIR/ADD TO AN EXISTING SEPTIC SYSTEM
- REPLACE AN EXISTING SEPTIC SYSTEM

CHECK AS NEEDED:

- NEW STRUCTURE(S)
- ADDITION TO AN EXISTING STRUCTURE
- REPLACE AN EXISTING STRUCTURE

CHECK ONE:

- CREATE NEW LOT(S)
- BUILD ON AN EXISTING LOT IN A SUBDIVISION
- BUILD ON AN EXISTING PARCEL OF RECORD

IS THE PROPERTY WITHIN 2500' OF ANY RESERVOIR?

- YES
- NO

THE TYPE OF STRUCTURE IS:

- RESIDENTIAL WITH _____ PROPOSED BEDROOMS IN THE COMPLETED STRUCTURE (NOTE UNKNOWN IF APPROPRIATE)
- COMMERCIAL (PROVIDE DETAIL OF NUMBERS AND TYPES OF EMPLOYEES/ CUSTOMERS ON ACCOMPANYING PLAN)
- INSTITUTIONAL/GOVERNMENT (PROVIDE DETAIL OF NUMBERS AND TYPES OF EMPLOYEES/USERS ON ACCOMPANYING PLAN)

PROPERTY OWNER(S) MR. Yang

DAYTIME PHONE 410 480 2648 CELL (571) 213-8430 FAX _____

MAILING ADDRESS 12765 FREDRICK RD WEST FRIENDSHIP MD 21704
STREET CITY/TOWN STATE ZIP

APPLICANT Fyock Septic Service

DAYTIME PHONE 410 988-9270 CELL 240-882-4025 FAX _____

MAILING ADDRESS PO Box 89 Glenelc md 21737
STREET CITY/TOWN STATE ZIP

APPLICANT'S ROLE: DEVELOPER BUILDER BUYER RELATIVE/FRIEND REALTOR CONSULTANT

PROPERTY LOCATION: SUBDIVISION/PROPERTY NAME 12765 Frederick Rd LOT NO. _____

PROPERTY ADDRESS Ellicott City
STREET TOWN/POST OFFICE

TAX MAP PAGE(S) _____ GRID _____ PARCEL(S) _____ PROPOSED LOT SIZE _____

AS APPLICANT, I UNDERSTAND THE FOLLOWING: THE SYSTEM INSTALLED SUBSEQUENT TO THIS APPLICATION IS ACCEPTABLE ONLY UNTIL PUBLIC SEWERAGE IS AVAILABLE. THIS APPLICATION IS COMPLETE WHEN ALL APPLICABLE FEES AND A SUITABLE SITE PLAN HAVE BEEN RECEIVED. I ACCEPT THE RESPONSIBILITY FOR COMPLIANCE WITH ALL M.O.S.H.A. AND "MISS UTILITY" REQUIREMENTS. APPROVAL IS BASED UPON SATISFACTORY REVIEW OF A PERC CERTIFICATION PLAN.

TEST RESULTS WILL BE MAILED TO APPLICANT. [Signature]
SIGNATURE OF APPLICANT

HOWARD COUNTY HEALTH DEPARTMENT, BUREAU OF ENVIRONMENTAL HEALTH, WELL AND SEPTIC PROGRAM
3525-H ELLICOTT MILLS DRIVE, ELLICOTT CITY, MARYLAND 21043-4544 (410) 313-1771 FAX (410) 313-2648
TDD (410) 313-2323 TOLL FREE 1-877-4MD-DHMH

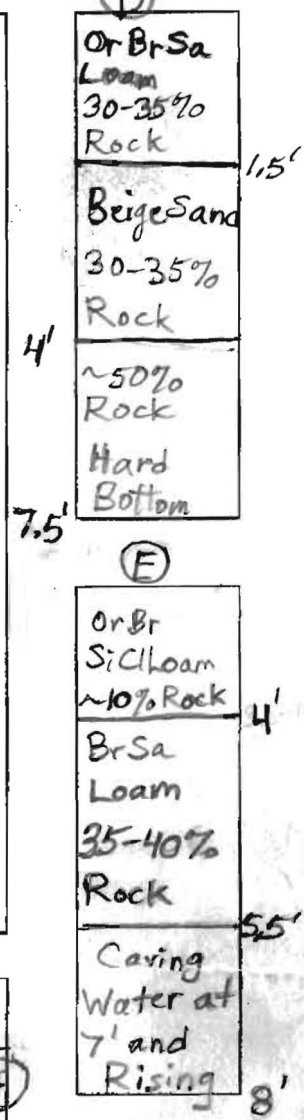
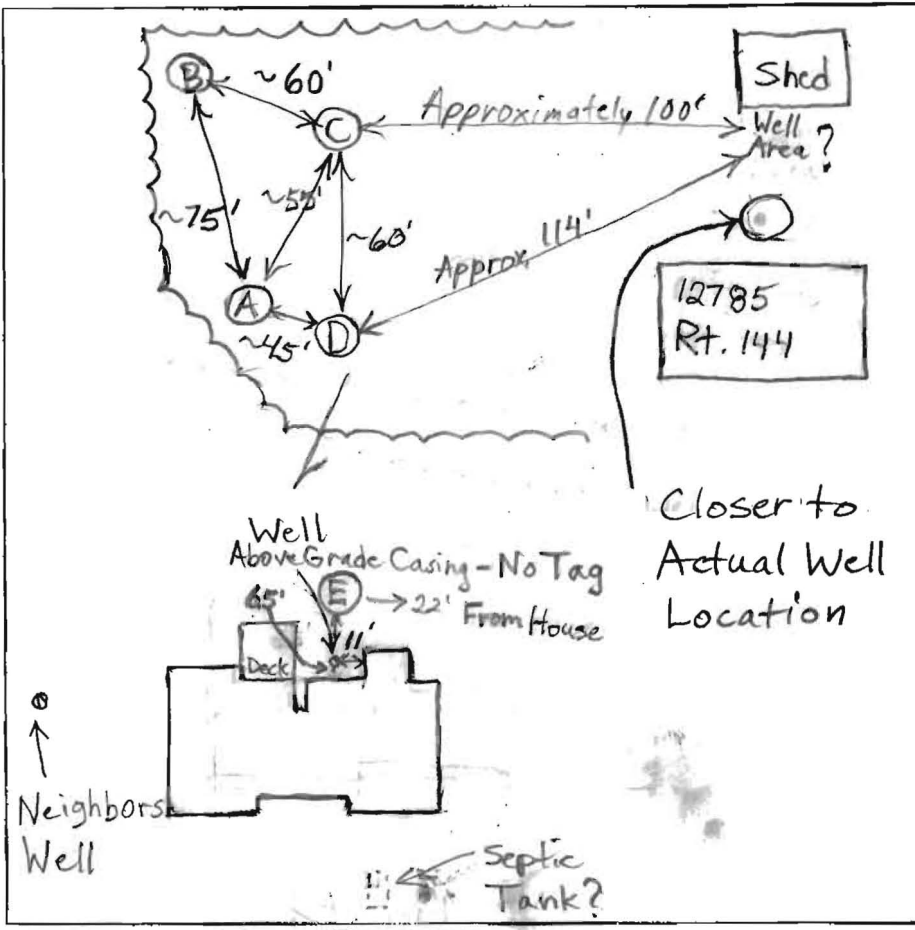
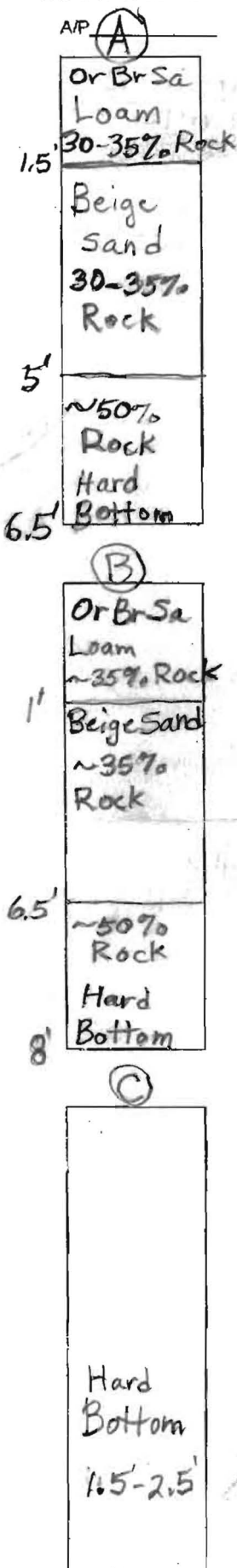

DATE	TEST #	DEPTH	START	BREAK 1" DROP	STOP 2" DROP	TIME OF 2nd INCH	P/F/H
9/9/05	A	2' / 6.5'				2nd inch → 30 seconds	(F)
	B	8' V					(F)
	C	15-2.5' V					(F)
	D	7.5' V					(F)
	E	4' / 8' V					(F)
Tested at Various Locations with a perc stick in top 1 1/2' of Soil - Slowest Rate was 11 minutes							

REMARKS Water Moved on Shelf at 4" in E
 SANITARIAN B. Baker BACKHOE Fyock OTHERS _____
 TEST HOLES USED IN SDA _____ AVG. PERC TIME _____ SQ. FT/BR _____
 TRENCH WIDTH _____ INLET DEPTH _____ MAX. BOT DEPTH _____ EFFECTIVE SW _____

AP (A)
 Or Br Sa Loam 30-35% Rock 1.5'
 Beige Sand 30-35% Rock 5'
 ~50% Rock Hard Bottom 6.5'
 (B)
 Or Br Sa Loam ~35% Rock 1'
 Beige Sand ~35% Rock 6.5'
 ~50% Rock Hard Bottom 8'
 (C)
 Hard Bottom 1.5-2.5'

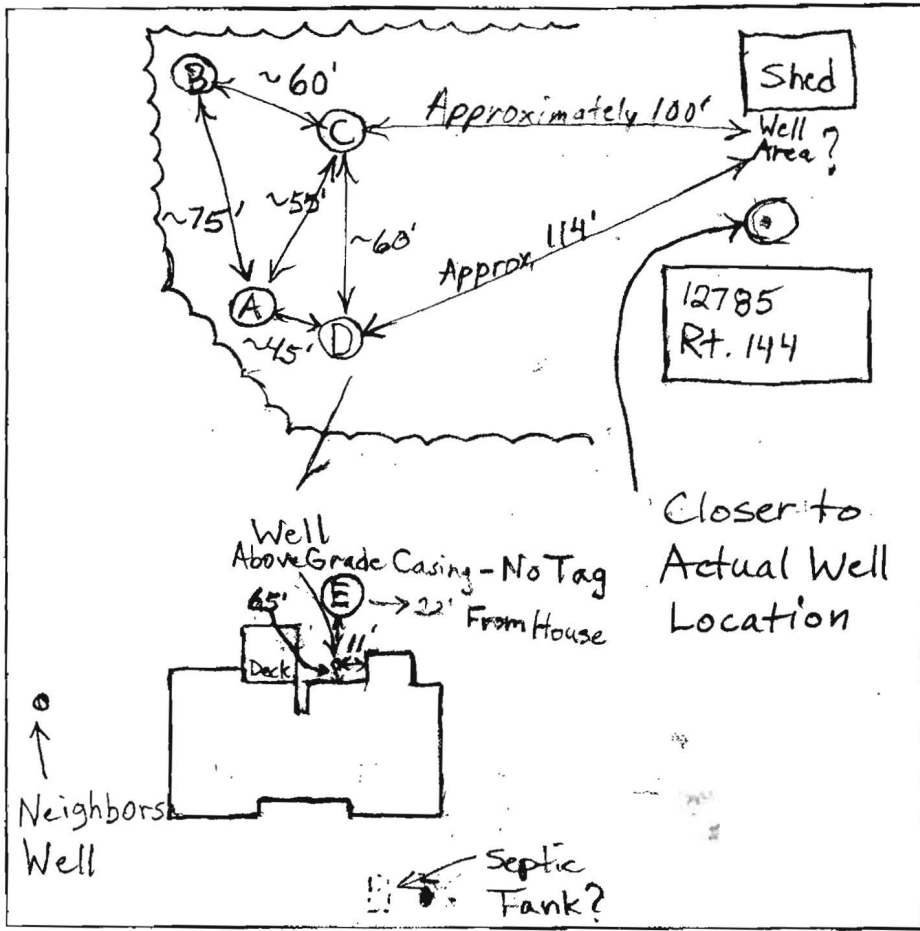













(D)
 Or Br Sa Loam 30-35% Rock 1.5'
 Beige Sand 30-35% Rock 4'
 ~50% Rock Hard Bottom 7.5'
 (E)
 Or Br SiCl loam ~10% Rock 4'
 Br Sa Loam 35-40% Rock 5.5'
 Caving Water at 7' and Rising 8'

Rt. 144

DATE	TEST #	DEPTH	START	BREAK 1" DROP	STOP 2" DROP	TIME OF 2nd INCH	P/F/H
9/9/05	A	2'/6.5'				2nd inch → 30 seconds	(F)
	B	8'V					(F)
	C	15-25'V					(F)
	D	7.5'V					(F)
	E	4'/8'V					(F)
Tested at Various Locations with a perc stick in top 1 1/2' of Soil - Slowest Rate was 11 minutes							

REMARKS Water Moved on Shelf at 4' in E
 SANITARIAN B. Baker BACKHOE Fyock OTHERS _____
 TEST HOLES USED IN SDA _____ AVG. PERG TIME _____ SQ. FT/BR _____
 TRENCH WIDTH _____ INLET DEPTH _____ MAX. BOT DEPTH _____ EFFECTIVE SW _____



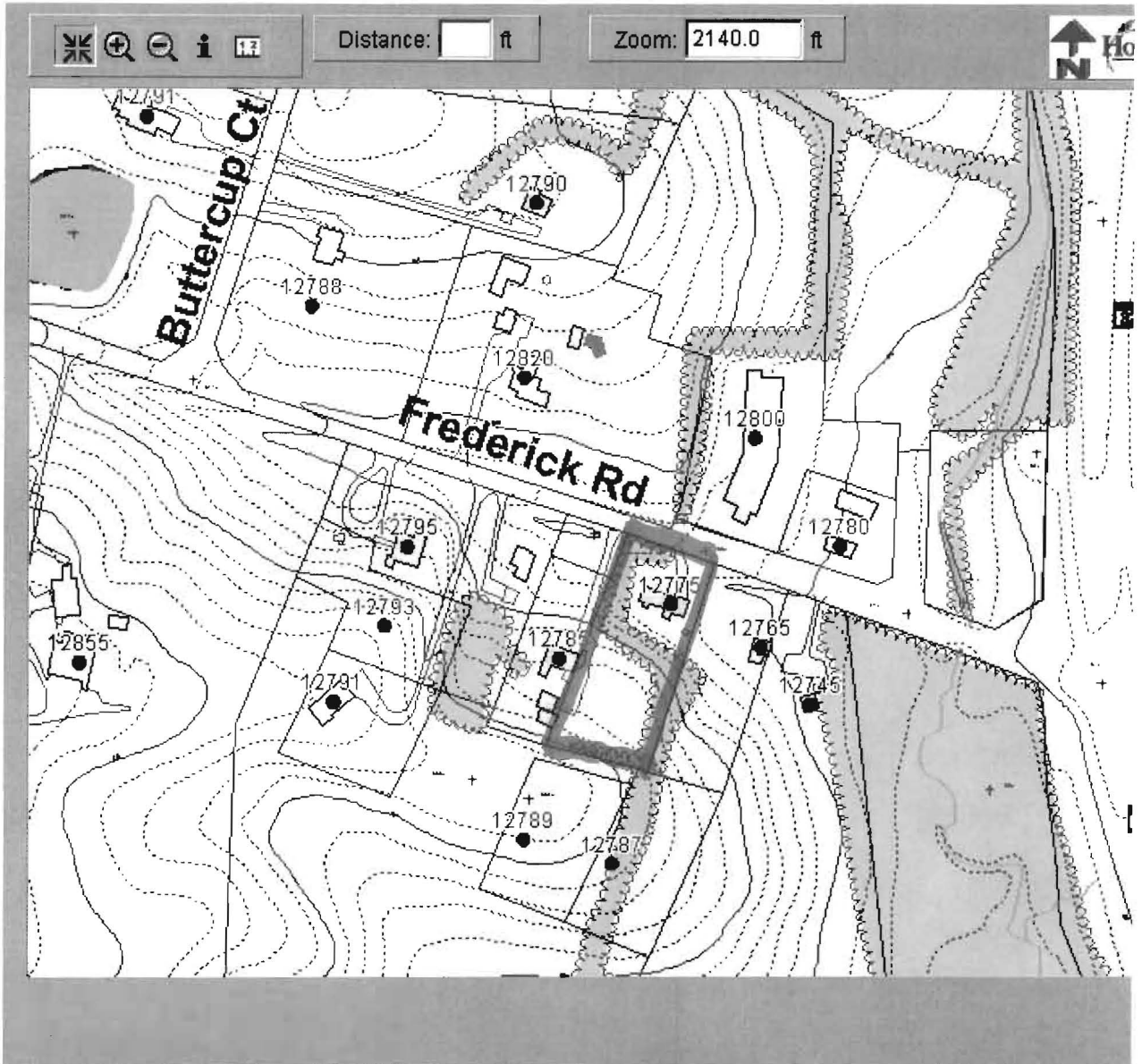









- Help Me 
- Map Reset 
- Zoom Fit 
- Find Location 
- Remove Pin 
- Layer Control 
- Image Control 
- Theme Map 
- Local Print 
- Print Layout 
- Email Map 
- Map Exit 



Disclaimer: Howard County, Maryland assumes no responsibility for the accuracy of the map or the information contained herein or derived therefrom. The buyer and/or seller assumes all risks and liabilities whatsoever resulting from or arising out of the use of this map. There are no oral agreements or warranties relating to this sale and/or the use of this map.

Friday, September 09 2005 | 10:02:31 AM | @626

Contacts: John Bussiere (x3044) Virginia Peterman (x3659) Yut Phasukyued (x3093) Robert Slivinsky (x3094)

- Help Me** 
- Map Reset** 
- Zoom Fit** 
- Find Location** 
- Remove Pin** 
- Layer Control** 
- Image Control** 
- Theme Map** 
- Local Print** 
- Print Layout** 
- Email Map** 
- Map Exit** 

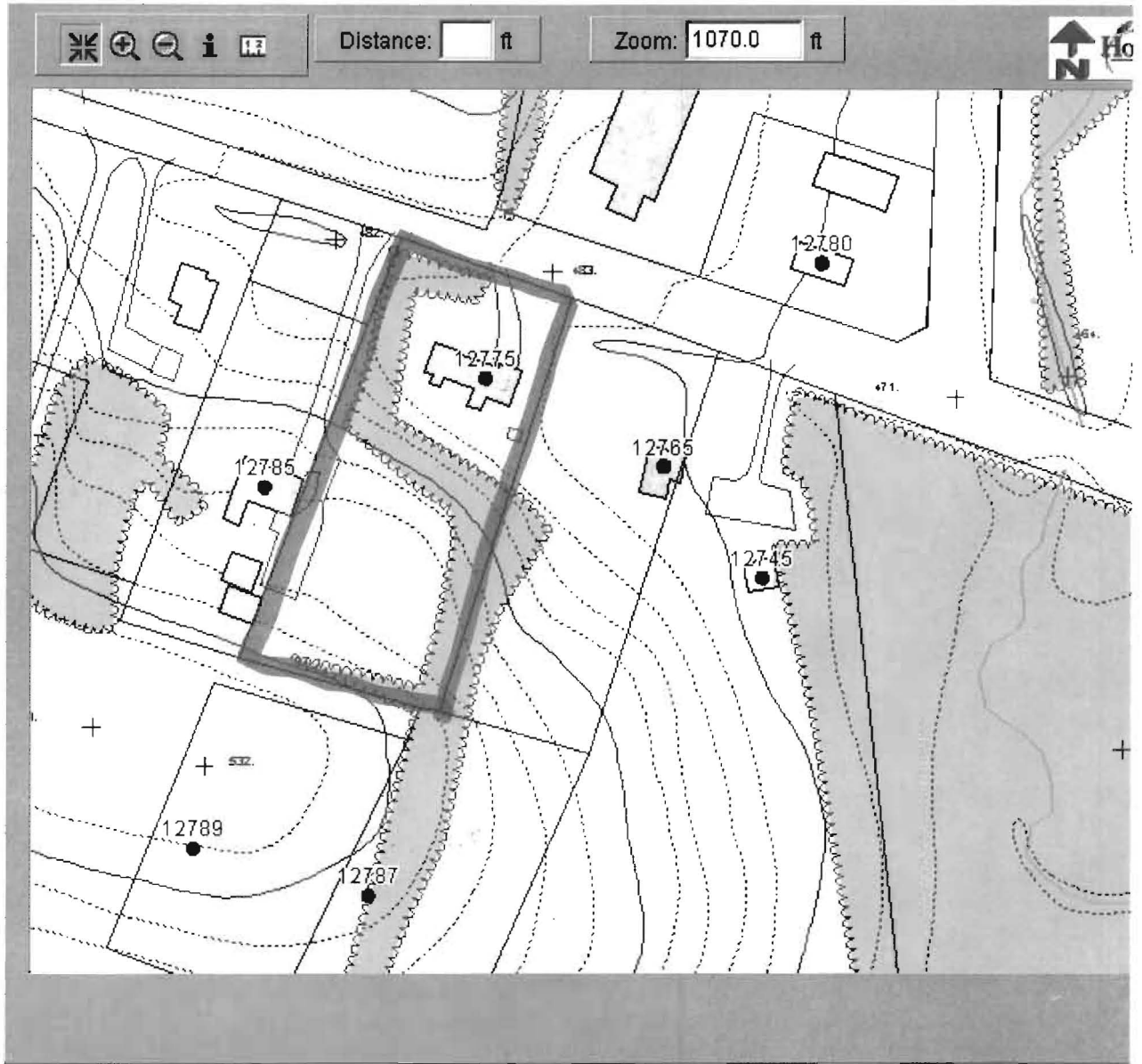

Disclaimer: Howard County, Maryland assumes no responsibility for the accuracy of the map or the information contained herein or derived therefrom. The buyer and/or seller assumes all risks and liabilities whatsoever resulting from or arising out of the use of this map. There are no oral agreements or warranties relating to this sale and/or the use of this map.

Friday, September 09 2005 | 10:08:46 AM | @631

Contacts: John Bussiere (x3044) Virginia Peterman (x3659) Yut Phasukyued (x3093) Robert Slivinsky (x3094)