

C1 2998

SEQUENCE NO. (MDE USE ONLY)

STATE OF MARYLAND WELL COMPLETION REPORT

THIS REPORT MUST BE SUBMITTED WITHIN 45 DAYS AFTER WELL IS COMPLETED.

1 2 3 4 5 6 7 8 (THIS NUMBER IS TO BE PUNCHED IN COLS. 3-6 ON ALL CARDS)

COUNTY NUMBER

ST/CO USE ONLY

DATE WELL COMPLETED

Depth of Well

PERMIT NO. FROM "PERMIT TO DRILL WELL"

DATE Received MM DD YY

MM DD YY 3 6 06

22 28' 26 (TO NEAREST FOOT)

Handwritten notes: 0169D, 4/10/06

28 29 30 31 32 33 34 35 36 37 No. 95-0256

OWNER: Rutan, Robert; STREET OR RFD: 5001 Durham Rd West; TOWN: Columbia Md 21044; SUBDIVISION: SECTION: LOT:

WELL LOG

Not required for driven wells

STATE THE KIND OF FORMATIONS PENETRATED, THEIR COLOR, DEPTH, THICKNESS AND IF WATER BEARING

Table with columns: DESCRIPTION (Use additional sheets if needed), FEET (FROM, TO), check if water bearing. Includes handwritten entry: Sand 0 26, Dewatering well for basement, 1/2 in screen's in 6 in casing, Hit water at 18', Sand pack casing 26'.

GROUTING RECORD

WELL HAS BEEN GROUTED (Circle Appropriate Box) YES Y NO N. TYPE OF GROUTING MATERIAL (Circle one) CEMENT CM BENTONITE CLAY BC. NO. OF BAGS NO. OF POUNDS. GALLONS OF WATER. DEPTH OF GROUT SEAL (to nearest foot) from 48 TOP 52 ft. to 54 BOTTOM 58 ft.

CASING RECORD

Case types insert appropriate code below. MAIN CASING TYPE: PL 6 28. Nominal diameter top (main) casing (nearest inch)! Total depth of main casing (nearest foot).

OTHER CASING (if used)

Table for OTHER CASING with columns: diameter inch, depth (feet) from to.

SCREEN RECORD

screen type or open hole. insert appropriate code below. ST BR HO PL OT.

DEPTH (nearest ft.)

Table for DEPTH with columns: 1 2 3 4 5 6 7 8 9 10 11 12 13 14 15 16 17 18 19 20 21 22 23 24 25 26 27 28 29 30 31 32 33 34 35 36 37 38 39 40 41 42 43 44 45 46 47 48 49 50 51 52 53 54 55 56 57 58 59 60 61 62 63 64 65 66 67 68 69 70 71 72 73 74 75 76 77 78 79 80.

GRAVEL PACK IF WELL DRILLED WAS FLOWING WELL INSERT F IN BOX 68

MDE USE ONLY (NOT TO BE FILLED IN BY DRILLER) T (E.R.O.S.) W Q

TELESCOPE CASING LOG INDICATOR OTHER DATA

C 3

PUMPING TEST

HOURS PUMPED (nearest hour) 8 9. PUMPING RATE (gal. per min.) 11 15. METHOD USED TO MEASURE PUMPING RATE. WATER LEVEL (distance from land surface) BEFORE PUMPING 17 20 ft. WHEN PUMPING 22 25 ft. TYPE OF PUMP USED (for test) A air P piston T turbine C centrifugal R rotary O other J jet S submersible.

PUMP INSTALLED

DRILLER INSTALLED PUMP YES NO. IF DRILLER INSTALLS PUMP, THIS SECTION MUST BE COMPLETED FOR ALL WELLS. TYPE OF PUMP INSTALLED PLACE (A,C,J,P,R,S,T,O) IN BOX 29. CAPACITY: GALLONS PER MINUTE (to nearest gallon) 31 35. PUMP HORSE POWER 37 41. PUMP COLUMN LENGTH (nearest ft.) 43 47. CASING HEIGHT (circle appropriate box and enter casing height) LAND SURFACE. below 2 (nearest foot).

LOCATION OF WELL ON LOT SHOW PERMANENT STRUCTURE SUCH AS BUILDING, SEPTIC TANKS, AND /OR LANDMARKS AND INDICATE NOT LESS THAN TWO DISTANCES (MEASUREMENTS TO WELL)

See Attached location.

NUMBER OF UNSUCCESSFUL WELLS: 0

WELL HYDROFRACTURED YES Y NO N

CIRCLE APPROPRIATE LETTER A A WELL WAS ABANDONED AND SEALED WHEN THIS WELL WAS COMPLETED E ELECTRIC LOG OBTAINED P TEST WELL CONVERTED TO PRODUCTION WELL

I HEREBY CERTIFY THAT THIS WELL HAS BEEN CONSTRUCTED IN ACCORDANCE WITH COMAR 26.04.04 "WELL CONSTRUCTION" AND IN CONFORMANCE WITH ALL CONDITIONS STATED IN THE ABOVE CAPTIONED PERMIT, AND THAT THE INFORMATION PRESENTED HEREIN IS ACCURATE AND COMPLETE TO THE BEST OF MY KNOWLEDGE.

DRILLERS LIC. NO. 1 MSD 024 DRILLERS SIGNATURE (MUST MATCH SIGNATURE ON APPLICATION)

LIC. NO. 1 D

SITE SUPERVISOR (sign. of driller or journeyman responsible for sitework if different from permittee)

B 1 1432

SEQUENCE NO. (MDE USE ONLY)

STATE OF MARYLAND APPLICATION FOR PERMIT TO DRILL WELL

STATE PERMIT NUMBER

10-95-0256 fill in this form completely

524057 please type

Date Received (APA) 02 07 2006

OWNER INFORMATION

Rutan Robert 5001 Durham Rd. West Columbia Md 21044

LOCATION OF WELL

Howard 21 COUNTY Beaverbrook 42 SUBDIVISION Columbia 71 NEAREST TOWN 5 MILES FROM TOWN

DRILLER INFORMATION

Joseph L. Mayne MSD024 Driller's Name License No. Joseph L. Mayne Well Drilling Firm Name 5512 Ridge Rd Mt Airy Md 21771 Address Joseph L. Mayne 2/6/06 Date Signature

DIRECTION OF WELL FROM TOWN (CIRCLE BOX)

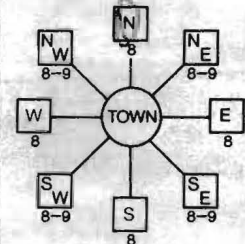

5001 Durham Rd West 30 NEAR WHAT ROAD ON WHICH SIDE OF ROAD 125 37 DISTANCE FROM ROAD ENTER FT OR MI TAX MAP: 30 BLK: 13 PARCEL 168

WELL INFORMATION APPROX. PUMPING RATE 10 AVERAGE DAILY QUANTITY NEEDED 8,500

- USE FOR WATER (CIRCLE APPROPRIATE BOX) D DOMESTIC POTABLE SUPPLY & RESIDENTIAL IRRIGATION F FARMING (LIVESTOCK WATERING & AGRICULTURAL IRRIGATION) I INDUSTRIAL, COMMERCIAL DEWATERING P PUBLIC WATER SUPPLY WELL T TEST, OBSERVATION, MONITORING G GEO-THERMAL

NOT TO BE FILLED IN BY DRILLER HEALTH DEPARTMENT APPROVAL Howard 13 COUNTY NAME COUNTY NO. STATE SIGNATURE DATE ISSUED 2/16/06 CO SIGNATURE EXP. DATE NORTH GRID 50 000 EAST GRID 57 837

APPROXIMATE DEPTH OF WELL 20 FEET APPROXIMATE DIAMETER OF WELL 6 INCH NEAREST

METHOD OF DRILLING (circle one) BORED (or Augered) JETTED Jetted & DRIVEN AIR-ROTary AIR-PERCussion ROTARY (Hydraulic Rotary) CABLE REVERSE-ROTary DRIVE-POINT other

REPLACEMENT OR DEEPEMED WELLS (CIRCLE APPROPRIATE BOX) THIS WELL WILL NOT REPLACE AN EXISTING WELL THIS WELL WILL REPLACE A WELL THAT WILL BE ABANDONED AND SEALED THIS WELL WILL REPLACE A WELL THAT WILL BE USED AS A STANDBY-CONTACT LOCAL APPROVING AUTHORITY FOR POLICY ON STANDBY WELLS THIS WELL WILL DEEPEN AN EXISTING WELL PERMIT NUMBER OF WELL TO BE REPLACED OR DEEPEMED (IF AVAILABLE) 41

Not to be filled in by driller (MDE OR COUNTY USE ONLY) APPROX. PERMIT NUMBER 10-2006-G-001 PERMIT No. 10-95-0256

SHOW MAJOR FEATURES OF BOX & LOCATE WELL WITH AN X SOURCES OF DRILLING WATER 1. well WRITE THE BOX NUMBER FROM THE MAP HERE E 837 N 510

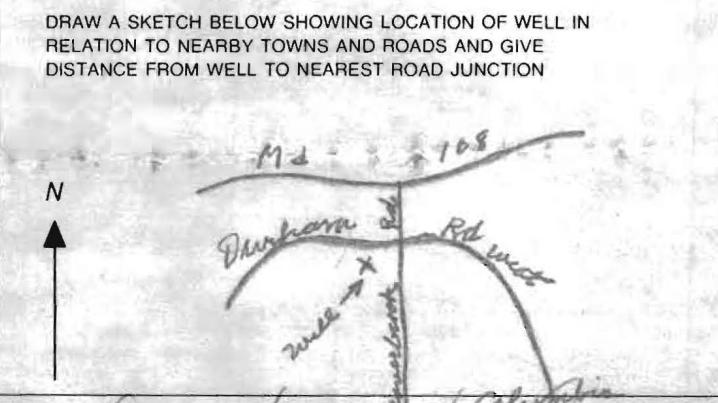

SPECIAL CONDITIONS Screened & Gravel packed

110 V  
ELECTRIC  
OUTLET

SOUTH END OF HOUSE

30' 6"

7' 6"

2/16/06  
Well site OK  
EG

23' 0" TO WELL

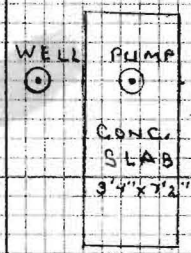

N

SUNY Durham Rd, W

110V  
ELECTRIC  
OUTLET

SOUTH END OF HOUSE

30' 0"

78' 6"

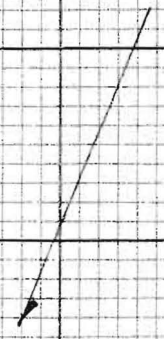

WELL PUMP

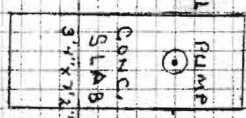

23' 0" TO WELL

2 1/2" / 10" S. HE  
WELL SITE  
DIT

5001 Durham Rd

N



MARYLAND DEPARTMENT OF THE ENVIRONMENT

1800 Washington Boulevard • Baltimore MD 21230

410-537-3000 • 1-800-633-6101

Robert L. Ehrlich, Jr.  
Governor

Kendl P. Philbrick  
Secretary

Michael S. Steele  
Lt. Governor

Jonas A. Jacobson  
Deputy Secretary

January 3, 2006

ROBERT RUTAN  
5001 DURHAM ROAD WEST  
COLUMBIA, MD 21044

(410) 997-9629

RE: State Water Appropriation  
Permit No. HO2006G001(01)  
First Permit

Dear Permittee:

Enclosed is your State Water Appropriation Permit. The permittee is responsible for complying with all permit conditions. Accordingly, you are advised to carefully read the Permit and become thoroughly familiar with its requirements. PLEASE NOTE THAT IF THE WATER IS NOT PUT TO USE WITHIN TWO (2) YEARS, THE PERMIT WILL EXPIRE.

If you have any questions, please contact this office at (410) 537-3590.

Sincerely,

MARK T. FILAR  
Water Supply Program

cc: HOWARD COUNTY HEALTH DEPARTMENT

Must use p. less & standard pump (sc)

**STATE OF MARYLAND**  
**DEPARTMENT OF THE ENVIRONMENT**  
**WATER MANAGEMENT ADMINISTRATION**

**WATER APPROPRIATION AND USE PERMIT**

PERMIT NUMBER: HO2006G001(01)

EFFECTIVE DATE: JANUARY 1, 2006

EXPIRATION DATE: JANUARY 1, 2009

FIRST APPROPRIATION: JANUARY 1, 2006

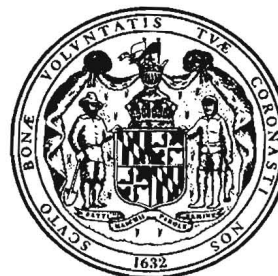

ROBERT RUTAN

HEREINAFTER REFERRED TO AS THE "PERMITTEE", IS AUTHORIZED BY THE WATER MANAGEMENT ADMINISTRATION, HEREINAFTER REFERRED TO AS THE "ADMINISTRATION" PURSUANT TO THE PROVISIONS OF TITLE 5 OF THE ENVIRONMENT ARTICLE, ANNOTATED CODE OF MARYLAND (1996 REPLACEMENT VOLUME) AS AMENDED, TO APPROPRIATE AND USE WATERS OF THE STATE SUBJECT TO THE FOLLOWING CONDITIONS:

1. ALLOCATION - THE WATER WITHDRAWAL GRANTED BY THIS PERMIT IS LIMITED TO:  
A DAILY AVERAGE OF 8,500 GALLONS ON A YEARLY BASIS AND  
A DAILY AVERAGE OF 100,000 GALLONS FOR THE MONTH OF MAXIMUM USE.
2. USE - THE WATER IS TO BE USED FOR DEWATERING OF THE GROUND WATER FROM THE BASEMENT OF A PRIVATE RESIDENCE.
3. SOURCE - THE WATER SHALL BE TAKEN FROM ONE WELL IN THE WISSAHIKON LOWER PELITIC SCHIST.
4. LOCATION - THE POINT(S) OF WITHDRAWAL SHALL BE LOCATED AT 5001 DURHAM ROAD WEST, COLUMBIA, HOWARD COUNTY, MD 21044.

CONTINUED ON PAGE 2

5. RIGHT OF ENTRY - THE PERMITTEE SHALL ALLOW AUTHORIZED REPRESENTATIVES OF THE ADMINISTRATION ACCESS TO THE PERMITTEE'S FACILITY TO CONDUCT INSPECTIONS AND EVALUATIONS NECESSARY TO ASSURE COMPLIANCE WITH THE CONDITIONS OF THIS PERMIT. THE PERMITTEE SHALL PROVIDE SUCH ASSISTANCE AS MAY BE NECESSARY TO EFFECTIVELY AND SAFELY CONDUCT SUCH INSPECTIONS AND EVALUATIONS.
6. PERMIT REVIEW - THE PERMITTEE WILL BE QUERIED EVERY THREE YEARS (TRIENNIAL REVIEW) REGARDING WATER USE UNDER THE TERMS AND CONDITIONS OF THIS PERMIT. FAILURE TO RETURN THE TRIENNIAL REVIEW QUERY WILL RESULT IN SUSPENSION OR REVOCATION OF THIS PERMIT.
7. PERMIT RENEWAL - THIS PERMIT WILL EXPIRE ON THE DATE INDICATED ON THE FIRST PAGE OF THIS PERMIT. IN ORDER TO RENEW THE PERMIT THE PERMITTEE SHALL FILE A RENEWAL APPLICATION WITH THE ADMINISTRATION NO LATER THAN 45 DAYS PRIOR TO THE EXPIRATION.
8. PERMIT SUSPENSION OR REVOCATION - THIS PERMIT MAY BE SUSPENDED OR REVOKED BY THE ADMINISTRATION UPON VIOLATION OF THE CONDITIONS OF THIS PERMIT, OR UPON VIOLATION OF ANY REGULATION PROMULGATED PURSUANT TO TITLE 5 OF THE ENVIRONMENT ARTICLE, ANNOTATED CODE OF MARYLAND (1996 REPLACEMENT VOLUME) AS AMENDED.
9. CHANGE OF OPERATIONS - ANY ANTICIPATED CHANGE IN APPROPRIATION WHICH MAY RESULT IN A NEW OR DIFFERENT USE, QUANTITY, SOURCE, OR PLACE OF USE OF WATER SHALL BE REPORTED TO THE ADMINISTRATION BY THE PERMITTEE BY SUBMISSION OF A NEW APPLICATION.
10. ADDITIONAL PERMIT CONDITIONS - THE ADMINISTRATION MAY AT ANYTIME (INCLUDING TRIENNIAL PERMIT REVIEW OR WHEN A CHANGE APPLICATION IS SUBMITTED) REVISE ANY CONDITION OF THIS PERMIT OR ADD ADDITIONAL CONDITIONS CONCERNING THE CHARACTER, AMOUNT, MEANS AND MANNER OF THE APPROPRIATION OR USE, WHICH MAY BE NECESSARY TO PROPERLY PROTECT, CONTROL AND MANAGE THE WATER RESOURCES OF THE STATE. CONDITION REVISIONS AND ADDITIONS WILL BE ACCOMPLISHED BY ISSUANCE OF A REVISED PERMIT.

11. DROUGHT PERIOD EMERGENCY RESTRICTIONS - IF THE DEPARTMENT DETERMINES THAT A DROUGHT PERIOD OR EMERGENCY EXISTS, THE PERMITTEE MAY BE REQUIRED UNDER THE DEPARTMENT'S DIRECTION TO STOP OR REDUCE WATER USE. ANY CESSATION OR REDUCTION OF WATER USE MUST CONTINUE FOR THE DURATION OF THE DROUGHT PERIOD OR EMERGENCY, OR UNTIL THE DEPARTMENT DIRECTS THE PERMITTEE THAT WATER USE UNDER STANDARD PERMIT CONDITIONS MAY BE RESUMED.
12. NON-TRANSFERRABLE - THIS PERMIT IS NON-TRANSFERRABLE. A NEW OWNER MAY ACQUIRE AUTHORIZATION TO CONTINUE THIS APPROPRIATION BY FILING A NEW APPLICATION WITH THE ADMINISTRATION. AUTHORIZATION WILL BE ACCOMPLISHED BY ISSUANCE OF A NEW PERMIT.
13. \*\*\*\*\*  
\* INITIATION OF WITHDRAWAL - THE PERMITTEE SHALL NOTIFY THE\*  
\* ADMINISTRATION BY CERTIFIED MAIL WHEN WITHDRAWALS FOR THE\*  
\* USES SPECIFIED IN THIS PERMIT HAVE BEEN INITIATED. THIS \*  
\* PERMIT SHALL EXPIRE IF WATER WITHDRAWAL IS NOT COMMENCED \*  
\* WITHIN TWO YEARS AFTER THE EFFECTIVE DATE OF THIS PERMIT \*  
\* EXCEPT THAT UPON WRITTEN REQUEST TO THE ADMINISTRATION \*  
\* PRIOR TO THE EXPIRATION OF THE TWO YEAR PERIOD, THE TIME \*  
\* LIMIT MAY BE EXTENDED FOR GOOD CAUSE, AT THE DISCRETION \*  
\* OF THE ADMINISTRATION. \*  
\*\*\*\*\*
14. WATER LEVEL MEASUREMENTS - FOR ALL THE APPLICANT'S WELLS FOUR (4) INCHES IN DIAMETER OR LARGER, PUMPING EQUIPMENT SHALL BE INSTALLED SO THAT WATER LEVELS CAN BE MEASURED DURING PUMPING AND NONPUMPING PERIODS WITHOUT DISMANTLING ANY EQUIPMENT. ANY OPENING FOR TAPE MEASUREMENTS OF WATER LEVELS SHALL HAVE A MINIMUM INSIDE DIAMETER OF 0.5 INCHES AND BE SEALED BY A REMOVABLE CAP OR PLUG. THE PERMITTEE SHALL PROVIDE A TAP FOR TAKING RAW WATER SAMPLES BEFORE WATER ENTERS A TREATMENT FACILITY, PRESSURE TANK, OR STORAGE TANK.

BY AUTHORITY OF THE DIRECTOR  
WATER MANAGEMENT ADMINISTRATION

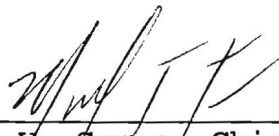
  
\_\_\_\_\_  
John W. Grace, Chief  
SOURCE PROTECTION AND APPROPRIATION DIV

1/6/06

PERMIT NO.: HO2006G001(01) ACTID: 200680000 January 3, 2006

APPLICANT: ROBERT RUTAN  
REMARKS: PRIVATE RESIDENCE  
PROJECT DESC: PRIVATE RESIDENCE

WATER TYPE: F REPORT CODE: N  
AQUIFER TEST: N WQ ANALYSIS: N

ADC MAP: 15 F 2

MD GRIDS: NORTH 510000 EAST 0836000

TAX MAP NO.: 30 BLOCK NO.: 13 PARCEL: 168 SBDN BLOCK:  
LOT:

CO GEO-HYDRO MAP: L USGS TOPO: ELLICOTT CITY

SUB-BASIN: 02-13-11-05 STREAM CODE: AQUIFER CODE: 300P

WATER USE:	CODE 1	CODE 2	CODE 3	CODE 4
	304 100.0	0.0	0.0	0.0

INTAKES: INTAKE ID N GRID E GRID USE PERCENT

CARBON COPIES:

SUPPLEMENTAL/RELATED (S/R):

SECONDARY NAMES:

5001 Durham Rd. West  
Columbia, Md. 21044

November 15, 2005

Howard County Health Department  
7178 Columbia Gateway Dr.  
Columbia, Md. 21046

Attn. Mr. Michael Davis, Program Supervisor

Re: Application for shallow well permit

Dear Mr. Davis:

I have discussed the aquifer situation, on my property, with Mr. Gul Behsudi at the Maryland Department of the Environment. He sent me the enclosed application which I have completed with as much information as I can supply. It now, apparently, must go to you for completion.

I am not familiar with this entire procedure and would appreciate a telephone call from you to advise me of whatever further action, on my part, is required. I would be willing to meet with you, and any other person involved in the decision making process, either here at the site, or at your office.

Please let me re-iterate that this is a health problem and must be resolved as quickly as possible. Thank you for your assistance in this matter.

Sincerely yours,

Robert E. Rutan

Attachments Enclosed

NOTE: THIS APPLICATION IS FOR A PERMIT TO DRAIN AN AQUIFER UNDER MY RESIDENCE, I DO NOT KNOW THE DIMENSIONS OR DEPTH OF THE AQUIFER. THE BASEMENT HAS BEEN FLOODED ON SEVERAL OCCASIONS, RESULTING IN THE FORMATION OF MOLD ON THE FLOOR AND WALLS. THE SUMP PUMP RUNS CONTINUOUSLY DURING ANY RAIN STORM. DURING THE DRYEST PERIODS OF NO RAIN THE SUMP REMAINS HALF FULL OF WATER, THIS IS AN EXTREMELY DANGEROUS HEALTH HAZARD AND THE ONLY WAY TO CORRECT IT IS TO DIG A SHALLOW WELL AND PUMP OUT THE WATER TO A LEVEL AT LEAST SIX TO EIGHT FEET BELOW THE BASEMENT FLOOR. I PROPOSE TO DIG THIS WELL AT A POINT 18 TO 20 FEET FROM THE SOUTHEAST CORNER OF MY HOUSE. R. E. R.

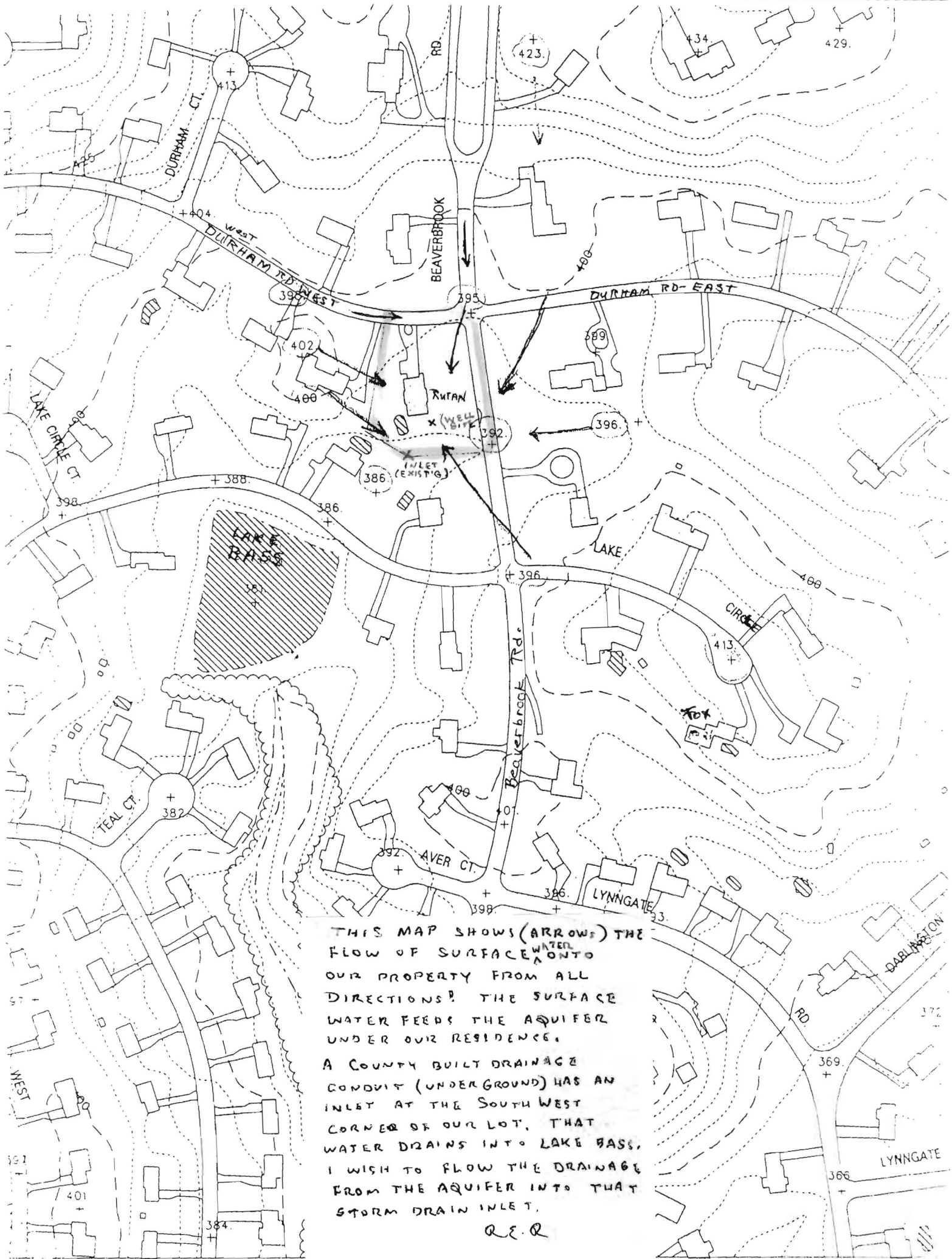

THIS MAP SHOWS (ARROWS) THE FLOW OF SURFACE WATER ONTO OUR PROPERTY FROM ALL DIRECTIONS. THE SURFACE WATER FEEDS THE AQUIFER UNDER OUR RESIDENCE. A COUNTY BUILT DRAINAGE CONDUIT (UNDERGROUND) HAS AN INLET AT THE SOUTH WEST CORNER OF OUR LOT. THAT WATER DRAINS INTO LAKE BASS. I WISH TO FLOW THE DRAINAGE FROM THE AQUIFER INTO THAT STORM DRAIN INLET.

R.E.R.



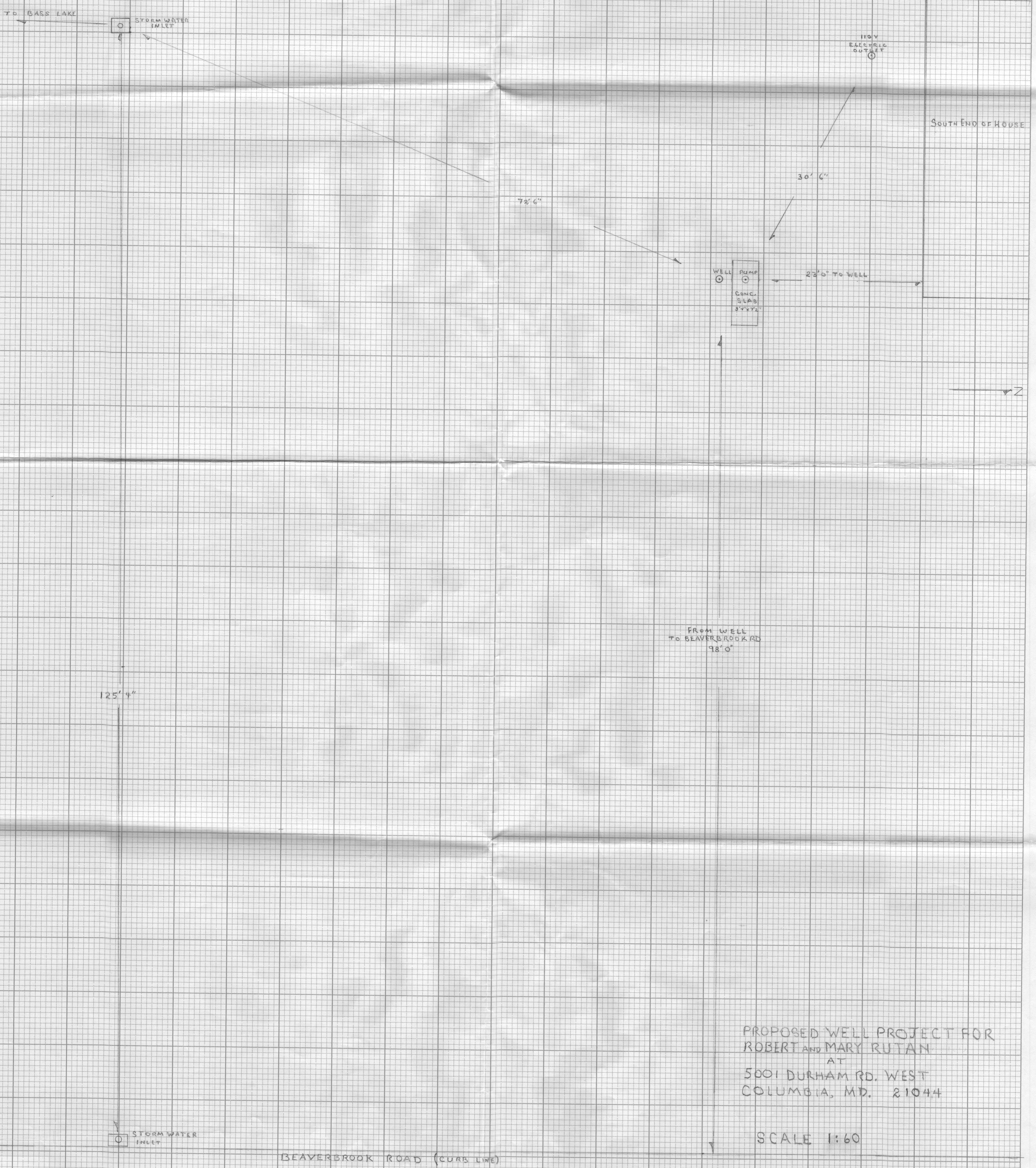

PROPOSED WELL PROJECT FOR  
 ROBERT AND MARY RUTAN  
 AT  
 5001 DURHAM RD. WEST  
 COLUMBIA, MD. 21044

SCALE 1:60

BEAVERBROOK ROAD (CURB LINE)