

C1 6466

SEQUENCE NO. (MDE USE ONLY)

STATE OF MARYLAND WELL COMPLETION REPORT

THIS REPORT MUST BE SUBMITTED WITHIN 45 DAYS AFTER WELL IS COMPLETED.

1 2 3 6 (THIS NUMBER IS TO BE PUNCHED IN COLS. 3-6 ON ALL CARDS)

COUNTY NUMBER 13 A519617

ST/CO USE ONLY DATE Received MM DD YY 8 13

DATE WELL COMPLETED MM DD YY 5 13 05

Depth of Well 22 400 26 (TO NEAREST FOOT) 6/6/05 O.K. BB

PERMIT NO. FROM "PERMIT TO DRILL WELL" HO-94-4158 28 29 30 31 32 33 34 35 36 37

OWNER Rachuba Home Builders last name Ed Warfield Road first name TOWN Woodbine SUBDIVISION Mariani Property SECTION LOT 3

WELL LOG Table with columns: DESCRIPTION, FEET (FROM, TO), check if water bearing. Rows include Brown Mica, Gray Limestone, Dry hole, Cement, Rock Cuttings.

GROUTING RECORD YES NO Y N. TYPE OF GROUTING MATERIAL (Circle one) CEMENT CM BENTONITE CLAY BC. NO. OF BAGS 52 NO. OF POUNDS 4888. GALLONS OF WATER 312. DEPTH OF GROUT SEAL (to nearest foot) from 0 TOP 52 ft. to 95 BOTTOM 58 ft.

CASING RECORD (circle types insert appropriate code below) ST STEEL CO CONCRETE PL PLASTIC OT OTHER. MAIN CASING TYPE ST Nominal diameter top (main) casing (nearest inch)! 06 Total depth of main casing (nearest foot) 105

OTHER CASING (if used) diameter inch depth (feet) from to

SCREEN RECORD (circle screen type or open hole insert appropriate code below) ST STEEL BR BRASS PL PLASTIC HO OPEN HOLE OT OTHER. DEPTH (nearest ft.) 1 105 400

NUMBER OF UNSUCCESSFUL WELLS: 1 WELL HYDROFRACTURED Y N

CIRCLE APPROPRIATE LETTER A A WELL WAS ABANDONED AND SEALED WHEN THIS WELL WAS COMPLETED E ELECTRIC LOG OBTAINED P TEST WELL CONVERTED TO PRODUCTION WELL

I HEREBY CERTIFY THAT THIS WELL HAS BEEN CONSTRUCTED IN ACCORDANCE WITH COMAR 26.04.04 "WELL CONSTRUCTION" AND IN CONFORMANCE WITH ALL CONDITIONS STATED IN THE ABOVE CAPTIONED PERMIT, AND THAT THE INFORMATION PRESENTED HEREIN IS ACCURATE AND COMPLETE TO THE BEST OF MY KNOWLEDGE.

DRILLERS LIC. NO. 1 MSD 009 1 DRILLERS SIGNATURE (MUST MATCH SIGNATURE ON APPLICATION) LIC. NO. 1 D 1

GRAVEL PACK IF WELL DRILLED WAS FLOWING WELL INSERT F IN BOX 68

MDE USE ONLY (NOT TO BE FILLED IN BY DRILLER) T (E.R.O.S.) W Q

70 72 74 75 76 TELESCOPE CASING LOG INDICATOR OTHER DATA

PUMPING TEST PUMPING TEST HOURS PUMPED (nearest hour) 06 8 9 PUMPING RATE (gal. per min.) 1.3 11 15 METHOD USED TO MEASURE PUMPING RATE 1906 WATER LEVEL (distance from land surface) BEFORE PUMPING 15 17 20 ft. WHEN PUMPING 109 22 25 ft. TYPE OF PUMP USED (for test) A air P piston T turbine C centrifugal R rotary O other (describe below) J jet S submersible

PUMP INSTALLED DRILLER INSTALLED PUMP YES NO (CIRCLE) (YES or NO) IF DRILLER INSTALLS PUMP, THIS SECTION MUST BE COMPLETED FOR ALL WELLS. TYPE OF PUMP INSTALLED PLACE (A,C,J,P,R,S,T,O) IN BOX 29. CAPACITY: GALLONS PER MINUTE (to nearest gallon) 31 35 PUMP HORSE POWER 37 41 PUMP COLUMN LENGTH (nearest ft.) 43 47 CASING HEIGHT (circle appropriate box and enter casing height) + above LAND SURFACE - below 01 (nearest) foot

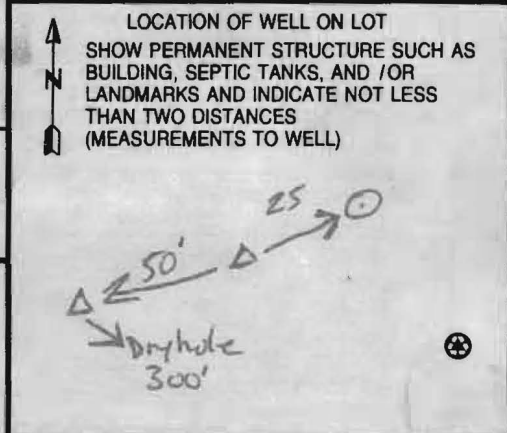

B 1 8121  
1 2 3 6

SEQUENCE NO.  
(MDE USE ONLY)

STATE OF MARYLAND  
APPLICATION FOR PERMIT TO DRILL WELL  
522063 please type

STATE PERMIT NUMBER

HO-94-4158  
70 fill in this form completely 79

Date Received (APA)

4/1/2005  
8 MM DD YY 13

OWNER INFORMATION

Mariani Theodore  
15 Last Name Owner First Name 34

16449 Ed Warfield rd  
36 Street or RFD 55

Woodbine mo 21797  
57 Town 70 State 72 Zip 76

DRILLER INFORMATION

Allen Compton M S D 009  
Driller's Name 76 License No. 81

Fogles Well Drilling  
Firm Name

580 Obrecht rd  
Address

Allen Compton 3-30-05  
Signature Date

B 2 WELL INFORMATION

APPROX. PUMPING RATE 5  
(GAL. PER MIN.) 8 12

AVERAGE DAILY QUANTITY NEEDED 500  
(GAL. PER DAY) 14 20

USE FOR WATER (CIRCLE APPROPRIATE BOX)

- DOMESTIC POTABLE SUPPLY & RESIDENTIAL IRRIGATION
- FARMING (LIVESTOCK WATERING & AGRICULTURAL IRRIGATION)
- INDUSTRIAL, COMMERCIAL, DEWATERING
- PUBLIC WATER SUPPLY WELL
- TEST, OBSERVATION, MONITORING
- GEO-THERMAL

B 3

LOCATION OF WELL

Howard  
8 COUNTY 21

MARIANI PLO.  
23 SUBDIVISION 42

SECTION 44 46 LOT 3 48 50

Glenwood  
52 NEAREST TOWN 71

MILES FROM TOWN (enter 0 if in town) 4  
73 76 77 78

B 4

DIRECTION OF WELL FROM TOWN (CIRCLE BOX)

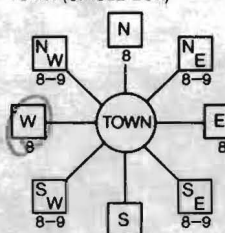

Ed Warfield rd.  
11 NEAR WHAT ROAD 30

ON WHICH SIDE OF ROAD (CIRCLE APPROPRIATE BOX)

700  
34 DISTANCE FROM ROAD 37  
ENTER FT OR MI 38 39

TAX MAP: 13 BLK: 23 PARCEL 277

NOT TO BE FILLED IN BY DRILLER HEALTH DEPARTMENT APPROVAL

Howard 13 A579617  
COUNTY NAME COUNTY NO.

STATE SIGNATURE INSERT S 41

DATE ISSUED 4/7/2005 Brian Baber 4/7/2006  
43 MM DD YY 48 CO SIGNATURE EXP. DATE

NORTH GRID 531 000 EAST GRID 779 000  
50 55 57 63

APPROXIMATE DEPTH OF WELL 300 FEET  
24 28

APPROXIMATE DIAMETER OF WELL 6 INCH NEAREST INCH

METHOD OF DRILLING (circle one)

- BORED (or Augered)  JETTED  Jetted & DRIVEN
- AIR-ROTARY  AIR-PERCussion  ROTARY (Hydraulic Rotary)
- CABLE  REVERSE-ROTARY  DRIVE-POINT
- other \_\_\_\_\_

REPLACEMENT OR DEEPEMED WELLS (CIRCLE APPROPRIATE BOX)

- THIS WELL WILL NOT REPLACE AN EXISTING WELL
- THIS WELL WILL REPLACE A WELL THAT WILL BE ABANDONED AND SEALED
- THIS WELL WILL REPLACE A WELL THAT WILL BE USED AS A STANDBY CONTACT LOCAL APPROVING AUTHORITY FOR POLICY ON STANDBY WELLS
- THIS WELL WILL DEEPEMED AN EXISTING WELL

PERMIT NUMBER OF WELL TO BE REPLACED OR DEEPEMED (IF AVAILABLE) 41 \_\_\_\_\_ 52

Not to be filled in by driller (MDE OR COUNTY USE ONLY)

APPROX. PERMIT NUMBER \_\_\_\_\_ G \_\_\_\_\_  
PERMIT No. HO-94-4158  
70 71 72 73 74 75 76 77 78 79

SHOW MAJOR FEATURES OF BOX & LOCATE WELL WITH AN X

SOURCES OF DRILLING WATER

- 1.
- 2.
- 3.

WRITE THE BOX NUMBER FROM THE MAP HERE

E 78079  
N 5301

000  
000

DRAW A SKETCH BELOW SHOWING LOCATION OF WELL IN RELATION TO NEARBY TOWNS AND ROADS AND GIVE DISTANCE FROM WELL TO NEAREST ROAD JUNCTION

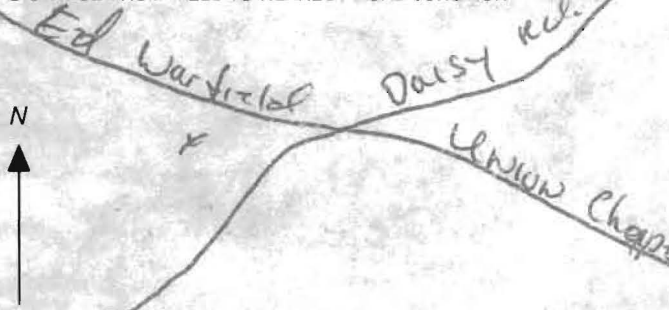

SPECIAL CONDITIONS

NOTE - APPROVING AUTHORITIES SHOULD USE SEPARATE SHEET IF NEEDED

FIELD DATA SHEET  
 HOWARD COUNTY WELL YIELD TEST

Well Permit No. HO - 94-4158  
 Location of property (road) Ed Warfield Road  
 Subdivision Mariani Property Lot 3 Block \_\_\_\_\_ Plat \_\_\_\_\_ Sec. \_\_\_\_\_  
 Well Driller Fogles / Compton Owner Rachuba Home Builders

Depth of well 400'  
 Distance of measuring point (M.P.) above ground 2'  
 Static water level (S.W.L.) below M.P. 15'

I. High rate pumping -- reservoir drawdown

Time pump started 8:00 Pumping rate 8.5  
 Total time 15 min to reach pumping water level 109' ft. below M.P.

II. Recovery pump test data - observations to be recorded every 15 minutes

TIME (in 15 minute intervals)	WATER LEVEL below M.P.	PUMPING RATE time to fill #1 gallon bucket	FLOW METER READING (if used)	CALCULATED FLOW (gallons per minute)
8:00	15	7		8.5
8:15	109	46		1.3
8:30	109	46		1.3
8:45	109	46		1.3
9:00	109	46		1.3
9:15	108	46		1.3
9:30	108	46		1.3
9:45	108	46		1.3
10:00	108	46		1.3
10:15	108	46		1.3
10:30	108	46		1.3
10:45	108	46		1.3
11:00	108	46		1.3
11:15	108	46		1.3
11:30	108	46		1.3
11:45	107	46		1.3
12:00	107	46		1.3
12:15	107	46		1.3
12:30	107	46		1.3
12:45	107	46		1.3
1:00	107	46		1.3
1:15	107	46		1.3
1:30	107	46		1.3
1:45	107	46		1.3



# Yield Test Data Sheet

County File # \_\_\_\_\_

MD Well Permit #: \_\_\_\_\_

Subdivision Name: Marummi Prop.

Section \_\_\_\_\_ Lot # 3

Street Address: \_\_\_\_\_

Measuring Point (MP) Description: Top of casing  
(for ex. "Top of casing")

Distance from MP to ground surface 34 ft.

Well Depth 400' ft.

Well Driller: Allen Compton

Must be submitted with the State of Maryland Well Completion Report

Submit to: Carroll County Health Department  
Bureau of Environmental Health  
P.O. Box 845  
Westminster, MD 21158  
410-876-1884, 410-857-5009  
410-875-3385

**NOTES:**

Pump Start Time	Static Water level: <u>34'</u> ft.	Pumping Rate ( ) Time to fill <u>4 sec.</u> <u>1</u> gal. bucket ( ) Flow meter reading (if used)	Calculated Flow (gallons per minute) <u>15</u>
TIME	WATER LEVEL BELOW M.P.		
<b>Water level and pumping rate must be recorded every 15 minutes</b>			
1	8:00	34 ft.	4 15 GPM
2	8:15	210 ft.	6 10 GPM
3	8:30	292 ft.	7 8.5 GPM
4	8:45	303 ft.	52 1.1 GPM
5	9:00	295 ft.	52 1.1 GPM
6	9:15	283 ft.	52 1.1 GPM
7	9:30	274 ft.	52 1.1 GPM
8	9:45	267 ft.	52 1.1 GPM
9	10:00	263 ft.	52 1.1 GPM
10	10:15	260 ft.	52 1.1 GPM
11	10:30	257 ft.	52 1.1 GPM
12	10:45	254 ft.	52 1.1 GPM
13	11:00	251 ft.	52 1.1 GPM
14	11:15	249 ft.	52 1.1 GPM
15	11:30	247 ft.	52 1.1 GPM
16	11:45	245 ft.	52 1.1 GPM
17	12:00	243 ft.	52 1.1 GPM
18	12:15	241 ft.	52 1.1 GPM
19	12:30	239 ft.	52 1.1 GPM
20	12:45	237 ft.	52 1.1 GPM
21	1:00	235 ft.	52 1.1 GPM
22	1:15	233 ft.	52 1.1 GPM
23	1:30	231 ft.	52 1.1 GPM
24	1:45	229 ft.	52 1.1 GPM
25	2:00	227 ft.	52 1.1 GPM
26	2:15	225 ft.	52 1.1 GPM
27	2:30	223 ft.	52 1.1 GPM
28	2:45	221 ft.	52 1.1 GPM
29	3:00	219 ft.	52 1.1 GPM
30	3:15	ft.	GPM

Yield Test Data Sheet

County File # ~~2005-001~~

MD Well Permit #: ~~05-001-001~~

Subdivision Name: \_\_\_\_\_

Section \_\_\_\_\_ Lot # 3

Street Address: \_\_\_\_\_

Measuring Point (MP) Description: Top of casing  
(for ex. "Top of casing")

Distance from MP to ground surface 34 ft.

Well Depth 400' ft.

Well Driller: Allen Compton

Must be submitted with the State of Maryland Well Completion Report

Submit to: Carroll County Health Department  
Bureau of Environmental Health  
P.O. Box 845  
Westminster, MD 21158  
410-876-1884, 410-857-5009  
410-875-3385

NOTES:

Pump Start Time	Static Water level	Pumping Rate ( ) Time to fill 1 gal. bucket ( ) Flow meter reading (if used)	Calculated Flow (gallons per minute)
TIME	WATER LEVEL BELOW M.P.		
	<u>34</u> ft.	<u>4</u> sec.	<u>15</u>
Water level and pumping rate must be recorded every 15 minutes			
1	8:00	34 ft.	4 15 GPM
2	8:15	210 ft.	6 10 GPM
3	8:30	292 ft.	7 8.5 GPM
4	8:45	303 ft.	52 1.1 GPM
5	9:00	295 ft.	52 1.1 GPM
6	9:15	293 ft.	52 1.1 GPM
7	9:30	274 ft.	52 1.1 GPM
8	9:45	267 ft.	52 1.1 GPM
9	10:00	265 ft.	52 1.1 GPM
10	10:15	260 ft.	52 1.1 GPM
11	10:30	257 ft.	52 1.1 GPM
12	10:45	254 ft.	52 1.1 GPM
13	11:00	251 ft.	52 1.1 GPM
14	11:15	249 ft.	52 1.1 GPM
15	11:30	247 ft.	52 1.1 GPM
16	11:45	245 ft.	52 1.1 GPM
17	12:00	243 ft.	52 1.1 GPM
18	12:15	241 ft.	52 1.1 GPM
19	12:30	239 ft.	52 1.1 GPM
20	12:45	237 ft.	52 1.1 GPM
21	1:00	235 ft.	52 1.1 GPM
22	1:15	233 ft.	52 1.1 GPM
23	1:30	231 ft.	52 1.1 GPM
24	1:45	229 ft.	52 1.1 GPM
25	2:00	227 ft.	52 1.1 GPM
26	2:15	225 ft.	52 1.1 GPM
27	2:30	223 ft.	52 1.1 GPM
28	2:45	221 ft.	52 1.1 GPM
29	3:00	219 ft.	52 1.1 GPM
30	3:15	ft.	GPM

**Yield Test Data Sheet**

County File #                     

MD Well Permit #                     

Subdivision Name:                     

Section                      Lot # 4

Street Address: Ed Warfield Rd.

Measuring Point (MP) Description: Top of casing  
(for ex. "Top of casing")

Distance from MP to ground surface 34' ft.

Well Depth 400' ft.

Well Driller: Alan Compton

Must be submitted with the State of Maryland Well Completion Report

Submit to: Carroll County Health Department  
Bureau of Environmental Health  
P.O. Box 845  
Westminster, MD 21158  
410-876-1884, 410-857-5009  
410-875-3385

**NOTES:**

Pump Start Time	Static Water level: <u>34</u> ft.	Pumping Rate ( ) Time to fill <u>1</u> gal. bucket ( ) Flow meter reading (if used)	Calculated Flow (gallons per minute) <u>8.5</u>	
TIME	WATER LEVEL BELOW M.P.			
<b>Water level and pumping rate must be recorded every 15 minutes</b>				
1	8:00	34 ft.	7	8.5 GPM
2	8:15	132 ft.	8	7 GPM
3	8:30	160 ft.	10	6 GPM
4	8:45	171 ft.	45	1.3 GPM
5	9:00	164.2	45	1.3 GPM
6	9:15	161 ft.	45	1.3 GPM
7	9:30	159 ft.	45	1.3 GPM
8	9:45	158 ft.	45	1.3 GPM
9	10:00	157 ft.	45	1.3 GPM
10	10:15	155 ft.	45	1.3 GPM
11	10:30	152 ft.	45	1.3 GPM
12	10:45	150 ft.	45	1.3 GPM
13	11:00	149 ft.	45	1.3 GPM
14	11:15	149 ft.	45	1.3 GPM
15	11:30	148 ft.	45	1.3 GPM
16	11:45	148 ft.	45	1.3 GPM
17	12:00	147 ft.	45	1.3 GPM
18	12:15	147 ft.	45	1.3 GPM
19	12:30	147 ft.	45	1.3 GPM
20	12:45	147 ft.	45	1.3 GPM
21	1:00	147 ft.	45	1.3 GPM
22	1:15	147 ft.	45	1.3 GPM
23	1:30	147 ft.	45	1.3 GPM
24	1:45	147 ft.	45	1.3 GPM
25	2:00	147 ft.	45	1.3 GPM
26	2:15	146 ft.	45	1.3 GPM
27	2:30	146 ft.	45	1.3 GPM
28	2:45	146 ft.	45	1.3 GPM
29	3:00	146 ft.	45	1.3 GPM
30	3:15	ft.		GPM

24' INGRESS AND EGRESS EASEMENT

14' MAC. PAVING

Ch2  
Ch82

PROPERTY OF  
NI PROPERTY  
OF THIS SUBMISSION,  
PROPERTY SHOWN FOR  
PURPOSE ONLY  
(AGRICULTURAL LAND  
EASEMENT)  
PF FILE NO.

*hde #2*  
*4/8/05*  
*Will site*  
*staked by J, C*  
*on 4/7/05*

*BB*

PRIVATE 24' WIDE  
INGRESS, EGRESS,  
MAINTENANCE & UTILITY  
EASEMENT FOR THE USE  
AND BENEFIT OF LOTS  
1 THRU 4.

CLASS
B
B
B

SCALE  
1"=50'

PERC CERTIFICATE  
**MARIANI PR**

TAX MAP #13

LOTS 1 -  
ZONED: RC-DEO

