

6/13/01-10:00
6/13/02 11:00
02-210452

PERMIT

SEWAGE DISPOSAL SYSTEM
HOWARD COUNTY HEALTH DEPARTMENT
BUREAU OF ENVIRONMENTAL HEALTH
410-313-2640

P Repair
A 515270

ISSUE DATE 6/4/01

INDEXED

APPROVAL DATE 6/13/02

Mr. Rrjun Chanmugam (Hatfield's Equipment) IS PERMITTED TO INSTALL ALTER X

ADDRESS 3161 Edgwood Road PHONE 410-465-4607

SUBDIVISION _____ LOT NUMBER _____ ADDRESS 3161 Edgwood Road

PROPERTY OWNER Rrjun Chanmugam PROPERTY OWNER'S ADDRESS 3161 Edgwood Road

SEPTIC TANK CAPACITY existing GALLONS 1000-1250 gal @ 2ft

PUMP CHAMBER CAPACITY 1500 GALLONS Top Seamed (for extra storage when power is out - happens for 3-4 days at a time)

NUMBER OF BEDROOMS 3 (existing)

SQUARE FEET PER BEDROOM 180

LINEAR FEET OF TRENCH REQUIRED NA $\frac{1800 \text{ sqft} \times 3}{480 \text{ sqft} \div 10 \text{ ft liquid depth} = 48 \text{ sqft} / 4 \text{ in. trench} = 12' \text{ trench}}$

TRENCHES: one Dry well - 10ft liquid depth - Trenches to be 12 feet wide. Inlet 3 feet below original grade. Bottom maximum depth 13 feet below original grade. 10 feet of stone below distribution box. depth below sidewalk and dry well rings (preformed rings or concrete block are both acceptable).

LOCATION: OK to disconnect existing DW. or connect in parallel via Ball Valve so old dry well can be used after several years recovery (Carbon 10ft deep)

PURPOSE: The existing septic system has failed. Call for inspection when ground is opened so a sanitarian can recommend repair. 6/4/01

Front of lot suitable for dry well - inlet @

years recovery (Carbon 10ft deep)
6/13/01

PLANS APPROVED [Signature] DATE 6/13/01

PERMIT VOID AFTER 2 YEARS

NOTE: CONTRACTOR RESPONSIBLE FOR SCHEDULING A PRE-CONSTRUCTION INSPECTION FOR ALL INSTALLATIONS

NOTE: TOP OF SEPTIC TANKS ARE TO BE NO DEEPER THAN 3.0 FEET BELOW FINISH GRADE

NOTE: WATERTIGHT SEPTIC TANKS REQUIRED

NOTE: CLEANOUT REQUIRED EVERY 70 FEET OF SEWER LINE AND/OR AT 90° SWEEPS IN LINES FROM HOUSE TO DRAIN FIELDS, 90° ELBOWS ARE NOT ACCEPTABLE

NOTE: ALL PARTS OF SEPTIC SYSTEMS (I.E. TANK, DISTRIBUTION BOX, DRAINFIELDS) TO BE 100 FEET FROM ANY WATER WELL UNLESS OTHERWISE SPECIFICALLY AUTHORIZED

NOTE: NO ABSORPTION TRENCH TO EXCEED 100 FEET IN LENGTH UNLESS SPECIFICALLY AUTHORIZED

NOTE: ALL PIPE FROM HOUSE TO SEPTIC TANK MUST BE CAST IRON OR SCHEDULE 35/40 PVC OR ABS

NOTE: MANHOLE RISERS REQUIRED ON ALL SEPTIC TANKS AND PUMP CHAMBERS

NOTE: DISTRIBUTION BOXES MUST HAVE BAFFLES

NOTE: IF PUMPED SEPTIC SYSTEM REQUIRED, (1) SEPTIC PUMP DETAIL TO BE PROVIDED BY INSTALLER PRIOR TO ISSUANCE OF SEPTIC PERMIT (2) PUMP PERFORMANCE TEST IS NECESSARY PRIOR TO HEALTH DEPARTMENT APPROVAL OF SEPTIC PERMIT

NEITHER THE HOWARD COUNTY COUNCIL NOR THE HEALTH DEPARTMENT IS RESPONSIBLE FOR THE SUCCESSFUL OPERATION OF ANY SYSTEM
PERMITTEE RESPONSIBLE FOR OBTAINING FINAL APPROVAL ON THIS PERMIT
CALL 410-313-2640 FOR INSPECTION OF SEPTIC SYSTEM

4515270

Table B
 0-13" 10 1/2 4/3 L
 12" 38" 2.5 1/2 4/4
 26" 7" 7.5 1/2 5/4
 HSL-SL
 7/ grey/white
 -15" HSL-COSL

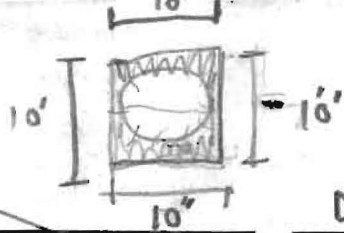

6/13/02
 New
 Drywell
 per Ron's
 specs

NOT TO SCALE

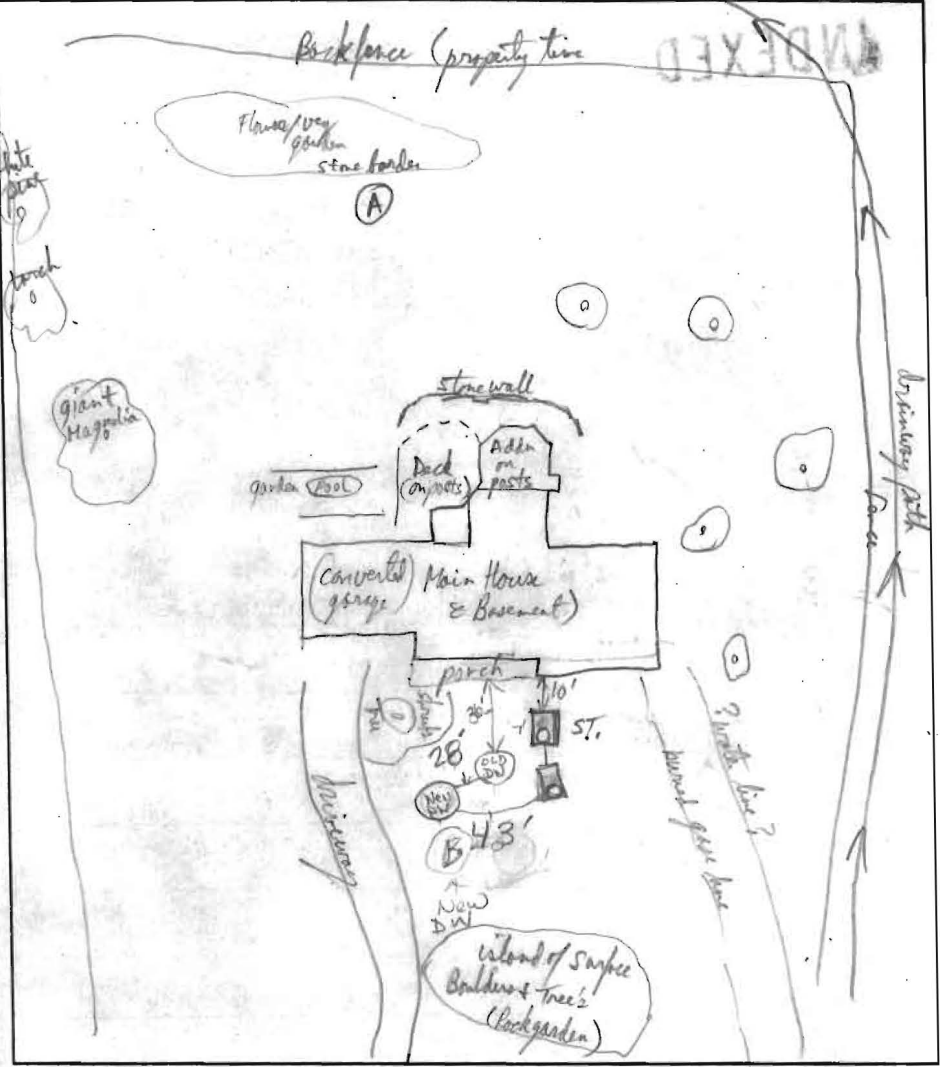

TRENCH DATA	excav.
D.W.	
TRENCH WIDTH	10'
NEW DW	
TRENCH INLET DEPTH	3'
D.W.	
TRENCH BOTTOM DEPTH	13'
DEPTH OF STONE	10'
NUMBER OF TRENCHES	NA
D.W.	
TOTAL TRENCH LENGTH	7'
ABSORBENT AREA	400ft ²
DISTRIBUTION BOX LEVEL	NA
BAFFLE IN DISTRIBUTION BOX	NA

New D.W. w/ C/O

SEPTIC TANK DATA	
New baffles Ex-midream	
SEPTIC TANK	1250 GALLONS
MANHOLE RISER	back
6 INCH INSPECTION PORT	N/A
PUMP CHAMBER DATA	
PUMP CHAMBER	(Fiberglass)
GALLONS	1500 T.S.
MANHOLE RISER	back
ALARM	yes
PUMP PERFORMANCE TEST	yes

PRE-CONSTRUCTION INSPECTION: area houses all on public water, many on public sewers. This residence isn't too low to get access to public sewers.

INSPECTION COMMENTS: Septic tank evidence of backing & clogging @ outlet Baffle (Terreotta T) - history of S.T. not being pumped (they thought dry well was S.T. & have been pumping that - Dry well was never full and inlet to DW is 7ft below grade - S.T. has 3 1/2 ft cover (large drain only loose soil (No Shrouding) S.T. doesn't appear to be covered and DW was serviced instead). Test hole A failed - Test hole B passed 6-13-02 5' drop from new d.w. to old d.w. Pump Chamber two floats #1 on/off, #2 alarm Pump works. Alarm & pump on same breaker - fix. Old D.W. 36' off porch in front of door. Roman

INSPECTOR Roman DATE SYSTEM APPROVED 6-13-02

Switched Alarm & labeled new breaker ✓ OK
 DW is 10' L x 13' Deep (KN)

**MARYLAND DEPT. OF THE ENVIRONMENT
 ONSITE SEWAGE DISPOSAL SYSTEM
 SITE EVALUATION REPORT
 SOIL PROFILE DESCRIPTION**

FILE NO.
 MD. GRID:
 TAX MAP/B/P:
 SUBDIVISION:
 DATE:
 BY:

LOT	SECTION						
DEPTH	TEXTURE	MATRIX COLOR	MOTTLES DESCRIPTION	STRUCTURE	CONSISTENCE	%ROCK BY VOL.	REMARKS (Caving, moisture, etc.)
HOLE A							
0-2"	hL	10YR 3/1-3/2	—	3c gran	mFr	—	Moist
2"-14"	L-hL	10YR 4/3	—	3c gran-fsbk	mFr	—	Moist CP-m roots
14"-24"	CL	10YR 5/6	E1F 10YR 4/3 (M ped. fbk)	2 m sbk	mFi	—	SL Moist (mod dense) Fm roots 2-3 m clay film
24"-38"	CL	Mix 10YR 5/6-5/4	E2F 10YR 5/3 (cap. fbk)	1 m sbk - 1 m pr	mLi	—	SL Moist dense
38"-48"	CL	Mix 10YR 4/4	E1A 7.5YR 5/6 (mottles) E1B 10YR 4/2 (grey) E2B 10YR 6/1 (grey)	1 c sbk - 1 m pr	mFi	—	SL Moist mod dense
48"-6'	hL	Mix 10YR 5/4 CIA 7.5YR 4/4	E2A 7.5YR 8/1 (grey) E2B 10YR 8/1 (grey)	1 c sbk - 1 m pr	mFi - mFr	—	SL Moist CP Blk Mn Fe conc. dense (mod)
6'-7 1/2'	Mica SL-csL	var. grey, whitest + tan	—	Massive ls	Saprolite mFr - LS	—	vi. Hicocem Moist caving @ 6-7' +
7 1/2'-11'	SL (Mica)	mit-dark grey + white	var. grey + white	"	Saprolite mFr - LS	—	Soils Moist + cool
11'-15'	scm - (Goidy)	—	—	—	—	—	concern of seasonal water table
15'-16'	(Mica) hL	10YR 6/3 pale tan	m2d 7.5YR 3/4 E1A 7.5YR 4/4 E2d 10YR 6/2	M-m	Massive Saprolite mFi - mFr	—	ve. moist - wet in grey/white Saprolite
Slope% - 4%		EL. (ft) -		Chroma 2 - 7.30 " Mottles		Least Permeable Layers - 14" - 6ft	
Landscape Position -		Water BLS -		Limiting Zones - Somewhat caving, but pumped seasonal w. Ti. grey Saprolite			
Additional Remarks -							

(Mottles) grey/white (Mottles)

TEST DATA

NAME Mr Arion Channing FILE NO Repair
 LOCATION 3161 Edgewood Rd COUNTY Howard
 DATE 6/13/01
 GRID _____ E
 RECORDED BY AP/infly _____ N

HOLE NO.	TEST NO.	DEPTH	CLOCK TIME	ELAPSED TIME	MEASUREMENT	REMARKS (Method, Moisture, Biopores)
(A)	VI6 ^{1/2}	6'	11:24:00 11:48:00 12:24 - 5' at 3rd Nail 12:40 <u>52 min</u>		Top Nail 3rd Nail 2nd Nail <u>Fail</u>	Slow pore & high water table
(B)	VI3	4'	12:14:01 12:22 Missed 12:24 <u>over 5 min</u>	2' fall	Top Nail 3rd Nail press	



DEPARTMENT OF PUBLIC WORKS
BUREAU OF UTILITIES

ROBERT M. BERINGER, BUREAU CHIEF

June 4, 2001

Mr. Rrjun Chanmugam
3161 Edgwood Rd
Ellicott City, MD 21043

Subject: Public Sewer Availability
3161 Edgewood Rd

Mr. Chanmugam:

This is to inform you that public sewer service is not available to the above subject property.

A review of the construction drawings indicate that the invert elevation of the public main within Edgewood Road is approximately 375' (fronting your property); the approximate service elevation requirement for the existing house is 369'. Therefore, we are unable to provide a gravity sewer house connection to serve the subject property.

If you have any questions, I can be contacted at 410-313-4943.

Sincerely,

John Schaeffer
Howard County
Bureau of Utilities

Ask for Waiver

8/22/06

Hammanna needs to write to request

hookup to

Ron Lepson

x 6140

public utility called 8/6/06

(SC)