

C1 7236

SEQUENCE NO. (MDE USE ONLY)

STATE OF MARYLAND WELL COMPLETION REPORT

THIS REPORT MUST BE SUBMITTED WITHIN 45 DAYS AFTER WELL IS COMPLETED.

(THIS NUMBER IS TO BE PUNCHED IN COLS. 3-6 ON ALL CARDS)

COUNTY NUMBER 13

ST/CO USE ONLY DATE Received

DATE WELL COMPLETED 04 30 05

Depth of Well 360

PERMIT NO. FROM "PERMIT TO DRILL WELL" 140-95-1751

OWNER: Feagan, Herald, William; STREET OR RFD: 2807 Wulf Ave; TOWN: Elkridge City; SUBDIVISION: Tennant House; SECTION: ; LOT: ;

WELL LOG Not required for driven wells

Table with columns: DESCRIPTION, FEET (FROM, TO), check if water bearing. Includes entries for Top Soil, Sandy Sandstone, Micka Sandstone, and Micka.

NUMBER OF UNSUCCESSFUL WELLS: 0

WELL HYDROFRACTURED: Y (Yes)

CIRCLE APPROPRIATE LETTER: A (Well was abandoned and sealed), E (Electric log obtained), P (Test well converted to production well)

I HEREBY CERTIFY THAT THIS WELL HAS BEEN CONSTRUCTED IN ACCORDANCE WITH COMAR 26.04.04 "WELL CONSTRUCTION" AND IN CONFORMANCE WITH ALL CONDITIONS STATED IN THE ABOVE CAPTIONED PERMIT...

DRILLERS LIC. NO. 1 M SD 112; DRILLERS SIGNATURE: [Signature]; LIC. NO. 1 D

SITE SUPERVISOR (sign. of driller or journeyman responsible for sitework if different from permittee)

GROUTING RECORD

WELL HAS BEEN GROUTED (Y) (N); TYPE OF GROUTING MATERIAL: CEMENT (CM), BENTONITE CLAY (BC); NO. OF BAGS: 15; NO. OF POUNDS: 1500; GALLONS OF WATER: 90; DEPTH OF GROUT SEAL: 0 to 50 mcs.

CASING RECORD

MAIN CASING TYPE: PL (Plastic); Nominal diameter top (main) casing: 6; Total depth of main casing: 55

OTHER CASING (if used): diameter inch, depth (feet) from to

SCREEN RECORD

screen type or open hole: HO (Open Hole); insert appropriate code below

DEPTH (nearest ft.): HO 53, 360

Table with columns: E A C H S R E E N, 8-11, 15-17, 21-24, 26-30, 32-36, 38-41, 45-47, 51-53; SLOT SIZE 1, 2, 3; DIAMETER OF SCREEN: 56, 60

GRAVEL PACK IF WELL DRILLED WAS FLOWING WELL INSERT F IN BOX 68

MDE USE ONLY (NOT TO BE FILLED IN BY DRILLER) T (E.R.O.S.) W Q; TELESCOPE CASING, LOG INDICATOR, OTHER DATA

PUMPING TEST

HOURS PUMPED (nearest hour): 4; PUMPING RATE (gal. per min.): 11; METHOD USED TO MEASURE PUMPING RATE: Bucket; WATER LEVEL (distance from land surface) BEFORE PUMPING: 60 ft; WHEN PUMPING: 360 ft; TYPE OF PUMP USED: A (air), P (piston), T (turbine), C (centrifugal), R (rotary), O (other), J (jet), S (submersible)

PUMP INSTALLED

DRILLER INSTALLED PUMP (CIRCLE) (YES or NO) YES; IF DRILLER INSTALLS PUMP, THIS SECTION MUST BE COMPLETED FOR ALL WELLS.

TYPE OF PUMP INSTALLED PLACE (A,C,J,P,R,S,T,O) IN BOX 29.

CAPACITY: GALLONS PER MINUTE (to nearest gallon) 31 35

PUMP HORSE POWER 37 41

PUMP COLUMN LENGTH (nearest ft.) 43 47

CASING HEIGHT (circle appropriate box and enter casing height) + above, - below; LAND SURFACE 2 (nearest foot)

LOCATION OF WELL ON LOT

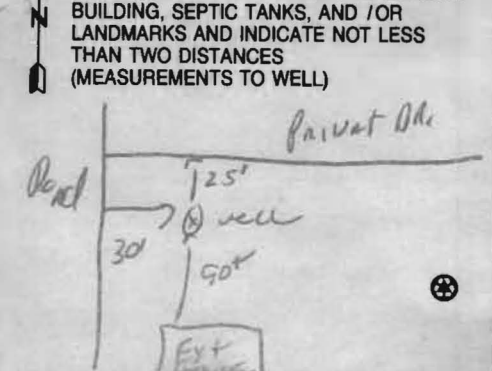

B 1 0855

SEQUENCE NO. (MDE USE ONLY)

STATE OF MARYLAND APPLICATION FOR PERMIT TO DRILL WELL 530964 please type

STATE PERMIT NUMBER 140 - 95 - 1751 fill in this form completely

OWNER INFORMATION Date Received (APA) 8 MM DD YY 13 MERRY ACRES FARM LLC 15 Last Name Owner First Name 34 3807 WALT ANN DR. 36 Street or RFD 55 ELLICOTT CITY MD. 21042 57 Town 70 State 72 Zip 76

LOCATION OF WELL B 3 HOWARD 8 COUNTY 21 3807 WALT ANN DR. 23 SUBDIVISION 42 SECTION 44 46 LOT 48 50 GLENELG 52 NEAREST TOWN 71 MILES FROM TOWN (enter 0 if in town) 73 I M I 76 77 78

DRILLER INFORMATION RALPH E. MAYNE M SD 117 76 Driller's Name License No. 81 RALPH E. MAYNE INC 41 Firm Name 17024 Handy Rd. Mt Airy MD. 21771 41 Address 2285 [Signature] 4/9/09 41 Signature Date

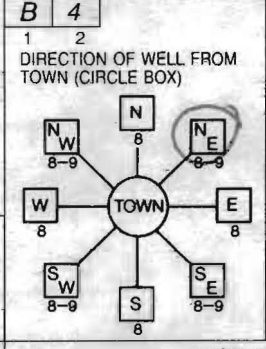

WALT ANN DR. 11 NEAR WHAT ROAD 30 ON WHICH SIDE OF ROAD (CIRCLE APPROPRIATE BOX) NORTH 34 40 37 SOUTH 38 39 DISTANCE FROM ROAD ENTER FT OR MI TAX MAP: 22 BLK: 16 PARCEL 80

WELL INFORMATION B 2 APPROX. PUMPING RATE (GAL. PER MIN.) 5 8 12 AVERAGE DAILY QUANTITY NEEDED (GAL. PER DAY) 500 14 20

USE FOR WATER (CIRCLE APPROPRIATE BOX) D DOMESTIC POTABLE SUPPLY & RESIDENTIAL IRRIGATION F FARMING (LIVESTOCK WATERING & AGRICULTURAL IRRIGATION) I INDUSTRIAL, COMMERCIAL, DEWATERING P PUBLIC WATER SUPPLY WELL T TEST, OBSERVATION, MONITORING G GEO-THERMAL

NOT TO BE FILLED IN BY DRILLER HEALTH DEPARTMENT APPROVAL HOWARD 13 COUNTY NAME COUNTY NO. STATE SIGNATURE INSERT S DATE ISSUED 4-8-09 41 CO SIGNATURE EXP. DATE 4-8-10 43 MM DD YY 48 NORTH GRID 521 000 EAST GRID 0809 000 50 55 57 63

APPROXIMATE DEPTH OF WELL 150 24 28 FEET APPROXIMATE DIAMETER OF WELL 6 61 NEAREST INCH

METHOD OF DRILLING (circle one) BORED (or Augered) JETTED Jetted & DRIVEN 30 AIR-ROtary AIR-PERcussion ROTARY (Hydraulic Rotary) 37 CABLE REVerse-ROtary DRive-POINT other

REPLACEMENT OR DEEPEINED WELLS (CIRCLE APPROPRIATE BOX) N THIS WELL WILL NOT REPLACE AN EXISTING WELL Y THIS WELL WILL REPLACE A WELL THAT WILL BE ABANDONED AND SEALED 39 S THIS WELL WILL REPLACE A WELL THAT WILL BE USED AS A STANDBY-CONTACT LOCAL APPROVING AUTHORITY FOR POLICY ON STANDBY WELLS D THIS WELL WILL DEEPEIN AN EXISTING WELL PERMIT NUMBER OF WELL TO BE REPLACED OR DEEPEINED (IF AVAILABLE) 41 52

Not to be filled in by driller (MDE OR COUNTY USE ONLY) APPROP. PERMIT NUMBER G PERMIT No. 140 - 95 - 1751 70 71 72 73 74 75 76 77 78 79

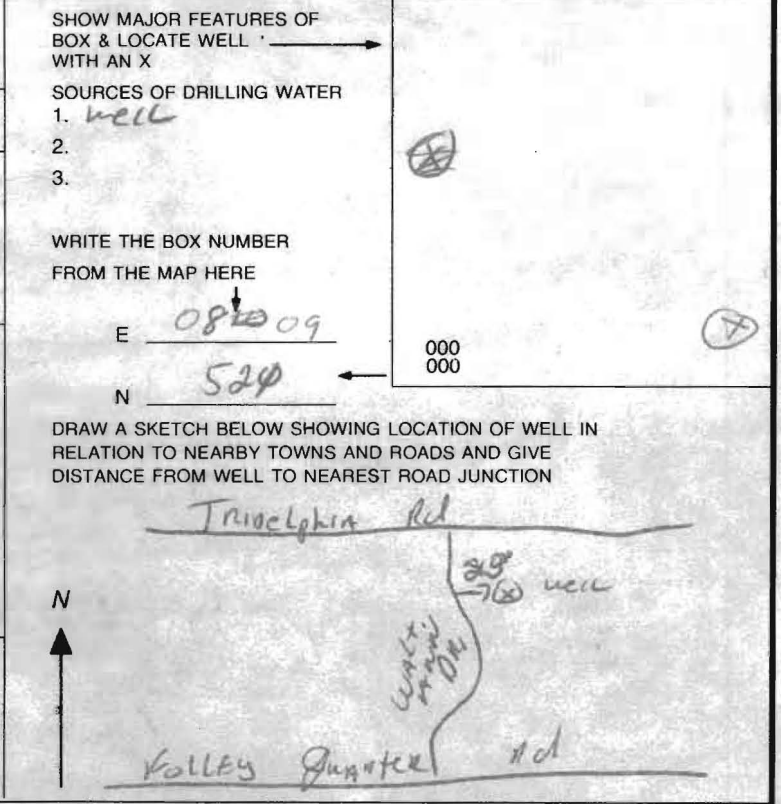

SPECIAL CONDITIONS For well (PT) to be sealed per COMAR NOTE - APPROVING AUTHORITIES SHOULD USE SEPARATE SHEET IF NEEDED.

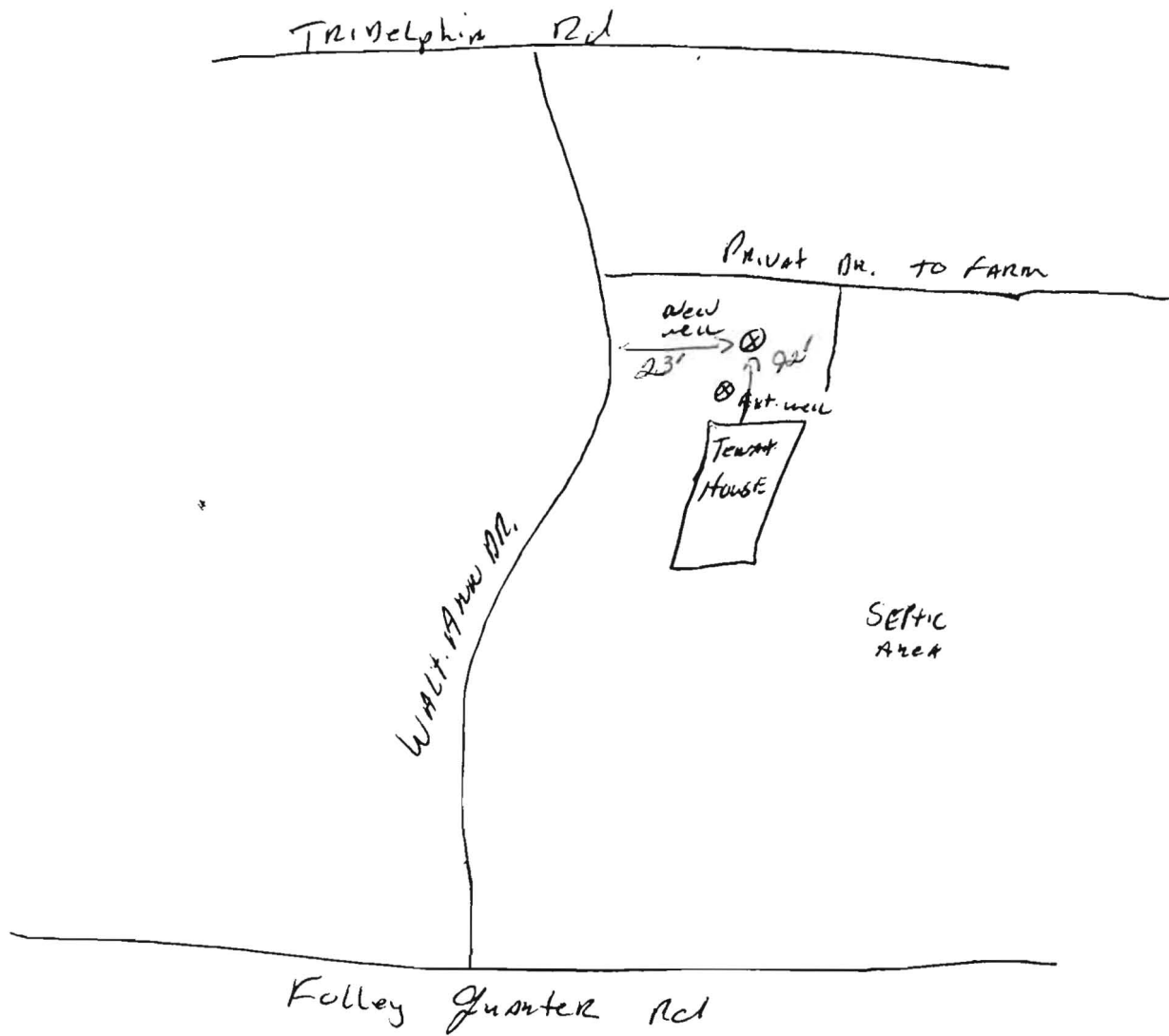

new well for Tenant House at 3807 Walt. Ann Dr.
 Merry Acres Farm LLC
 3807 Walt. Ann Dr.
 Ellicott City MD. 21042

Penny E. Borenstein, M.D., M.P.H., Health Officer

ATTENTION WELL DRILLERS!!!

When submitting a well application for a new or replacement well, please indicate one of the following:

- The well site has been staked by owner on 4/9/09 and is ready for site inspection.
- _____ will call the Health Department for a time to meet in the field to verify a well location.
- Site plan for new well is attached to well permit application.

Please attach this sheet when submitting your green application. This should help improve communication allowing a more timely service for our citizens.

KN Well owner - merry ACRES FARM LLC

Well Sub - 3805 WALT. ANN DR.

Well Lot # 2/A.

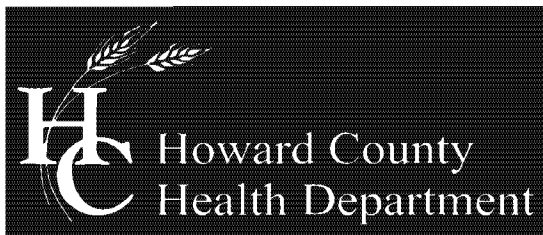

Bureau of Environmental Health

8930 Stanford Blvd, Columbia, MD 21045
Main: 410-313-2640 | Fax: 410-313-2648
TDD 410-313-2323 | Toll Free 1-866-313-6300
www.hchealth.org

Maura J. Rossman, M.D., Health Officer

February 12, 2016

William Harold Feaga
3807 Walt Ann Drive
Ellicott City, MD 21042

RE: **Old well abandonment**
3805 Walt Ann Drive

Dear Mr. Feaga,

According to our records, Ralph Mayne drilled a replacement well at 3805 Walt Ann Drive in 2009. The Health Department never received documentation that the old well was sealed. The old pit well must be abandoned and sealed by a licensed well driller as per *COMAR 26.04.04.34*.

A pit well can lead to the entrapment of people or animals in the vicinity of the well. Additionally, a well not in use can contribute to pollution of groundwater and pose a risk to people drinking water in the area. Documentation should be submitted by the driller the Health Department showing the well has been abandoned and sealed.

Feel free to contact me with any questions.

Sincerely,

A handwritten signature in cursive script that reads 'Sarah Collins'.

Sarah Collins, L.E.H.S.
Howard County Health Department
Well and Septic Program
SCollins@howardcountymd.gov
410-313-6287

Cc: File