



Howard County
Health Department

7178 Columbia Gateway Drive, Columbia MD 21046
(410) 313-2640 Fax (410) 313-2648
TDD (410) 313-2323 Toll Free 1-866-313-6300
website: www.hchealth.org

Peter L. Beilenson, M.D., M.P.H., Health Officer

MEMORANDUM

TO: Charles Crocken
Charles R. Crocken & Assoc.

FROM: Heidi Scott
Well and Septic Program
Development Coordination Section

RE: Percolation Certification Plan
13898 Forsythe Rd.

DATE: August 19th, 2008

The following comments apply to the above referenced plan. Please revise and resubmit prior to signature:

- Add the note "Any changes to a sewage easement shall require a revised percolation certification plan"
- Add approximate original perc test locations (enclosed, all tests passed)
- Remove portion of septic area within the 100' well radius. Label parts of original septic area to be removed and show area to be added if necessary
- Label soil units per the enclosed soil map sheet from Howard County data (reflects most recent soil survey)

HS
Cc:
File



SOILS LEGEND		
SYMBOL	NAME/DESCRIPTION	SOIL GROUP
G1B2	GLENELG LOAM 3-8% SLOPE	B
G1C2	GLENELG LOAM 8-15% SLOPE	B
EKB2	ELIDAK SILT LOAM 3-8% SLOPE	B
GNB2	GLENVILLE SILT LOAM 3-8% SLOPE	C
M1E	MANOR LOAM 25-45% SLOPE	B

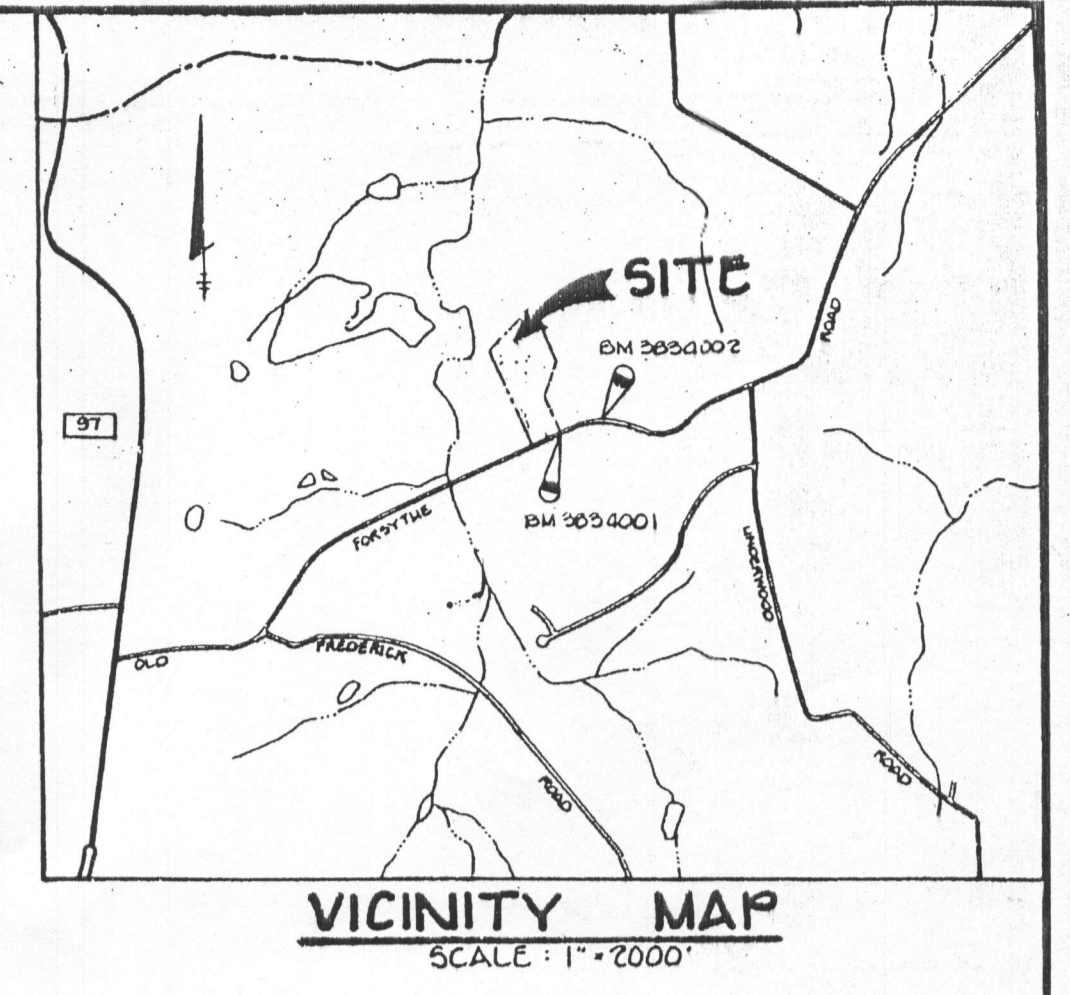

GENERAL NOTES:

1. Area of Property = 4.49 acres +/-
2. Existing Use = Single Family Residential
3. Proposed Use = Single Family Residential
4. Number of Units Allowed = 1 Unit
5. Number of Units Proposed = 1 Unit
6. Topography based upon aerial topography provided by Howard County and verified in the field by CRC & Assoc. August 12, 2008.
7. Boundary shown here on based upon Current Deed Liber Folio 656 And Plat # 7894.
8. Service: Water = Private, Sewer = Private
9. Soils based upon Howard County Soil Survey Map No. 3863
10. There are no streams, wetlands or steep slopes in the vicinity of the sewage easement except as shown hereon.
11. No additional subdivision of subject property is required for a Building Permit.

HEALTH DEPARTMENT NOTES

1. The lot shown hereon complies with the minimum ownership, width and area required by the Maryland Department of the Environment.
2. This area designates a private sewage easement of 10,000 sq. ft. As required by the Maryland Department of the Environment for Individual sewage disposal. Improvements of any nature in this area are restricted until public sewage is available. These easements shall become null and void upon Connection to a public sewage system. The county Health Officer shall have authority to grant variances for encroachments into the private sewage easements. Recordation of a modified sewage easement shall not be necessary.
3. The existing well shown here on was drilled under a permit.
4. There are no existing wells and septic systems within 100 ft. of the lot lines shown hereon unless noted otherwise.
 - Denotes satisfactory percolation test
 - Denotes unsatisfactory percolation test
5. The nearest water intake structure is five miles +/- away.
6. There are no 25% or steeper slopes located within 200' +/- of the Proposed sewage disposal area.
7. Any change to the sewage easement shown hereon shall require a Revised percolation certification plan.

SITE ANALYSIS
 Area of Lot = 4.49 acres +/-
 As per the Master Plan of Howard County the present Zoning = RC-DEO
 Existing Use = Single Family Residential
 Proposed Use = Single Family Residential
 Number of Units Allowed = 1
 Number of Units Provided = 1
 Open Space on Site = N/A
 Howard County File No. =

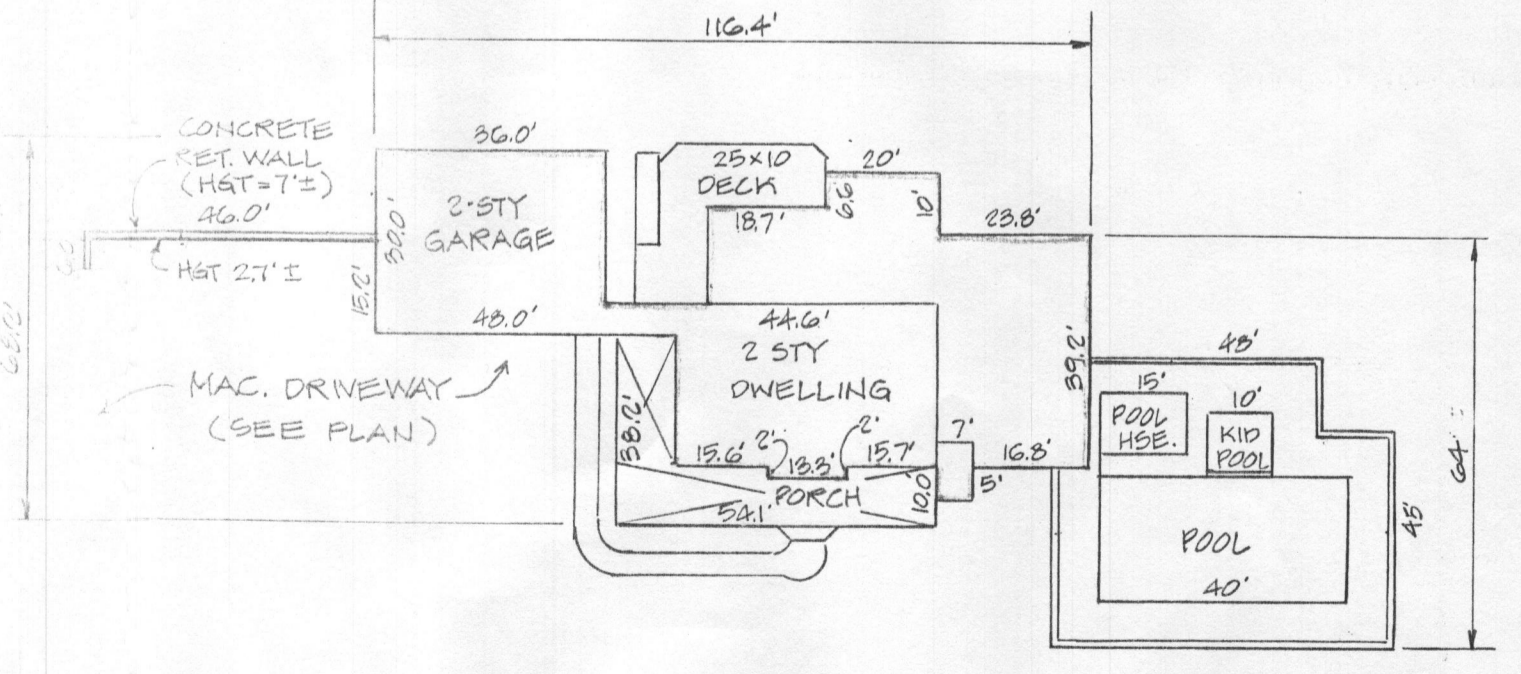

HOUSE DETAIL
Scale 1" = 20'

PLOT PLAN

APPROVED FOR PRIVATE WATER AND PRIVATE SEWERAGE SYSTEMS

By: *Barbara P. Peter* 10/8/2008
 HOWARD COUNTY HEALTH OFFICER HS DATE

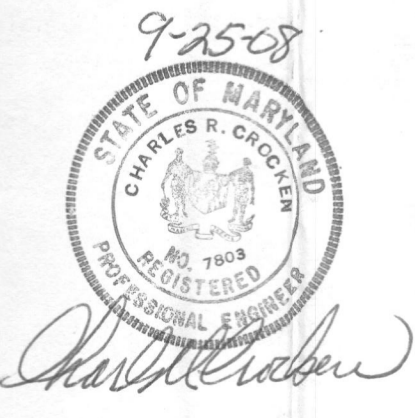

NO.	DATE	REVISION
PERCOLATION CERTIFICATION PLAN FOR RICKER PROPERTY		
13898 FORSYTHE ROAD LOT #1		
SINGLE FAMILY DETACHED DWELLING		
TAX MAP 9, GRID 1, PARCEL 63		ZONED RC-DEO
4 TH. ELECTION DIST. 8/14/08		HOWARD COUNTY, MARYLAND
OWNER/DEVELOPER DANIEL N. & JENNIE A. RICKER		
13898 FORSYTHE ROAD SYKESVILLE, MD 21784		
Tel. 410-44202421		
CHARLES R. CROCKEN & ASSOC. INC. 902 LEE AVE SYKESVILLE, MD 21784		SCALE: 1" = 50'
Tel. 410-549-2708 Fax. 410-549-9063		SHEET: 1 OF 1



SOILS LEGEND		
SYMBOL	NAME/DESCRIPTION	SOIL GROUP
G1B2	GLENELG LOAM 3-8% SLOPE	B
G1C2	GLENELG LOAM 8-15% SLOPE	B
E1B2	ELIQUAK SILT LOAM 3-8% SLOPE	B
G1B2	GLENVILLE SILT LOAM 3-8% SLOPE	C
M1E	MANOR LOAM 25-45% SLOPE	B

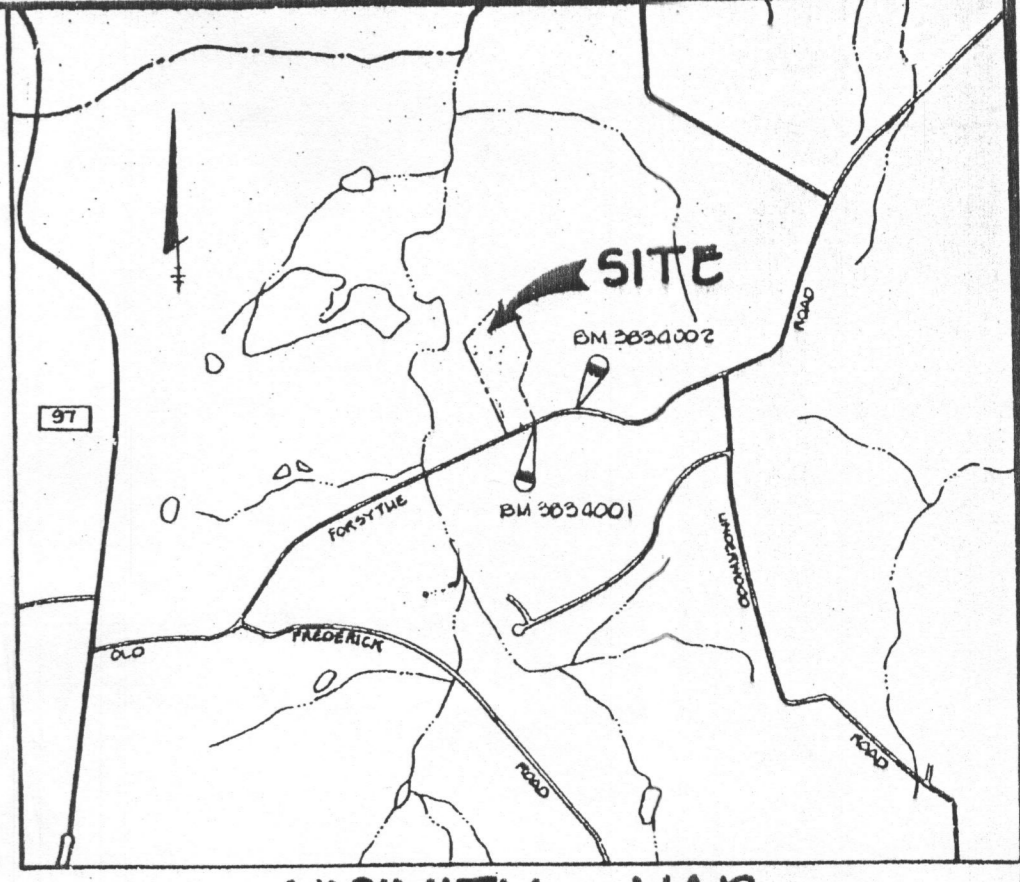

GENERAL NOTES:

1. Area of Property = 4.49 acres +/-
2. Existing Use = Single Family Residential
3. Proposed Use = Single Family Residential
4. Number of Units Allowed = 1 Unit
5. Number of Units Proposed = 1 Unit
6. Topography based upon aerial topography provided by Howard County and verified in the field by CRC & Assoc. August 12, 2008.
7. Boundary shown here on based upon Current Deed Liber Folio 656 And Plat # 7894.
8. Service: Water = Private, Sewer = Private
9. Soils based upon Howard County Soil Survey Map No. 3863
10. There are no streams, wetlands or steep slopes in the vicinity of the sewage easement except as shown hereon.
11. No additional subdivision of subject property is required for a Building Permit.

HEALTH DEPARTMENT NOTES

1. The lot shown hereon complies with the minimum ownership, width and area required by the Maryland Department of the Environment.
2. This area designates a private sewage easement of 10,000 sq. ft. As required by the Maryland Department of the Environment for individual sewage disposal. Improvements of any nature in this area are restricted until public sewage is available. These easements shall become null and void upon connection to a public sewage system. The county Health Officer shall have authority to grant variances for encroachments into the private sewage easements. Recordation of a modified sewage easement shall not be necessary.
3. The existing well shown here on was drilled under a permit.
4. There are no existing wells and septic systems within 100 ft. of the lot lines shown hereon unless noted otherwise.
 - Denotes satisfactory percolation test
 - Denotes unsatisfactory percolation test
5. The nearest water intake structure is five miles +/- away.
6. There are no 25% or steeper slopes located within 200' +/- of the Proposed sewage disposal area.
7. Any change to the sewage easement shown hereon shall require a Revised percolation certification plan.

SITE ANALYSIS

Area of Lot = 4.49 acres +/-
 As per the Master Plan of Howard County the present Zoning = RC-DEO
 Existing Use = Single Family Residential
 Proposed Use = Single Family Residential
 Number of Units Allowed = 1
 Number of Units Provided = 1
 Open Space on Site = N/A
 Howard County File No. =

PLOT PLAN

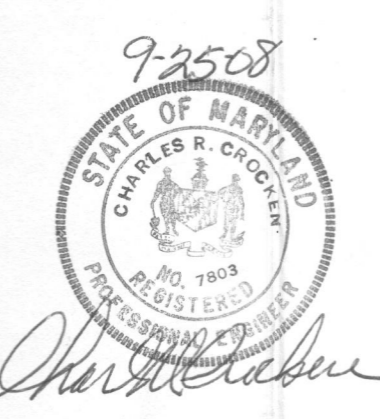
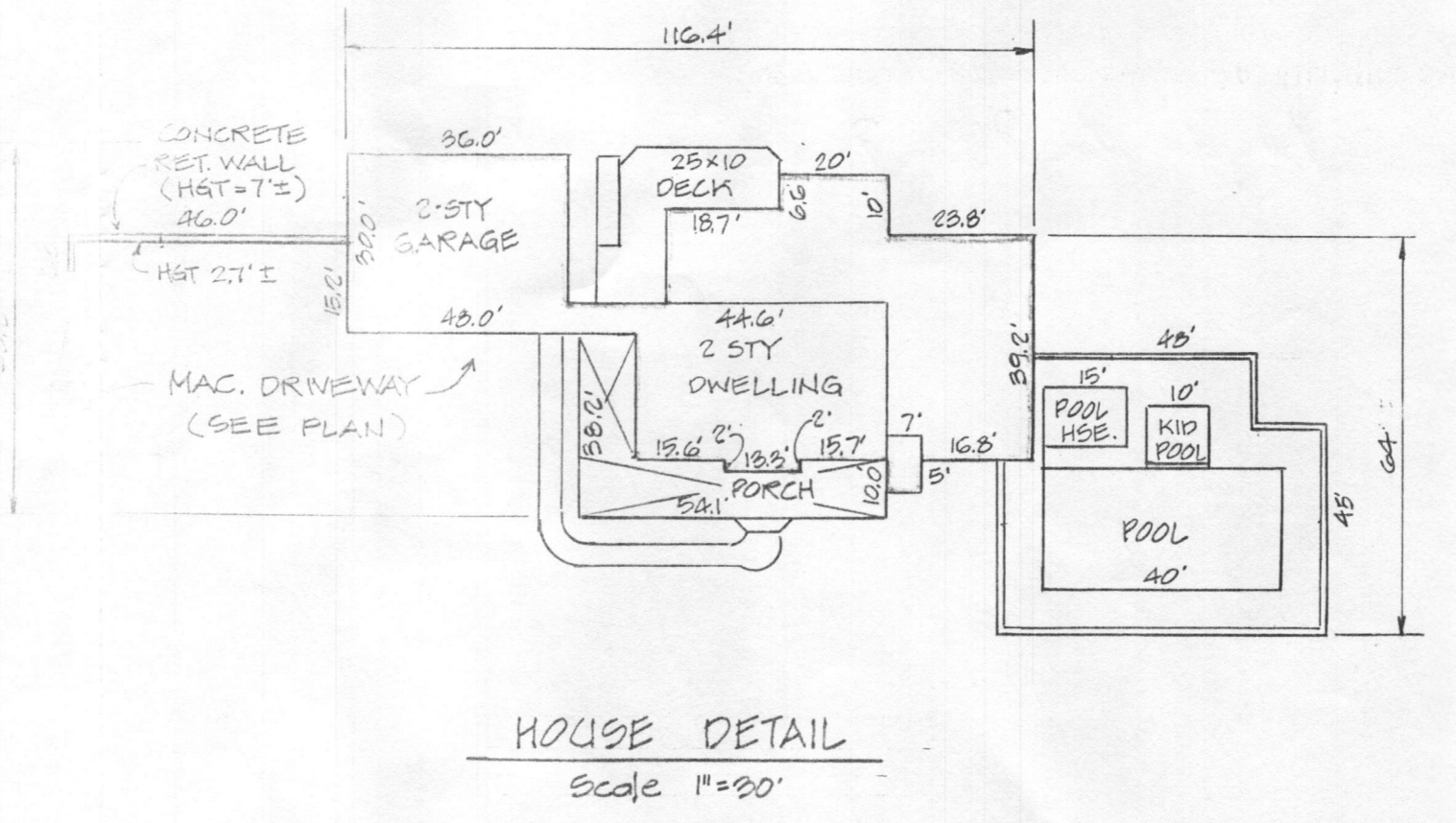

APPROVED FOR PRIVATE WATER AND PRIVATE SEWERAGE SYSTEMS
B. Wilson for Peter Brilenson 10/8/2008
 HOWARD COUNTY HEALTH OFFICER VB DATE 10/8/08

NO.	DATE	REVISION

PERCOLATION CERTIFICATION PLAN
 FOR
RICKER PROPERTY
 13898 FORSYTHE ROAD
 LOT #1
 SINGLE FAMILY DETACHED DWELLING
 TAX MAP 9, GRID 1, PARCEL 63 ZONED RC-DEO
 4 TH. ELECTION DIST. 8/14/08 HOWARD COUNTY, MARYLAND

OWNER/DEVELOPER
 DANIEL N. & JENNIE A. RICKER
 13898 FORSYTHE ROAD
 SYKESVILLE, MD 21784
 Tel. 410-44202421

CHARLES R. CROCKEN & ASSOC. INC.
 902 LEE AVE SYKESVILLE, MD 21784
 Tel. 410-549-2708 Fax. 410-549-9063

SCALE: 1" = 50' SHEET: 1 OF 1

CHARLES R. CROCKEN & ASSOCIATES, INC.

Civil Engineering and Land Planning
 902 Lee Avenue Sykesville, MD 21784
 Tel. (410) 549-2708 Fax. (410) 549-9063

LETTER OF TRANSMITTAL

DATE	8-14-08	JOB NO.
ATTENTION	HIEDI SCOTT	
RE:	RICKER PROPERTY 13898 FORSYTHE RD.	

TO HOWARD COUNTY HEALTH DEPT
ENVIRONMENTAL HEALTH
7178 COLUMBIA GATEWAY DRIVE
COLUMBIA, MD. 21046

GENTLEMEN:

WE ARE SENDING YOU Attached Under separate cover via _____ the following items:
 Shop drawings Prints Plans Samples Specifications
 Copy of letter Change order _____

COPIES	DATE	NO.	DESCRIPTION
4	8/14	1	PERCOLATION TEST CERTIFICATION

THESE ARE TRANSMITTED as checked below:

- For approval Approved as submitted Resubmit _____ copies for approval
- For your use Approved as noted Submit _____ copies for distribution
- As requested Returned for corrections Return _____ corrected prints
- For review and comment _____
- FOR BIDS DUE _____ 19_____ PRINTS RETURNED AFTER LOAN TO US

REMARKS

CRC PREPARED PLAN UTILIZING INFORMATION & TOPO RECEIVED FROM HEALTH DEPT AND FIELD INSPECTION BY CRC 8/12/08. IN AN ATTEMPT TO MEET THE DEADLINE OF 8/15/08 CRC AS PREPARED THE ABOVE PLANS - WE HAVE NOT VERIFIED LOCATION OF ALL ADJOINERS, HOWEVER, CONDITIONS IN THE FIELD APPEAR TO AGREE WITH HEALTH DEPT. INFORMATION.

COPY TO DAN RICKER/PATASCOT HOMES

SIGNED: [Signature]