

LAYOUT 4/16/07 INSP 4 \_\_\_\_\_  
INSP 2 \_\_\_\_\_ INSP 5 \_\_\_\_\_  
INSP 3 \_\_\_\_\_ INSP 6 \_\_\_\_\_

ISSUE DATE: 04/12/2007

APPROVAL DATE: 4/17/07

# PERMIT

UPGRADE

P 526635

A \_\_\_\_\_

TAX ID # 04-352432

**ON-SITE SEWAGE DISPOSAL SYSTEM  
HOWARD COUNTY HEALTH DEPARTMENT  
BUREAU OF ENVIRONMENTAL HEALTH**

Charlie's Bobcat Service Inc IS PERMITTED TO INSTALL  ALTER

ADDRESS: 13 Energetic Endeavor Drive PHONE NUMBER: 410-549-8020

SUBDIVISION: St. Michaels Overlook LOT NUMBER: 2

ADDRESS: 2884 Florence Road PROPERTY OWNER: Christina Mayhew

SEPTIC TANK CAPACITY (GALLONS): 2000 OUTLET BAFFLE FILTER REQUIRED

PUMP CHAMBER CAPACITY (GALLONS): \_\_\_\_\_ COMPARTMENTED TANK REQUIRED

NUMBER OF BEDROOMS: 4

SQUARE FEET PER BEDROOM: \_\_\_\_\_

LINEAR FEET OF TRENCH REQUIRED: \_\_\_\_\_

TRENCHES:	Trench to be feet wide. Inlet feet below original grade. Bottom maximum depth feet below original grade. Effective area begins at feet below original grade. feet of stone below distribution pipe.
LOCATION:	Tank replacement only--to support upcoming building permit
NOTES:	A 1,000 gallon piggy-back tank can be added if there is space available, otherwise a new 2,000 gallon tank will be needed. Call for a layout inspection prior to installation.

PLANS APPROVED: Sara Fegel DATE: 4/9/2007

- NOTE: PERMIT VOID AFTER 2 YEARS
- NOTE: CONTRACTOR RESPONSIBLE FOR SCHEDULING A PRE-CONSTRUCTION INSPECTION FOR ALL INSTALLATIONS
- NOTE: WATERTIGHT SEPTIC TANKS REQUIRED
- NOTE: ALL PARTS OF SEPTIC SYSTEM SHALL BE 100 FEET FROM ANY WATER WELL
- NOTE: MANHOLE RISERS REQUIRED ON ALL SEPTIC TANKS AND PUMP CHAMBERS UNLESS SPECIFICALLY AUTHORIZED

**NEITHER THE HOWARD COUNTY COUNCIL NOR THE HEALTH DEPARTMENT IS  
RESPONSIBLE FOR THE SUCCESSFUL OPERATION OF ANY SYSTEM  
PERMITTEE RESPONSIBLE FOR OBTAINING FINAL APPROVAL ON THIS PERMIT  
CALL 410-313-1771 FOR INSPECTION OF SEPTIC SYSTEM**

HO-92-0179

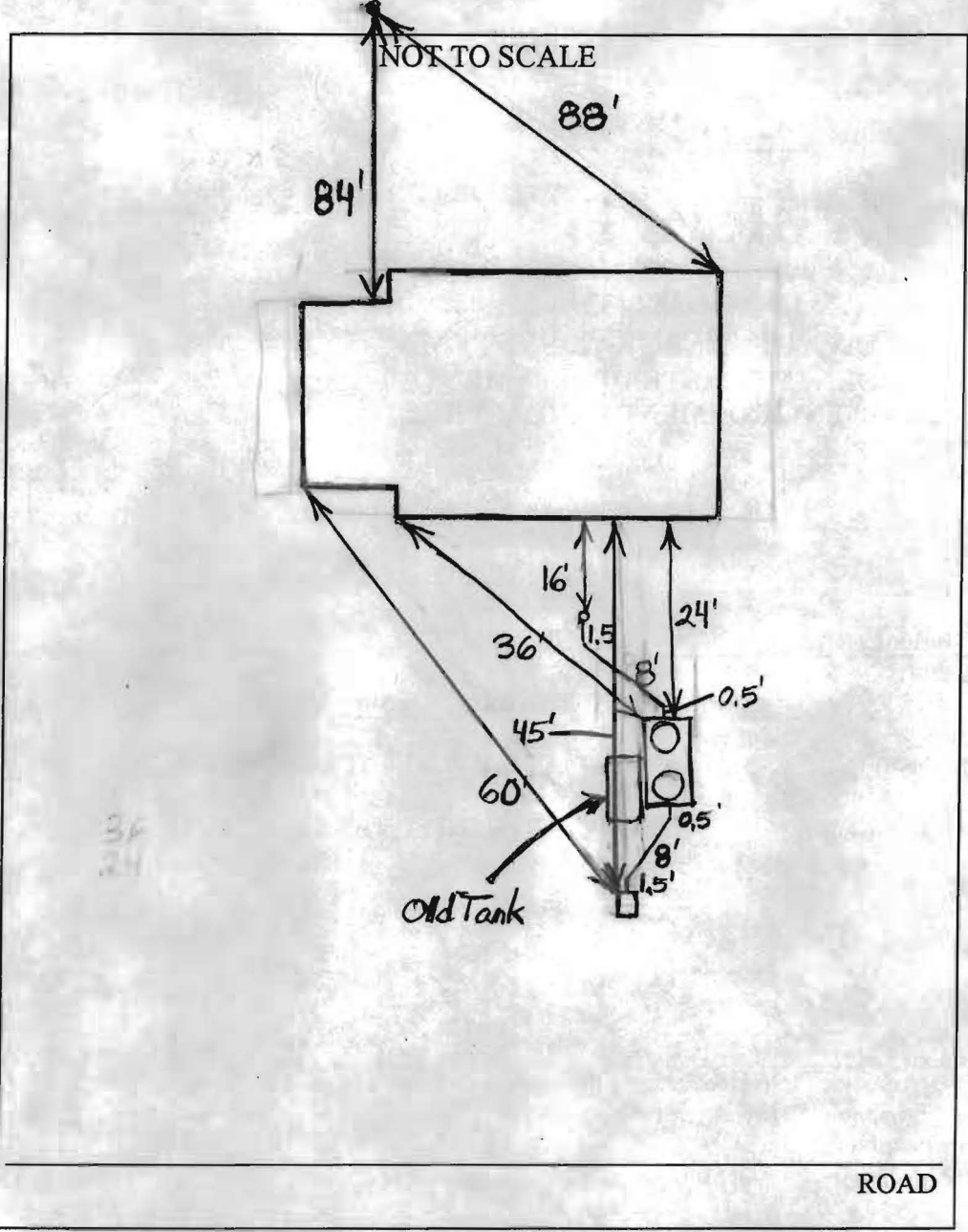

TRENCH/DRAINFIELD DATA		
WIDTH	INLET	BOTTOM
_____	_____	_____
NUMBER OF TRENCHES _____		
TOTAL LENGTH _____		
ABSORPTION AREA _____		
DISTRIBUTION BOX LEVEL _____		
DISTRIBUTION BOX BAFFLE _____		
DISTRIBUTION BOX PORT <u>No</u>		

SEPTIC TANK DATA	
SEPTIC TANK 1 LEVEL	<u>Yes</u>
CAPACITY	<u>2000</u> GAL
SEAM LOC	<u>Top</u>
TANK LID DEPTH	<u>2-5'</u>
BAFFLES	<u>Yes</u>
BAFFLE FILTER	<u>No</u>
MANHOLE LOC	<u>Front+Rear</u>
6" PORT LOC	<u>None</u>
WATERTIGHT TEST	<u>No</u>
SEPTIC TANK 2 LEVEL	<u>N/A</u>
CAPACITY	_____ GAL
SEAM LOC	_____
TANK LID DEPTH	_____
BAFFLES	_____
BAFFLE FILTER	_____
MANHOLE LOC	_____
6" PORT LOC	_____
WATERTIGHT TEST	_____

PRE-CONSTRUCTION 4/16/07 O.K. to install new 2000 tank next to existing tank. Keep tank as shallow as possible. (BB)

INSTALLATION 4/17/07 Tank set and connections made. Old tank pumped out and filled in. O.K. to backfill. (BB)

FINAL INSPECTOR B. Baker DATE OF APPROVAL 4/17/07