

6/2/78 - copied F.S.

# PERMIT

SEWAGE DISPOSAL SYSTEM

MARYLAND STATE DEPARTMENT OF HEALTH

HOWARD COUNTY

P 27246

A 16594

ELLICOTT CITY

DISTRICT 4th

DATE 11/18/77

**INDEXED**

James Wolbert IS PERMITTED TO INSTALL  ALTER

ADDRESS 5466 Mineral Hill Road, Sykesville, Md. 21784 PHONE 795-5223

A SEWAGE DISPOSAL SYSTEM LOCATED AT

SUBDIVISION ROAD Route 144 LOT

PROPERTY OWNER James Wolbert

ADDRESS same as above

SPECIFICATIONS 3 bedrooms

DRAIN FIELD DEPTH FEET, BOTTOM AREA SQ. FT.

SEEPAGE PITS ABSORBENT SIDE-WALL AREA SQ. FT.

SEPTIC TANK CAPACITY 1000 GALLONS

FOR GARBAGE GRINDER, INCREASE DISPOSAL AREA 22% & TANK CAPACITY 50%.

OTHER DRY WELL - 125 sq. ft. sidewall area per bedroom to begin below the inlet with the dry well inlet no deeper than 4 1/2 ft. and the bottom of the dry well no deeper than 12 ft. below original grade. Place the dry well 194 ft. from the back lot line and 55 ft. from the left side of the lot as seen when facing the lot from Route 144.

NOTE: ALL PIPE FROM HOUSE TO DISPOSAL AREA MUST BE CAST IRON.

NOTE: NO DRY WELL IS TO EXCEED 15 FOOT IN DIAMETER.

PERMIT VOID AFTER THREE YEARS.

NOTE: INSTALL STAND PIPE ON SEPTIC TANK AND DRY WELL. STAND PIPES MUST BE 6 INCHES IN DIAMETER. CAST IRON, CONCRETE OR TERRA COTTA ACCEPTED.

PLANS APPROVED BY Raymond Hodges DATE 12/21/71

FILL SEPTIC TANK AND DISTRIBUTION BOX WITH WATER BEFORE CALLING FOR AN INSPECTION. COVER NO WORK UNTIL INSPECTED AND APPROVED.

NEITHER THE HOWARD COUNTY COMMISSIONERS NOR THE HEALTH DEPARTMENT IS RESPONSIBLE FOR THE SUCCESSFUL OPERATION OF ANY SYSTEM.

A 16594

DATE PERMIT APPROVED

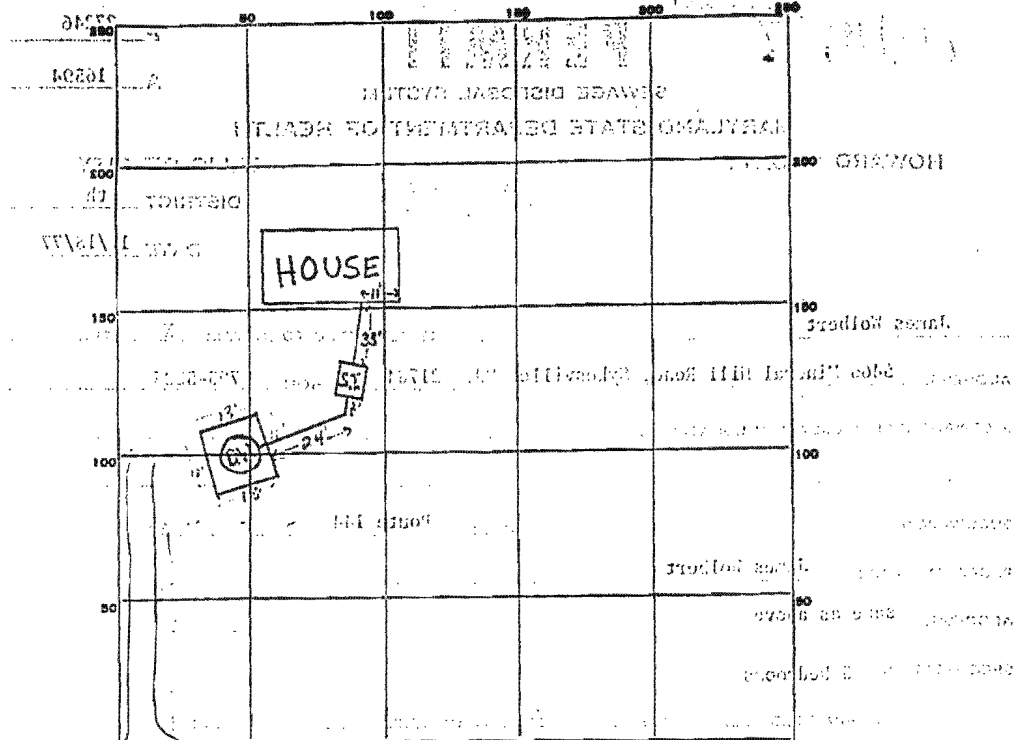

INDICATE NORTH. - NAME ADJOINING ROADWAY AS BASE LINE.

Rte. 144

PERMIT CARD  \_\_\_\_\_ 6701 S.P. D.W.

SEPTIC TANK, LEVEL  \_\_\_\_\_ CLEANOUTS

DISTRIBUTION BOX, LEVEL na

TILE FIELD, DEPTH 12 FT. TRENCH WIDTH 12 FT.

GRAVEL DEPTH \_\_\_\_\_ IN. TOTAL LENGTH \_\_\_\_\_ FT.

NUMBER OF TRENCHES \_\_\_\_\_ TOTAL BOTTOM AREA \_\_\_\_\_

SEEPAGE PITS, INSIDE-DIAMETER 5.0 FT. DEPTH BELOW INLET 7.5 FT.

ABSORBENT AREA 137.5 SQ. FT.

REMARKS \_\_\_\_\_

\_\_\_\_\_

\_\_\_\_\_

\_\_\_\_\_

DATE SYSTEM APPROVED 6/2/78 INSPECTOR Frank Skinner