

9/8/00 Repair  
9/8/00 9:30 Uncover  
Covered  
Work

INDEXED

# PERMIT

SEWAGE DISPOSAL SYSTEM  
HOWARD COUNTY HEALTH DEPARTMENT  
BUREAU OF ENVIRONMENTAL HEALTH  
410-313-2640

P 514238

A REPAIR

ISSUE DATE 9/8/00

~~OR TO COVER~~  
APPROVAL DATE 9/18/00

Jenkins Brothers IS PERMITTED TO INSTALL        ALTER X

ADDRESS 7670 Smith's Private Road, Sykesville, MD 21784 PHONE 410-461-9282

SUBDIVISION        LOT NUMBER        ADDRESS 12118 Frederick Road

PROPERTY OWNER Shifflet-Deitz PROPERTY OWNER'S ADDRESS 12118 Frederick Road

SEPTIC TANK CAPACITY 1000-1250 GALLONS

PUMP CHAMBER CAPACITY        GALLONS

NUMBER OF BEDROOMS 2 3 BR Add'n pending

SQUARE FEET PER BEDROOM 125

LINEAR FEET OF TRENCH REQUIRED 125

TRENCHES: Trenches to be 2 feet wide. Inlet 3 feet below original grade. Bottom maximum depth

LOCATION: 8 feet below original grade. 5 feet of stone below distribution box.

REPAIR - PURPOSE - Existing septic system has failed.

Call for inspection when ground is opened so sanitarian can recommend repair. 01-24-2000

*OK/MD*

PLANS APPROVED        DATE       

PERMIT VOID AFTER 2 YEARS

NOTE: CONTRACTOR RESPONSIBLE FOR SCHEDULING A PRE-CONSTRUCTION INSPECTION FOR ALL INSTALLATIONS

NOTE: TOP OF SEPTIC TANKS ARE TO BE NO DEEPER THAN 3.0 FEET BELOW FINISH GRADE

NOTE: WATERTIGHT SEPTIC TANKS REQUIRED

NOTE: CLEANOUT REQUIRED EVERY 70 FEET OF SEWER LINE AND/OR AT 90° SWEEPS IN LINES FROM HOUSE TO DRAIN FIELDS, 90° ELBOWS ARE NOT ACCEPTABLE

NOTE: ALL PARTS OF SEPTIC SYSTEMS (I.E. TANK, DISTRIBUTION BOX, DRAINFIELDS) TO BE 100 FEET FROM ANY WATER WELL UNLESS OTHERWISE SPECIFICALLY AUTHORIZED

NOTE: NO ABSORPTION TRENCH TO EXCEED 100 FEET IN LENGTH UNLESS SPECIFICALLY AUTHORIZED

NOTE: ALL PIPE FROM HOUSE TO SEPTIC TANK MUST BE CAST IRON OR SCHEDULE 35/40 PVC OR ABS

NOTE: MANHOLE RISERS REQUIRED ON ALL SEPTIC TANKS AND PUMP CHAMBERS

NOTE: DISTRIBUTION BOXES MUST HAVE BAFFLES

NOTE: IF PUMPED SEPTIC SYSTEM REQUIRED, (1) SEPTIC PUMP DETAIL TO BE PROVIDED BY INSTALLER PRIOR TO ISSUANCE OF SEPTIC PERMIT (2) PUMP PERFORMANCE TEST IS NECESSARY PRIOR TO HEALTH DEPARTMENT APPROVAL OF SEPTIC PERMIT

NEITHER THE HOWARD COUNTY COUNCIL NOR THE HEALTH DEPARTMENT IS RESPONSIBLE FOR THE SUCCESSFUL OPERATION OF ANY SYSTEM

PERMITTEE RESPONSIBLE FOR OBTAINING FINAL APPROVAL ON THIS PERMIT

CALL 410-313-2640 FOR INSPECTION OF SEPTIC SYSTEM

NOT TO SCALE

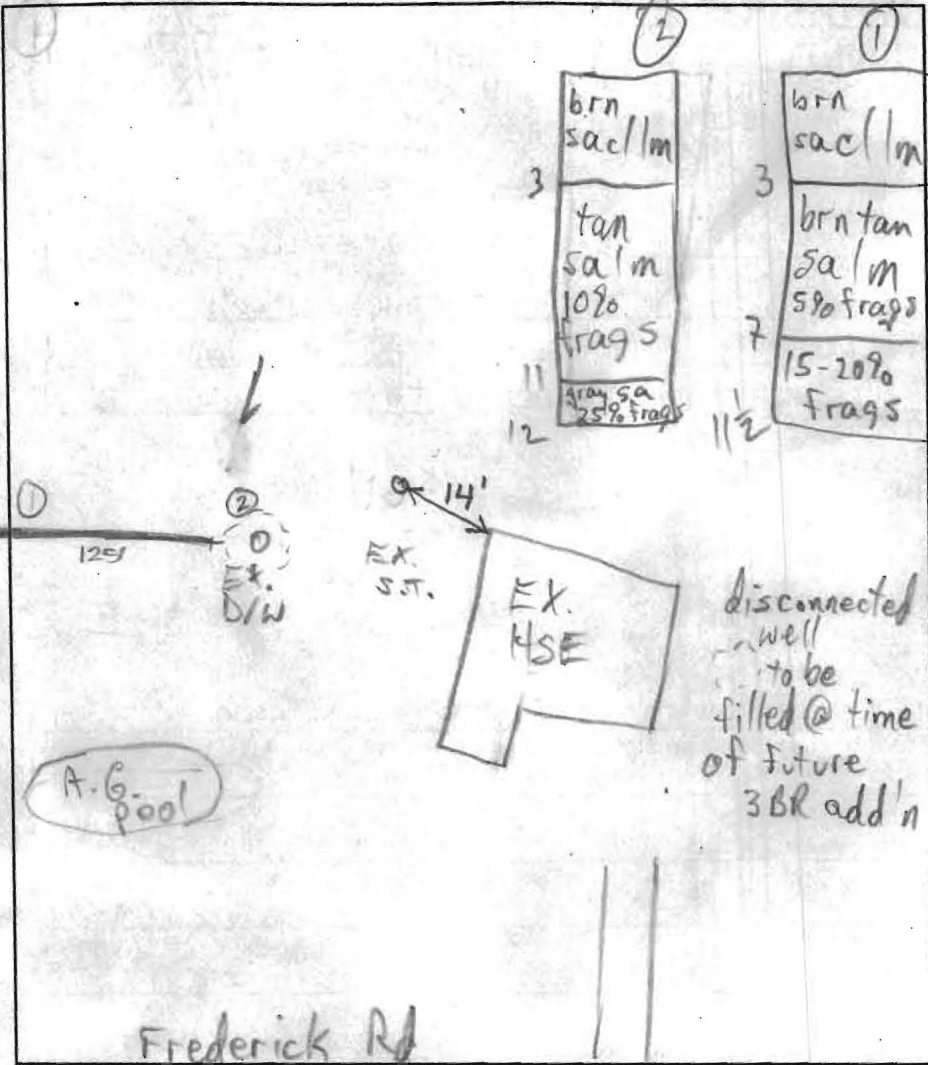

**TRENCH DATA**

TRENCH WIDTH	2
TRENCH INLET DEPTH	3
TRENCH BOTTOM DEPTH	8
DEPTH OF STONE	9
NUMBER OF TRENCHES	1
TOTAL TRENCH LENGTH	125
ABSORBENT AREA	625
DISTRIBUTION BOX LEVEL	N/A
BAFFLE IN DISTRIBUTION BOX	N/A

**SEPTIC TANK DATA**

SEPTIC TANK EXISTING GALLONS  
 MANHOLE RISER \_\_\_\_\_  
 6 INCH INSPECTION PORT \_\_\_\_\_

**PUMP CHAMBER DATA**

PUMP CHAMBER GALLONS \_\_\_\_\_  
 MANHOLE RISER \_\_\_\_\_  
 ALARM \_\_\_\_\_  
 PUMP PERFORMANCE TEST \_\_\_\_\_

PRE-CONSTRUCTION INSPECTION: 9/8/00 #1 OK TO START

INSPECTION COMMENTS: 9/8/00 4:20± SYSTEM COVERED; JENKINS REPORTS #0E MAN (RONNIE) WAS TO LEAVE SYSTEM OPEN; I ADVISED JENKINS SYSTEM NOT APPROVED UNTIL FURTHER NOTICE & STS. EXCAVATED; HE AGREED (MR)

9/18/00 contractor opened ends of trench - reports installing above specified trench. OK to cover. DLC

INSPECTOR DLC DATE SYSTEM COVERED ~~APPROVED~~ 9/18/00