

PUB. SEWER STATUS VERIFIED BY _____

ISSUE DATE: _____

APPROVAL DATE: _____

PERMIT

INDEXED

P ~~INDEXED~~

A REPAIR 518589-K

ON-SITE SEWAGE DISPOSAL SYSTEM HOWARD COUNTY HEALTH DEPARTMENT BUREAU OF ENVIRONMENTAL HEALTH

04-317807

Jack Fyock IS PERMITTED TO INSTALL ALTER

ADDRESS: P.O. Box 89, Glenelg PHONE NUMBER: 410-988-9270

SUBDIVISION: Tax Map 14, Parcel 89 LOT NUMBER: _____

ADDRESS: 2841 Hobbs Road PROPERTY OWNER: S. Hobbs/R. Kinlein

SEPTIC TANK CAPACITY (GALLONS): 1250

PUMP CHAMBER CAPACITY (GALLONS): _____

NUMBER OF BEDROOMS: 4

SQUARE FEET PER BEDROOM: _____

LINEAR FEET OF TRENCH REQUIRED: _____

REPAIR NOT DONE
AS OF 10/7/03

TRENCHES:	Trench to be _____ feet wide. Inlet _____ feet below original grade. Bottom maximum depth _____ feet below original grade. Effective area begins at _____ feet below original grade. _____ feet of stone below distribution pipe.
LOCATION:	
PURPOSE:	Existing metal septic tank has collapsed. Call for inspection when tank is installed. Drainfield to be verified at a later date.

PLANS APPROVED: MER DATE: 9/20/02

- NOTE: PERMIT VOID AFTER 2 YEARS
- NOTE: CONTRACTOR RESPONSIBLE FOR SCHEDULING A PRE-CONSTRUCTION INSPECTION FOR ALL INSTALLATIONS
- NOTE: WATERTIGHT SEPTIC TANKS REQUIRED
- NOTE: ALL PARTS OF SEPTIC SYSTEM SHALL BE 100 FEET FROM ANY WATER WELL
- NOTE: MANHOLE RISERS REQUIRED ON ALL SEPTIC TANKS AND PUMP CHAMBERS

NEITHER THE HOWARD COUNTY COUNCIL NOR THE HEALTH DEPARTMENT IS RESPONSIBLE FOR THE SUCCESSFUL OPERATION OF ANY SYSTEM PERMITTEE RESPONSIBLE FOR OBTAINING FINAL APPROVAL ON THIS PERMIT CALL 410-313-2640 FOR INSPECTION OF SEPTIC SYSTEM

A 518589-K



HOWARD COUNTY HEALTH DEPARTMENT

Bureau of Environmental Health
3525-H Ellicott Mills Drive, Ellicott City, Maryland 21043-4544
(410) 313-2640 Fax (410) 313-2648
TDD (410) 313-2323 Toll Free 1-877-4MD-DHMH

Penny E. Borenstein, M.D., M.P.H., Howard County Health Officer

September 30, 2002

Mrs. Shirley Hobbs
308 Drovers Way
Stevensville, MD 21606-3930

Mr. Richard Kinlein
8355 Court Avenue
Ellicott City, MD 21043

RE: Septic System Repair
2841 Hobbs Road
Tax Map 14, Parcel 89

Dear Mrs. Hobbs and Mr. Kinlein:

On September 20, 2002, this office received notification of an imminent septic tank replacement due to a collapsed metal tank at the referenced property. This office agreed to installation of the tank given the emergency, but concerns remain about the existing drainfield to which the tank was connected.

No records could be located for the existing septic system, suggesting that the drainfield has not been repaired in at least 40 years. Since properly-installed drainfields are designed to fail in about 20 years, this office is concerned that the septic drainfield is installed in unsuitable soils or does not otherwise meet minimum standards. Since the original septic tank was old enough to collapse and was undersized, then the existing drainfield certainly warrants review and evaluation. The septic tank failure itself could have had detrimental effects on the drainfield as well.

In addition, Code of Maryland Regulations 26.04.02.02.O and 26.04.02.02.L give the Health Department authority, in a tank replacement situation, to require evaluation of an existing drainfield which has no record of a permit.

Therefore, you are requested to have a septic contractor schedule an evaluation of the soils in the vicinity of the existing drainfield. This should occur within ten business days of issuance of this letter to avoid additional actions by this office. If you have any questions, please call this office at the number listed above.

Respectfully,

Mark E. Rifkin

Well and Septic Program

MER

cc: Jack Fyock
File

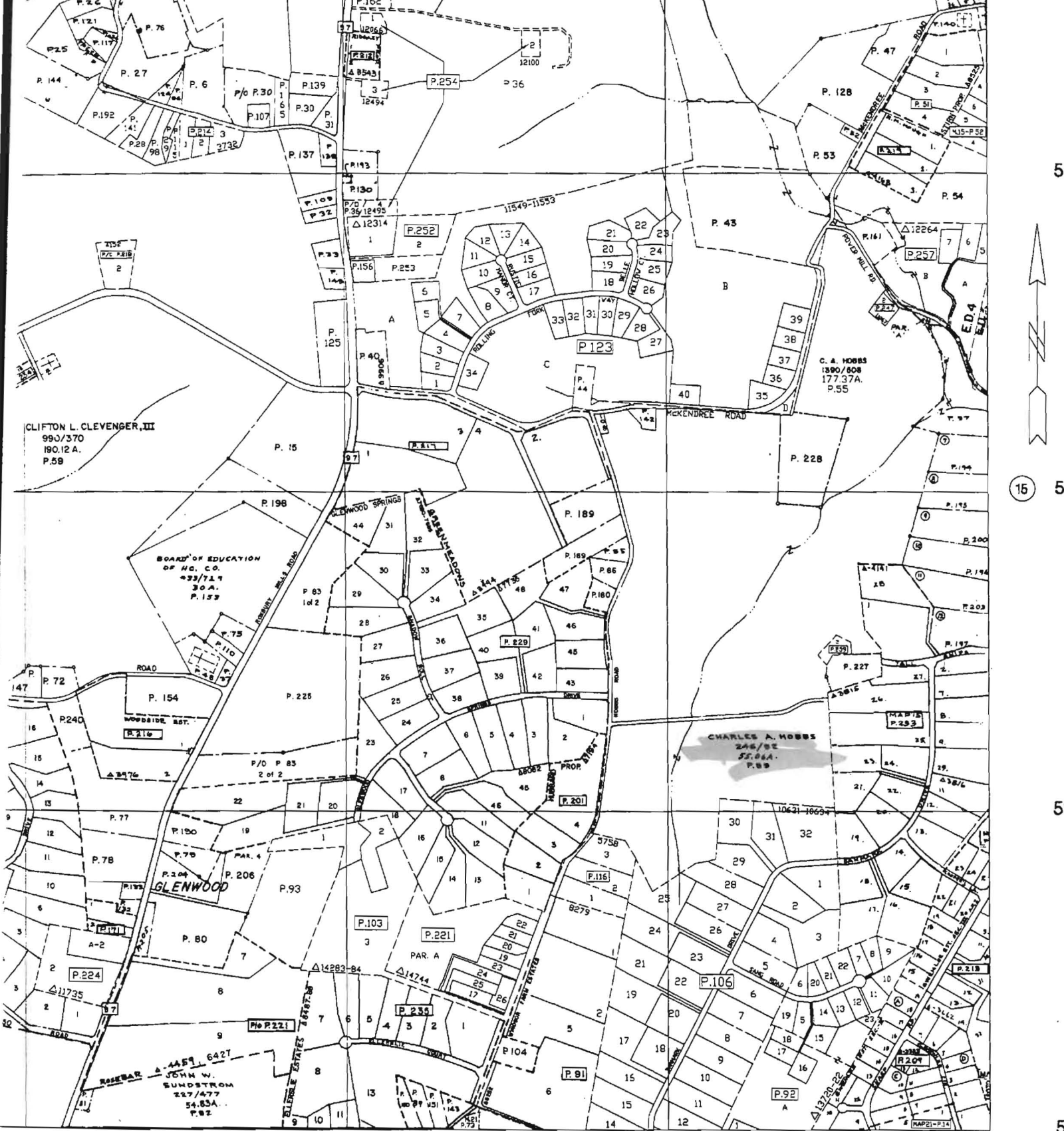

53

15 53

53

5

21

791

COMPILED BY:
MARYLAND DEPARTMENT OF PLANNING
PROPERTY MAPPING SECTION

The information shown on this map has been obtained from deed descriptions and plots and is not a total survey. It should not be used for legal descriptions. Errors in this map are not the responsibility of the Maryland Department of Planning, Property Mapping Section, Room 1181, 321 W. Preston St., Baltimore, MD 21201-1326.

PROPERTY LINE
 SUBDIVISION BOUNDARY
 TOWN BOUNDARY
 PRIVATE ROAD
 ESTATE LINE
 CONTINGENT OWNERSHIP

SCALE 1"=600' (RF 1:7200)

PARCEL NUMBERING - P LINE (ASSIGNED TO IDENTIFY OWNERSHIP, MUST BE PRECEDED BY A MAP NUMBER)

REVISED TO:	DATE	BY	LSBR	LAST P. NO.	QUARTER-QUADRANGLE	DATE OF PHOTO	SHA GRID
	JUL '01	AB					



HOWARD COUNTY,
MARYLAND

797

1794510mN
 400025.9mE

782-5
 MAP N
 14

800