



# APPLICATION

## FOR PERCOLATION TESTING AND SITE EVALUATION

TEST DATE(S) \_\_\_\_\_ TEST TIME \_\_\_\_\_

AP 536034

AGENCY REVIEW: \_\_\_\_\_

DATE 11-15-11

DO NOT WRITE ABOVE THIS LINE

I HEREBY APPLY FOR THE NECESSARY TESTING/EVALUATION PRIOR TO ISSUANCE OF SEWAGE DISPOSAL SYSTEM PERMIT(S) TO:

CHECK AS NEEDED:

- ☒ CONSTRUCT NEW SEPTIC SYSTEM(S)  
☐ REPAIR/ADD TO AN EXISTING SEPTIC SYSTEM  
☐ REPLACE AN EXISTING SEPTIC SYSTEM

CHECK AS NEEDED:

- ☐ NEW STRUCTURE(S)  
☐ ADDITION TO AN EXISTING STRUCTURE  
☐ REPLACE AN EXISTING STRUCTURE

CHECK ONE:

- ☒ CREATE NEW LOT(S)  
☐ BUILD ON AN EXISTING LOT IN A SUBDIVISION  
☐ BUILD ON AN EXISTING PARCEL OF RECORD

IS THE PROPERTY WITHIN 2500' OF ANY RESERVOIR?

- ☐ YES  
☒ NO

THE TYPE OF STRUCTURE IS:

- ☐ RESIDENTIAL WITH 4-5 PROPOSED BEDROOMS IN THE COMPLETED STRUCTURE (NOTE **UNKNOWN** IF APPROPRIATE)  
☐ COMMERCIAL (PROVIDE DETAIL OF NUMBERS AND TYPES OF EMPLOYEES/ CUSTOMERS ON ACCOMPANYING PLAN)  
☐ INSTITUTIONAL/GOVERNMENT (PROVIDE DETAIL OF NUMBERS AND TYPES OF EMPLOYEES/USERS ON ACCOMPANYING PLAN)

PROPERTY OWNER(S) GILBERT + ELIZABETH BLEVINS

DAYTIME PHONE 301-854-0587 CELL 443-980-0306 FAX N/A

MAILING ADDRESS 11986 HALL SHOP Rd CLARKSVILLE MD 21029  
STREET CITY/TOWN STATE ZIP

APPLICANT WILLIAMSBURG GROUP LLC - BOB CORBETT

DAYTIME PHONE 410-977-3343 CELL 410-977-3343 FAX 410-997-4358

MAILING ADDRESS 5485 HARPERS FARM Rd #200 COLUMBIA MD 21044  
STREET CITY/TOWN STATE ZIP

APPLICANT'S ROLE: DEVELOPER BUILDER BUYER RELATIVE/FRIEND REALTOR CONSULTANT

PROPERTY LOCATION

SUBDIVISION/PROPERTY NAME \_\_\_\_\_ LOT NO. 76

PROPERTY ADDRESS 11986 HALL SHOP Rd CLARKSVILLE, MD 21029  
STREET TOWN/POST OFFICE

TAX MAP PAGE(S) 35 GRID 19 PARCEL(S) 0310 PROPOSED LOT SIZE 3 ACRE

AS APPLICANT, I UNDERSTAND THE FOLLOWING: THE SYSTEM INSTALLED SUBSEQUENT TO THIS APPLICATION IS ACCEPTABLE ONLY UNTIL PUBLIC SEWERAGE IS AVAILABLE. THIS APPLICATION IS COMPLETE WHEN ALL APPLICABLE FEES AND A SUITABLE SITE PLAN HAVE BEEN RECEIVED. I ACCEPT THE RESPONSIBILITY FOR COMPLIANCE WITH ALL M.O.S.H.A. AND "MISS UTILITY" REQUIREMENTS. APPROVAL IS BASED UPON SATISFACTORY REVIEW OF A PERC CERTIFICATION PLAN.

TEST RESULTS WILL BE MAILED TO APPLICANT.

SIGNATURE OF APPLICANT

HOWARD COUNTY HEALTH DEPARTMENT, BUREAU OF ENVIRONMENTAL HEALTH, WELL AND SEPTIC PROGRAM  
7178 COLUMBIA GATEWAY DRIVE COLUMBIA, MARYLAND 21046 (410) 313-2640 FAX (410) 313-2648  
TDD (410) 313-2323 TOLL FREE 1-877-4MD-DHMH



Lot 8 (31X)

1026  
dk brn loam  
brn loam  
brn cl  
brn, red  
& yel-brn  
loams  
red &  
yellow s  
olive  
& brn ls

1028  
dk brn h  
brn loam  
brn cl  
slightly sticky  
few stones  
brn loam  
c. mica  
brn fs  
many mica  
brn grey  
& red-yel  
ls

lt. grey ls  
m 2d pale yellow  
grey & lt grey  
p ls  
20% (w.c.)  
white  
striations

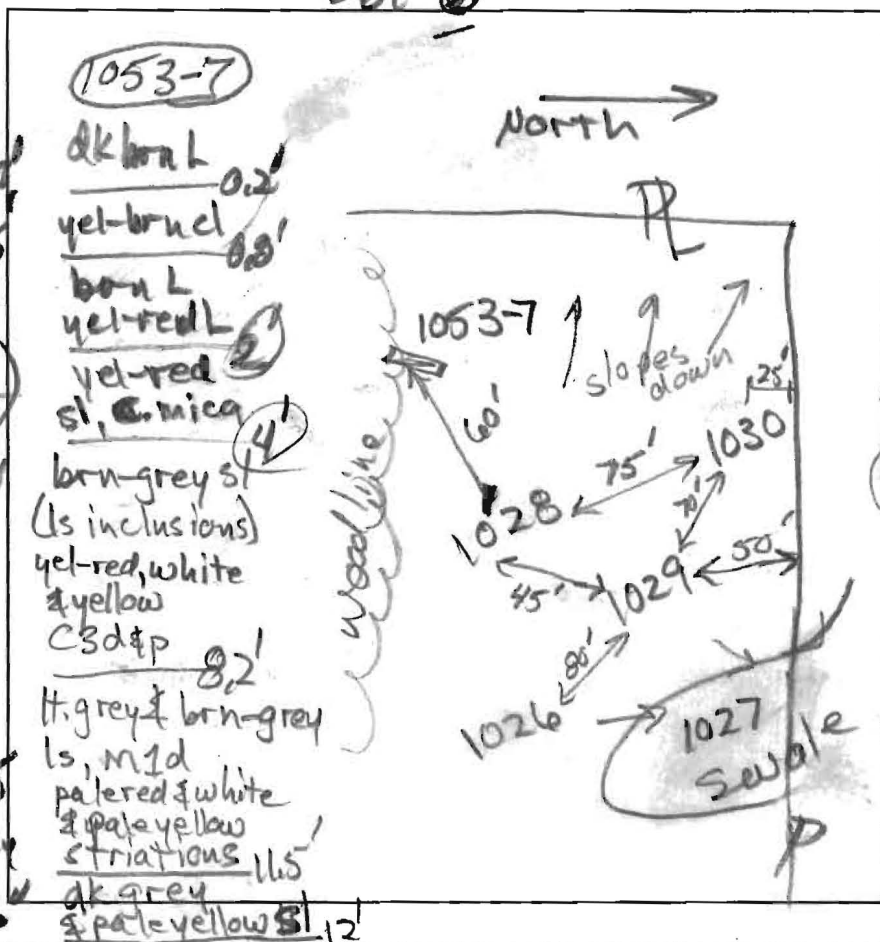

DATE	TEST #	DEPTH	START	BREAK 1" DROP	STOP 2" DROP	TIME OF 2ND INCH	P/F/H
12/8/11	1026	6' 12"	12:58	1:05	1:16	11	P
12/8/11	1027	5' 3"	1:00	1:32			F
12/8/11	1028	6' 12"	1:21	1:23	1:28	5	P
12/8/11	1029	6' 13"	1:38	1:40	1:43	3	P
12/8/11	1030	5' 5"	2:05	2:07	2:10	3	P
12/8/11	1053-7	11.5'	Visual		2' to 7.5' OK 1.29 gpd / 10' x 2'		P

1029  
dk brn loam  
brn cl  
few stones  
brn & grey brn  
loam c. mica  
brn-grey  
sl. dense  
m 2d red  
m 3d yellow  
brn-grey  
c 3d yellow  
strata  
brn-grey  
ls c 2d  
pale yellow  
lt grey & grey  
m 1d white  
ls  
1030  
dk brn loam  
brn loam  
brn sl  
m. mica  
brn-grey  
sl (ls inclusions)  
c 3d & p  
yel-red, white  
& yellow  
brn & olive  
ls f 2d  
pale  
yellow  
lt grey & white  
gr ls

REMARKS Holes dug Ahead of Env. San #1027 Head of swale  
no description

SANITARIAN RB BACKHOE Mike Johnson OTHERS Mike Johnson Bob Corbett

TEST HOLES USED IN SDA \_\_\_\_\_ AVG. PERC TIME \_\_\_\_\_ SQ. FT/BR \_\_\_\_\_

TRENCH WIDTH \_\_\_\_\_ INLET DEPTH \_\_\_\_\_ MAX. BOT DEPTH \_\_\_\_\_ EFFECTIVE S/W \_\_\_\_\_