

B 1	10683	SEQUENCE NO. (MDE USE ONLY)	STATE OF MARYLAND APPLICATION FOR PERMIT TO DRILL WELL please type	STATE PERMIT NUMBER HO-14-0096 <small>fill in this form completely</small>
------------	--------------	--------------------------------	--	---

Date Received (APA)

OWNER INFORMATION

8 MM DD YY 13
 15 Last Name Owner First Name 34
 36 Street or RFD 55
 57 Town 70 State 72 Zip 76

Jasinski Stephen
10821 Graeclach Rd
Laurel MD 20723

B 3 **LOCATION OF WELL**

8 COUNTY 21
 23 SUBDIVISION 42
 SECTION 44 46 LOT 48 50
 52 NEAREST TOWN 71

Howard
Laurel

DRILLER INFORMATION

Driller's Name 76 License No. 81
 Firm Name
 Address
 Signature Date

Edward Gross MWD 580
Long Green Drilling
2105 Emory Park Rd Annapolis
9/11/14

B 4 **SOURCES OF DRILLING WATER**

1. *Public*
 2.
 3.

11 STREET ADDRESS 30
ON WHICH SIDE OF ROAD (CIRCLE APPROPRIATE BOX)

NORTH
 WEST EAST
 SOUTH

34 140 37 DISTANCE FROM ROAD
 ENTER FT OR MI 38 39
 TAX MAP: *41* BLK: *23* PARCEL *297*

B 2 **WELL INFORMATION**

1 2
 APPROX. PUMPING RATE (GAL. PER MIN.) 8 12
 AVERAGE DAILY QUANTITY NEEDED (GAL. PER DAY) 14 20

USE FOR WATER (CIRCLE APPROPRIATE BOX)

DOMESTIC POTABLE SUPPLY & RESIDENTIAL IRRIGATION
 FARMING (LIVESTOCK WATERING & AGRICULTURAL IRRIGATION)
 INDUSTRIAL, COMMERCIAL, DEWATERING
 PUBLIC WATER SUPPLY WELL
 TEST, OBSERVATION, MONITORING
 OPEN LOOP GEOTHERMAL
 CLOSED LOOP GEOTHERMAL *20 Geothermal*

NOT TO BE FILLED IN BY DRILLER HEALTH DEPARTMENT APPROVAL

Howard COUNTY NAME COUNTY NO. *13*
 STATE SIGNATURE INSERT S → 41
 DATE ISSUED *9/25/14* CO SIGNATURE *John M. Wang* EXP. DATE *9/25/15*

APPROXIMATE DEPTH OF WELL *320* FEET
 APPROXIMATE DIAMETER OF WELL *6* NEAREST INCH

PROPOSED LOCATION OF WELL ON LOT
 SHOW PERMANENT STRUCTURES SUCH AS BUILDINGS, SEPTIC SYSTEM, ROADS AND/OR LANDMARKS AND INDICATE NOT LESS THAN TWO DISTANCE MEASUREMENTS TO WELL

METHOD OF DRILLING (circle one)

BORED (or Augered) **JETTED** Jetted & DRIVEN
 AIR-ROTary **AIR-PERCussion** ROTARY (Hydraulic Rotary)
 CABLE REVerse-ROTary DRIVE-POINT
 other _____

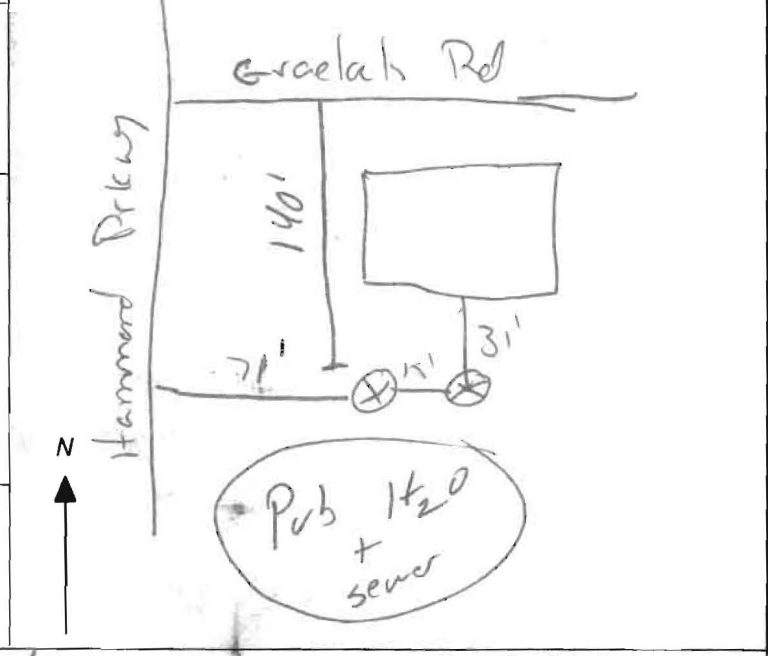

REPLACEMENT OR DEEPEMED WELLS (CIRCLE APPROPRIATE BOX)

THIS WELL WILL NOT REPLACE AN EXISTING WELL
 THIS WELL WILL REPLACE A WELL THAT WILL BE ABANDONED AND SEALED
 THIS WELL WILL REPLACE A WELL THAT WILL BE USED AS A STANDBY-CONTACT LOCAL APPROVING AUTHORITY FOR POLICY ON STANDBY WELLS
 THIS WELL WILL DEEPEM AN EXISTING WELL

PERMIT NUMBER OF WELL TO BE REPLACED OR DEEPEMED (IF AVAILABLE) 41 _____ 52

Not to be filled in by driller (MDE OR COUNTY USE ONLY)

APPROX. PERMIT NUMBER _____ **G** _____
 PERMIT No. *HO-14-0096*
 70 71 72 73 74 75 76 77 78 79

SPECIAL CONDITIONS *Grout bottom to top.*

NOTE APPROVING AUTHORITIES SHOULD USE SEPARATE SHEET IF NEEDED

C1 29903

SEQUENCE NO. (MDE USE ONLY)

STATE OF MARYLAND WELL COMPLETION REPORT

THIS REPORT MUST BE SUBMITTED WITHIN 45 DAYS AFTER WELL IS COMPLETED.

(THIS NUMBER IS TO BE PUNCHED IN COLS. 3-6 ON ALL CARDS)

COUNTY NUMBER

ST/CO USE ONLY DATE RECEIVED

DATE WELL COMPLETED

DEPTH OF WELL

PERMIT NO. FROM "PERMIT TO DRILL WELL"

MM DD YY

MM DD YY

22 370' 26

140-14-0096

OWNER: Jasinski, Stephen; WELL SITE ADDRESS: 10821 Graeflach Rd.; TOWN: Laurel; SECTION: 7; LOT: 8

WELL LOG

Not required for driven wells

GROUTING RECORD

WELL HAS BEEN GROUTED (Y/N); TYPE OF GROUTING MATERIAL (CM/BC); NO. OF BAGS (94); NO. OF POUNDS (700); GALLONS OF WATER (320); DEPTH OF GROUT SEAL (0' to 320')

C 3

PUMPING TEST

HOURS PUMPED (8.9); PUMPING RATE (11.15 gal. per min.); METHOD USED TO MEASURE PUMPING RATE; WATER LEVEL (17.20 ft. before, 22.25 ft. when pumping); TYPE OF PUMP USED (centrifugal)

STATE THE KIND OF FORMATIONS PENETRATED, THEIR COLOR, DEPTH, THICKNESS AND IF WATER BEARING

Table with 3 columns: DESCRIPTION, FEET (FROM TO), and check if water bearing. Includes entries for Moist, stiff Brown m-f Sandy, Micaceous silt.; Moist to wet soft m-f sandy, Micaceous silt w/ large quartz boulders; Weathered Rock; Rock; 2x Goodhead

CASING RECORD: casing types insert appropriate code below (ST/PL/CO/OT)

MAIN CASING TYPE: Nominal diameter (top (main) casing) (nearest inch); Total depth of main casing (nearest foot)

OTHER CASING (if used): diameter (nearest inch); depth (feet) from to

SCREEN RECORD: screen type or open hole (ST/BR/PL/HO/OT); DEPTH (nearest ft.)

NUMBER OF UNSUCCESSFUL WELLS; WELL HYDROFRACTURED (Y/N)

CIRCLE APPROPRIATE LETTER: A WELL WAS ABANDONED AND SEALED WHEN THIS WELL WAS COMPLETED; E ELECTRIC LOG OBTAINED; P TEST WELL CONVERTED TO PRODUCTION WELL

I HEREBY CERTIFY THAT THIS WELL HAS BEEN CONSTRUCTED IN ACCORDANCE WITH COMAR 26.04.04 "WELL CONSTRUCTION" AND IN CONFORMANCE WITH ALL CONDITIONS STATED IN THE ABOVE CAPTIONED PERMIT...

DRILLERS LIC. NO. M2 D 560; DRILLERS SIGNATURE; LIC. NO. D

RECEIVED stamp: MAY 05 2016; HOWARD COUNTY HEALTH DEPT. COMMUNITY HYGIENE PROGRAM

GRAVEL PACK IF WELL DRILLED WAS FLOWING WELL; MDE USE ONLY (NOT TO BE FILLED IN BY DRILLER); TELESCOPE CASING; LOG INDICATOR; OTHER DATA

PUMP INSTALLED: DRILLER INSTALLED PUMP (YES/NO); IF DRILLER INSTALLS PUMP, THIS SECTION MUST BE COMPLETED FOR ALL WELLS; TYPE OF PUMP INSTALLED PLACE (A,C,J,P,R,S,T,O) IN BOX 29; CAPACITY: GALLONS PER MINUTE (31-35); PUMP HORSE POWER (37-41); PUMP COLUMN LENGTH (43-47); CASING HEIGHT (circle appropriate box and enter casing height) (+ above, - below) LAND SURFACE (nearest foot)

LATITUDE 39.153116; LONGITUDE 76.889600; (DEFAULT COORD. WGS 84)

NOTES: 39.153134; 76.889631

40'

N 62°46'30" W 142.93' (P)

LOT 8
BLOCK 7
29,623 S.F.

LOT 9

S 27°13'30" W 195.37' (P)

50' S.B.L.

R=739.00' A=188.07' (P)
A=188.56' (C)

HAMMOND PARKWAY
(60' R/W)

*Geo Bene's
approval
-KMO*



*Geotherm
Wells*

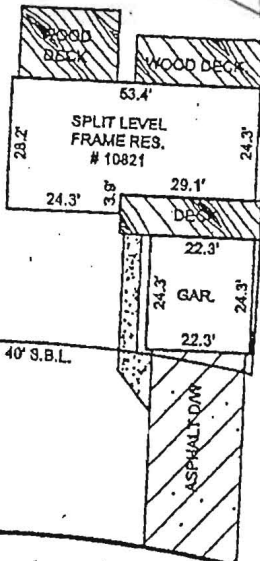

S 62°46'30" E
38.25' (P)

R=231.90'
A=77.95' (P)

R=25.00'
A=44.38' (P)

GRAELOCH ROAD
(50' R/W)

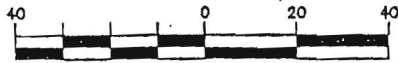

GRAPHIC SCALE (In Feet)
1 inch = 40' ft.

ACCURACY=3±

*Public
Water
+
Sewer
OK*

3-00019 DATE: 1/12/2013

AND ELENA CONTRERAS

ATH AND ELMINA HILSEN RATH

ENA CONTRERAS

PREPARED THIS DRAWING OR WAS IN RESPONSIBLE AND THE SURVEYING WORK REFLECTED IN IT, ALL IN IS SET FORTH IN REGULATION . 12 OF CHAPTER AND ANNOTATED REGULATIONS.

DO NOT REMOVE THIS TAG
DEPARTMENT OF THE ENVIRONMENT
WELL PERMIT NUMBER

HO-14-0096

INFORMATION: GIVE NUMBER AND WRITE
1800 WASHINGTON BLVD
BALTIMORE MARYLAND. 21230

Maryland Surveyors, Inc. P (443) 692-6523 • F (443) 692-6524
10480 Little Patuxent Parkway • Suite 400 • Columbia, MD 21044

DOCUMENT. THE ADVICE FOUND ON THE AFFIXED PAGE (PAGE 2 OF 2) IS AN INTEGRAL PART OF THE PLAT.

Bore hole Cross Section

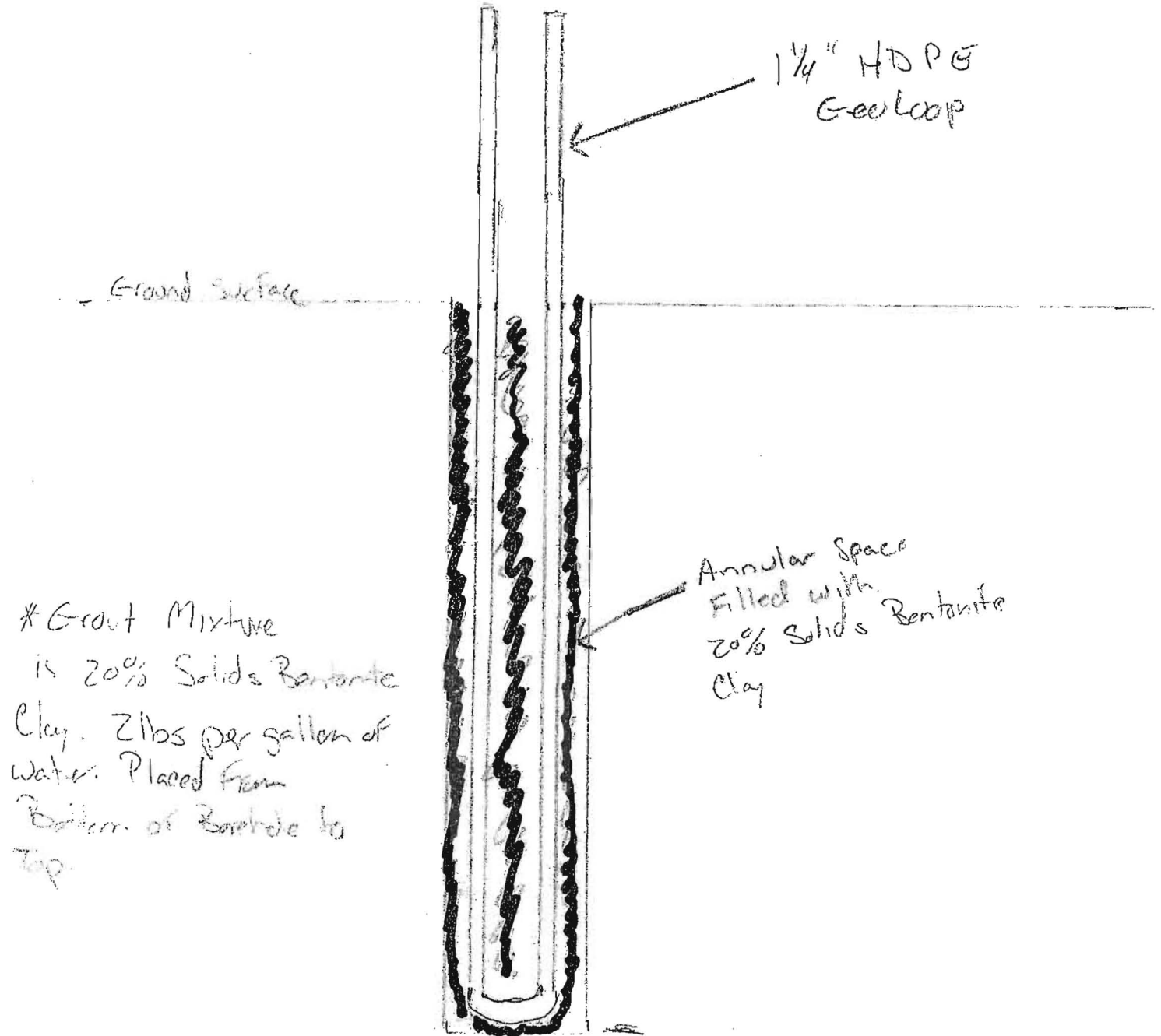

* Grout Mixture
is 20% Solids Bentonite
Clay. 2lbs per gallon of
water. Placed from
Bottom of Borehole to
Top.