

6/23/86 ANYTIME

6/27/86 ANYTIME
→ 490-1881

7/3/86 9:30

7/7/86 approved
S. Abel

Repair Pole
BOB Lewis

PERMIT

SEWAGE DISPOSAL SYSTEM

MARYLAND STATE DEPARTMENT OF HEALTH*

P 37180

A REPAIR

HOWARD COUNTY

ELLICOTT CITY

BUREAU OF ENVIRONMENTAL HEALTH

X 992-2330

461-9933

INDEXED

DISTRICT _____

DATE 6/16/86

Hall Chevrolet, Inc. BOB WARD IS PERMITTED TO INSTALL _____ ALTER

ADDRESS _____ PHONE 988-9522

SUBDIVISION _____ ROAD 12205 Hall Shop Road LOT _____

PROPERTY OWNER Hall Chevrolet, Inc.

ADDRESS 12205 Hall Shop Road
Clarksville, Maryland 21029

IF GARBAGE GRINDER IS USED INCREASE SEPTIC TANK CAPACITY BY 50% AND ABSORPTION AREA BY 22%.

GARBAGE GRINDER? YES _____ NO _____

SEPTIC TANK CAPACITY _____ GALLONS NUMBER OF BEDROOMS _____

REPAIR - CALL FOR INSPECTION WHEN GROUND IS OPENED UP SO SANITARIAN CAN RECOMMEND REPAIR.

13 EMPLOYEES 1 OVERNIGHT RESIDENCE 70 GPD x 13 = 910 GAL/DAY

4 TOILETS ~ 12 HR. DAY = 455 - 500 GAL/DAY 4.0 USE

1 GP SIDEWALL ~ 500 GP SIDEWALL NEEDED ON REPAIR.

7/3/86 INLET 5" BOTTOM 10" 5" STONE

1 - 100' TRENCH MINIMUM REQUIRED

PLANS APPROVED BY C. Williams DATE 6/16/86

COVER NO WORK UNTIL INSPECTED AND APPROVED.

NEITHER THE HOWARD COUNTY COUNCIL NOR THE HEALTH DEPARTMENT IS RESPONSIBLE FOR THE SUCCESSFUL OPERATION OF ANY SYSTEM.

NOTE: IF TRENCH IS USED CALL FOR INSPECTION BEFORE AND AFTER PLACING GRAVEL IN TRENCH.

NOTE: NO DRY WELL SHALL EXCEED 15 FOOT IN DIAMETER. NO ABSORPTION TRENCH TO EXCEED 100 FEET IN LENGTH.

NOTE: ALL PIPE FROM HOUSE TO SEPTIC TANK MUST BE CAST IRON OR SCHEDULE 40 PVC OR ABS.

PERMIT VOID AFTER THREE YEARS.

NOTE: INSTALL STAND PIPE ON SEPTIC TANK AND DRY WELL. STAND PIPES MUST BE 6 INCHES IN DIAMETER CAST IRON, CONCRETE OR TERRA COTTA, OR PVC OR ABS ACCEPTED. IF TOP OF SEPTIC TANK IS DEEPER THAN 3 FEET MANHOLE TO GRADE REQUIRED

***INSTALLER IS RESPONSIBLE FOR OBTAINING FINAL APPROVAL ON THIS PERMIT**

*CALL 992-2330 FOR INSPECTION OF SEPTIC SYSTEMS.

EH - 2-1082

37180
A Repair



HALL CHEVROLET, Inc.

12205 Hall's Shop Road / CLARKSVILLE, MD. 21029 / Telephone (301) 988-9522

Howard County Health Department
B.E.H. Box 476
Ellicott City, MD 21043

Attention: Craig Williams

Dear Mr. Williams,

Enclosed is the check for a health permit, as we discussed by phone today. We will be closed Monday, I will talk to you on Tuesday, May 27.

Very truly yours,

HALL CHEVROLET, INC.

A handwritten signature in dark ink, appearing to read 'R. M. Ward', written over a horizontal line.

Robert M. Ward
President

RMW/hm

OFFICE OF THE
COUNTY CLERK
HOWARD COUNTY, MD.
MAY 27 9 08 AM '00

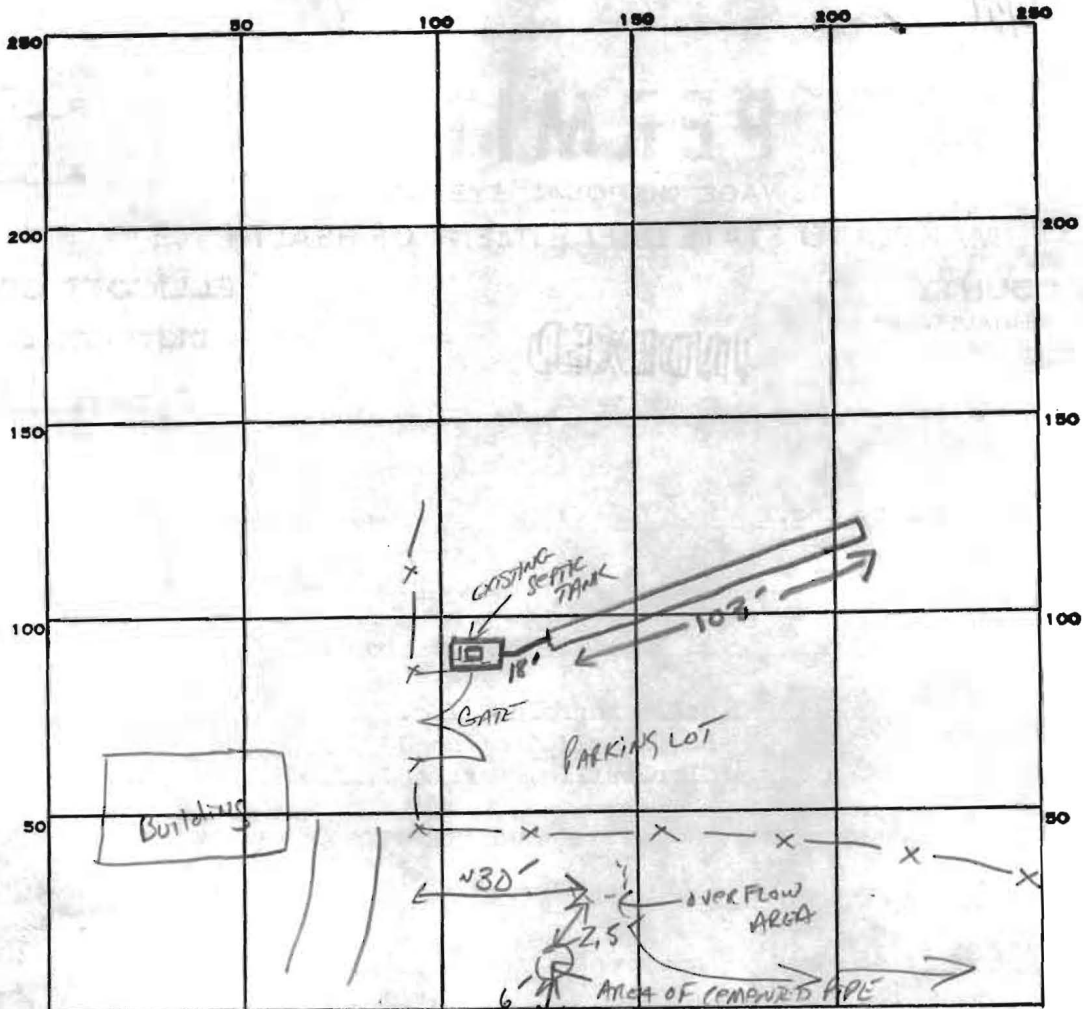

INDICATE NORTH. - NAME ADJOINING ROADWAY AS BASE LINE.

HALL SHOP Rd.

PERMIT CARD _____

SEPTIC TANK, LEVEL EXISTING

CLEANOUTS EXISTING ST

DISTRIBUTION BOX, LEVEL N/A

TILE FIELD, DEPTH 10' FT. TRENCH WIDTH 2 FT. INLET 5"

GRAVEL DEPTH 5 FT ^{FE} ~~DC~~ TOTAL LENGTH 103 FT.

NUMBER OF TRENCHES 1 ^{ONE SIDEWALL} TOTAL BOTTOM AREA 515 ~~sq~~

SEEPAGE PITS, INSIDE DIAMETER _____ FT. DEPTH BELOW INLET _____ FT.

ABSORBENT AREA 515 SQ. FT.

REMARKS 6/23/86 PILE COMPLETED; OVERFLOW CONTINUES AS SHOWN ON DIAGRAM; STEADY
STREAM WHICH SHOWS UP 50' DOWN ROAD OF POINT OF DISCHARGE; PROBLEM NOT
RESOLVED SYST. FAILING. S. ADL

DATE SYSTEM APPROVED 7/7/86

INSPECTOR S. ADL