

PUB. SEWER STATUS VERIFIED BY \_\_\_\_\_

ISSUE DATE: 6/7/06

# PERMIT

P 524500

APPROVAL DATE: 8/11/06

A 524382

## ON-SITE SEWAGE DISPOSAL SYSTEM HOWARD COUNTY HEALTH DEPARTMENT BUREAU OF ENVIRONMENTAL HEALTH

Edward Cochran IS PERMITTED TO INSTALL  ALTER

ADDRESS: 7400 Guilford Road PHONE NUMBER: 410-531-2128

SUBDIVISION: \_\_\_\_\_ LOT NUMBER: \_\_\_\_\_

ADDRESS: 7400 Guilford Road PROPERTY OWNER: Cochran

SEPTIC TANK CAPACITY (GALLONS): 1250

PUMP CHAMBER CAPACITY (GALLONS): n/a

NUMBER OF BEDROOMS: 4

SQUARE FEET PER BEDROOM: 180

LINEAR FEET OF TRENCH REQUIRED: 149

TRENCHES:	Trench to be 3.0 feet wide. Inlet 3.0 feet below original grade. Bottom maximum depth 7.0 feet below original grade. Effective area begins at 5.0 feet below original grade. 4.0 feet of stone below distribution pipe.
LOCATION:	This is for the initial and second system only, the 3 <sup>rd</sup> system should be 7' bottom, effective area @ 4 feet and the inlet at 3 feet. <b>Pump and collapse old septic system.</b>
PURPOSE:	The existing septic system has failed and the property owner has requested to increase the capacity of the septic system. <b>Installation of the system does not constitute approval of a future building permit.</b> A Percolation Certification Plan and additional testing may be required. If the property does not meet the minimum requirements based on the current Code and Regulation at that time, the building permit may be denied.

PLANS APPROVED: \_\_\_\_\_ DATE: \_\_\_\_\_

- NOTE: PERMIT VOID AFTER 2 YEARS
- NOTE: CONTRACTOR RESPONSIBLE FOR SCHEDULING A PRE-CONSTRUCTION INSPECTION FOR ALL INSTALLATIONS
- NOTE: WATERTIGHT SEPTIC TANKS REQUIRED
- NOTE: ALL PARTS OF SEPTIC SYSTEM SHALL BE 100 FEET FROM ANY WATER WELL
- NOTE: MANHOLE RISERS REQUIRED ON ALL SEPTIC TANKS AND PUMP CHAMBERS

**NEITHER THE HOWARD COUNTY COUNCIL OR THE HEALTH DEPARTMENT IS RESPONSIBLE FOR THE SUCCESSFUL OPERATION OF ANY SYSTEM PERMITTEE RESPONSIBLE FOR OBTAINING FINAL APPROVAL ON THIS PERMIT CALL 410-313-2640 FOR INSPECTION OF SEPTIC SYSTEM**

NOT TO SCALE

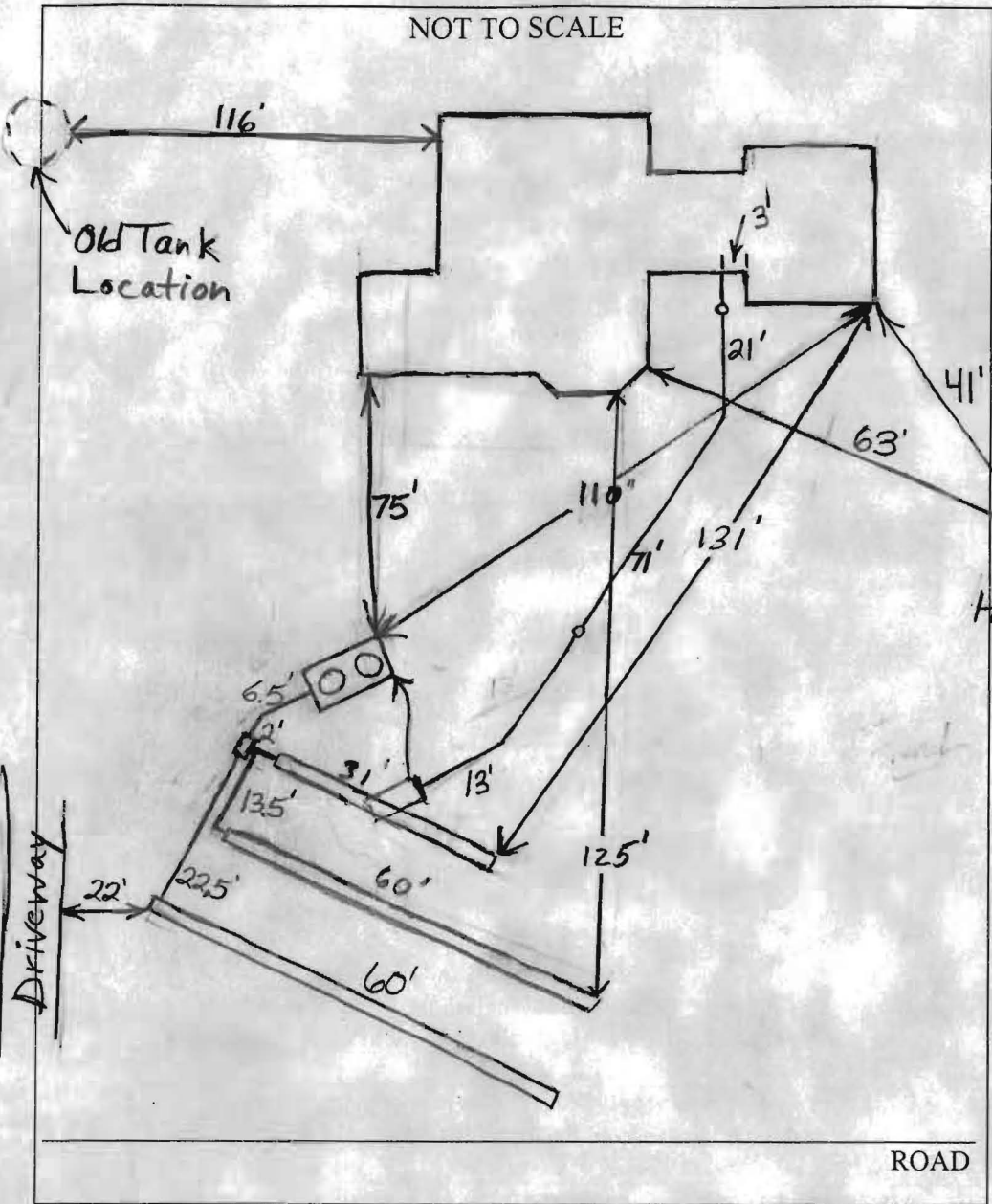

TRENCH/DRAINFIELD DATA		
WIDTH	INLET	BOTTOM
3'	3'	7'
NUMBER OF TRENCHES		3
TOTAL LENGTH		151'
ABSORPTION AREA		453 + Sidewall
DISTRIBUTION BOX LEVEL		Levelers
DISTRIBUTION BOX BAFFLE		YES
DISTRIBUTION BOX PORT		No

SEPTIC TANK DATA	
SEPTIC TANK 1 LEVEL	Yes
CAPACITY	1500 GAL
SEAM LOC	Top
TANK LID DEPTH	2'-3'
BAFFLES	Yes
BAFFLE FILTER	No
MANHOLE LOC	2-Comp Front/Rear Baby/on
6" PORT LOC	None
WATERTIGHT TEST	No
SEPTIC TANK 2 LEVEL	N/A
CAPACITY	GAL
SEAM LOC	
TANK LID DEPTH	
BAFFLES	
BAFFLE FILTER	
MANHOLE LOC	
6" PORT LOC	
WATERTIGHT TEST	

PRE-CONSTRUCTION 8/10/06 Topography not accurate. Install a 30' trench between top failed and passing test holes. Then 2-60' trenches below it.

INSTALLATION 8/10/06 Installed trench 1 and 2. 3' inlet on both trench's. (KW)

8/11/06 System finished. O.K. to backfill. Old tank pumped out and filled in. (BB)

FINAL INSPECTOR B. Baker DATE OF APPROVAL 8/11/06