

C1 3434

SEQUENCE NO. (MDE USE ONLY)

STATE OF MARYLAND WELL COMPLETION REPORT

THIS REPORT MUST BE SUBMITTED WITHIN 45 DAYS AFTER WELL IS COMPLETED.

(THIS NUMBER IS TO BE PUNCHED IN COLS. 3-6 ON ALL CARDS)

FILL IN THIS FORM COMPLETELY PLEASE TYPE

COUNTY NUMBER

ST/CO USE ONLY DATE Received

DATE WELL COMPLETED

Depth of Well

PERMIT NO. FROM "PERMIT TO DRILL WELL"

MM DD YY

06 22 10 2X

22 240 26 10/20/2010

110-95-1912

OWNER: Weller Jeffrey; STREET OR RFD: 3200 Fox Valley Drive; TOWN: West Friendship; SUBDIVISION: ; SECTION: ; LOT: ;

WELL LOG

Not required for driven wells

STATE THE KIND OF FORMATIONS PENETRATED, THEIR COLOR, DEPTH, THICKNESS AND IF WATER BEARING

DESCRIPTION (Use additional sheets if needed)

FEET FROM TO

check if water bearing

Dirt 0 25; Hard gray 25 35; Med hard tan 35 38; Hard gray 38 240

GROUTING RECORD

WELL HAS BEEN GROUTED (Circle Appropriate Box)

TYPE OF GROUTING MATERIAL (Circle one)

CEMENT CM BENTONITE CLAY BC

NO. OF BAGS 15 NO. OF POUNDS 70

GALLONS OF WATER 315

DEPTH OF GROUT SEAL (to nearest foot)

from 0 ft. to 240 ft. (enter 0 if from surface)

CASING RECORD

ST STEEL CO CONCRETE PL PLASTIC OT OTHER

MAIN CASING TYPE, Nominal diameter top (main casing) (nearest inch), Total depth of main casing (nearest foot)

OTHER CASING (if used) diameter inch, depth (feet) from to

SCREEN RECORD: screen type or open hole, insert appropriate code below, ST STEEL, BR BRASS, HO OPEN HOLE, PL PLASTIC, OT OTHER

NUMBER OF UNSUCCESSFUL WELLS: 1

WELL HYDROFRACTURED YES Y NO N

CIRCLE APPROPRIATE LETTER: A WELL WAS ABANDONED AND SEALED WHEN THIS WELL WAS COMPLETED; E ELECTRIC LOG OBTAINED; P TEST WELL CONVERTED TO PRODUCTION WELL

I HEREBY CERTIFY THAT THIS WELL HAS BEEN CONSTRUCTED IN ACCORDANCE WITH COMAR 26.04.04 "WELL CONSTRUCTION" AND IN CONFORMANCE WITH ALL CONDITIONS STATED IN THE ABOVE CAPTIONED PERMIT...

DRILLERS LIC. NO. MD 304; David Kelly; DRILLERS SIGNATURE; LIC. NO. MD 376; Jason Morrison

SITE SUPERVISOR (sign. of driller or journeyman responsible for sitework if different from permittee)

GRAVEL PACK IF WELL DRILLED WAS FLOWING WELL INSERT F IN BOX 68

MDE USE ONLY (NOT TO BE FILLED IN BY DRILLER) T (E.R.O.S.) W Q

TELESCOPE CASING, LOG INDICATOR, OTHER DATA

C 3

PUMPING TEST

HOURS PUMPED (nearest hour) 8 9

PUMPING RATE (gal. per min.) 11 15

METHOD USED TO MEASURE PUMPING RATE

WATER LEVEL (distance from land surface)

BEFORE PUMPING 17 20 ft.

WHEN PUMPING 22 25 ft.

TYPE OF PUMP USED (for test)

A air, P piston, T turbine, C centrifugal, R rotary, O other (describe below), J jet, S submersible

PUMP INSTALLED

DRILLER INSTALLED PUMP YES NO (CIRCLE) (YES or NO)

IF DRILLER INSTALLS PUMP, THIS SECTION MUST BE COMPLETED FOR ALL WELLS.

TYPE OF PUMP INSTALLED PLACE (A,C,J,P,R,S,T,O) IN BOX 29

CAPACITY: GALLONS PER MINUTE (to nearest gallon) 31 35

PUMP HORSE POWER 37 41

PUMP COLUMN LENGTH (nearest ft.) 43 47

CASING HEIGHT (circle appropriate box and enter casing height)

LAND SURFACE (nearest foot)

LOCATION OF WELL ON LOT: SHOW PERMANENT STRUCTURE SUCH AS BUILDING, SEPTIC TANKS, AND /OR LANDMARKS AND INDICATE NOT LESS THAN TWO DISTANCES (MEASUREMENTS TO WELL)

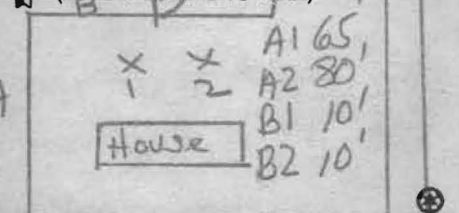

Fox Valley Drive

B 1 8311

SEQUENCE NO. (MDE USE ONLY)

STATE OF MARYLAND APPLICATION FOR PERMIT TO DRILL WELL 533222 please type

STATE PERMIT NUMBER

HO-95-1912 fill in this form completely

Date Received (APA)

OWNER INFORMATION

8 MM DD YY 13

15 Last Name Owner First Name 34

36 3200 Fox Valley Drive Street or RFD 55

57 West Friendship MD 21794 Town 70 State 72 Zip 76

B 3

LOCATION OF WELL

8 COUNTY Howard 21

23 SUBDIVISION 42

SECTION 44 46 LOT 48 50

52 NEAREST TOWN West Friendship 71

MILES FROM TOWN (enter 0 if in town) 2.1 73 76 77 78

DRILLER INFORMATION

Driller's Name David Kelly License No. MW D 304 76 81

Firm Name Jones Well Drilling, Inc.

Address 3700 Rush Rd. Jarr. MD 21084

Signature David Kelly Date 4-28-10

B 4

DIRECTION OF WELL FROM TOWN (CIRCLE BOX)

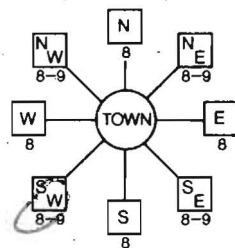

11 Fox Valley Drive NEAR WHAT ROAD 30

ON WHICH SIDE OF ROAD (CIRCLE APPROPRIATE BOX)

34 175 37 DISTANCE FROM ROAD ENTER FT OR MI 38 39

TAX MAP: 22 BLK: 2 PARCEL 9

B 2 WELL INFORMATION APPROX. PUMPING RATE (GAL. PER MIN.) 0 8 12

AVERAGE DAILY QUANTITY NEEDED (GAL. PER DAY) 0 14 20

USE FOR WATER (CIRCLE APPROPRIATE BOX)

- Domestic Potable Supply & Residential Irrigation (checked)
Farming (Livestock Watering & Agricultural Irrigation)
Industrial, Commercial, Dewatering
Public Water Supply Well
Test, Observation, Monitoring
Geo-Thermal

NOT TO BE FILLED IN BY DRILLER HEALTH DEPARTMENT APPROVAL

Howard 13 A41662 COUNTY NAME COUNTY NO.

STATE SIGNATURE INSERT S DATE ISSUED

5/26/2010 Brian Baker 5/26/2010

43 NORTH GRID 528 000 EAST GRID 806 000 48 55 57 63

APPROXIMATE DEPTH OF WELL 320 FEET

APPROXIMATE DIAMETER OF WELL 6 INCH

METHOD OF DRILLING (circle one)

- Bored (or Augered) Jetted Jetted & Driven
AIR-ROTary AIR-PERCussion ROTARY (Hydraulic Rotary)
CABLE REVERSE-ROTary DRIVE-POINT
other

REPLACEMENT OR DEEPEMED WELLS (CIRCLE APPROPRIATE BOX)

- N THIS WELL WILL NOT REPLACE AN EXISTING WELL
Y THIS WELL WILL REPLACE A WELL THAT WILL BE ABANDONED AND SEALED
S THIS WELL WILL REPLACE A WELL THAT WILL BE USED AS A STANDBY-CONTACT LOCAL APPROVING AUTHORITY FOR POLICY ON STANDBY WELLS
D THIS WELL WILL DEEPEMED AN EXISTING WELL

PERMIT NUMBER OF WELL TO BE REPLACED OR DEEPEMED (IF AVAILABLE) 41 52

Not to be filled in by driller (MDE OR COUNTY USE ONLY)

APPROP. PERMIT NUMBER G

PERMIT No. HO-95-1912

SPECIAL CONDITIONS

Start Grouting With Tremie Pipe at Bottom of Borehole

SHOW MAJOR FEATURES OF BOX & LOCATE WELL WITH AN X

SOURCES OF DRILLING WATER

- 1.
2.
3.

WRITE THE BOX NUMBER FROM THE MAP HERE

E Fox 6 000 000
N 528

DRAW A SKETCH BELOW SHOWING LOCATION OF WELL IN RELATION TO NEARBY TOWNS AND ROADS AND GIVE DISTANCE FROM WELL TO NEAREST ROAD JUNCTION

N

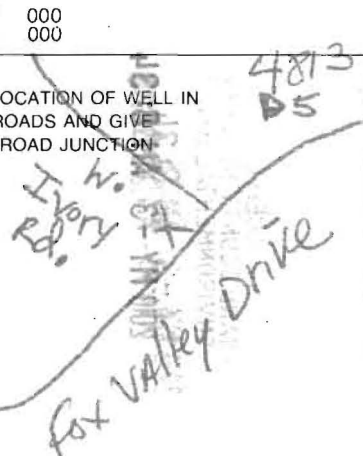

**HOWARD COUNTY HEALTH DEPARTMENT
BUREAU OF ENVIRONMENTAL HEALTH
WATER AND SEWERAGE PROGRAM
TEL: (410)313-2640 FAX: (410)313-2648**

Information Form for the Installation of the Well Pump, Pitless Adapter, and Supply Piping

NOTE: The installer is responsible for requesting an inspection prior to 9 am on the day of the desired inspection. No work is to be covered until approved by the Health Department. All installations must comply with the National Standard Plumbing Code (NSPC, as amended locally) and COMAR 26.04.04 (MD Well Construction Regulations). Submission of a complete form is required prior to Use and Occupancy approval.

Company Name: _____ Telephone #: _____
Address: _____

(Must circle one) Licensed Plumber Licensed Well Driller Licensed Well Pump Installer

License # and name of individual responsible for the field installation:

Name (Print): _____ License# _____

***A licensed individual must perform the actual installation. Apprentices must be under the direct supervision of a licensed journeyman or master plumber, pump installer or well driller. Licenses may be subjected to field verification.**

Name of Property Owner: _____ Telephone #: _____
Subdivision: _____ Lot #: _____ Well Tag #: HO - ____ - ____
Site Address: _____

Submersible Pump Data

Make: _____
Model #: _____
Pump Capacity _____ GPM
Well Yield: _____ GPM

Pitless Adapter

Make: _____
Model#: _____
Depth _____ (36" min)
NSF approved: _____

Well Cap and Electric Conduit

Two piece watertight cap: _____
Screened, vented well cap: _____
Cap secured to casing: _____
Conduit min 18" B.G.: _____
Conduit secured to well cap: _____

Depth of well encountered at time of pump installation: _____ (feet)
If pump capacity exceeds well yield, a low water cut off switch is required by NSPC 1990 Section 17.8.4
Torque arrestors or Cable guards are required - Must circle one
Safety rope, if used, attached to inside of well casing with eye bolt _____

Piping to house

Type: _____
PSI: _____ (160 psi min)
Depth of supply line: _____ (36" min)

House Connection

PVC sleeved to undisturbed soil at wall penetration: _____
Approximate length of sleeve: _____
Sleeve caulked and sealed properly: _____

The water supply line is required to be at least ten feet from the septic tank, pump chamber, sewage piping, distribution box, drainfields, and sewage reserve area. If this cannot be accomplished, contact this office for approval prior to installation.

Signature of company representative responsible for installation _____ date _____

For Health Department Use Only - Not to be completed by Installer

Date Insp. Requested: _____ Date Insp. Approved: _____
Inspection Data. Pitless adapter and water supply line at least 36" below grade _____
Two piece cap installed and attached to casing securely _____
Elec. conduit extends at least 18" below grade/attached to cap properly _____
Safety rope installed inside of well casing _____
Correct well tag attached properly and casing 3" above finished grade _____
Water supply line sleeved adequately at house connection _____
Adequate grout observed below pitless adapter _____

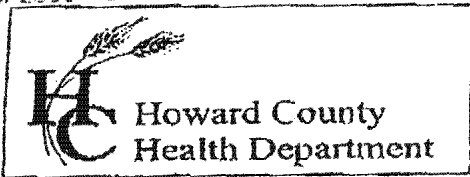

7178 Columbia Gateway Drive, Columbia MD 21046
 (410) 313-2640 Fax (410) 313-2648
 TDD (410) 313-2323 Toll Free 1-866-313-6300
 website: www.hchealth.org

Penny E. Borenstein, M.D., M.P.H., Health Officer

TO ALL INTERESTED PARTIES

When submitting a well permit application for a proposed well for new construction, please indicate one of the following:

Well Site Location:

3200 Fox Valley Drive
 Subdivision/Property Name Lot# Road Name

The well site has been staked by _____,
 (professional land surveyor or company employing professional land surveyors)
 on _____ (date) and does not require a site inspection.

The well driller *flagged on 4/28/10* builder or property owner will call the Health Department to schedule a time to meet in the field to verify the proposed well site location.

This sheet, along with two copies of an acceptable well site plan, must be attached to the green well permit application.

Revised 3/11/05



HOWARD COUNTY HEALTH DEPARTMENT

33222

DATE 15 / 3 / 10

Received From

Arono Well Drilling, Inc.

PHONE #

3700 Bush Rd Gaithersville MD 20884

For

90 - the main - well

3200 Fox Valley Dr

CASH

CHECK

NO.

2277

one hundred sixty

Dollars

\$

160 PD

Received By

William [Signature]