

LAYOUT \_\_\_\_\_ INSP 4 \_\_\_\_\_

INSP 2 \_\_\_\_\_ INSP 5 \_\_\_\_\_

INSP 3 \_\_\_\_\_ INSP 6 \_\_\_\_\_

ISSUE DATE: \_\_\_\_\_

APPROVAL DATE: \_\_\_\_\_

# PERMIT INDEXED

P \_\_\_\_\_

A 521550-A

## ON-SITE SEWAGE DISPOSAL SYSTEM HOWARD COUNTY HEALTH DEPARTMENT BUREAU OF ENVIRONMENTAL HEALTH

\_\_\_\_\_ IS PERMITTED TO INSTALL  ALTER

ADDRESS: \_\_\_\_\_ PHONE NUMBER: \_\_\_\_\_

SUBDIVISION: \_\_\_\_\_ LOT NUMBER: \_\_\_\_\_

ADDRESS: 11036 Harding Road PROPERTY OWNER: Marsha Engel

SEPTIC TANK CAPACITY (GALLONS): \_\_\_\_\_ OUTLET BAFFLE FILTER REQUIRED

PUMP CHAMBER CAPACITY (GALLONS): \_\_\_\_\_ COMPARTMENTED TANK REQUIRED

NUMBER OF BEDROOMS: \_\_\_\_\_

SQUARE FEET PER BEDROOM: \_\_\_\_\_

LINEAR FEET OF TRENCH REQUIRED: \_\_\_\_\_

|           |   |
|-----------|---|
| TRENCHES: | Trench to be _____ feet wide. Inlet _____ feet below original grade. Bottom maximum depth _____ feet below original grade. Effective area begins at _____ feet below original grade. _____ feet of stone below distribution pipe. |
| LOCATION: | _____   |
| NOTES:    | _____   |

PLANS APPROVED: \_\_\_\_\_ DATE: \_\_\_\_\_

- NOTE: PERMIT VOID AFTER 2 YEARS
- NOTE: CONTRACTOR RESPONSIBLE FOR SCHEDULING A PRE-CONSTRUCTION INSPECTION FOR ALL INSTALLATIONS
- NOTE: WATERTIGHT SEPTIC TANKS REQUIRED
- NOTE: ALL PARTS OF SEPTIC SYSTEM SHALL BE 100 FEET FROM ANY WATER WELL
- NOTE: MANHOLE RISERS REQUIRED ON ALL SEPTIC TANKS AND PUMP CHAMBERS UNLESS SPECIFICALLY AUTHORIZED

**NEITHER THE HOWARD COUNTY COUNCIL NOR THE HEALTH DEPARTMENT IS RESPONSIBLE FOR THE SUCCESSFUL OPERATION OF ANY SYSTEM PERMITTEE RESPONSIBLE FOR OBTAINING FINAL APPROVAL ON THIS PERMIT CALL 410-313-2640 FOR INSPECTION OF SEPTIC SYSTEM**

A521550-A

6/25/02

11:00

6/25/02 (MR)

NO OBJ. TO DECK,  
OWNER ~~DOES~~ COMMITTS TO  
~~DO~~ PROPER FILLING OF  
HAND DUG WITHIN 120 DAYS  
(BY WELL DRILLER)  
NO OBJ. TO DECK BP

1/23/03 DC w/OWNER -  
~~DOES~~ SHE REPORTS NO SUCCESS  
IN HIRING DRILLER; 4 NEW  
NAMES OF DRILLERS GIVEN

8/3/04 NO RECORD OF  
WELL AB.

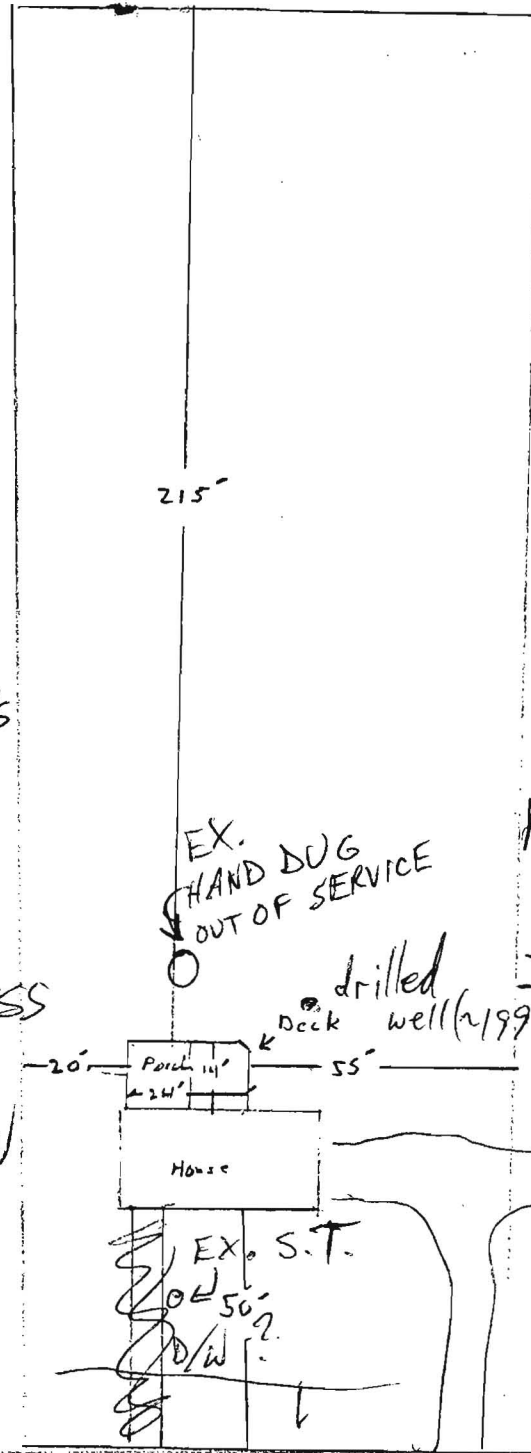

6/6/02 (MR)

PER Co. Finance  
No Record of Conn.  
to Pub. H<sub>2</sub>O or  
Sewer.

No Record of  
Septic System, Well  
Insp req'd

HARDING ROAD

Murphy Sundecks LLC

scale  
1" = 40'

11036 Harding Rd.  
Laurel MD. 20723

Lot 1  
Map 46  
Zone R20