

# APPLICATION

PERCOLATION TESTING

A 516063

P \_\_\_\_\_

HOWARD COUNTY HEALTH DEPARTMENT  
BUREAU OF ENVIRONMENTAL HEALTH  
3525-H ELLICOTT MILLS DRIVE/ELLICOTT CITY, MARYLAND 21043  
TELEPHONE: 313-2840

DISTRICT 5TH

DATE 2/9/01

TO: THE COUNTY HEALTH OFFICER  
ELLICOTT CITY, MARYLAND

I HEREBY APPLY FOR THE NECESSARY TEST PRIOR TO APPLICATION FOR PERMIT TO CONSTRUCT (OR RECONSTRUCT) A SEWAGE DISPOSAL SYSTEM.

PROPERTY OWNER D.R. HORTON  
ADDRESS 1370 PICCARD DRNE  
ROCKVILLE MD 20850 PHONE 301-670-6144

AGENT OR PROSPECTIVE BUYER CLARK SPERRY  
ADDRESS P.O. BOX 417  
ELLICOTT CITY MD 21041 PHONE 410-465-4244

PROPERTY LOCATION:

SUBDIVISION PALMER PROPERTY LOT NO. \_\_\_\_\_

ROAD AND DESCRIPTION TEN OAKS ROAD  
CLARKSVILLE

TAX MAP 34 PARCEL # 77

SIZE OF LOT 1 AC ± TYPE BLDG. SINGLE FAMILY DETACHED  
(SINGLE FAMILY DWELLING OR COMMERCIAL)

THE SYSTEM INSTALLED UNDER THIS APPLICATION IS ACCEPTABLE ONLY UNTIL PUBLIC FACILITIES BECOME AVAILABLE. I FULLY UNDERSTAND THE FEE CONNECTED WITH THE FILING OF THIS PERC TEST APPLICATION IS NON-REFUNDABLE UNDER ANY CIRCUMSTANCES. I ALSO AGREE TO COMPLY WITH ALL M.O.S.H.A. REQUIREMENTS IN TESTING THIS LOT.

(SIGNATURE OF APPLICANT)

APPROVED BY \_\_\_\_\_ FOR \_\_\_\_\_ DATE \_\_\_\_\_

DISAPPROVED BY \_\_\_\_\_ FOR \_\_\_\_\_ DATE \_\_\_\_\_

HOLD PENDING FURTHER TESTS \_\_\_\_\_

REASONS FOR REJECTION OR HOLDING \_\_\_\_\_

PERCOLATION TEST PLAT/PRELIMINARY PLAT - TITLE OR I.D. # \_\_\_\_\_ DATE \_\_\_\_\_

SITE DEVELOPMENT PLAN/FINAL PLAT - TITLE OR I.D. # \_\_\_\_\_ DATE \_\_\_\_\_

# THIS IS NOT A PERMIT

COUNTY #

SOIL PROFILE

0' (89)  
 Red Br Loam 4.5-5'  
 Or Br Loam 6.5'  
 15-20% Rock  
 Med Br Sa Loam  
 Very Little Rock  
 No Obvious Mottling  
 Water 13'

SOIL PROFILE

0' (90)  
 Red Br Heavy Loam 3.5-4'  
 Or Red Si Loam  
 Very Little Rock 5.5-6'  
 Light Br Sa Loam  
 25-30% Rock  
 Hard Bottom 8.5'

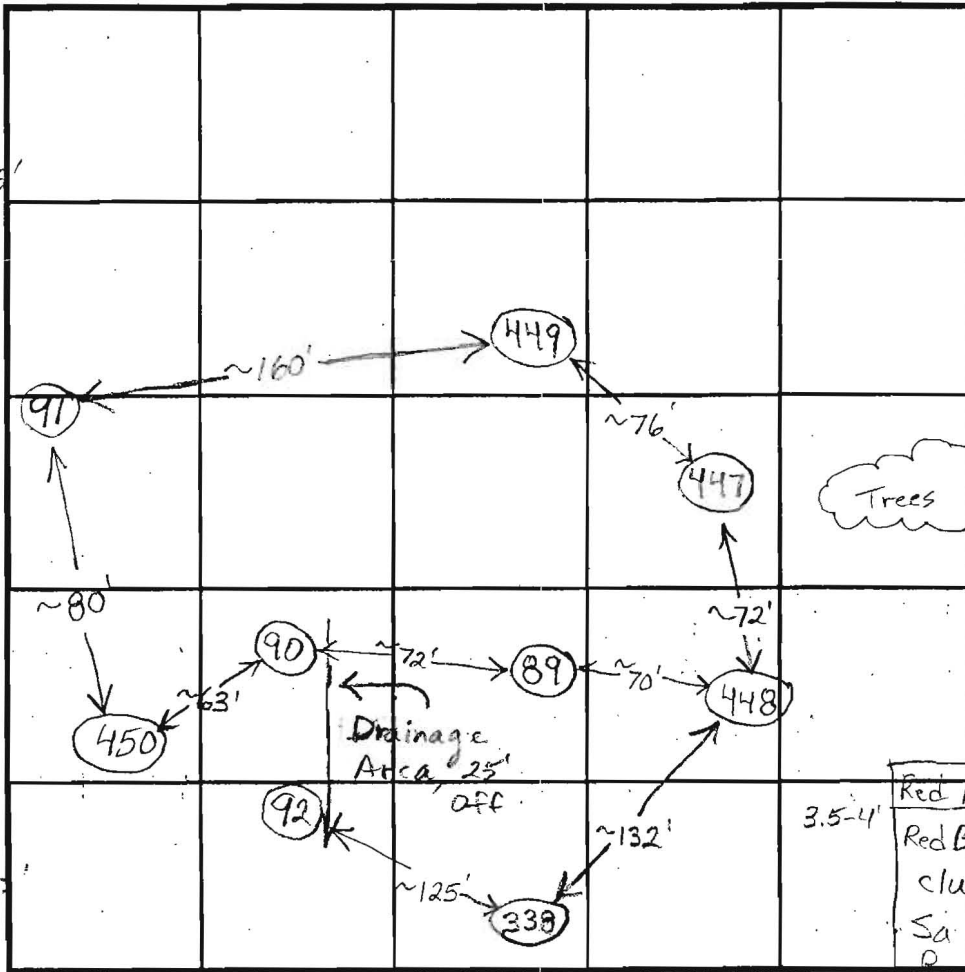

(338)  
 Red Br Mottled Loam  
 Red Br and Gray, Wet clumpy, Mottled  
 Sa Loam Very Little Rock,  
 Water

(447)  
 Red Br Heavy Loam 4-4.5'  
 Or Br Heavy Si Loam  
 Very Little Rock 6.5'  
 Or Br Si Loam  
 Very Little Rock 8'  
 Med Br Sa Loam  
 Very Little Rock  
 ~25% Saprolite  
 Wet/Clumpy at Very Bottom 14'

(449) (91)  
 Br Heavy Loam 3.5-4.5'  
 Red Br Dense Si Loam  
 ~10% Rock 6'  
 Light Br Sa Loam  
 ~25% Soft Saprolite  
 Wet/Mottled at Very Bottom 14'

DATE	TEST NO.	DEPTH	PRE-WET		TEST - 1" DROP		TIME	
			START	STOP	START	STOP		
4/21/03	89	4'3"/13'V	3:11	~1/8" in 30 minutes			Slow	O.K.
		6'	3:13	3:30	3:30	3:51	21	
	447	5'/14'V	3:47	~1/4" in 10 minutes			Slow	O.K.
		6'10"	3:47	3:59:30	3:59:30	4:17	17 1/2	
4/22/03	449	6'/14'V	9:19	9:36	9:36	10:05	29	O.K.
		7'	9:19	9:24:30	9:24:30	9:31:30	7	
	Similar 91	5.5'/12'V	9:46	~1/4" in 10 minutes			Slow	O.K.
	to 449 but Hard Bottom at 12'	7.5'	9:45	9:50	9:50	9:58	8	
		6'2"	10:40	10:52	10:52	11:09:30	17 1/2	
	90	4'8"/8.5'V	10:45:30	10:57:30	10:57:30	11:21:30	24	(F)

REMARKS: 338 8'V (E)  
 TYPE OF SOIL: 90 Failed - Surrounding Holes Won't Pass Shallow / Next to Drainage Area  
 TESTED BY: B. Baker ALSO PRESENT  
 TRENCH DESIGN DATA: AVERAGE PERCOLATION TIME \_\_\_\_\_ TRENCH WIDTH \_\_\_\_\_  
 INLET DEPTH \_\_\_\_\_ MAXIMUM BOTTOM DEPTH \_\_\_\_\_ SQ. FT./BEDROOM \_\_\_\_\_

# APPLICATION

PERCOLATION TESTING

A 516063

P \_\_\_\_\_

HOWARD COUNTY HEALTH DEPARTMENT  
BUREAU OF ENVIRONMENTAL HEALTH  
3525-H ELLICOTT MILLS DRIVE/ELLICOTT CITY, MARYLAND 21043  
TELEPHONE: 313-2840

DISTRICT 5TH

DATE 2/9/01

TO: THE COUNTY HEALTH OFFICER  
ELLICOTT CITY, MARYLAND

I HEREBY APPLY FOR THE NECESSARY TEST PRIOR TO APPLICATION FOR PERMIT TO CONSTRUCT (OR RECONSTRUCT) A SEWAGE DISPOSAL SYSTEM.

PROPERTY OWNER D.R. HORTON  
ADDRESS 1370 PICCARD DRNE  
ROCKVILLE MD 20850 PHONE 301-670-6144

AGENT OR PROSPECTIVE BUYER CLARK SPERRY  
ADDRESS P.O. BOX 417  
ELLICOTT CITY MD 21041 PHONE 410-465-4244

PROPERTY LOCATION:

SUBDIVISION PALMER PROPERTY LOT NO. \_\_\_\_\_

ROAD AND DESCRIPTION TEN OAKS ROAD  
CLARKSVILLE

TAX MAP 34 PARCEL # 77

SIZE OF LOT 1 AC ± TYPE BLDG. SINGLE FAMILY DETACHED  
(SINGLE FAMILY DWELLING OR COMMERCIAL)

THE SYSTEM INSTALLED UNDER THIS APPLICATION IS ACCEPTABLE ONLY UNTIL PUBLIC FACILITIES BECOME AVAILABLE. I FULLY UNDERSTAND THE FEE CONNECTED WITH THE FILING OF THIS PERC TEST APPLICATION IS NON-REFUNDABLE UNDER ANY CIRCUMSTANCES. I ALSO AGREE TO COMPLY WITH ALL M.O.S.H.A. REQUIREMENTS IN TESTING THIS LOT.

(SIGNATURE OF APPLICANT)

APPROVED BY \_\_\_\_\_ FOR \_\_\_\_\_ DATE \_\_\_\_\_

DISAPPROVED BY \_\_\_\_\_ FOR \_\_\_\_\_ DATE \_\_\_\_\_

HOLD PENDING FURTHER TESTS \_\_\_\_\_

REASONS FOR REJECTION OR HOLDING \_\_\_\_\_

PERCOLATION TEST PLAT/PRELIMINARY PLAT - TITLE OR I.D. # \_\_\_\_\_ DATE \_\_\_\_\_

SITE DEVELOPMENT PLAN/FINAL PLAT - TITLE OR I.D. # \_\_\_\_\_ DATE \_\_\_\_\_

## THIS IS NOT A PERMIT

COUNTY #

SOIL PROFILE

0' (328)  
 Red Br Loam 3.5'-4'  
 Light Br and Beige Sa Loam getting Darker with Depth Very Little Rock 6.5'  
 Caving 8.5'  
 Wet and Mottled Water 10'

(446)  
 Red Br Loam 3'  
 Red Br Loam and Mottled? Gray Beige, Red, or + Yellow Sa Loam 5'  
 Sa Loam Mottled? Very Little Rock 8.5'  
 Water

(445)  
 Red Br Loam 4.5'-5'  
 Or Br Si Loam Caving Below 6.5' ~10% Rock 7.5-8.5'  
 Beige and Gray Sa Loam Very Little Rock Mottled Below 8.5' Maybe Higher Water 9.5'

SOIL PROFILE

0' (78)  
 Red Br Heavy Loam 3'-4'  
 Or Sa Loam with some Or Red Si Layers Very Little Rock 8'  
 Caving 8.5'  
 Gray Mottling Water 10.5'

(448)  
 Red Br Loam 4.5'-5.5'  
 Brown, Or and Gray clumpy Mica with a Silty texture - Very Little Rock Mottled Below 9.5' and maybe Higher Water Caving 7'

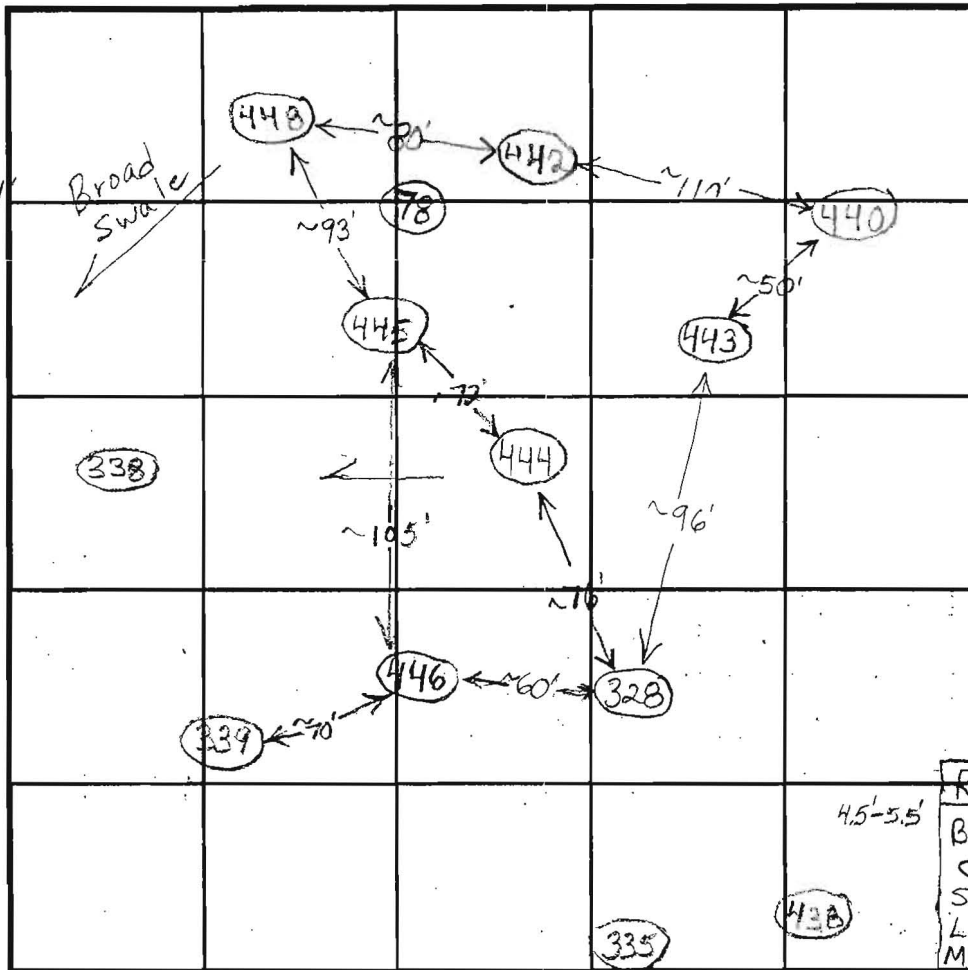

INDICATE NORTH - NAME ADJOINING ROADWAY AS BASE LINE.

DATE	TEST NO.	DEPTH	PRE-WET		TEST - 1" DROP		TIME		
			START	STOP	START	STOP			
4/21/03	328	4.5'/10' V	12:37	12:48	12:48	1:12	24	Marg.	
		6'10"	12:37:30	12:43	12:43	12:51:30	8 1/2		
	446	3'10"/8.5'	1:20:30	1:33	1:33	1:47	14	Very Marg.	
		Caved to Surface Due Out 7'	1:18	1:22	1:22	1:28:45	~7		
	445	4'3"/9.5' V	1:58	~1/4" in 15 minutes			Slow	(F)	
		7'	1:57:30	2:08	2:08	2:23	15		
	78	5'11' V	2:27	2:29:45	2:29:45	2:36	~7	Marg.	
	444	Kept Caving in While Digging							(F)
	448	4'8"/10.5' V	2:49	~1/4" in 10 minutes			Slow	(F)	
		6'9"	2:48:45	2:57	2:57	3:22	25		

REMARKS: 328, 448 + 78 May Be O.K For a Very Shallow System

TYPE OF SOIL \_\_\_\_\_

TESTED BY B. Baker ALSO PRESENT \_\_\_\_\_

TRENCH DESIGN DATA: AVERAGE PERCOLATION TIME \_\_\_\_\_ TRENCH WIDTH \_\_\_\_\_

INLET DEPTH \_\_\_\_\_ MAXIMUM BOTTOM DEPTH \_\_\_\_\_ SQ. FT./BEDROOM \_\_\_\_\_

