

6/18/75
trench inspection

~~File # 610275~~ File # 610275
Repair when
house built

PERMIT

P 21604
513625 P
A 19911

SEWAGE DISPOSAL SYSTEM

MARYLAND STATE DEPARTMENT OF HEALTH

HOWARD COUNTY

ELLICOTT CITY

INDEXED

DISTRICT 5

DATE 6/3/75

Harold Brown

IS PERMITTED TO INSTALL ALTER

ADDRESS 10217 Wesleigh Drive, Simpsonville, Md, 21046 PHONE 997-8437

A SEWAGE DISPOSAL SYSTEM LOCATED AT

- 7993
594.5691

SUBDIVISION Colonial Marsh Farm I ROAD 4179 Heritage Hill Lane Holly Quarter Road LOT 10

PROPERTY OWNER Harold Brown

ADDRESS

SPECIFICATIONS - 4 bedrooms

DRAIN FIELD DEPTH FEET, BOTTOM AREA SQ. FT.

SEEPAGE PITS ABSORBENT SIDE-WALL AREA SQ. FT.

SEPTIC TANK CAPACITY 1,250 GALLONS

FOR GARBAGE GRINDER, INCREASE DISPOSAL AREA 22% & TANK CAPACITY 50%.

OTHER There will be 190 sq. ft. of absorbent sidewall area per bedroom. (760 sq. ft. for 4 bedrooms). The inlet will be located 2 ft. below original grade with a maximum depth not to exceed 10 ft. If water is encountered all work is to cease and the Health Department is to be notified immediately. It will be permitted to use more than one dry well or a dry well and trench. If this change in design is used, the system will run parallel to the property line designated at N89°50'00" E in a direction toward the road. The dry well will be located 183 ft. from the 887 ft. property line and 262 ft. from the point where it intersects the road.

NOTE: ALL PIPE FROM HOUSE TO DISPOSAL AREA MUST BE CAST IRON.

PERMIT VOID AFTER THREE YEARS.

PLANS APPROVED BY R. Moorefield DATE 5/29/74

NOTE: INSTALL STAND PIPES ON SEPTIC TANK AND DRY WELL. CLEANOUT MUST BE 6" IN DIA., CAST

FILL SEPTIC TANK AND DISTRIBUTION BOX WITH WATER BEFORE CALLING FOR AN INSPECTION. COVER NO WORK UNTIL INSPECTED AND APPROVED.

IRON, CONCRETE OR TERRA COTTA ACCEPTED.

NEITHER THE HOWARD COUNTY COMMISSIONERS NOR THE HEALTH DEPARTMENT IS RESPONSIBLE FOR THE SUCCESSFUL OPERATION OF ANY SYSTEM.

BUILDING PERMIT WILL NOT BE SIGNED UNTIL SYSTEM IS INSTALLED AND APPROVED.

BLDG. PERMIT SIGNED
AND RETURNED 6/11/75

AS13625 P A

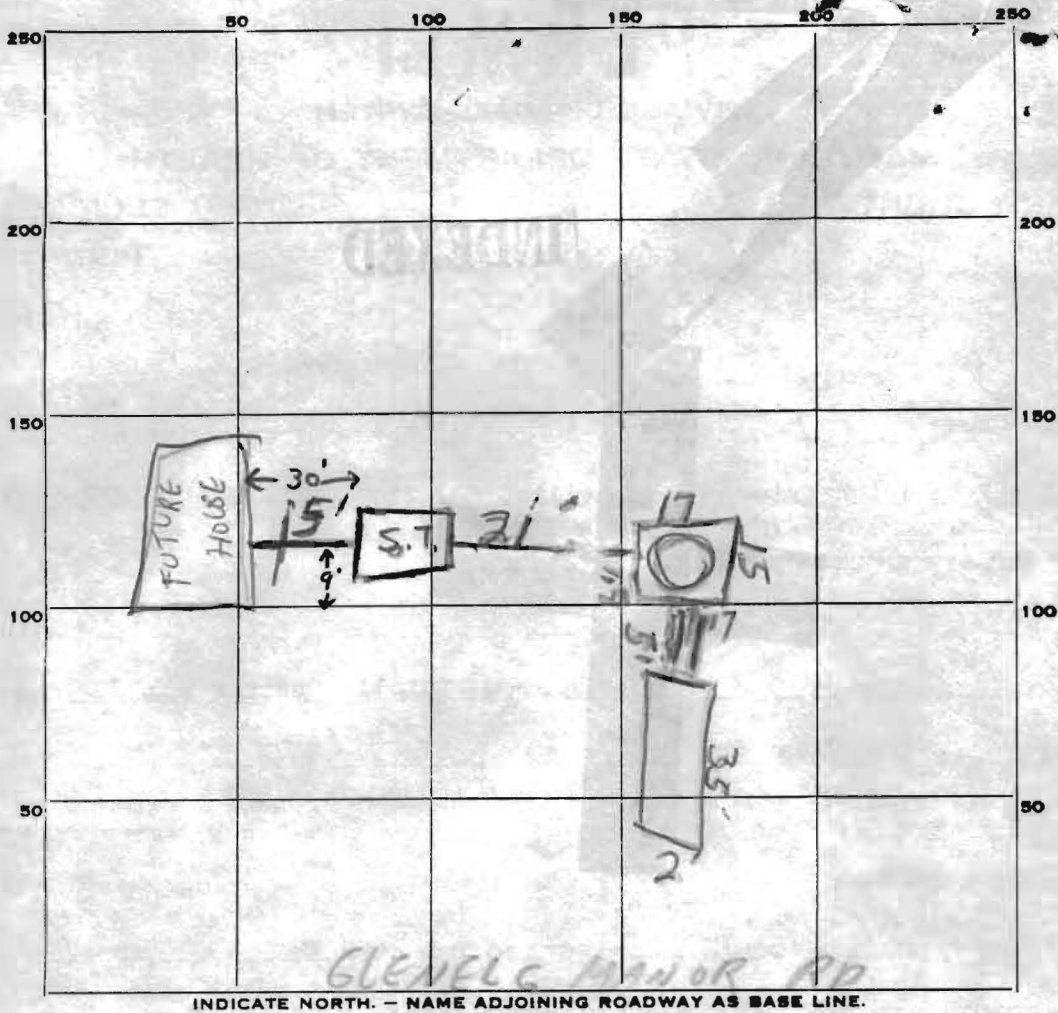

location
ok

INDICATE NORTH. - NAME ADJOINING ROADWAY AS BASE LINE.

PERMIT CARD SK

SEPTIC TANK, LEVEL OK CLEANOUTS OK

DISTRIBUTION BOX, LEVEL N/A

TILE FIELD, DEPTH 9 FT. TRENCH WIDTH 2 FT.

GRAVEL DEPTH 7 1/2 IN. TOTAL LENGTH 35 FT.

NUMBER OF TRENCHES 1 TOTAL BOTTOM AREA _____

SEEPAGE PITS, INSIDE DIAMETER OUTSIDE PERIMETER 66 FT. DEPTH BELOW INLET 8 FT.

ABSORBENT AREA 58 0. W / TRENCH 262 SQ. FT. TOTAL 790

REMARKS OK TO COVER

8/5/75 House not started yet S.S.

1/30/76 House now connected

DATE SYSTEM APPROVED 6-10-75 INSPECTOR 91-J-3lov

