

# PERMIT

7/16/82  
APPROVED P 32020  
RA A 31875

SEWAGE DISPOSAL SYSTEM

MARYLAND STATE DEPARTMENT OF HEALTH\*

HOWARD COUNTY

ELLICOTT CITY

DISTRICT 4th

## INDEX

DATE 7/12/82

Olen Ketterman

IS PERMITTED TO INSTALL  ALTER

ADDRESS 14960 Frederick Road, Woodbine, Maryland 21797 PHONE 442-1336

SUBDIVISION Hoods Mill Farm ROAD 828 Hoods Mill Road LOT Parcel F

PROPERTY OWNER Bruce W. Vaden

Phone: 988-9219

ADDRESS

SPECIFICATIONS 3 bedrooms

SEPTIC TANK CAPACITY 1000 GALLONS

DRAIN FIELD DEPTH FEET, BOTTOM AREA SQ. FT.

DEEP TRENCH DEPTH FEET, BOTTOM AREA SQ. FT.

SEEPAGE PITS ABSORBENT SIDE-WALL AREA SQ. FT.

INLET PIPE FT. BELOW ORIGINAL GRADE, MAXIMUM DEPTH FT. BELOW ORIGINAL GRADE

EFFECTIVE DEPTH AT FT. BELOW ORIGINAL GRADE.

LOCATE DISPOSAL AREA FT. FROM LOT LINE AND FT. FROM LOT LINE AS SEEN WHEN

FACING LOT FROM

SHALLOW TRENCHES - 147 sq. ft. <sup>sidewall</sup> ~~bottom~~ area per bedroom. Ditch is to be 2 ft. wide, 3 ft. deep, with inlet at 3 ft. below original grade and filled with 3-3 1/2 ft. of stone. Length of the ditch deepens on the number of sq. ft. needed. Start the ditch at perc hole #2 and run it along level ground toward perc hole #3. Perc hole #2 is located 135 ft. from the front lot line and 15 ft. from the right lot line as seen when facing the lot from the front lot line. Perc hole #3 is located 25 ft. from the front lot line and 135 ft. from the right lot line as seen when facing the lot from the front lot line. The front lot line is the 395.57 ft. long lot line. Use

PLANS APPROVED BY Frank Skinner and Raymond Hodges DATE 4/28/82 & 7/14/82

a distribution box. No trench ~~ex~~ over 100 ft. long.

COVER NO WORK UNTIL INSPECTED AND APPROVED. 7/15/81 O.K. to set D box in trench & run to head with way P.S.

NEITHER THE HOWARD COUNTY COUNCIL NOR THE HEALTH DEPARTMENT IS RESPONSIBLE FOR THE SUCCESSFUL OPERATION OF ANY SYSTEM.

NOTE: IF TRENCH IS USED CALL FOR INSPECTION BEFORE PLACING GRAVEL IN TRENCH.

NOTE: NO DRY WELL SHALL EXCEED 15 FOOT IN DIAMETER.

NOTE: ALL PIPE FROM HOUSE TO DISPOSAL AREA MUST BE CAST IRON.

PERMIT VOID AFTER THREE YEARS.

NOTE: INSTALL STAND PIPE ON SEPTIC TANK AND DRY WELL. STAND PIPES MUST BE 6 INCHES IN DIAMETER. CAST IRON, CONCRETE OR TERRA COTTA ACCEPTED.

\*INSTALLER IS RESPONSIBLE FOR OBTAINING FINAL APPROVAL ON THIS PERMIT.

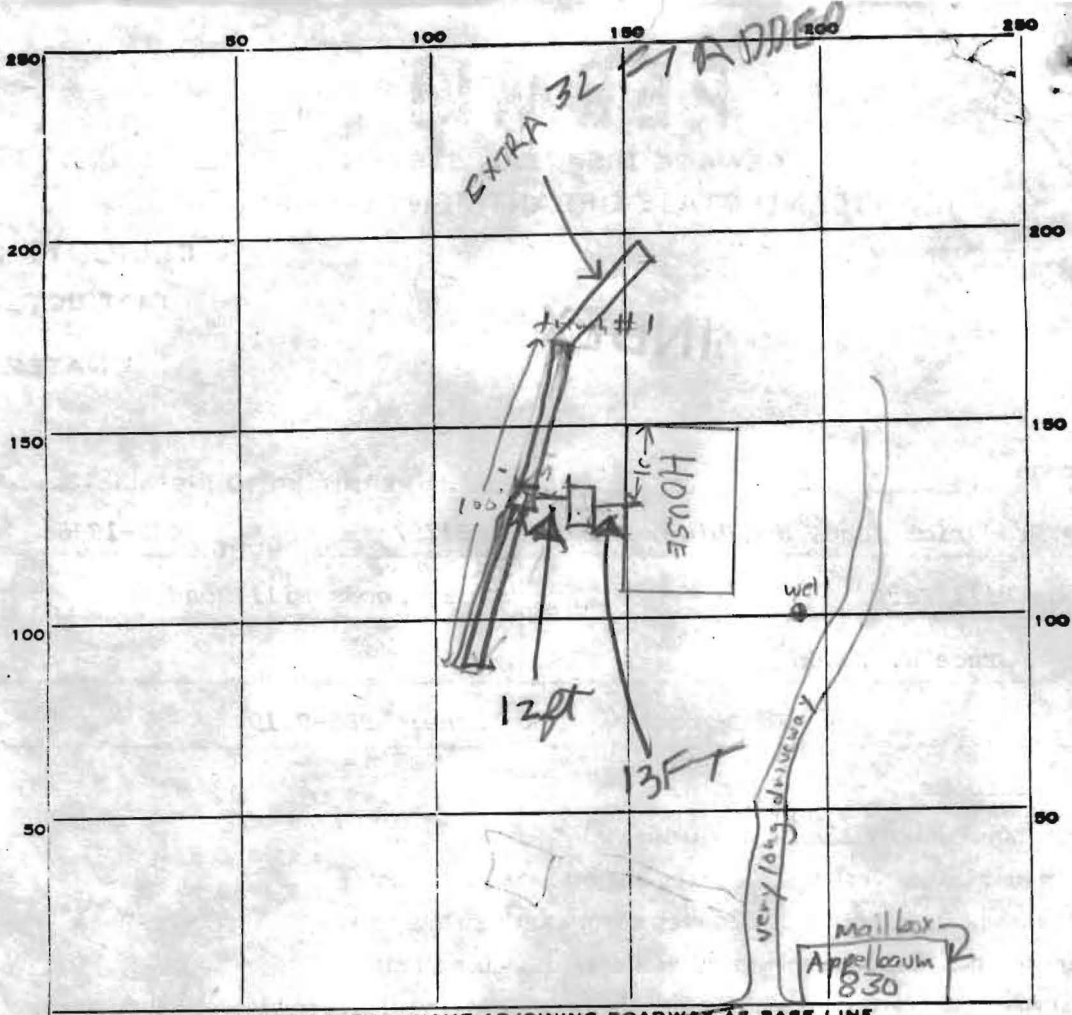

INDICATE NORTH. - NAME ADJOINING ROADWAY AS BASE LINE.

Rte 97

PERMIT CARD \_\_\_\_\_

SEPTIC TANK, LEVEL OK

CLEANOUTS S.T. OK

DISTRIBUTION BOX, LEVEL OK

TILE FIELD, DEPTH 6-7 avg. 6 1/2' FT. TRENCH WIDTH 2 FT.

GRAVEL DEPTH 3 FT. #1 sand 100' long TOTAL LENGTH 132 FT.

NUMBER OF TRENCHES \_\_\_\_\_ ONE SIDEWALL TOTAL BOTTOM AREA \_\_\_\_\_

SEEPAGE PITS, INSIDE DIAMETER \_\_\_\_\_ FT. DEPTH BELOW INLET \_\_\_\_\_ FT.

ABSORBENT AREA \_\_\_\_\_ SQ. FT.

REMARKS 7/14/82 O.K. to add gravel in tank #1 F.S. 7/16/82 OK TO

COVER TANK HOUSE SEWER & HALF OF TRENCH

ADD STONE TO REST OF DITCH & CALL RH

7/16/82 300 STONE ADDED TO REST OF DITCH RH

DATE SYSTEM APPROVED 7/16/82

INSPECTOR Raymond Hodges