

PUB. SEWER STATUS VERIFIED BY _____

ISSUE DATE: 06/15/07

P 527219

APPROVAL DATE: 8/27/07

PERMIT

A UPGRADE

Tax ID # 03-297551

ON-SITE SEWAGE DISPOSAL SYSTEM HOWARD COUNTY HEALTH DEPARTMENT BUREAU OF ENVIRONMENTAL HEALTH

Iris K. Ritter IS PERMITTED TO INSTALL ALTER

ADDRESS: 12280 Howard Lodge Drive PHONE NUMBER: 410-489-4386

SUBDIVISION: _____ LOT NUMBER: _____

ADDRESS: Same as above PROPERTY OWNER: Iris K. Ritter

SEPTIC TANK CAPACITY (GALLONS): 1500

PUMP CHAMBER CAPACITY (GALLONS): N/A

NUMBER OF BEDROOMS: 4

SQUARE FEET PER BEDROOM: _____

LINEAR FEET OF TRENCH REQUIRED: 207.5

TRENCHES:	Trench to be 3.0 feet wide. Inlet 3.0 feet below original grade. Bottom maximum depth 5.0 feet below original grade. Effective area begins at 4.0 original grade. 2.0 feet of stone below distribution pipe.
LOCATION:	Install as instructed by HCHD personnel at the pre-construction layout inspection.
PURPOSE:	Existing septic to be upgraded in support of building permit #B07001852 Call for inspection when ground is opened so sanitarian can recommend repair.

PLANS APPROVED: Gabriel A Creighton DATE: 07/16/2007

- NOTE: PERMIT VOID AFTER 2 YEARS
- NOTE: CONTRACTOR RESPONSIBLE FOR SCHEDULING A PRE-CONSTRUCTION INSPECTION FOR ALL INSTALLATIONS
- NOTE: WATERTIGHT SEPTIC TANKS REQUIRED
- NOTE: ALL PARTS OF SEPTIC SYSTEM SHALL BE 100 FEET FROM ANY WATER WELL
- NOTE: MANHOLE RISERS REQUIRED ON ALL SEPTIC TANKS AND PUMP CHAMBERS

NEITHER THE HOWARD COUNTY COUNCIL OR THE HEALTH DEPARTMENT IS RESPONSIBLE FOR THE SUCCESSFUL OPERATION OF ANY SYSTEM PERMITTEE RESPONSIBLE FOR OBTAINING FINAL APPROVAL ON THIS PERMIT CALL 410-313-2640 FOR INSPECTION OF SEPTIC SYSTEM

NOT TO SCALE

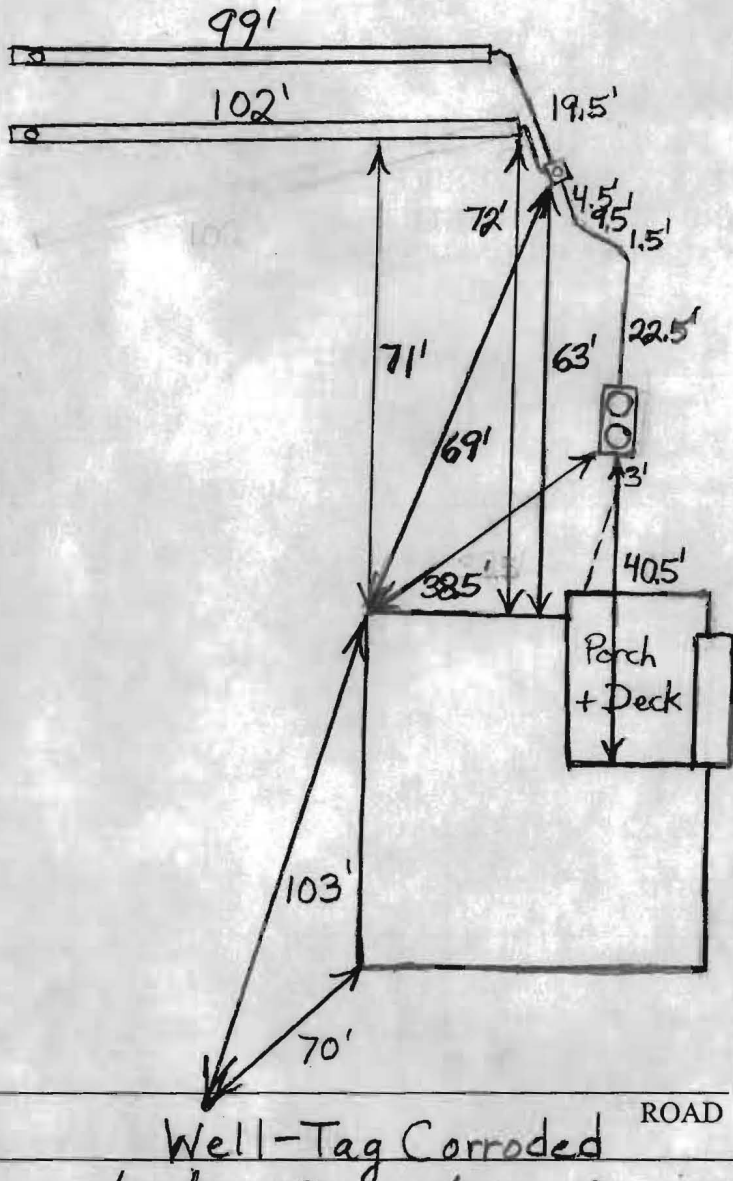

TRENCH/DRAINFIELD DATA		
WIDTH	INLET	BOTTOM
3'	3'	5'
NUMBER OF TRENCHES		2
TOTAL LENGTH		201'
ABSORPTION AREA		603 + Sidewalk
DISTRIBUTION BOX LEVEL		Yes
DISTRIBUTION BOX BAFFLE		Yes
DISTRIBUTION BOX PORT		Yes

SEPTIC TANK DATA	
SEPTIC TANK 1 LEVEL	Yes
CAPACITY	1500 GAL
SEAM LOC	Top
TANK LID DEPTH	1'-2'
BAFFLES	Yes
BAFFLE FILTER	No
MANHOLE LOC	Front + Rear
6" PORT LOC	None
WATERTIGHT TEST	No
SEPTIC TANK 2 LEVEL	N/A
CAPACITY	_____ GAL
SEAM LOC	_____
TANK LID DEPTH	_____
BAFFLES	_____
BAFFLE FILTER	_____
MANHOLE LOC	_____
6" PORT LOC	_____
WATERTIGHT TEST	_____

PRE-CONSTRUCTION 8/22/07 A good portion of upper part of easement is unusable because of swale and trees.

INSTALLATION Dug additional perc. test hole (H). Install 2-105' trenches on contour in area of test holes C+G. Set new 1500 gallon tank so that there is 3' or less of cover over it but not in middle of swale. (BB)

8/23/07 New tank set. Old tank pumped out and filled with stone. Top trench done. Plumbing to distribution box finished. (BB)

8/24/07 No work done. (BB)

8/27/07 Bottom trench done. O.K. to backfill. (BB)

FINAL INSPECTOR B. Baker DATE OF APPROVAL 8/27/07