

5-28-84
ASAP

05-35097a

5/28/86
OK'd repair
(bn)

PERMIT

P. 37187

A. REPAIR

SEWAGE DISPOSAL SYSTEM

MARYLAND STATE DEPARTMENT OF HEALTH*

HOWARD COUNTY
BUREAU OF ENVIRONMENTAL HEALTH
~~XXXXXXXX~~
461-9933

ELLICOTT CITY

INDEXED

DISTRICT _____

DATE 6/16/86

_____ Jack Fyock _____ IS PERMITTED TO INSTALL _____ ALTER X _____

ADDRESS _____ PHONE 988-9270

SUBDIVISION _____ ROAD 14186 Howard Road LOT _____

PROPERTY OWNER _____ Gibson _____

ADDRESS _____

IF GARBAGE GRINDER IS USED INCREASE SEPTIC TANK CAPACITY BY 50% AND ABSORPTION AREA BY 22%.

GARBAGE GRINDER? YES _____ NO X

SEPTIC TANK CAPACITY _____ GALLONS NUMBER OF BEDROOMS 3

REPAIR - CALL FOR INSPECTION WHEN GROUND IS OPENED UP SO SANITARIAN CAN RECOMMEND

REPAIR.

Variable soils (some mica, sand & clay)
OK to use leaching system (4' deep)

PLANS APPROVED BY _____ C. Williams _____ DATE 5/23/86

COVER NO WORK UNTIL INSPECTED AND APPROVED.

NEITHER THE HOWARD COUNTY COUNCIL NOR THE HEALTH DEPARTMENT IS RESPONSIBLE FOR THE SUCCESSFUL OPERATION OF ANY SYSTEM.

NOTE: IF TRENCH IS USED CALL FOR INSPECTION BEFORE AND AFTER PLACING GRAVEL IN TRENCH.

NOTE: NO DRY WELL SHALL EXCEED 15 FOOT IN DIAMETER. NO ABSORPTION TRENCH TO EXCEED 100 FEET IN LENGTH.

NOTE: ALL PIPE FROM HOUSE TO SEPTIC TANK MUST BE CAST IRON OR SCHEDULE 40 PVC OR ABS.

PERMIT VOID AFTER THREE YEARS.

NOTE: INSTALL STAND PIPE ON SEPTIC TANK AND DRY WELL. STAND PIPES MUST BE 6 INCHES IN DIAMETER CAST IRON, CONCRETE OR TERRA COTTA, OR PVC OR ABS ACCEPTED. IF TOP OF SEPTIC TANK IS DEEPER THAN 3 FEET MANHOLE TO GRADE REQUIRED

***INSTALLER IS RESPONSIBLE FOR OBTAINING FINAL APPROVAL ON THIS PERMIT**

*CALL 992-2330 FOR INSPECTION OF SEPTIC SYSTEMS.

EH - 2-1082

P. 37187
A. Repair

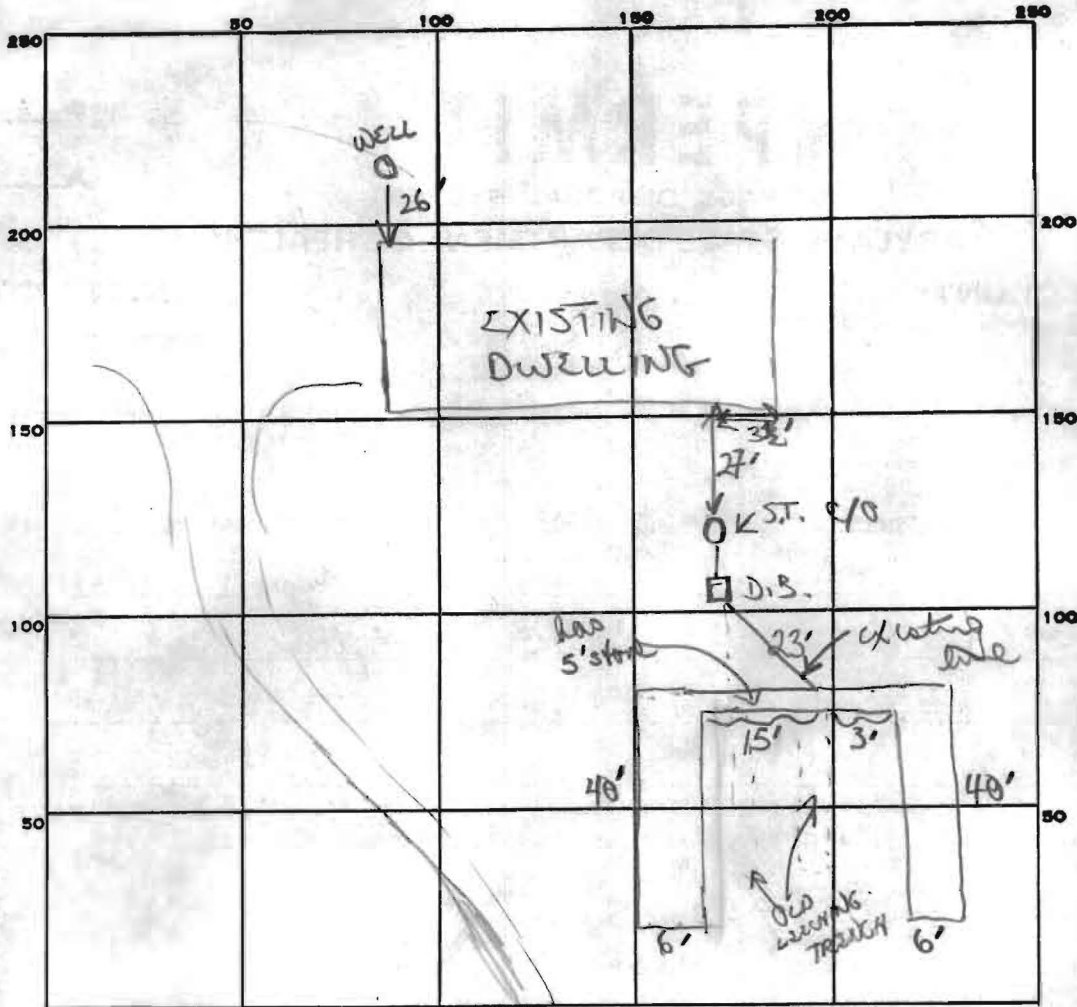

INDICATE NORTH. - NAME ADJOINING ROADWAY AS BASE LINE.

PERMIT CARD final HOWARD RD
 SEPTIC TANK, LEVEL 750-1000 CLEANOUTS 1 ST. EXISTING

DISTRIBUTION BOX, LEVEL EXISTING

TILE FIELD, DEPTH 4 + 4 FT. TRENCH WIDTH 6' FT.

GRAVEL DEPTH 18 IN. TOTAL LENGTH 40 40 FT.

NUMBER OF TRENCHES 2 TOTAL BOTTOM AREA 240 + 240 = 480

SEEPAGE PITS, INSIDE DIAMETER — FT. DEPTH BELOW INLET — FT.

ABSORBENT AREA 480 SQ. FT.

REMARKS OK to use leaching bed system (previous system good
28 years), OK to add stone pipe paper to both trenches
OK to cover trenches + all work

125
 3
 375
 MIN

DATE SYSTEM APPROVED 5/28/86 INSPECTOR B. Wyler