

# APPLICATION

A 08037

SEWAGE DISPOSAL TESTING

P \_\_\_\_\_

MARYLAND STATE DEPARTMENT OF HEALTH

HOWARD COUNTY

ELLICOTT CITY

DISTRICT 5

DATE 2-13-64

Septic Tank - 1000 gal.  
Leaching Bed - 400 sq ft bottom covered, installed with a depth of 5 ft at points nearest front lot line.

Place Leaching Bed in area between 120 and 150 ft from front lot line and between 45 and 110 ft from left side line as seen when facing lot from Hunting Lane.

System must be installed in manner where sewage lift pump will not be used.

TO: THE COUNTY HEALTH OFFICER  
ELLICOTT CITY, MARYLAND

I, HEREBY, APPLY FOR THE NECESSARY TESTS IN ORDER TO CONSTRUCT (OR RECONSTRUCT) A SEWAGE DISPOSAL SYSTEM.

PROPERTY OWNER Frank W. Robbins

ADDRESS 112 Hunting Lane Simpsonville PHONE AT 6-2534

PROPERTY LOCATION:

SUBDIVISION Holiday Hills LOT NO. 62, sec. 5

ROAD AND DESCRIPTION Hunting Lane

OCCUPANT \_\_\_\_\_ PHONE \_\_\_\_\_

PERSON TO CONSTRUCT SYSTEM \_\_\_\_\_

ADDRESS \_\_\_\_\_ PHONE \_\_\_\_\_

SIZE OF LOT 163' X 266' TYPE BLDG. # 4  
NUMBER OF BEDROOMS

IF NOT SINGLE RESIDENCE DESCRIBE \_\_\_\_\_

SIGNATURE OF APPLICANT Frank W. Robbins

APPROVED BY P. D. Fletcher FOR Leaching Bed DATE 2/25/64  
(KIND OF SYSTEM)

REJECTED BY \_\_\_\_\_ FOR \_\_\_\_\_ DATE \_\_\_\_\_  
(KIND OF SYSTEM)

HOLD PENDING FURTHER TESTS \_\_\_\_\_ DATE \_\_\_\_\_

REASONS FOR REJECTION OR HOLDING \_\_\_\_\_

# THIS IS NOT A PERMIT

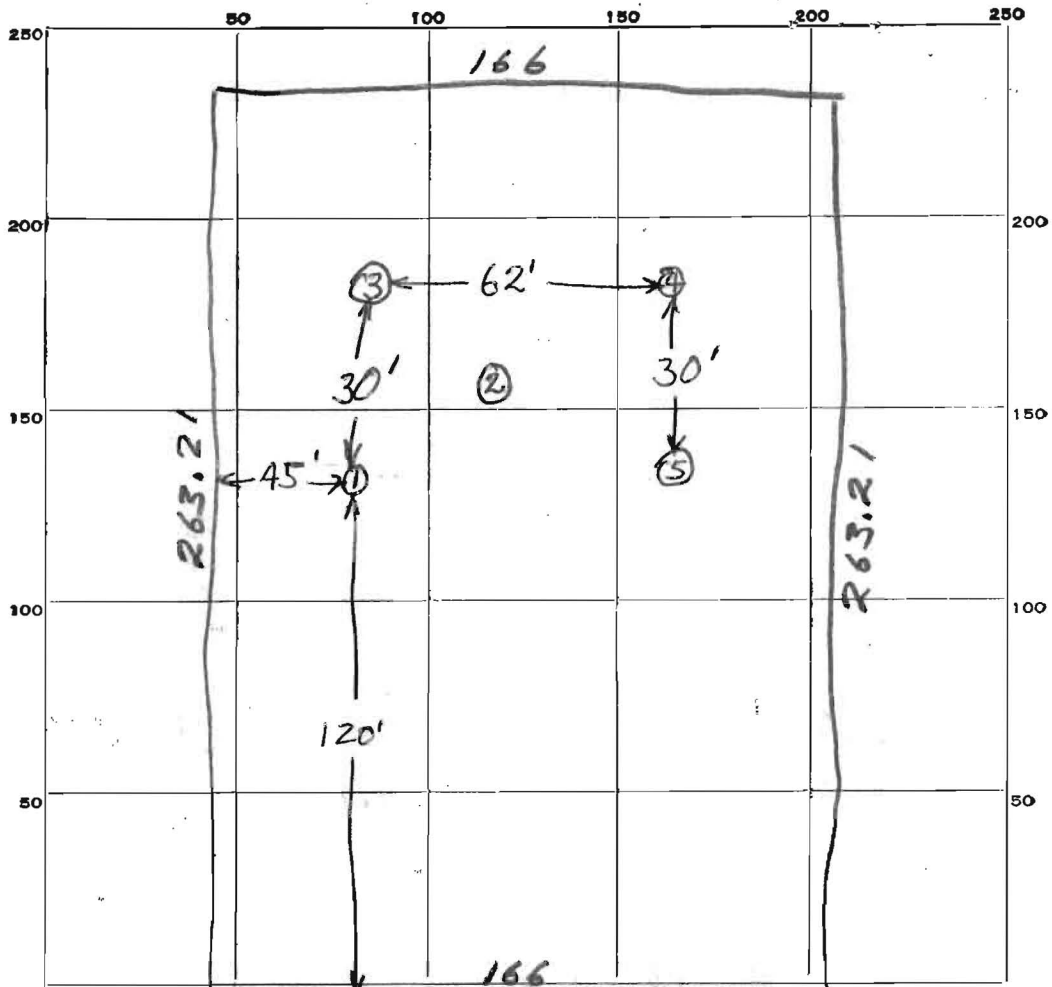

INDICATE NORTH. NAME ADJOINING ROADWAY AS BASELINE.

Hunting Lane

DATE	TEST NO.	DEPTH	PRE-WET		TEST - 1" DROP		TIME	
			START	STOP	START	STOP		
2/25/64	1	4 1/2 ft.	957 <del>1057</del>	1002	1002	1010	8 min.	
	2	9 ft.	1002	1005	1005	1014	9 min.	
	3	7 1/2 ft.	1014	1017	1017	1021	4 min.	
	4	7 ft.	1025	1028	1028	1035	7 min.	
	5	4 ft.	did not test - got same type as other holes					

SOIL AUGER FINDING

TESTED BY: Sum + RDF 2/25/64

REMARKS: Lot lower in front - spot will have to be filled in no case is pump the used for sewage

ALSO PRESENT: W Robbins

LOT NO. 62 Sec 5