

7/1/80

existing file

approved 7/7/80
Kiel + Stamp

PERMIT

SEWAGE DISPOSAL SYSTEM

MARYLAND STATE DEPARTMENT OF HEALTH

HOWARD COUNTY

INDEXED

P 30741

A 29951

ELLCOTT CITY

DISTRICT 5th

DATE 6/26/80

Malcolm Brothers

IS PERMITTED TO INSTALL ALTER

ADDRESS 2001 Briggs Chaney Road, Silver Spring, Md. 20904 PHONE 384-9172

SUBDIVISION ROAD ~~11825 Lime Kiln Road~~ LOT Parcel 89

PROPERTY OWNER Ulrich F. Walter

~~8100 Hunter Brooke Lane~~
~~8229 Hunterbrooke Ln~~

ADDRESS 10088 Hatbrine Terrace, Columbia, Md. 21046

SPECIFICATIONS 4 bedrooms

SEPTIC TANK CAPACITY 1250 GALLONS

DRAIN FIELD DEPTH FEET. BOTTOM AREA SQ. FT.

DEEP TRENCH DEPTH FEET. BOTTOM AREA SQ. FT.

SEEPAGE PITS ABSORBENT SIDE-WALL AREA 130 SQ. FT. per bedroom.

INLET PIPE 3 FT. BELOW ORIGINAL GRADE. MAXIMUM DEPTH 12 FT. BELOW ORIGINAL GRADE

EFFECTIVE DEPTH AT FT. BELOW ORIGINAL GRADE.

LOCATE DISPOSAL AREA 225 FT. FROM back LOT LINE AND 320 FT. FROM left LOT LINE AS SEEN WHEN FACING LOT FROM road.

NOTE: The back lot line is considered to be 559.49 ft. long and runs S 76 degrees 32 feet 30 inches W and the left lot line is 1295.21 ft. long.

PLANS APPROVED BY Raymond Hodges DATE 9/29/79

COVER NO WORK UNTIL INSPECTED AND APPROVED.

NEITHER THE HOWARD COUNTY COUNCIL NOR THE HEALTH DEPARTMENT IS RESPONSIBLE FOR THE SUCCESSFUL OPERATION OF ANY SYSTEM.

NOTE: IF TRENCH IS USED CALL FOR INSPECTION BEFORE PLACING GRAVEL IN TRENCH.

NOTE: NO DRY WELL SHALL EXCEED 15 FOOT IN DIAMETER.

NOTE: ALL PIPE FROM HOUSE TO DISPOSAL AREA MUST BE CAST IRON.

PERMIT VOID AFTER THREE YEARS.

NOTE: INSTALL STAND PIPE ON SEPTIC TANK AND DRY WELL. STAND PIPES MUST BE 6 INCHES IN DIAMETER. CAST IRON, CONCRETE OR TERRA COTTA ACCEPTED.

BLDG. PERMIT SIGNED
AND RETURNED 5/10/85
Serial # 64575
Prot.

A 29951

*INSTALLER IS RESPONSIBLE FOR OBTAINING FINAL APPROVAL ON THIS PERMIT.

24
 29

 53
 48

 101

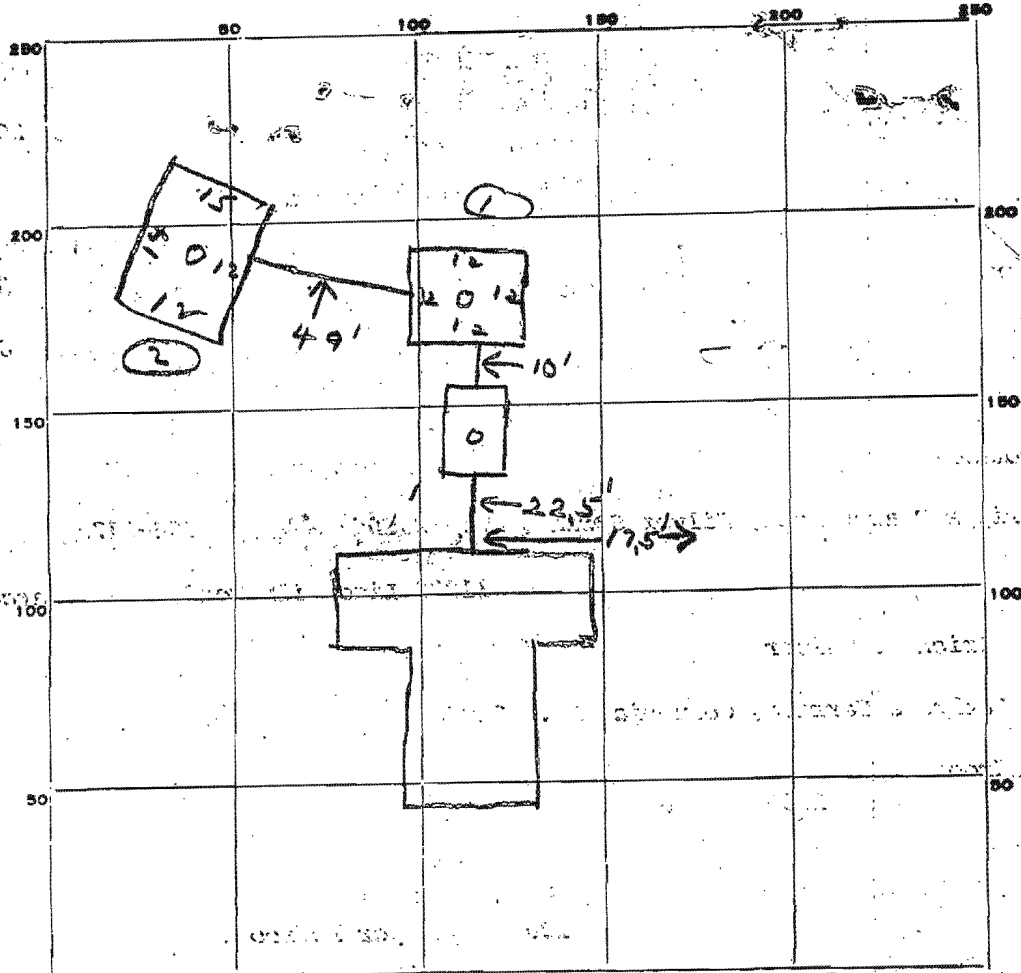

PERMIT CARD

SEPTIC TANK, LEVEL

CLEANOUTS

ST	DW	DW
<input checked="" type="checkbox"/>	<input checked="" type="checkbox"/>	<input checked="" type="checkbox"/>

DISTRIBUTION BOX, LEVEL

TILE FIELD, DEPTH _____ FT. TRENCH WIDTH _____ FT.

GRAVEL DEPTH _____ IN. TOTAL LENGTH _____ FT.

NUMBER OF TRENCHES _____ TOTAL BOTTOM AREA _____

SEEPAGE PITS, INSIDE DIAMETER 53 48 101 FT. DEPTH BELOW INLET 8 FT.

ABSORBENT AREA 808 SQ. FT.

REMARKS

7/7/80 OK to cover all work SK + JS

DATE SYSTEM APPROVED

7/7/80

INSPECTOR

J. Steyer + S. Kiel

A 27951

ELLWOOD

P.T.T.C. TANK: 3 BEDROOM, 1000 GALLON

JOHNSON PR. FR. 5-277

4 BEDROOM, 1250 GALLON

LIME RICKS R17

WELL TO HAVE 130 SQUARE FEET OF SIDEWALL AREA PER BEDROOM

WELL INLET TO BE MAX. 4³ FEET BELOW ORIGINAL GRADE.

WELL BOTTOM (MAXIMUM DEPTH) TO BE 13¹² FEET BELOW ORIGINAL GRADE.

PLACE THE DRY WELL 225 FEET FROM THE BACK LOT LINE AND 320 FEET FROM THE

LEFT LOT LINE AS SEEN WHEN FACING THE LOT FROM THE BACK ROAD.

LOT LINE

NOTE THE BACK LOT LINE IS CONSIDERED

TO BE 559.49 FT LONG &

RUN'S S 76° 32' 30" W 8

THE LEFT LOT LINE IS

1295.21 FT LONG

New Test Plot Returns

All in with spec

I admit to draw

Septer Plan Plans 9/19/70

1 1
3
5 1 3
0 0
0 0

APPLICATION

SEWAGE DISPOSAL TESTING

STATE OF MARYLAND - DEPARTMENT OF HEALTH AND MENTAL HYGIENE

A 29951
P _____

HOWARD COUNTY HEALTH DEPARTMENT
ENVIRONMENTAL HEALTH SERVICES

P.O. BOX 476 ELLICOTT, MARYLAND 21043
TELEPHONE: 992-2330

DISTRICT 5th
DATE 6/26/79

WIT AY
11/11/50
FLOOR
3 MAR
LOW

TO: THE COUNTY HEALTH OFFICER
ELLICOTT CITY, MARYLAND

I, HEREBY, APPLY FOR THE NECESSARY TEST IN ORDER TO CONSTRUCT (OR RECONSTRUCT) A SEWAGE DISPOSAL SYSTEM.

PROPERTY OWNER Ulrich F. Walter

ADDRESS 10088 Hatbrine Terrace Columbia, Md. 21046 PHONE HOME: 730-1890
WORK: 498-7400

PROPERTY LOCATION _____

SUBDIVISION Ellwood Johnson Property LOT NO. Parcel 89

ROAD AND DESCRIPTION 1825 Lime Kilm Road

SIZE OF LOT 16.59 Acres TYPE BLDG. 4 Bedrooms

THE SYSTEM INSTALLED UNDER THIS APPLICATION IS ACCEPTABLE ONLY UNTIL PUBLIC FACILITIES BECOME AVAILABLE.

I FULLY UNDERSTAND THE FEE CONNECTED WITH THE FILING OF THIS PERC TEST APPLICATION IS NON-REFUNDABLE UNDER

ANY CIRCUMSTANCES.

SIGNATURE OF APPLICANT Ulrich F. Walter June 26, 79

APPROVED BY _____ FOR _____ DATE _____

REJECTED BY _____ FOR _____ DATE _____

HOLD PENDING FURTHER TESTS _____ DATE _____

REASONS FOR REJECTION OR HOLDING 7/6/79 - MORE TESTS RHT 7/11/79 PERC
TIME OK BUT MUST SHOW HOW PATTERN TO SUPERVISOR RHT

BLDG. PERMIT SIGNED
AND RETURNED 11/8/79
serial # 41640

THIS IS NOT A PERMIT

① SOIL PROFILE

ALL SANDY & FEW SMALL ROCKS

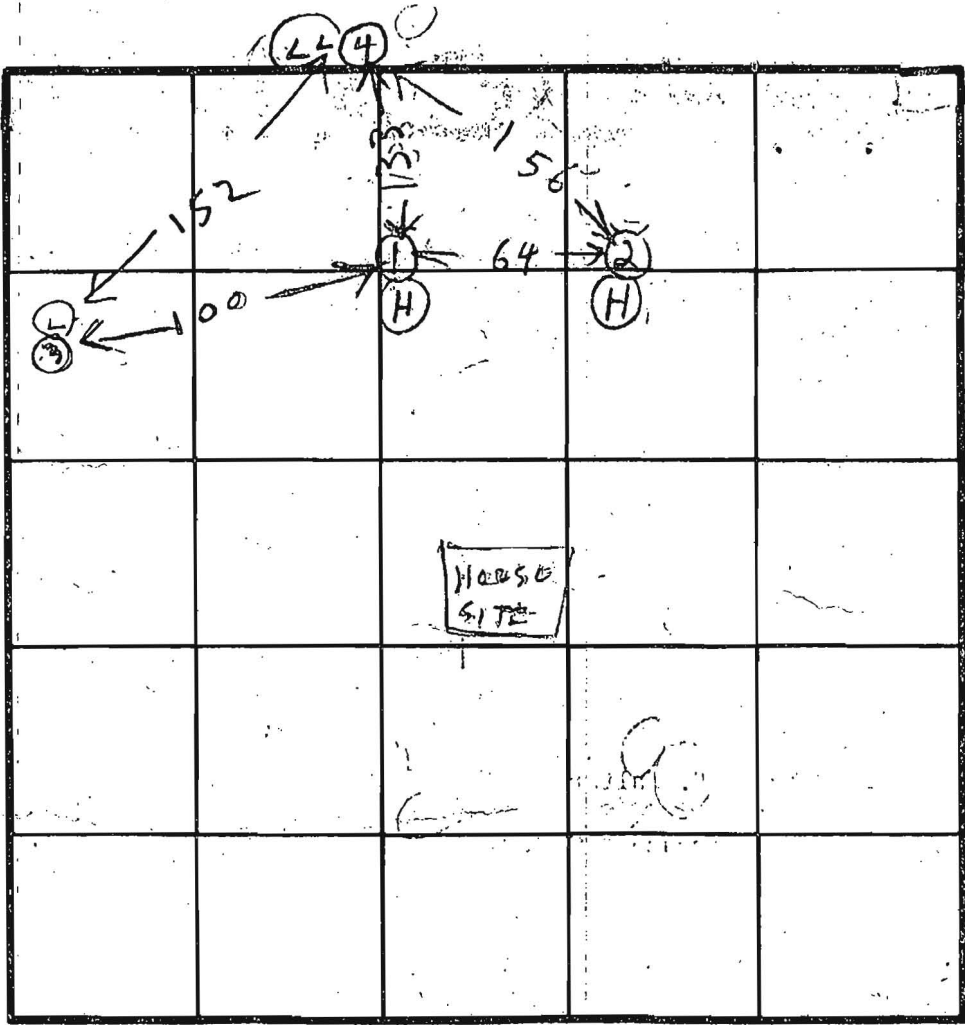

ELEVATION HOLE

① ② HIGH ABOUT SAME

③ LOW

④ LOWEST

INDICATE NORTH - NAME ADJOINING ROADWAY AS BASE LINE.

②

ALL SANDY & FEW SMALL ROCKS

③

ALL SAND

④

ALL SANDY

DATE	TEST NO.	DEPTH	PRE-WET		TEST - 1" DROP		TIME
			START	STOP	START	STOP	
7/6/79	1D	13	1102	1104	1104	1109	5
	1S	4	1107	1109	1109	1112	3
	2D	13 1/2	1157	1206	1206	1210	14
7/11/79	2S	4	1202	1210	1210	1217	7
	3D	12 1/2	1242	1245	1245	1247	2
7/16/79	3S	4 1/2	1244	1245	1245	1256	11
7/18/79	4S	4 1/2	1952	1954	1954	1957	3
7/18/79	4D	14 1/2	1953	1957	1957	1003	6

REMARKS 7/31/78 - NO TEST. DENNIS MALCUM SAID HE HAD TO GO TO RD TO SITE WHERE HOLES TO BE DUG. WILL CALL FOR APPROX.

TYPE OF SOIL 7/11/79 NO BACK HOLE TODAY

CERTIFY LOCATION & ELEV VARYUN OF HOLES

TESTED BY RH RH ALSO PRESENT DENNIS MALCUM

COPY TO D. BURNETT DALE BURNETT

APPLICATION

SEWAGE DISPOSAL TESTING

A 29951

STATE OF MARYLAND - DEPARTMENT OF HEALTH AND MENTAL HYGIENE

P _____

HOWARD COUNTY HEALTH DEPARTMENT
ENVIRONMENTAL HEALTH SERVICES

P.O. BOX 476 ELLICOTT, MARYLAND 21043
TELEPHONE: 992-2330

DISTRICT 5th

DATE 6/26/79

WITNESSES
11/11/79
ABOUT
3PM
LOW

(H)

TO: THE COUNTY HEALTH OFFICER
ELLICOTT CITY, MARYLAND

I, HEREBY, APPLY FOR THE NECESSARY TEST IN ORDER TO CONSTRUCT (OR RECONSTRUCT) A SEWAGE DISPOSAL SYSTEM.

PROPERTY OWNER Ulrich F. Walter

ADDRESS 10088 Hatbrine Terrace Columbia, Md. 21046 PHONE HOME: 730-1890
WORK: 498-7400

PROPERTY LOCATION:

SUBDIVISION Ellwood Johnson Property LOT NO. Parcel 89

ROAD AND DESCRIPTION Lime Kilm Road

SIZE OF LOT 16.59 Acres TYPE BLDG 4 Bedrooms

THE SYSTEM INSTALLED UNDER THIS APPLICATION IS ACCEPTABLE ONLY UNTIL PUBLIC FACILITIES BECOME AVAILABLE.

I FULLY UNDERSTAND THE FEE CONNECTED WITH THE FILING OF THIS PERC TEST APPLICATION IS NON-REFUNDABLE UNDER

ANY CIRCUMSTANCES.

SIGNATURE OF APPLICANT [Signature] June 26 79

APPROVED BY _____ FOR _____ DATE _____

REJECTED BY _____ FOR _____ DATE _____

HOLD PENDING FURTHER TESTS _____ DATE _____

REASONS FOR REJECTION OR HOLDING 7/6/79 - MORE TESTS R14 7/11/79 PERC

TIME OK BUT MUST SHOW HOLE PATTERN TO SUPERVISOR RH

THIS IS NOT A PERMIT

① SOIL PROFILE

ALL SANDY & FEW SMALL ROCKS

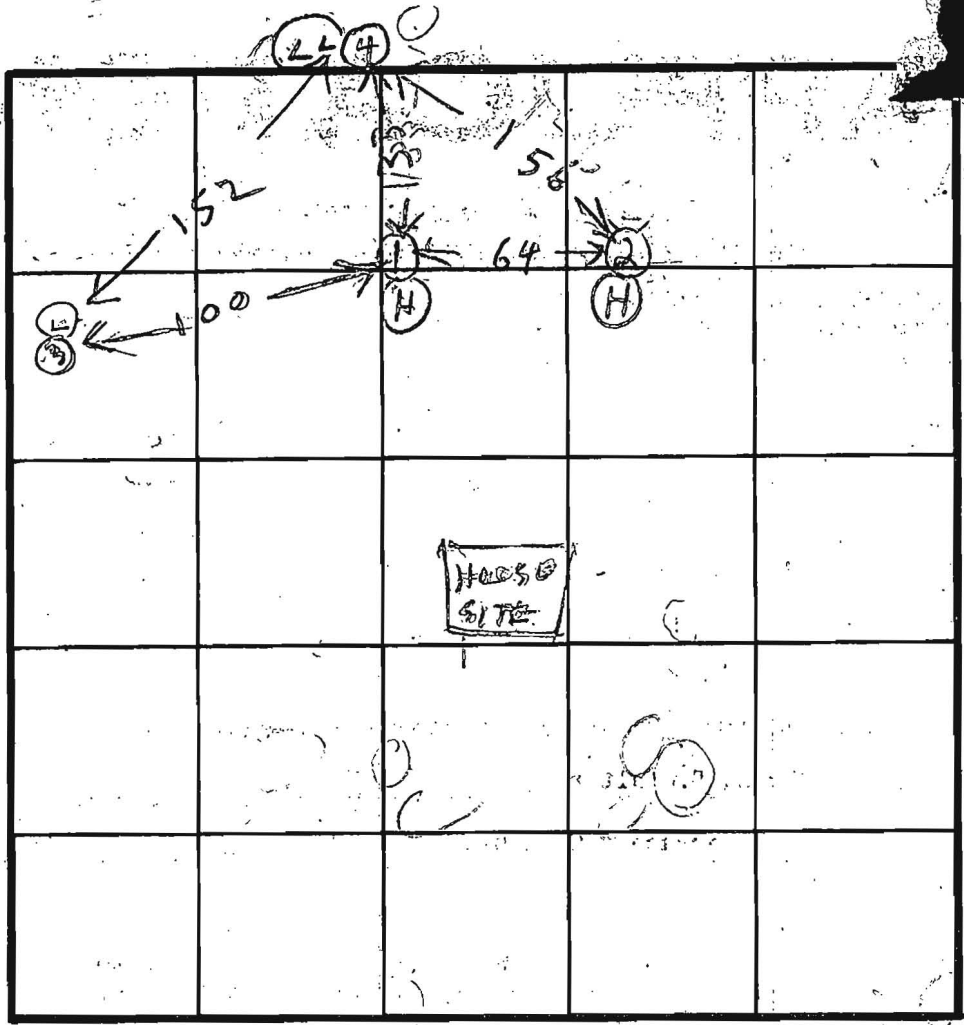

ELEVATIONS HOLE

- ① ② HIGH ABOUT SAME
- ③ LOW
- ④ LOWEST

156

INDICATE NORTH - NAME ADJOINING ROADWAY AS BASE LINE.

② ALL SANDY & FEW SMALL ROCKS

③ ALL SAND

④ ALL SANDY

DATE	TEST NO.	DEPTH	PRE-WET		TEST - 1" DROP		TIME
			START	STOP	START	STOP	
7/6/79	1D	13	1102	1104	1104	1109	5
	1S	24	1107	1109	1109	1112	3
	2D	13 1/2	1157	1206	1206	1220	14
7/6/79	2S	4	1202	1210	1210	1217	7
	3D	12 1/2	1242	1245	1245	1247	2
7/6/79	3S	4 1/2	1244	1245	1245	1256	11
7/10/79	4S	4 1/2	1952	1954	1954	1957	3
7/10/79	4D	14 1/2	1953	1957	1957	1003	6

REMARKS 7/3/78 - NO TEST. DENNIS MALCUM SAID HE HAD TO GO TO SITE WHERE HOLES TO BE DUG. WILL CALL FOR REAPPOINTMENT

TYPE OF SOIL 7/11/79 NO BACK HOLE TODAY

CERTIFY LOCATION & ELEVATION OF HOLES

TESTED BY RH RH ALSO PRESENT DENNIS MALCUM

COPY TO D. BURNETT DALE BURNETT

STATE OF MARYLAND
WATER RESOURCES ADMINISTRATION
TAWES STATE OFFICE BLDG. ANNAPOLIS, MARYLAND 21401
APPLICATION FOR PERMIT TO DRILL WELL

SEQUENCE NO. (WRA USE ONLY) **3777**

WRA PERMIT NUMBER **Hu 73-2455**

FILL IN THIS FORM COMPLETELY

DATE RECEIVED (WRA USE ONLY) **9-30-79**

OWNER **Richard W. Wald** COL. 15. LAST NAME

STREET OR RFD **2001 L. Miller Church Rd** COL. 86

POST OFFICE **Silver Spring, Md.** COL. 87

B 1 CONTINUED DRILLER INFORMATION

DATE **9-20-79** LICENSE NUMBER **40**

George Easterday FIRST NAME DRILLER LAST NAME

George Easterday SIGNATURE

B 3 LOCATION OF WELL

COUNTY **Howard** (DO NOT ABBREVIATE COUNTY NAME)

SUBDIVISION **23** SECTION **44** LOT **48**

NEAREST TOWN **Fulton**

MILES FROM TOWN (ENTER 0 IF IN TOWN) **1**

B 2 WELL INFORMATION

MAXIMUM PUMPING RATE (GALLONS PER MINUTE) **5**

AVERAGE DAILY QUANTITY NEEDED (GALLONS PER DAY) **600**

USE FOR WATER (CIRCLE APPROPRIATE BOX)

HOME (SINGLE OR DOUBLE HOUSEHOLD UNIT ONLY)

FARMING, AGRICULTURE, IRRIGATION

INDUSTRIAL, COMMERCIAL, STATE AND FEDERAL GOVERNMENT

MUNICIPAL WATER SUPPLY

PRIVATE WATER COMPANY

TEST

B 4 DIRECTION FROM TOWN

(CIRCLE APPROPRIATE BOX)

NORTH EAST NORTHWEST SOUTHWEST

NEAR WHAT ROAD **Line Rd**

ON WHICH SIDE OF ROAD (CIRCLE APPROPRIATE BOX) NORTH SOUTH

DISTANCE FROM ROAD (ENTER DISTANCE AND CIRCLE APPROPRIATE BOX) **150**

APPROXIMATE DEPTH OF WELL **150** FEET

APPROXIMATE DIAMETER OF WELL **10"** (NEAREST INCH)

METHOD OF DRILLING USED (CIRCLE APPROPRIATE METHOD)

BORED (OR AUGERED) JETTED DRIVEN

AIR-ROTARY AIR-PERCUSSION ROTARY (HYDRAULIC ROTARY)

CABLE REVERSE-ROTARY DRIVE-POINT

DRAW A SKETCH BELOW SHOWING LOCATION OF WELL IN RELATION TO NEARBY TOWNS, ROADS AND STREAMS WITH NORTH IN THE DIRECTION OF THE ARROW, AND GIVE DISTANCE FROM WELL TO NEAREST ROAD JUNCTION OR STREAM CROSSING SHOWN ON THE SKETCH. ALSO SHOW, BY MEANS OF AN "X", THE WELL LOCATION IN THE BOX BELOW AND THE BOX NUMBER FROM THE WELL LOCATION MAP.

42' CASING
2' ABOVE GR
38' OPEN
10 BAGS CEMENT

8 11/5/79
Fulton
Line Rd
Revised well 2/16

REPLACEMENT OR DEEPEMED WELLS (CIRCLE APPROPRIATE BOX)

THIS WELL WILL NOT REPLACE AN EXISTING WELL

THIS WELL WILL REPLACE A WELL THAT WILL BE ABANDONED AND SEALED

THIS WELL WILL REPLACE A WELL THAT WILL BE USED AS A STANDBY

THIS WELL WILL DEEPEM AN EXISTING WELL PERMIT NUMBER OF WELL TO BE REPLACED OR DEEPEMED (IF AVAILABLE)

NOT TO BE FILLED IN BY DRILLER (WRA USE ONLY)

APPROPRIATION PERMIT NUMBER **04** ENGINEER REVIEW DISTRICT NO. **05**

FORCE **07** WRITE INITIALS IN BOX **08** CONDITIONS **09**

BOX NUMBER **E 820**
N 470

NORTH COORDINATE **475000**

EAST COORDINATE **620000**

ELEVATION AT WELL HEAD (FEET) **0/0**

B 4 CONTINUED HEALTH DEPARTMENT APPROVAL

COUNTY NAME **Howard**

DATE **09 20 79**

Donald W. Monaghan, Sanitarian

B 5 SPECIAL CONDITIONS (WRA USE ONLY)