

C1 4013

SEQUENCE NO. (MDE USE ONLY)

STATE OF MARYLAND WELL COMPLETION REPORT

THIS REPORT MUST BE SUBMITTED WITHIN 45 DAYS AFTER WELL IS COMPLETED.

COUNTY NUMBER

1 2 3 6 (THIS NUMBER IS TO BE PUNCHED IN COLS. 3-6 ON ALL CARDS)

ST/CO USE ONLY DATE RECEIVED

DATE WELL COMPLETED 01 19 08

Depth of Well 22 400 26 (TO NEAREST FOOT)

PERMIT NO. FROM "PERMIT TO DRILL WELL" Ho - 95 - 1629

OWNER Land Design + Development 8229 Hunterbrooke Lane TOWN Fulton SUBDIVISION Bruns Property SECTION LOT 3

WELL LOG

Not required for driven wells

STATE THE KIND OF FORMATIONS PENETRATED, THEIR COLOR, DEPTH, THICKNESS AND IF WATER BEARING

Table with columns: DESCRIPTION, FEET (FROM, TO), check if water bearing. Rows include Soil, Brown shale, Gray Rock, and Water at 200'.

GROUTING RECORD

WELL HAS BEEN GROUTED (Y/N) TYPE OF GROUTING MATERIAL (CEMENT, BENTONITE CLAY) NO. OF BAGS, NO. OF POUNDS, GALLONS OF WATER, DEPTH OF GROUT SEAL

CASING RECORD

MAIN CASING TYPE (PL) Nominal diameter top (main) casing (nearest inch!) 6 Total depth of main casing (nearest foot) 45

OTHER CASING (if used)

Table for other casing with columns for diameter and depth.

SCREEN RECORD

screen type or open hole (ST, BR, HO, PL, OT) insert appropriate code below

NUMBER OF UNSUCCESSFUL WELLS: 0

WELL HYDROFRACTURED (Y/N)

CIRCLE APPROPRIATE LETTER A WELL WAS ABANDONED AND SEALED WHEN THIS WELL WAS COMPLETED

I HEREBY CERTIFY THAT THIS WELL HAS BEEN CONSTRUCTED IN ACCORDANCE WITH COMAR 26.04.04 "WELL CONSTRUCTION" AND IN CONFORMANCE WITH ALL CONDITIONS STATED IN THE ABOVE CAPTIONED PERMIT...

DRILLERS LIC. NO. M SD 162

DRILLERS SIGNATURE (MUST MATCH SIGNATURE ON APPLICATION)

LIC. NO. MS D 066

SITE SUPERVISOR (sign. of driller or journeyman responsible for sitework if different from permittee)

C 2 DEPTH (nearest ft.)

Table for depth measurements with columns for diameter and depth.

GRAVEL PACK IF WELL DRILLED WAS FLOWING WELL INSERT F IN BOX 68

MDE USE ONLY (NOT TO BE FILLED IN BY DRILLER) T (E.R.O.S.) W Q

TELESCOPE CASING LOG INDICATOR OTHER DATA

C 3

PUMPING TEST

HOURS PUMPED (nearest hour) 3 PUMPING RATE (gal. per min.) 5.45 METHOD USED TO MEASURE PUMPING RATE Submersible WATER LEVEL (distance from land surface) BEFORE PUMPING 298 ft. WHEN PUMPING 25 ft. TYPE OF PUMP USED (for test) S submersible

PUMP INSTALLED

DRILLER INSTALLED PUMP (CIRCLE) (YES or NO) YES IF DRILLER INSTALLS PUMP, THIS SECTION MUST BE COMPLETED FOR ALL WELLS. TYPE OF PUMP INSTALLED PLACE (A,C,J,P,R,S,T,O) IN BOX 29 CAPACITY: GALLONS PER MINUTE (to nearest gallon) 31 35 PUMP HORSE POWER 37 41 PUMP COLUMN LENGTH (nearest ft.) 43 47 CASING HEIGHT (circle appropriate box and enter casing height) + above LAND SURFACE (nearest foot) 50 51

LOCATION OF WELL ON LOT SHOW PERMANENT STRUCTURE SUCH AS BUILDING, SEPTIC TANKS, AND /OR LANDMARKS AND INDICATE NOT LESS THAN TWO DISTANCES (MEASUREMENTS TO WELL)

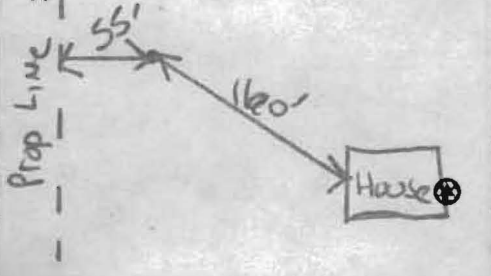

B 1 6916

SEQUENCE NO. (MDE USE ONLY)

STATE OF MARYLAND APPLICATION FOR PERMIT TO DRILL WELL

528742 please type

STATE PERMIT NUMBER

HO-95-1629 fill in this form completely

Date Received (APA)

OWNER INFORMATION

Land Design & Development
5300 Dorsey Hall Road
Ellicott City MD 21043

B 3

LOCATION OF WELL

Howard
8 COUNTY 21
Bruns Property
23 SUBDIVISION 42
SECTION 44 46 LOT 3 48 50
Fulton
52 NEAREST TOWN 71
MILES FROM TOWN (enter 0 if in town) 0 M I

DRILLER INFORMATION

Michael D. Isom M SD 162
Driller's Name 76 License No. 81
G. Edgar Harr Sons' Corp.
Firm Name
12047 Valley Road, Cockeysville 21030
Address
Signature Date 5/6/08

B 4

DIRECTION OF WELL FROM TOWN (CIRCLE BOX)

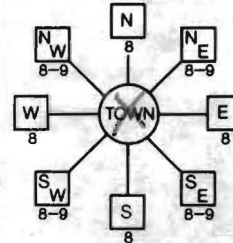

8100 #8229
Hunterbrooke Lane
11 NEAR WHAT ROAD 30
ON WHICH SIDE OF ROAD (CIRCLE APPROPRIATE BOX)
NORTH
WEST 32 EAST
SOUTH
34 500 37
DISTANCE FROM ROAD FT
ENTER FT OR MI 38 39
TAX MAP: BLK: PARCEL

B 2

WELL INFORMATION

APPROX. PUMPING RATE (GAL. PER MIN.) 5
8 750 12
AVERAGE DAILY QUANTITY NEEDED (GAL. PER DAY) 14 20

USE FOR WATER (CIRCLE APPROPRIATE BOX)

- D DOMESTIC POTABLE SUPPLY & RESIDENTIAL IRRIGATION
F FARMING (LIVESTOCK WATERING & AGRICULTURAL IRRIGATION
I INDUSTRIAL, COMMERCIAL, DEWATERING
P PUBLIC WATER SUPPLY WELL
T TEST, OBSERVATION, MONITORING
G GEO-THERMAL

NOT TO BE FILLED IN BY DRILLER HEALTH DEPARTMENT APPROVAL

Howard AS23353
COUNTY NAME COUNTY NO.
STATE SIGNATURE INSERT S
DATE ISSUED 6/16/08
CO SIGNATURE EXP. DATE 6/16/09
43 MM DD YY 48
NORTH GRID 477 000 EAST GRID 820 000
50 55 57 63

APPROXIMATE DEPTH OF WELL 300 FEET
APPROXIMATE DIAMETER OF WELL 6 NEAREST INCH

METHOD OF DRILLING (circle one)

- BORED (or Augered) JETTED Jetted & DRIVEN
AIR-ROTary AIR-PERCussion ROTARY (Hydraulic Rotary)
CABLE REVERSE-ROTary DRIVE-POINT
other

REPLACEMENT OR DEEPEMED WELLS (CIRCLE APPROPRIATE BOX)

- N THIS WELL WILL NOT REPLACE AN EXISTING WELL
Y THIS WELL WILL REPLACE A WELL THAT WILL BE ABANDONED AND SEALED
S THIS WELL WILL REPLACE A WELL THAT WILL BE USED AS A STANDBY-CONTACT LOCAL APPROVING AUTHORITY FOR POLICY ON STANDBY WELLS
D THIS WELL WILL DEEPM AN EXISTING WELL
PERMIT NUMBER OF WELL TO BE REPLACED OR DEEPEMED (IF AVAILABLE) 41 52

SHOW MAJOR FEATURES OF BOX & LOCATE WELL WITH AN X
SOURCES OF DRILLING WATER
1. well
2.
3.
WRITE THE BOX NUMBER FROM THE MAP HERE
E 820
N 477

DRAW A SKETCH BELOW SHOWING LOCATION OF WELL IN RELATION TO NEARBY TOWNS AND ROADS AND GIVE DISTANCE FROM WELL TO NEAREST ROAD JUNCTION

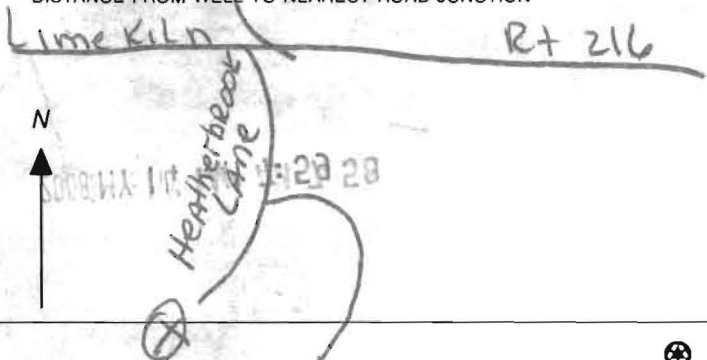

Not to be filled in by driller (MDE OR COUNTY USE ONLY)

APPROX. PERMIT NUMBER G
PERMIT No. HO-95-1629
70 71 72 73 74 75 76 77 78 79

SPECIAL CONDITIONS

NOTE - APPROVING AUTHORITIES SHOULD USE SEPARATE SHEET IF NEEDED

**HARR WELL DRILLING**  
 12047 FALLS ROAD  
 COCKEYSVILLE, MD 21030  
 410-252-4588

**HOWARD COUNTY WELL YIELD TEST REPORT**

*new  
#8229*

Date Test Performed: 09-18-08  
 Address: ~~8100~~ Hunterbrooke Lane  
 Owner: Land Design & Devel  
 Well Depth: 400 feet

Permit Number: HO-95-1629  
 Subdivision: Bruns Property lot 3  
 Election District:  
 Static Water Level: 61 feet

Time	Water Level	PSI Existing Pump	Pumping Rate Seconds to fill 5 Gallon bucket	Calculated Flow-Gallons Per Minute
0800	61 ft		15 sec	20.00 gpm
0815	160		20	15.00
0830	220		20	15.00
0845	258		50	6.00
0900	298		55	5.45
0915	298		55	5.45
0930	298		55	5.45
0945	298		55	5.45
1000	298		55	5.45
1015	298		55	5.45
1030	298		55	5.45
1045	298		55	5.45
1100	298		55	5.45
1115	298		55	5.45
1130	298		55	5.45
1145	298		55	5.45
1200	298		55	5.45

# HARR WELL DRILLING

12047 FALLS ROAD  
COCKEYSVILLE, MD 21030  
410-252-4588

## HOWARD COUNTY WELL YIELD TEST REPORT

Date Test Performed: 09-18-08  
Address: 8100 Hunterbrooke Lane  
Owner: Land Design & Devel  
Well Depth: 400 feet

Permit Number: HO-95-1629  
Subdivision: Bruns Property lot 3  
Election District:  
Static Water Level: 61 feet

Time	Water Level	PSI Existing Pump	Pumping Rate Seconds to fill 5 Gallon bucket	Calculated Flow-Gallons Per Minute
0800	61 ft		15 sec	20.00 gpm
0815	160		20	15.00
0830	220		20	15.00
0845	258		50	6.00
0900	298		55	5.45
0915	298		55	5.45
0930	298		55	5.45
0945	298		55	5.45
1000	298		55	5.45
1015	298		55	5.45
1030	298		55	5.45
1045	298		55	5.45
1100	298		55	5.45
1115	298		55	5.45
1130	298		55	5.45
1145	298		55	5.45
1200	298		55	5.45

tfisher@fccleng.com

HOWARD COUNTY HEALTH DEPARTMENT  
BUREAU OF ENVIRONMENTAL HEALTH  
WATER AND SEWERAGE PROGRAM  
TEL: (410)313-2640 FAX: (410)313-2648

Information Form for the Installation of the Well Pump, Pitless Adapter, and Supply Piping

**NOTE:** The installer is responsible for requesting an inspection prior to 9 am on the day of the desired inspection. No work is to be covered until approved by the Health Department. All installations must comply with the National Standard Plumbing Code (NSPC, as amended locally) and COMAR 26.04.04 (MD Well Construction Regulations). Submission of a complete form is required prior to Use and Occupancy approval.

Company Name: G. Edgar Harr Sons Corp Telephone #: 410-252-4588  
Address: 12047 Falls Road  
Cockeysville, MD 21030

(Must circle one) Licensed Plumber Licensed Well Driller Licensed Well Pump Installer

License # and name of individual responsible for the field installation:

Name (Print): Michael Thom License# MSD162

\*A licensed individual must perform the actual installation. Apprentices must be under the direct supervision of a licensed journeyman or master plumber, pump installer or well driller. Licenses may be subjected to field verification.

Name of Property Owner: Doug Bruns Telephone #: \_\_\_\_\_  
Subdivision: Bruns Property Lot #: 3 Well Tag #: HO-95-1627  
Site Address: 8100 Huntersbrook Lane

new #8229

Ex pump →  
to be reamed  
new well

Submersible Pump Data

Make: Unknown  
Model #: \_\_\_\_\_  
Pump Capacity \_\_\_\_\_ GPM  
Well Yield: 545 GPM

Pitless Adapter

Make: Mannson  
Model #: G10X  
Depth: 42 (36" min)  
NSF approved: yes

Well Cap and Electric Conduit

Two piece watertight cap:   
Screened, vented well cap:   
Cap secured to casing:   
Conduit min 18" B.G.:   
Conduit secured to well cap:

Depth of well encountered at time of pump installation: 405 (feet)  
If pump capacity exceeds well yield, a low water cut off switch is required by NSPC 1990 Section 17.8.4

Torque arrestors or Cable guards are required - Must circle one

Safety rope, if used, attached to inside of well casing with eye bolt \_\_\_\_\_

Piping to house

Type: Poly  
PSI: 160 (160 psi min)  
Depth of supply line: 42 (36" min)

House Connection

Ex line will be tied into outside of PVC sleeved to undisturbed soil at wall penetration: \_\_\_\_\_ the house  
Approximate length of sleeve: \_\_\_\_\_  
Sleeve caulked and sealed properly: \_\_\_\_\_

The water supply line is required to be at least ten feet from the septic tank, pump chamber, sewage piping, distribution box, drainfields, and sewage reserve area. If this cannot be accomplished, contact this office for approval prior to installation.

Signature of company representative responsible for installation \_\_\_\_\_ date \_\_\_\_\_

For Health Department Use Only - Not to be completed by Installer

Date Insp. Requested: 9/24/08 Date Insp. Approved: [Signature]

Inspection Data: Pitless adapter and water supply line at least 36" below grade   
Two piece cap installed and attached to casing securely   
Elec. conduit extends at least 18" below grade/attached to cap properly   
Safety rope installed inside of well casing   
Correct well tag attached properly and casing 8" above finished grade   
Water supply line sleeved adequately at house connection   
Adequate grout observed below pitless adapter

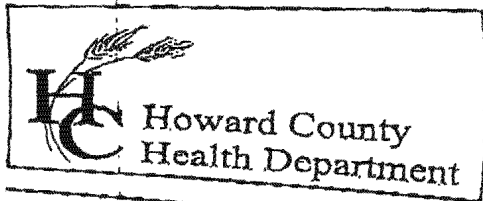

7178 Columbia Gateway Drive, Columbia, MD 21046  
 (410) 313-2640 Fax (410) 313-2640  
 TDD (410) 313-2323 Toll Free 1-866-313-2640  
 website: www.hchealth.org

Penny E. Borenstein, M.D., M.P.H., Health Officer

TO ALL INTERESTED PARTIES

When submitting a well permit application for a proposed well for new construction, please indicate one of the following:

Well Site Location:

<u>Bruns Property</u>	<u>1,2+3</u>	<u>Huntbrooke Lane</u>
Subdivision/Property Name	Lot#	Road Name

The well site has been staked by Fisher, Collins + Carter,  
 (professional land surveyor or company employing professional land surveyors)  
 on May 6, 2003 (date) and does not require a site inspection.

The well driller, builder or property owner will call the Health Department to schedule a time to meet in the field to verify the proposed well site location.

This sheet, along with two copies of an acceptable well site plan, must be attached to the green well permit application.

Revised 3/11/05



6/10/08  
well site  
OK

**FISHER, COLLINS & CARTER, INC.**  
 CIVIL ENGINEERING CONSULTANTS & LAND SURVEYORS  
 CENTENNIAL SQUARE OFFICE PARK - 10272 BALTIMORE NATIONAL PIKE  
 ELLICOTT CITY, MARYLAND 21042  
 (410) 461 - 2855

EXHIBIT TO ACCOMPANY  
 WELL PERMIT  
 BRUNS PROPERTY  
 LOT 3  
 TAX MAP 46 PARCEL 89 GRID 7  
 THIRD ELECTION DISTRICT  
 HOWARD COUNTY, MARYLAND  
 SCALE: 1" = 100' DATE: May 6, 2008

8100 Hunterbrooke Lane

I:\2005\05117\dwg\05117-6001 Well Exhibit Lot 3.dwg, 5/6/2008 11:14:32 AM

MARYLAND DEPARTMENT OF THE ENVIRONMENT, WATER MANAGEMENT ADMINISTRATION  
1800 Washington Blvd., Baltimore, Maryland 21230 (410) 537-3784

\*\*\*\*\*  
WATER WELL ABANDONMENT-SEALING REPORT FORM  
\*\*\*\*\*

SUBMIT COPIES OF COMPLETED FORM TO:

- \* COUNTY ENVIRONMENT AGENCY (contact MDE, WMA if address needed)
- \* WELL OWNER
- \* MDE, WATER MANAGEMENT ADMINISTRATION, WELL PROGRAM

DATE WELL ABANDONED: 9-24-08 (month/day/year)

OK  
(KW)

\* PERMIT NUMBER OF ABANDONED WELL (if any) \_\_\_\_\_

\* PERMIT NUMBER OF REPLACEMENT WELL \_\_\_\_\_

\* PERSON ABANDONING WELL: Michael Tsom

WELL DRILLERS LICENSE NUMBER: 162

CIRCLE: MWD/MSD/MGD

\* OWNER'S NAME: Doug Bruns

SITE LOCATION MAP

\* WELL LOCATION:  
COUNTY: Howard  
NEAREST TOWN: Fulton  
TAX MAP \_\_\_\_\_ BLOCK \_\_\_\_\_ PARCEL \_\_\_\_\_  
SUBDIVISION: Bruns Property  
SECTION: \_\_\_\_\_ LOT: 3  
NEAREST ROAD: 8100 Hunterbrooke Lane

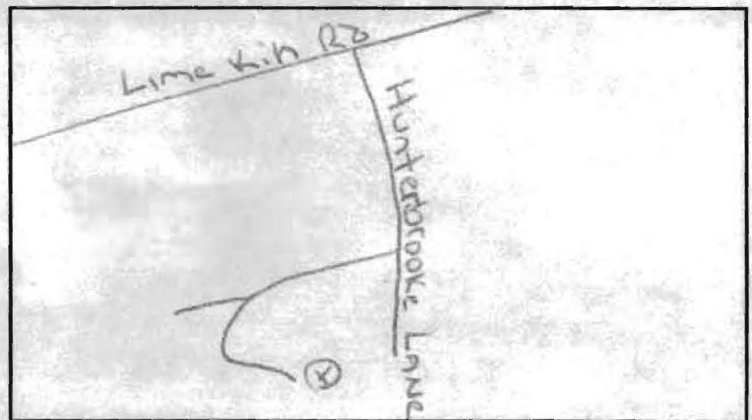

now #8229

\* TYPE OF WELL BEING ABANDONED:

DRILLED \_\_\_\_\_ JETTED  
 BORED/AUGERED \_\_\_\_\_ HAND DUG  
 OTHER (specify) \_\_\_\_\_

\* USE CODE:

DOMESTIC \_\_\_\_\_ MUNICIPAL/PUBLIC  
 IRRIGATION \_\_\_\_\_ INDUSTRIAL  
 TEST/OBSERVATION \_\_\_\_\_ GEOTHERMAL

\* TYPE OF CASING:

STEEL \_\_\_\_\_ PLASTIC  
 CONCRETE \_\_\_\_\_ OTHER (specify) \_\_\_\_\_

\* SIZE OF CASING: 6 INCHES IN DIAMETER

\* DEPTH OF WELL: 170 FEET DEEP

\* WAS ANY CASING REMOVED? YES \_\_\_\_\_ NO   
if yes, length removed, in feet: \_\_\_\_\_

\* WAS CASING RIPPED OR PERFORATED? YES  NO

LOG OF SEALING MATERIAL

MATERIAL	FEET	
	FROM	TO
Cement	0	170
VOLUME OF MATERIAL USED		

SIGNATURE - MASTER WELL DRILLER OR SUPERVISING SANITARIAN \_\_\_\_\_

LICENSE # 162

MWD/MSD/MGD (MWD)

DATE 9-24-08