



Building Permit Application

Howard County Maryland
Department of Inspections, Licenses and Permits
3430 Court House Drive
Permits: 410-313-2455
www.howardcountymd.gov

Date Received: _____

Permit No.: _____

Building Address: 11023 Blevins Dr
City: Clarksville State: MD Zip Code: 21029
Suite/Apt. #: _____ SDP/WP/BA #: _____
Census Tract: _____ Subdivision: Blevins
Section: _____ Area: _____ Lot: 4
Tax Map: 35 Parcel: 310 Grid: 19
Zoning: _____ Map Coordinates: _____ Lot Size: 3.1361Ac

Existing Use: SFD
Proposed Use: SFD
Estimated Construction Cost: \$ 3,400
Description of Work: Construct 15' x 12' open deck

Occupant or Tenant: _____
Was tenant space previously occupied? ☐ Yes ☐ No
Contact Name: _____
Address: _____
City: _____ State: _____ Zip Code: _____
Phone: _____ Fax: _____
Email: _____

Commercial Building Characteristics	Residential Building Characteristics
Height:	<input checked="" type="checkbox"/> SF Dwelling <input type="checkbox"/> SF Townhouse
No. of stories:	Depth Width
Gross area, sq. ft./floor:	1 st floor:
	2 nd floor:
Area of construction (sq. ft.):	Basement:
	<input type="checkbox"/> Finished Basement
Use group:	<input type="checkbox"/> Unfinished Basement
	<input type="checkbox"/> Crawl Space
Construction type:	<input type="checkbox"/> Slab on Grade
<input type="checkbox"/> Reinforced Concrete	No. of Bedrooms:
<input type="checkbox"/> Structural Steel	Multi-family Dwelling
<input type="checkbox"/> Masonry	No. of efficiency units:
<input type="checkbox"/> Wood Frame	No. of 1 BR units:
<input type="checkbox"/> State Certified Modular	No. of 2 BR units:
	No. of 3 BR units:
	Other Structure:
	Dimensions:
➤ Roadside Tree Project Permit	Footings:
<input type="checkbox"/> Yes <input type="checkbox"/> No	Roof:
Roadside Tree Project Permit #	<input type="checkbox"/> State Certified Modular
	<input type="checkbox"/> Manufactured Home

Property Owner's Name: Williamsburg Group
Address: 5185 Harpers Farm Rd STE 200
City: Columbia State: MD Zip Code: 21044
Phone: _____ Fax: _____
Email: _____

Applicant's Name & Mailing Address, (If other than stated herein)
Applicant's Name: Josh Simpson
Address: 8057 Veterans Hwy
City: Millersville State: MD Zip Code: 21108
Phone: 410-969-4444 Fax: _____
Email: permits@fencedeckconnect.com

Contractor Company: Fence & Deck Connection
Contact Person: Josh Simpson
Address: 8057 Veterans Hwy
City: Millersville State: MD Zip Code: 21108
License No.: 45780
Phone: 410-969-4444 Fax: _____
Email: permits@fencedeckconnect.com

Engineer/Architect Company: _____
Responsible Design Prof.: _____
Address: _____
City: _____ State: _____ Zip Code: _____
Phone: _____ Fax: _____
Email: _____

Utilities	
Water Supply	
<input type="checkbox"/> Public	
<input type="checkbox"/> Private	
Sewage Disposal	
<input type="checkbox"/> Public	
<input type="checkbox"/> Private	
Electric: <input type="checkbox"/> Yes <input type="checkbox"/> No	
Gas: <input type="checkbox"/> Yes <input type="checkbox"/> No	
Heating System	
<input type="checkbox"/> Electric <input type="checkbox"/> Oil	
<input type="checkbox"/> Natural Gas <input type="checkbox"/> Propane Gas	
<input type="checkbox"/> Other:	
Sprinkler System:	
<input type="checkbox"/> Yes <input type="checkbox"/> No	
Grading Permit Number:	
Building Shell Permit Number:	

THE UNDERSIGNED HEREBY CERTIFIES AND AGREES AS FOLLOWS: (1) THAT HE/SHE IS AUTHORIZED TO MAKE THIS APPLICATION; (2) THAT THE INFORMATION IS CORRECT; (3) THAT HE/SHE WILL COMPLY WITH ALL REGULATIONS OF HOWARD COUNTY WHICH ARE APPLICABLE THERETO; (4) THAT HE/SHE WILL PERFORM NO WORK ON THE ABOVE REFERENCED PROPERTY NOT SPECIFICALLY DESCRIBED IN THIS APPLICATION; (5) THAT HE/SHE GRANTS COUNTY OFFICIALS THE RIGHT TO ENTER ONTO THIS PROPERTY FOR THE PURPOSE OF INSPECTING THE WORK PERMITTED AND POSTING NOTICES.

Applicant's Signature: _____
Email Address: permits@fencedeckconnect.com
Title/Company: Fence & Deck Connection

Print Name: Josh Simpson
Date: 10/27/15

Checks Payable to: DIRECTOR OF FINANCE OF HOWARD COUNTY

PLEASE WRITE NEATLY & LEGIBLY

-FOR OFFICE USE ONLY-

AGENCY	DATE	SIGNATURE OF APPROVAL
State Highways		
Building Officials		
PSZA (Zoning)		
PSZA (Engineering)		
Health	<u>10-27-15</u>	<u>Bernard</u>

Is Sediment Control approval required for issuance? ☐ Yes ☐ No
☐ CONTINGENCY CONSTRUCTION START

DPZ SETBACK INFORMATION
Front:
Rear:
Side:
Side St.:
All minimum setbacks met? <input type="checkbox"/> Yes <input type="checkbox"/> No
Is Entrance Permit Required? <input type="checkbox"/> Yes <input type="checkbox"/> No
Historic District? <input type="checkbox"/> Yes <input type="checkbox"/> No
Lot Coverage for New Town Zone:
SDP/Red-line approval date:

Filing Fee	\$
Permit Fee	\$
Tech Fee	\$
Excise Tax	\$
PSFS	\$
Guaranty Fund	\$
Add'l per Fee	\$
Total Fees	\$
Sub-Total Paid	\$
Balance Due	\$
Check	#

Distribution of Copies: White: Building Officials

Green: PSZA, Zoning

Yellow: PSZA, Engineering

Pink: Health

Gold: SHA



HOWARD COUNTY DEPARTMENT OF PLANNING AND ZONING

3430 Court House Drive ■ Ellicott City, Maryland 21043 ■ 410-313-2350

Valdis Lazdins, Director

www.howardcountymd.gov

FAX 410-313-3467

TDD 410-313-2323

February 24, 2016

Ms. Firoozeh Alvandi
11023 Blevins Drive
Clarksville MD 22029

**RE: Address Change
Blevins Property, F-13-094**

Dear Ms. Alvandi:

The purpose of this letter is to notify you regarding the correct street address for your property in accordance with the Howard County Street Address Grid System.

At your request and with concurrence of Richard Jordan, the county's address coordinator in 9-1-1, the address of your lot is being changed as shown below.

OLD/INCORRECT ADDRESS:	11023 Blevins Drive
NEW/CORRECTED ADDRESS:	11025 Blevins Drive Map 0035, Grid 0019, Parcel 0310, Lot 4 Tax Account # 05-597769

This address change will take effect **APRIL 4, 2016**. The Department of Planning and Zoning will notify the agencies as copied below.

It is essential that you use the "corrected address" so that emergency response of fire, police and medical services to your location will not be inhibited. The County bases responses according to street addresses.

(over)

In accordance with Section 16.400 of the Howard County Code, "Street Names and House Numbers," all buildings (commercial and residential) must have the correct street address displayed in a conspicuous place over or near the principal entrance. The numbers must be easily legible figures not less than three inches (3") high for residential, six inches (6") high for commercial, and in a color contrasting with their background. The Department of Fire & Rescue Services recommends reflective numbers.

If you have any questions, **please contact Richard Jordan** at rjordan@howardcountymd.gov

Sincerely,



Tanya Maenhardt
Division of Land Development

TM: RIJ: j

File: 11025 Blevins Dr

CERTIFIED MAIL / RECEIPT REQUESTED

cc: Department of Finance, Water Billing, Becky Sheubrooks
Department of Fire & Rescue Services – Fire Marshal's Office
Maryland Assessments and Taxation
Department of Inspections, Licenses and Permits – Shari Logan
Department of Inspections, Licenses and Permits – Cathy Anest
Department of Inspections, Licenses and Permits – Chris Walker
Inspections Enforcement – Bonnie Harkins
Inspections Enforcement – Rebecca DeMarco
Inspections Enforcement – Linda Reger
Health Department
Election Board
DPZ – Jeff Bronow
DPZ – Carrie Grosch
DPZ – Eric Buschman
DPZ – Zoning
DPW – Bureau of Utilities - Brian Magee
Howard County Public School System – Timothy D. Rogers, Planning Analyst

Postmaster, Clarksville MD 20129-9998
Verizon
Baltimore Gas Electric

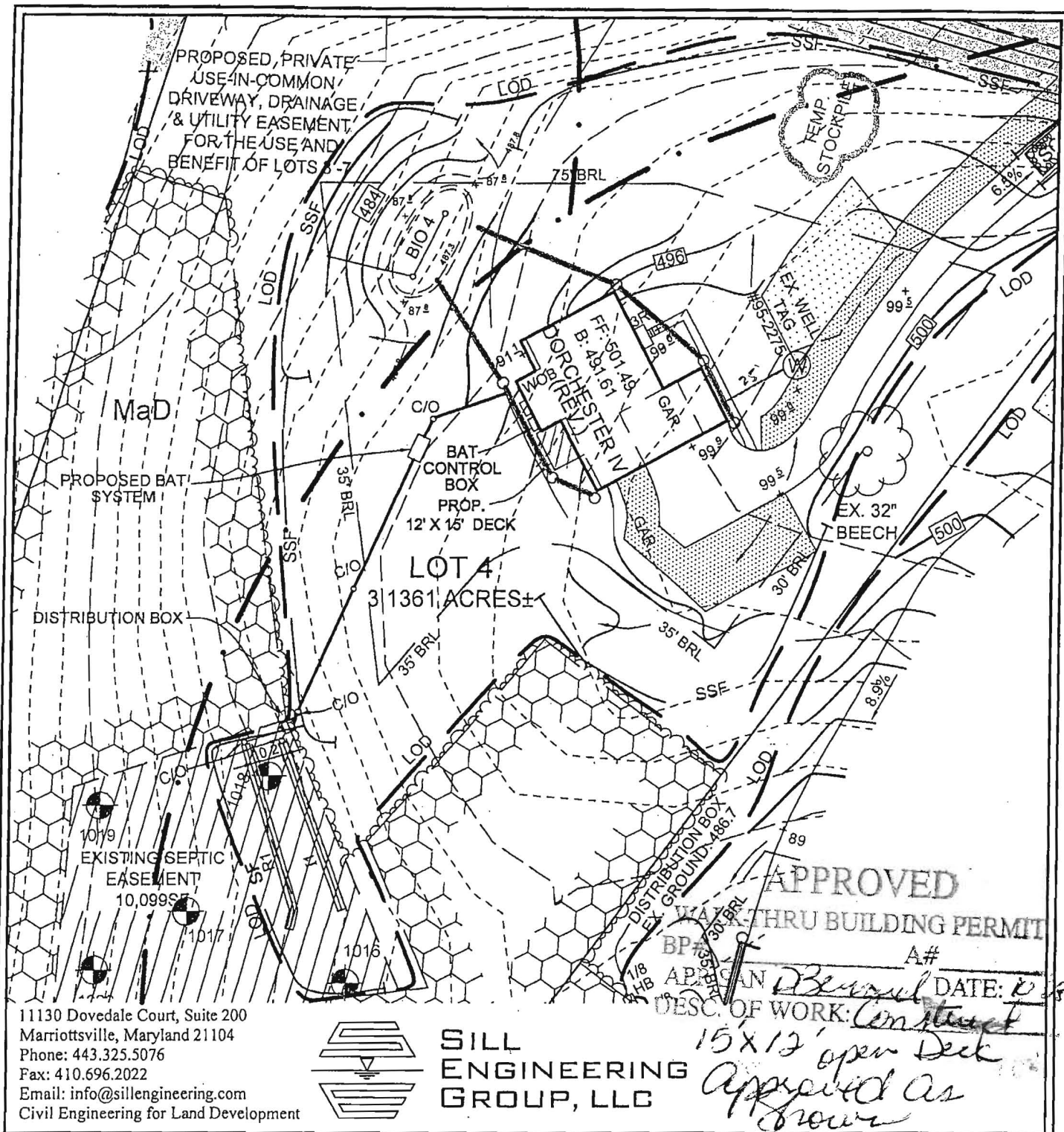

DESIGN BY: PS
DRAWN BY: KSZ
CHECKED BY: PS
SCALE: 1"=50'
DATE: MARCH 26, 2016
PROJECT #: 14-040
SHEET #: 1 OF 1

RESITE BLEVINS PROPERTY LOT 4

TAX MAP 35 GRID 19
5ND ELECTION DISTRICT

PARCEL 310
HOWARD COUNTY, MARYLAND



Building Permit Application

Howard County Maryland
Department of Inspections, Licenses and Permits
3430 Court House Drive
Permits: 410-313-2455
www.howardcountymd.gov

Date Received: 4-6-15

Permit No.: B15001229

Building Address: 11023 Blevins Drive
City: Clarksville State: MD Zip Code: 21029
Suite/Apt. # SDP/WP/BA #: F13-394
Census Tract: Subdivision: Blevins Pkwy
Section: Area: Lot: 4
Tax Map: 35 Parcel: Grid: 19
Zoning: Map Coordinates: Lot Size: 3.13/1.4

Existing Use: Vacant lot
Proposed Use: SHA
Estimated Construction Cost: \$ 453,000
Description of Work: Detached 2 w/ 4 BR w/ 2 1/2 BA
2 1/2 BR 1 1/2 BA 2 1/2 BA 2 1/2 BA 11R
3 1/2 BR 1 1/2 BA 2 1/2 BA 2 1/2 BA 11R
Occupant or Tenant:
Was tenant space previously occupied? ☐ Yes ☒ No
Contact Name:
Address:
City: State: Zip Code:
Phone: Fax:
Email:

Property Owner's Name: Williamsburg Group LLC
Address: 5495 Harpers Lane #200
City: Clarksville State: MD Zip Code: 21029
Phone: 410-593-3500 Fax:
Email: mcmorris@williamsburggroup.com

Applicant's Name & Mailing Address, (If other than stated herein)
Applicant's Name: Same
Address:
City: State: Zip Code:
Phone: Fax:
Email:

Contractor Company:
Contact Person:
Address:
City: State: Zip Code:
License No.: 155
Phone: Fax:
Email:

Engineer/Architect Company:
Responsible Design Prof.:
Address:
City: State: Zip Code:
Phone: Fax:
Email:

Commercial Building Characteristics	Residential Building Characteristics
Height:	<input checked="" type="checkbox"/> SF Dwelling <input type="checkbox"/> SF Townhouse
No. of stories:	Depth Width
Gross area, sq. ft./floor:	1 st floor:
Area of construction (sq. ft.):	2 nd floor:
Use group:	Basement:
	<input type="checkbox"/> Finished Basement
	<input type="checkbox"/> Unfinished Basement
	<input type="checkbox"/> Crawl Space
Construction type:	<input type="checkbox"/> Slab on Grade
<input type="checkbox"/> Reinforced Concrete	No. of Bedrooms: 4
<input type="checkbox"/> Structural Steel	Multi-family Dwelling
<input type="checkbox"/> Masonry	No. of efficiency units:
<input type="checkbox"/> Wood Frame	No. of 1 BR units:
<input type="checkbox"/> State Certified Modular	No. of 2 BR units:
	No. of 3 BR units:
	Other Structure:
	Dimensions:
➤ Roadside Tree Project Permit	Footings:
<input type="checkbox"/> Yes <input checked="" type="checkbox"/> No	Roof:
Roadside Tree Project Permit #	<input type="checkbox"/> State Certified Modular
	<input type="checkbox"/> Manufactured Home

Utilities
Water Supply
<input type="checkbox"/> Public
<input checked="" type="checkbox"/> Private
Sewage Disposal
<input type="checkbox"/> Public
<input checked="" type="checkbox"/> Private
Electric: <input type="checkbox"/> Yes <input type="checkbox"/> No
Gas: <input type="checkbox"/> Yes <input type="checkbox"/> No
Heating System
<input type="checkbox"/> Electric <input type="checkbox"/> Oil
<input checked="" type="checkbox"/> Natural Gas <input type="checkbox"/> Propane Gas
Other:
Sprinkler System:
<input checked="" type="checkbox"/> Yes <input type="checkbox"/> No
Grading Permit Number:
Building Shell Permit Number:

THE UNDERSIGNED HEREBY CERTIFIES AND AGREES AS FOLLOWS: (1) THAT HE/SHE IS AUTHORIZED TO MAKE THIS APPLICATION; (2) THAT THE INFORMATION IS CORRECT; (3) THAT HE/SHE WILL COMPLY WITH ALL REGULATIONS OF HOWARD COUNTY WHICH ARE APPLICABLE THERETO; (4) THAT HE/SHE WILL PERFORM NO WORK ON THE ABOVE REFERENCED PROPERTY NOT SPECIFICALLY DESCRIBED IN THIS APPLICATION; (5) THAT HE/SHE GRANTS COUNTY OFFICIALS THE RIGHT TO ENTER ONTO THIS PROPERTY FOR THE PURPOSE OF INSPECTING THE WORK PERMITTED AND POSTING NOTICES.

Applicant's Signature: [Signature]
Email Address: mcmorris@williamsburggroup.com
Title/Company: [Signature]

Print Name: [Signature]
Date: 4/6/15

Checks Payable to: DIRECTOR OF FINANCE OF HOWARD COUNTY

PLEASE WRITE NEATLY & LEGIBLY

-FOR OFFICE USE ONLY-

AGENCY	DATE	SIGNATURE OF APPROVAL
State Highways		
Building Officials		
PSZA (Zoning)		
PSZA (Engineering)		
Health	4/27/15	[Signature]

Is Sediment Control approval required for issuance? ☐ Yes ☒ No
☐ CONTINGENCY CONSTRUCTION START

DPZ SETBACK INFORMATION
Front:
Rear:
Side:
Side St.:
All minimum setbacks met? <input type="checkbox"/> Yes <input type="checkbox"/> No
Is Entrance Permit Required? <input type="checkbox"/> Yes <input type="checkbox"/> No
Historic District? <input checked="" type="checkbox"/> Yes <input type="checkbox"/> No
Lot Coverage for New Town Zone:
SDP/Red-line approval date:

Filing Fee	\$
Permit Fee	\$
Tech Fee	\$
Excise Tax	\$
PSFS	\$
Guaranty Fund	\$
Add'l per Fee	\$
Total Fees	\$
Sub-Total Paid	\$
Balance Due	\$
Check	#

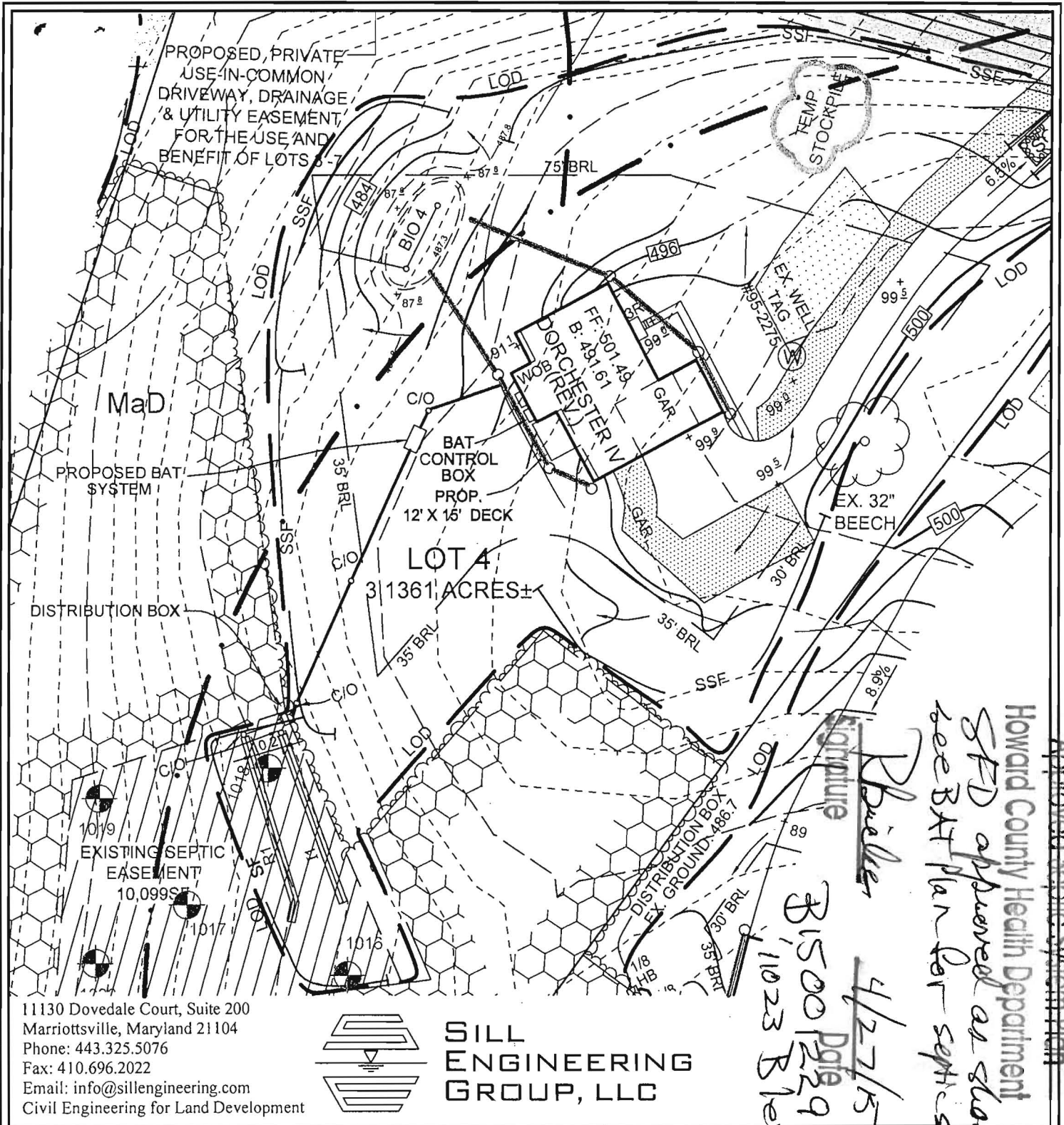

DESIGN BY: PS
DRAWN BY: KSZ
CHECKED BY: PS
SCALE: 1"=50'
DATE: MARCH 26, 2016
PROJECT #: 14-040
SHEET #: 1 OF 1

RESITE
BLEVINS PROPERTY
LOT 4

TAX MAP 35 GRID 19
5ND ELECTION DISTRICT

PARCEL 310
HOWARD COUNTY, MARYLAND

Approved Septic System Plan
Howard County Health Department
SFD approved as shown
see BAT Plan for septic system details