



# APPLICATION

FOR PERCOLATION TESTING AND SITE EVALUATION

TEST DATE(S) \_\_\_\_\_ TEST TIME \_\_\_\_\_

AP 520108-R

AGENCY REVIEW: \_\_\_\_\_

DATE 4/9/04

DO NOT WRITE ABOVE THIS LINE

I HEREBY APPLY FOR THE NECESSARY TESTING/EVALUATION PRIOR TO ISSUANCE OF SEWAGE DISPOSAL SYSTEM PERMIT(S) TO:

CHECK AS NEEDED:

- CONSTRUCT NEW SEPTIC SYSTEM(S)
- REPAIR/ADD TO AN EXISTING SEPTIC SYSTEM
- REPLACE AN EXISTING SEPTIC SYSTEM

CHECK AS NEEDED:

- NEW STRUCTURE(S)
- ADDITION TO AN EXISTING STRUCTURE
- REPLACE AN EXISTING STRUCTURE

CHECK ONE:

- CREATE NEW LOT(S)
- BUILD ON AN EXISTING LOT IN A SUBDIVISION
- BUILD ON AN EXISTING PARCEL OF RECORD

IS THE PROPERTY WITHIN 2500' OF ANY RESERVOIR?

- YES
- NO

THE TYPE OF STRUCTURE IS:

- RESIDENTIAL WITH unknown PROPOSED BEDROOMS IN THE COMPLETED STRUCTURE (NOTE UNKNOWN IF APPROPRIATE)
- COMMERCIAL (PROVIDE DETAIL OF NUMBERS AND TYPES OF EMPLOYEES/ CUSTOMERS ON ACCOMPANYING PLAN)
- INSTITUTIONAL/GOVERNMENT (PROVIDE DETAIL OF NUMBERS AND TYPES OF EMPLOYEES/USERS ON ACCOMPANYING PLAN)

PROPERTY OWNER(S) LDEI Inc. Lee Plaza

DAYTIME PHONE 301-585-7000 CELL \_\_\_\_\_ FAX \_\_\_\_\_

MAILING ADDRESS 8601 Georgia Ave. Silver Spring MD 20910  
STREET CITY/TOWN STATE ZIP

APPLICANT VanMar Associates Inc.

DAYTIME PHONE 301-829-2890 CELL \_\_\_\_\_ FAX \_\_\_\_\_

MAILING ADDRESS 310 South Main St. Mount Airy MD 21771  
STREET CITY/TOWN STATE ZIP

APPLICANT'S ROLE: DEVELOPER BUILDER BUYER RELATIVE/FRIEND REALTOR CONSULTANT

PROPERTY LOCATION  
SUBDIVISION/PROPERTY NAME Schwabe Farms LOT NO. 12

PROPERTY ADDRESS MD Route 32 West Friendship 21794  
STREET TOWN/POST OFFICE

TAX MAP PAGE(S) 15 GRID 5 PARCEL(S) 12 PROPOSED LOT SIZE 1AC±

AS APPLICANT, I UNDERSTAND THE FOLLOWING: THE SYSTEM INSTALLED SUBSEQUENT TO THIS APPLICATION IS ACCEPTABLE ONLY UNTIL PUBLIC SEWERAGE IS AVAILABLE. THIS APPLICATION IS COMPLETE WHEN ALL APPLICABLE FEES AND A SUITABLE SITE PLAN HAVE BEEN RECEIVED. I ACCEPT THE RESPONSIBILITY FOR COMPLIANCE WITH ALL M.O.S.H.A. AND "MISS UTILITY" REQUIREMENTS. APPROVAL IS BASED UPON SATISFACTORY REVIEW OF A PERC CERTIFICATION PLAN.

TEST RESULTS WILL BE MAILED TO APPLICANT.

Danielle Stout  
SIGNATURE OF APPLICANT

HOWARD COUNTY HEALTH DEPARTMENT, BUREAU OF ENVIRONMENTAL HEALTH, WELL AND SEPTIC PROGRAM  
3525-H ELLICOTT MILLS DRIVE, ELLICOTT CITY, MARYLAND 21043-4544 (410) 313-1771 FAX (410) 313-2648  
TDD (410) 313-2323 TOLL FREE 1-877-4MD-DHMH

AMP \_\_\_\_\_

457  
 Browns/L 1'  
 Orange/Red micaceous Sil 4'  
 Yellow/Brown Sil 9'  
 Glac/orange 2d mottls  
 water 11'

458  
 Browns/Orange L 2'  
 Orange/gray 2f mottles 4 1/2'

Orange/gray 2d mottls - no rock 8'

459  
 Browns/L 1'  
 Yellow/Brown Sil 3'  
 Brown/Yellow Sil 7'  
 Brown/gray orange 2f mottls  
 water 8'

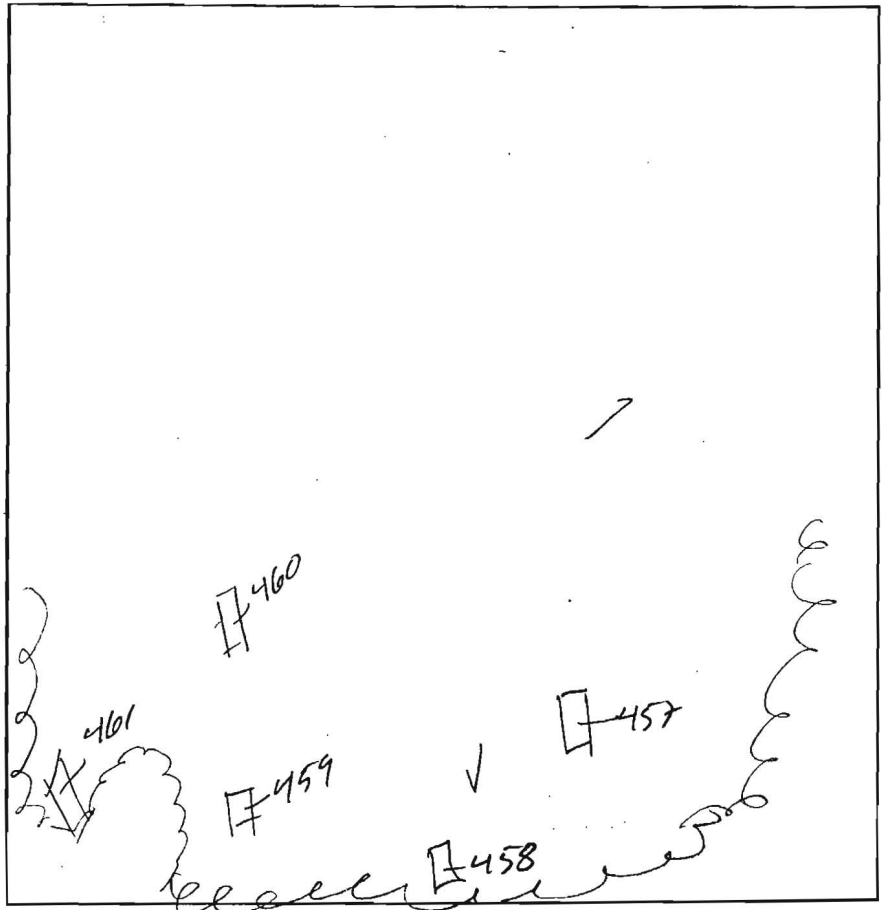

460  
 Browns/L 1'  
 Red/Orange Yellow micaceous Sil 4 1/2'  
 Brown/Red Black Sil fine Red 9 1/2'  
 Gray/Orange mottls water 11'

461  
 Browns/L 1'  
 Orange/Brown Red micaceous Sil 4'  
 Yellow/Brown micaceous Sil 10'  
 Gray/Brown Sil fine Red 11'  
 water 12'

DATE	TEST #	DEPTH	START	BREAK 1" DROP	STOP 2" DROP	TIME OF 2ND INCH	P/F/H
7/14/04	457	5' 11"	11:08	11:15	11:24	9min	P
	458	8'	- Visual				F
	459	4' 8"	11:31	11:35	11:40	5min	P
	460	4 1/2' 11'	11:44	- Pulled 12:05		slow	F
	461	4' 12'	12:15	- Pulled 12:45		slow	F
Failed Test Hole							

REMARKS All holes dug per plan  
 SANITARIAN KSB BACKHOE Zack OTHERS JUSTIN  
 TEST HOLES USED IN SDA \_\_\_\_\_ AVG. PERC TIME \_\_\_\_\_ SQ. FT/BR \_\_\_\_\_  
 TRENCH WIDTH \_\_\_\_\_ INLET DEPTH \_\_\_\_\_ MAX. BOT DEPTH \_\_\_\_\_ EFFECTIVE SW \_\_\_\_\_

AP  
544

Brown L	1/2'
Red/Orange micaceous Scl	4'
Yellow/Brown micaceous sil w/ 15% qtz frags.	12'

534

Brown L	1/2'
Orange/Brown Red micaceous Scl	4'
Yellow/Brown micaceous sil w/ 10% Saprolite	13'

-moist-

535

Brown L	1'
Yellow/Brown Red scl w/ D-3 gray/orange mottling	4'
Yellow/Brown scl w/ D-3 mottling + 5% sporelite	10'
Water	11'

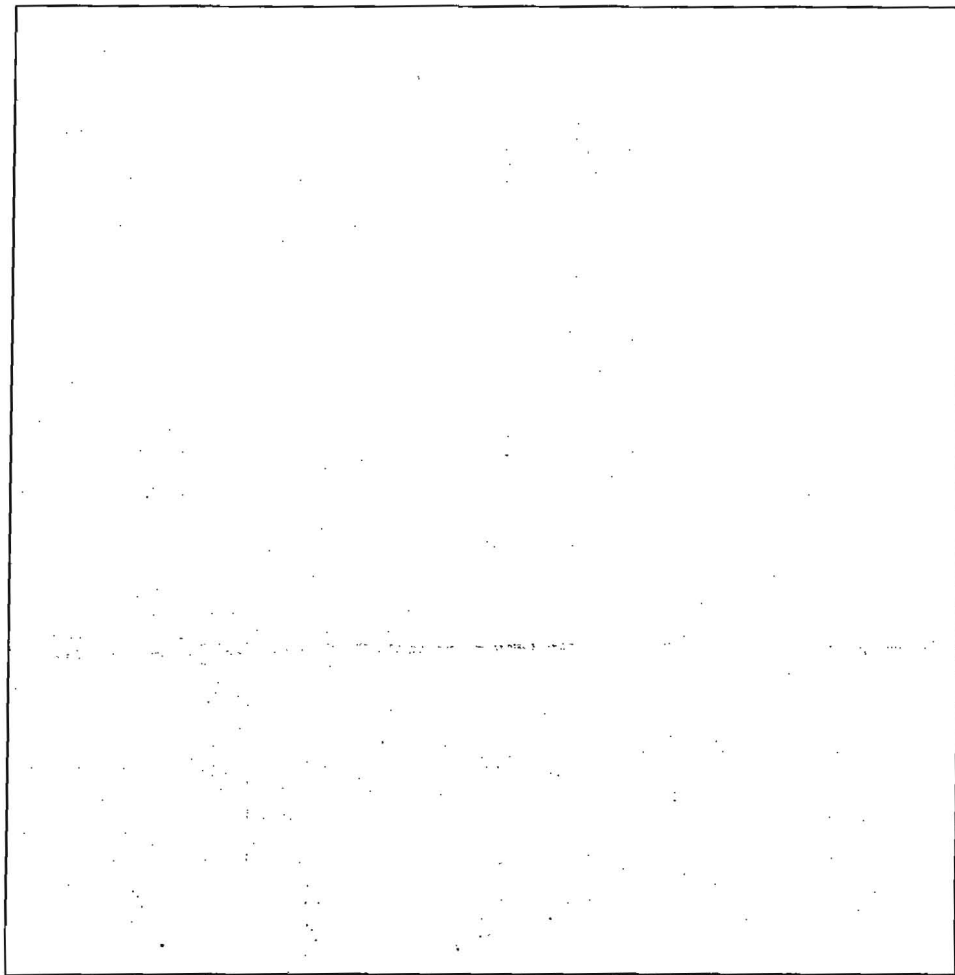

533

Brown L	1/2'
Red/Orange Scl	4'
Yellow/Brown micaceous sil w/ 5% Saprolite	12'

A

Brown L	1'
Red/Orange Brown Scl	4'
Yellow/Brown micaceous sil w/ 10% Saprolite	12'

DATE	TEST #	DEPTH	START	BREAK 1" DROP	STOP 2" DROP	TIME OF 2nd INCH	P/F/H
11/3/07	544	4 1/2' / 12'	10:04	10:06	10:11	5 min	P
	534	4 1/2' / 13'	10:39	10:41	10:47	6 min	P
	535	- / 11'	Visual	-		H2O	F
	533	4 1/2' / 12'	11:20	11:22	11:24	2 min	P
	A	4 1/2' / 12'	11:30	11:30	11:36	4 min	P
	536	5 1/2' / 15'	11:58	12:00	12:03	3 min	P

536

Brown L	1'
Brown/Yellow non Scl	5'
Brown/Yellow micaceous sil w/ 10% sporelite	11'
Water	13'

REMARKS all holes dug per plan.

SANITARIAN KJB BACKHOE Justin OTHERS \_\_\_\_\_

TEST HOLES USED IN SDA \_\_\_\_\_ AVG. PERC TIME \_\_\_\_\_ SQ. FT/BR \_\_\_\_\_

TRENCH WIDTH \_\_\_\_\_ INLET DEPTH \_\_\_\_\_ MAX. BOT DEPTH \_\_\_\_\_ EFFECTIVE SW \_\_\_\_\_