

AP 3008

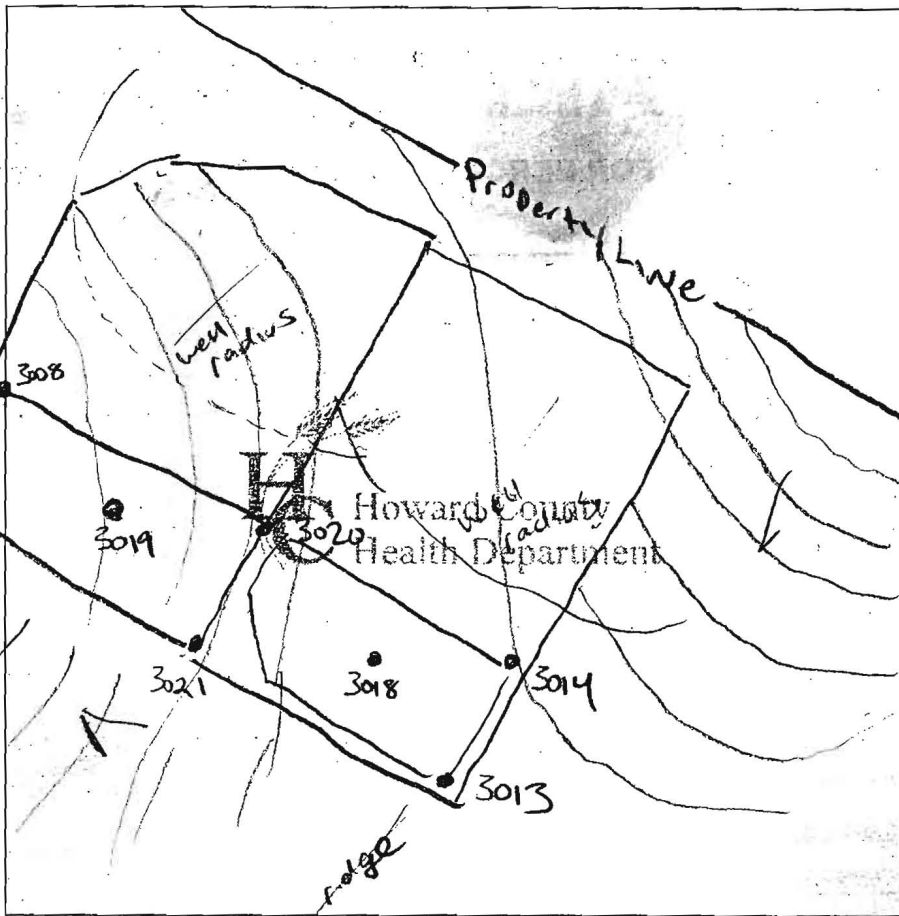

brown
orange brown heavy
3 orange brown sil
5 yellow brown sil
w 15% cherty frass
13' mica schist

3019
brown
red orange brown sil
6 yellow brown sil
8 30% rock cherty frass
13 very fine sil
14' mica schist

3022
brown
orange brown heavy
sil
yellow brown sil
10% mica schist

3021
brown
red purple brown sil
4
5 light purple brown sil
15% cherty frass
mica schist

3020
brown
orange brown heavy
purple brown sil
brown sil
70% cherty frass

3018
brown
orange and purple brown sil
purple brown sil
sil w/ 15% mica schist

DATE	TEST #	DEPTH	START	BREAK 1" DROP	STOP 2" DROP	TIME OF 2nd INCH	P/F/H
3/29	3009	7 14	10:26	10:32	10:41	9	P
	3022	6 13	10:46	10:54	11:04	10	P
	3008	7 13	10:52	11:00	11:12	12	P
	3021	6 14	11:16	11:27	11:37	10	P
*	3020	1 14	11:22	11:38	11:58	20	P
	3018	6 14	11:26	11:32	11:38	6	P
* 3020 - bottom at 8' for trench.							

REMARKS Dug to stick 12" holes. - DRY SOILS.
 SANITARIAN PAY BACKHOE HATFIELD OTHERS ASH-112
 TEST HOLES USED IN SDA _____ AVG. PERC TIME _____ SQ. FT/BR _____
 TRENCH WIDTH _____ INLET DEPTH _____ MAX. BOT DEPTH _____ EFFECTIVE SW _____

**FISHER, COLLINS
& CARTER, INC.**

**CIVIL ENGINEERING CONSULTANTS
and LAND SURVEYORS**

Terrell A. Fisher, P.E., L.S.
Earl D. Collins, P.E.
Charles J. Crovo, Sr., P.E., L.S.

Paul W. Kriebel, P.E.
Mark L. Robel, P.L.S.
Aldo M. Vitucci, P.E.

November 7, 2013

Ms. Heidi Scott
Howard County Health Dept.
7178 Columbia Gateway Dr.
Columbia, MD 21046

RE: Lot 1
Asbury Property
2714 Jennings Chapel Road

Dear Heidi:

Mr. Anthony Fertitta with our firm had contacted you previously on behalf of our client, Mr. Ron Asbury, to confirm that the existing house on Lot 1, Asbury Property, Plat Nos. 20028 thru 20030 (#2714 Jennings Chapel Road) which presently contains 4 bedrooms may be expanded to 5 bedrooms without modification to the existing operational septic system.

Our client has requested that we contact you to obtain this confirmation before expending costs for architectural design.

We appreciate your assistance in responding to Mr. Asbury's request.

Very truly yours,
Fisher, Collins & Carter, Inc.

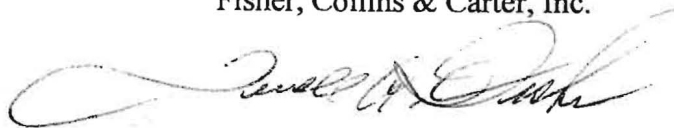

Terrell A. Fisher, P.E., L.S.

WO #30735
c.c. Mr. Ron Asbury