

Benedict Farm

COUNTY #
SOIL PROFILE
672
0' topsoil
red org
brn
cl lm
3.5' med
org brn
sa mica
lm
80%+
rock
12'8" Refusal

SOIL PROFILE
653
0' deep
org
sa
cl lm
6.15-20%
6.1/2' tan beige
lt. brn
sand
15-20%

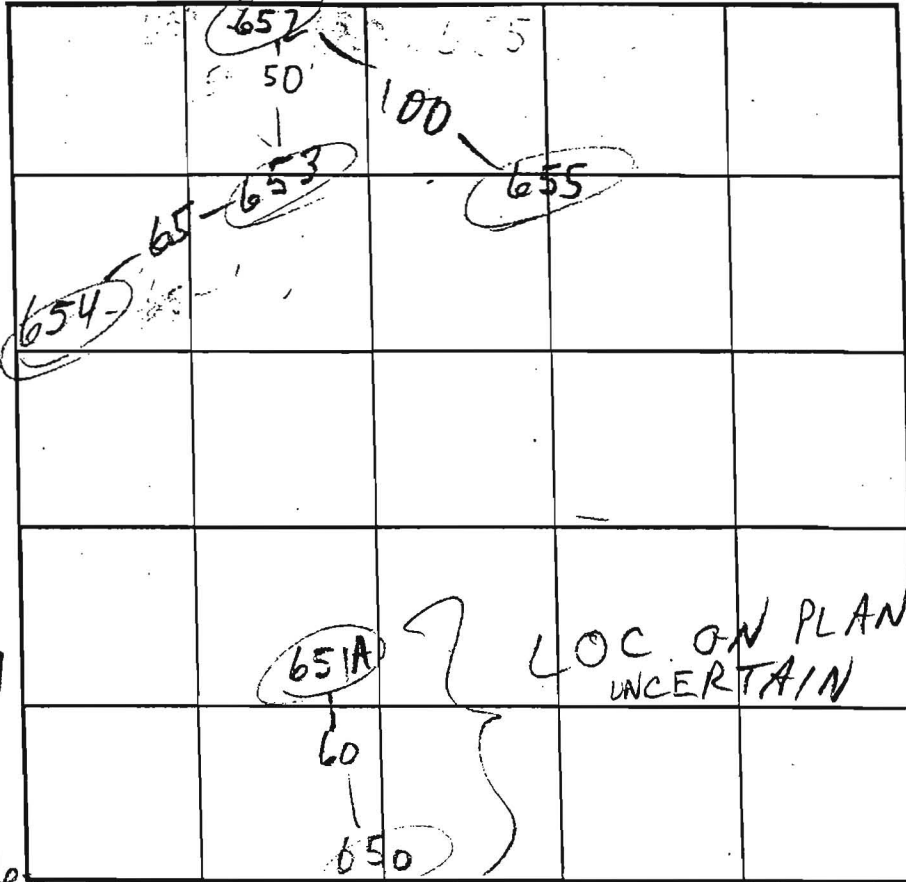

650/51
6
to 6 1/2
13 1/2"
654/652

orge
brn
scl lm
gray mot
tan
beige
sand
10%
13 1/2"

orge brn
el lm
15-20%
Frag
compacted
course
tan brn
sand
15%
Frag

INDICATE NORTH - NAME ADJOINING ROADWAY AS BASE LINE.

DATE	TEST NO.	DEPTH	PRE-WET		TEST - 1" DROP		TIME
			START	STOP	START	STOP	
5-31-01	672	4.9' S	10:26	10:30	10:30	10:33	3 1/2
		12'0" D	Refusal	-see	profile		FAIL
2/21/02	650	6 1/8' 13 1/2"	1:51 2:13:45	2:02 2:21	1/2"	1/2"	FAIL
	651A	6 13 1/2"	1:57:30	1:57:45	1:57:45	1:58:10	25 sec ok
			2:01:20	2:03:50	2:03:50	2:07:00	3+
	654 S	6 1/8' 13 1/2"	2:36:45 3:09:25	2:37:25 3:18	2:37:25 3:18	2:42 3:36	5 18 ok
	653 S	7 13 1/2"	2:51	2:58	2:58	3:12	14 ok
	652 S	5 1/2' 13 1/2"	3:18:50 3:36:30	3:22 3:34	3:22 3:40	3:27 3:45	5 5 ok
	655 S	6 1/2' 13 1/2"	3:43:30	3:45:15	3:45	3:48	3 ok
	650 S	7	4:00	4:10	PULLED DUE		20 min 0

REMARKS _____ DUE TO DROUGHT CONDITIONS, APPROVABLE HOLES MUST HAVE 8 FEET FROM OBSERVED
 TYPE OF SOIL _____
 TESTED BY IVE GROUNDWATER TO BOTTOM OF PROPOSED SEPTIC SYSTEM
 TRENCH DESIGN DATA: _____ TRENCH WIDTH _____
 INLET DEPTH _____ MAXIMUM BOTTOM DEPTH _____ SQ. FT./BEDROOM _____

TD LATE TIME EST
 ALSO PRESENT M. Johnson & crew
Owners

13 1/2"

COUNTY #

SOIL PROFILE

0' (519)

Strong org brn rd brn CLLm to hLm

89'

org brn beige tan micaceous SCL Lm
Rock Frag @ 35-45% (Boulders)

EAST

Bottom

(521) (523)

tan org brn

hLm

56'

org brn Lm

Rock <2%

Bottom

(522)

DENSE 2D, ROBBIN CL Lm Rock 10-15%

6-7

strong brown tan beige SLM w/ quartz (ite) Frag 10-15%

Bottom

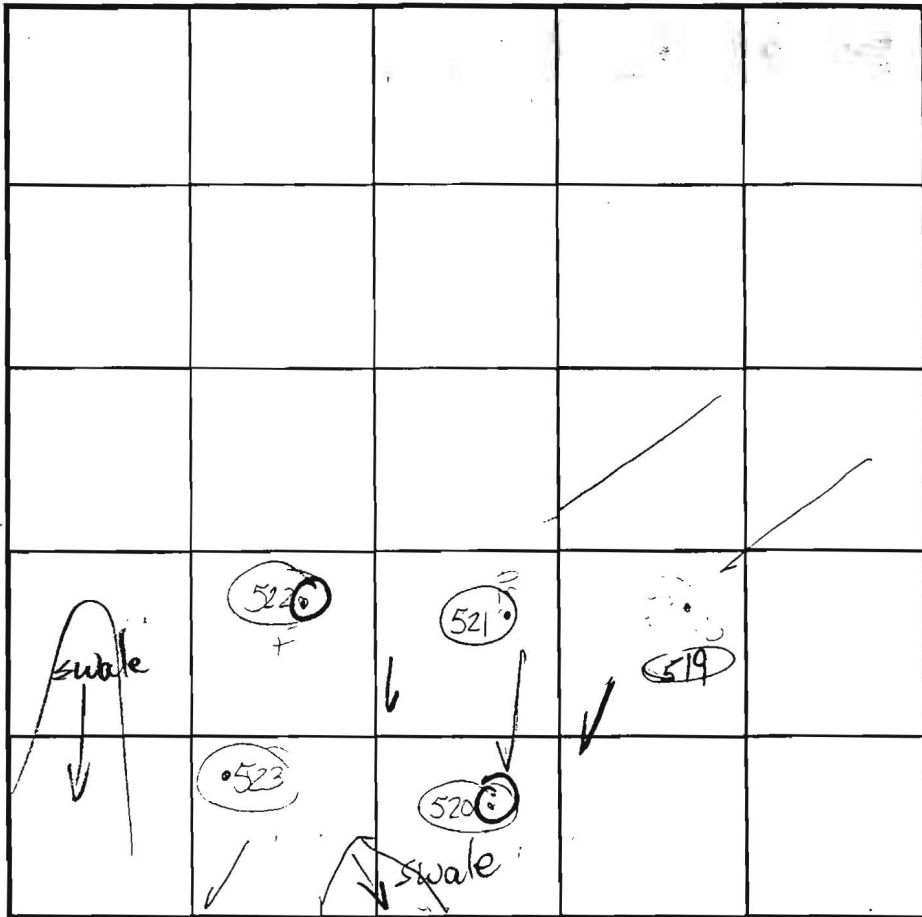

INDICATE NORTH - NAME ADJOINING ROADWAY AS BASE LINE.

North

SOIL PROFILE

0' (520)

HEAVY CL Lm

10-15% rock frag

hLm rd brn brn white aggregation

micaceous brn white h brn SLM

Bottom

DATE	TEST NO.	DEPTH	PRE-WET		TEST - 1" DROP		TIME
			START	STOP	START	STOP	
10/15/01	(519)	7' S	3:59	4:00	4:00	4:02 ³⁰	2 1/2 min
		14' Bottom	DEEPER RETEST		REQ'D		
	(521)	5' S	3:35	3:40	3:40	3:43	3 min
		13 1/2' Bottom					PASS
	(520)	6' 8" / 16	4:04 ⁴⁵	4:32	4:32	1" longer than 30 min	
		8' 10"	2:21	2:50	1" > 30 min		Fail
	(522)	7' 10" / 16	4:09	1" > 30 min			Fail
		9	2:40	1" > 30 min			FAIL
	(523)	Visual	SEE SOIL PROFILE #				PASS

NE CORNER W/ QUARTZ POCKET TO 1 1/2'

REMARKS

HOLES PER PLAN

TYPE OF SOIL

TESTED BY Goodking

ALSO PRESENT Chuck

TRENCH DESIGN DATA: AVERAGE PERCOLATION TIME

TRENCH WIDTH

INLET DEPTH

MAXIMUM BOTTOM DEPTH

SQ. FT/BEDROOM

Mikes & crew

COUNTY #

SOIL PROFILE

SOIL PROFILE

0' 516
 tan
 17. brn
 sac l m
 10-15% frags
 5 1/2
 tan beige
 sand
 15-20% frags
 7 1/2
 30-35%
 struc.
 frags
 12
 15-20%
 frags

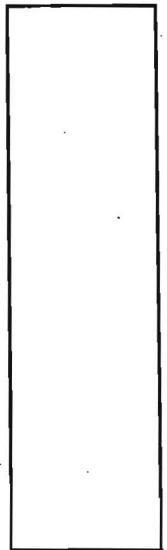
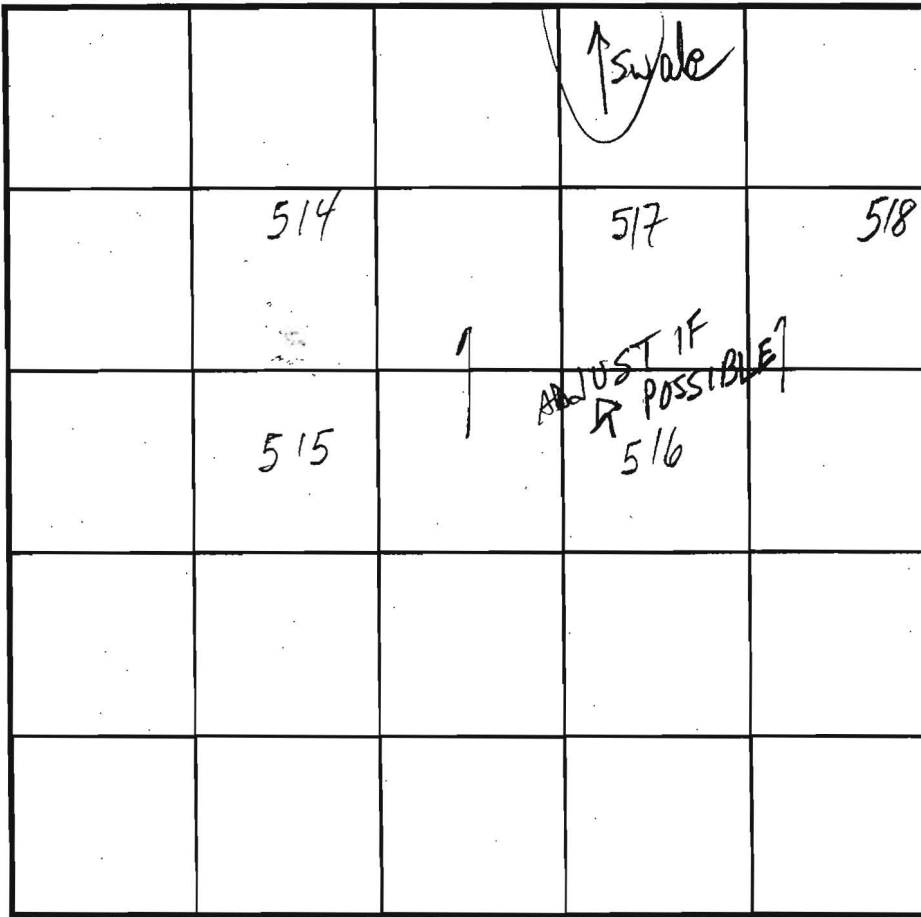

517/515/518

3-4
 orange tan
 sac l m
 15% frags
 tan beige
 sand
 10-15%
 frags

INDICATE NORTH - NAME ADJOINING ROADWAY AS BASE LINE.

DATE	TEST NO.	DEPTH	PRE-WET		TEST - 1" DROP		TIME		
			START	STOP	START	STOP			
10/16/01	516 S	4' 9" / 5 1/2	10:46 12:17:55	11:08 12:18:55	3/4" SLOW 12:18:55	12:20:55	2	OK	
	517	4' 3" / 13	11:02	11:03	11:03	11:05	2	OK	
	514	5' / B	11:22	11:23	11:23	11:25	2	OK	
	515	5' 3" / B	11:27	11:28	11:28	11:30	2	OK	
	518	5' 1/2 / 14	11:47	11:48	11:48	11:52	4	OK	
	516 M	7 1/2	12:02:40	12:05	12:05	12:09	4	OK	
	516	13	MARGINAL - AVOID BY 25'						

514

orange tan
 sac l m
 10% frags
 3
 tan beige
 orange
 sand
 15%
 frags
 7

REMARKS: Lots 99,100 ALL HOLES PER PLAN

TYPE OF SOIL: _____

TESTED BY: MARK RIFKIN ALSO PRESENT: Chuck Crowe
Mike Sacrew

TRENCH DESIGN DATA: AVERAGE PERCOLATION TIME _____ TRENCH WIDTH _____

INLET DEPTH _____ MAXIMUM BOTTOM DEPTH _____ SQ. FT./BEDROOM _____

13



D10

P17

STREAM BUFFER

POINT OF HOMEWOOD
PLAN NO. 8004
ZONED RC-20
LOT 12

PROF. SWIM FACILITY NO. 9
BIG REDDITION FACILITY FOR HWY 4 & CRY...
RETAINED BY...

HOMEWOOD
1363
5691 1337

24' USE-IN-COMMON
ACCESS EASEMENT
FOR LOTS 44 - 52



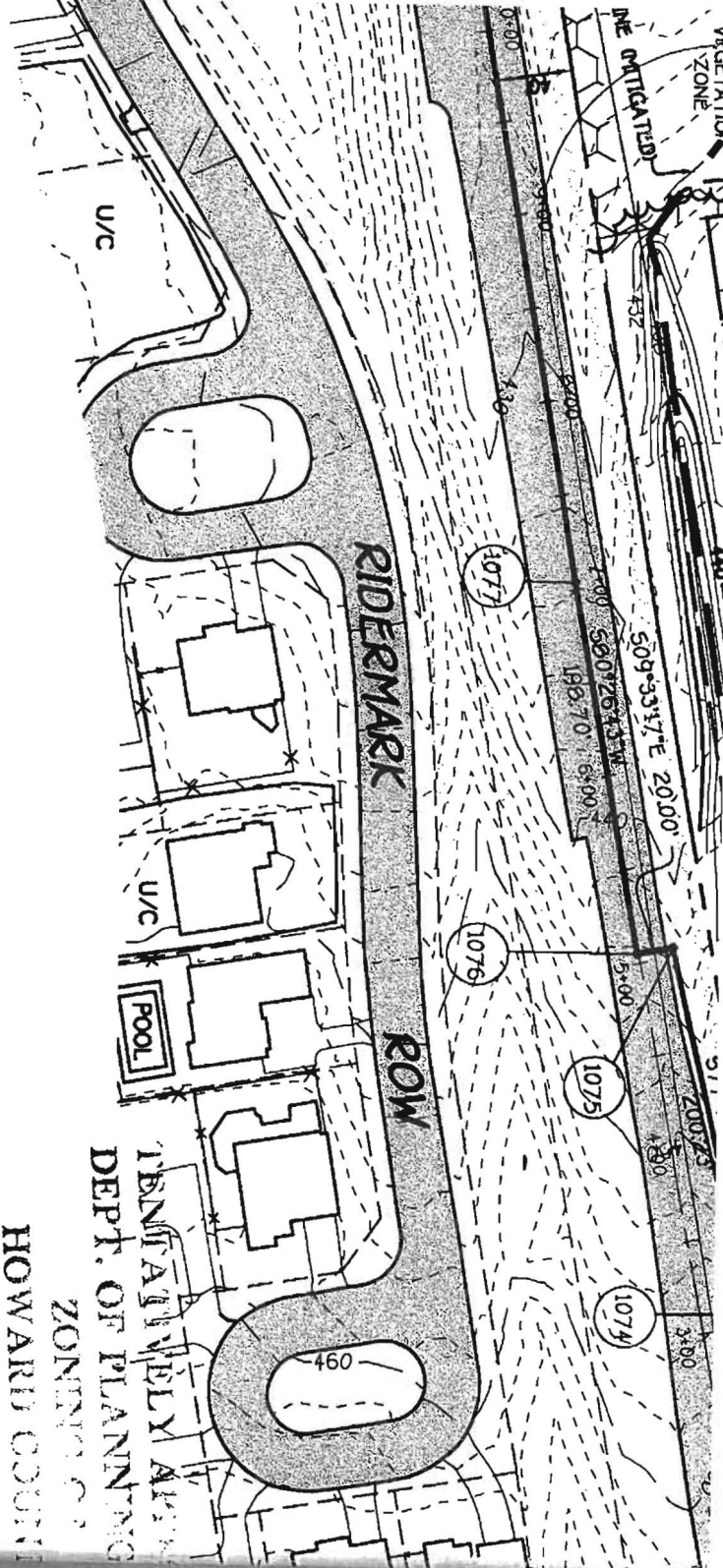

BENJAMIN W. WELLS
 DEPT. OF PLANNING
 ZONING OFFICER
 HOWARD COUNTY

LOPER

OTHERS, INC.
 SCOTT HARE
 STEWAY DR., SUITE 230
 MARYLAND 21046

APPROVED FOR PRIVATE WATER AND PRIVATE SEWERAGE SYSTEMS,
 HOWARD COUNTY HEALTH DEPARTMENT.

[Signature]
 COUNTY HEALTH OFFICER

1/3/03
 DATE

LEGEND:

- EXISTING WELL BOX
(TO BE ABANDONED BY
THIS PERCOLATION
CERTIFICATION PLAN)
- EXISTING WELL
- PROPOSED NEW WELL BOX
(1,586 S.F.)
- EXISTING PASSED PERC.
- EXISTING SEPTIC AREA

*Lot 66
Septic Tank
not installed (10/9/09)
Inquiry placed in
file: location
adjusted per
perc cert
approval for lot 65*

NOTES:

THE LOT SHOWN HEREON WAS RECORDED ON MAY 2, 2006 AS PLAT NUMBER 18245. REFER TO THIS PLAT FOR LOT DIMENSIONS, LOT AREAS, ALL EASEMENTS AND BUILDING RESTRICTIONS.

THIS AREA DESIGNATES A PRIVATE SEWAGE DISPOSAL AREA OF AT LEAST 10,000 SQ. FT. AS REQUIRED BY THE MARYLAND DEPARTMENT OF ENVIRONMENT FOR INDIVIDUAL SEWAGE DISPOSAL. IMPROVEMENTS OF ANY NATURE IN THIS AREA ARE RESTRICTED. THIS SEWAGE DISPOSAL AREA SHALL BECOME NULL AND VOID UPON CONNECTION TO A PUBLIC SEWERAGE SYSTEM. THE COUNTY HEALTH OFFICER SHALL HAVE AUTHORITY TO GRANT ADJUSTMENTS TO THE PRIVATE SEWAGE EASEMENT. RECORDATION OF A REVISED SEWAGE EASEMENT SHALL NOT BE NECESSARY.

ANY CHANGES TO A PRIVATE SEWAGE EASEMENT SHALL REQUIRE A REVISED PERCOLATION CERTIFICATION PLAN.

ALL WELLS AND SEPTIC SYSTEMS LOCATED WITHIN 100' OF THE PROPERTY BOUNDARIES AND 200' DOWN GRADIENT OF ANY WELLS AND/OR SEPTIC SYSTEMS HAVE BEEN SHOWN.

EXISTING TOPOGRAPHY IS TAKEN FROM AERIAL SURVEY WITH 2 - FOOT CONTOUR INTERVALS PREPARED BY 3Di, L.L.C. DATED APRIL 14, 2001 AND SUPPLEMENTED BY FIELD RUN TOPOGRAPHY PREPARED BY FISHER, COLLINS & CARTER, INC.

THE PURPOSE OF THIS PERCOLATION CERTIFICATION PLAN IS TO ADJUST THE WELL BOX LOCATIONS IN SUPPORT OF A BUILDING PERMIT APPLICATION FOR NEW CONSTRUCTION AT 11216 INDEPENDENCE WAY, ELLICOTT CITY, MARYLAND 21043.

THE EXISTING WELL(S) SHOWN ON THIS PLAN (IDENTIFIED WITH THE ATTACHED WELL TAG NUMBER HO-95-1293) HAS BEEN FIELD LOCATED AND IS ACCURATELY SHOWN.

WELL No.	HO-95-1293	
INV. @ HOUSE		447.7
GROUND @ INV. @ HOUSE		455.0
INV. IN TANK		446.6
INV. OUT TANK		446.3
TOP OF TANK		447.3
GROUND OVER TANK		448.7
INV. IN DIST. BOX		446.1
INV. OUT DIST. BOX		445.8
GROUND @ BOX		448.0

APPROVED:
FOR PRIVATE WATER & PRIVATE SEWAGE SYSTEMS
HOWARD COUNTY HEALTH DEPARTMENT

COUNTY HEALTH OFFICER _____ DATE _____

ADDRESS: 11216 INDEPENDENCE WAY
ELLICOTT CITY, MD 21043

TYPE: COVINGTON (HERITAGE)-

- WALKOUT BASEMENT
- ADD'L 1' TO HEIGHT OF BASEMENT
- BRICK SIDES AND REAR OF HOME
- EXPANDED BASEMENT
- SOLARIUM

- OPTION No. 017
- OPTION No. 070
- OPTION No. 673
- OPTION No. 046
- OPTION No. 501

BUILDING SETBACKS (B.R.L.'s) SHOWN HEREON PER SITE DEVELOPMENT PLAN SETBACK DISTANCES SHOWN HEREON AS "±" HAVE AN ACCURACY OF ±0.1' FOOT.



PERMIT PLOT PLAN &
PERCOLATION CERTIFICATION PLAN

LOT #65
HOMWOOD CROSSING

D.B. 9808, PG. 204
PLAT No. 18245
THIRD ELECTION DISTRICT
HOWARD COUNTY

*Septic Tank
well box
Spatial relationship*

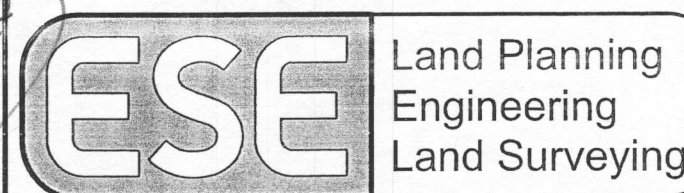

ESE Consultants Inc.
7164 Columbia Gateway Dr.
Suite 203
Columbia, MD 21046
TEL: 410-872-9105
FAX: 410-872-4870

DATE: 10/07/09 SCALE: 1"=50' FILE: LOT 65 Covington Heritage
CHK'D: MJB JOB#: 1214 DRAWN: GVS