

C1 13417

SEQUENCE NO. (MDE USE ONLY)

STATE OF MARYLAND WELL COMPLETION REPORT

THIS REPORT MUST BE SUBMITTED WITHIN 45 DAYS AFTER WELL IS COMPLETED.

1 2 3 6 (THIS NUMBER IS TO BE PUNCHED IN COLS. 3-6 ON ALL CARDS)

COUNTY NUMBER

ST/CO USE ONLY DATE RECEIVED

DATE WELL COMPLETED

Depth of Well

PERMIT NO. FROM "PERMIT TO DRILL WELL"

OWNER Wertheimer last name first name TOWN Columbia

WELL LOG table with columns: DESCRIPTION, FEET (FROM, TO), check if water bearing. Includes entries for 'Dirt' and 'Hard Gray'.

GROUTING RECORD form with fields for material type (CM, BC), bags, pounds, and gallons of water.

CASING RECORD form with fields for casing type (ST, CO, PL, OT) and main casing details.

OTHER CASING (if used) form with fields for diameter and depth.

SCREEN RECORD form with fields for screen type (ST, BR, HO, PL, OT) and depth.

DEPTH (nearest ft.) table with columns for casing height and depth.

GRAVEL PACK IF WELL DRILLED WAS FLOWING WELL INSERT F IN BOX 68

MDE USE ONLY (NOT TO BE FILLED IN BY DRILLER) form with fields T, W, Q.

PUMPING TEST form with fields for hours pumped, rate, method, and pump type.

PUMP INSTALLED form with fields for driller, pump type, capacity, and horse power.

NUMBER OF UNSUCCESSFUL WELLS: 0

WELL HYDROFRACTURED Y N

CIRCLE APPROPRIATE LETTER A, E, P

DRILLERS LIC. NO. 1 MWD 304 David Kelly

DRILLERS SIGNATURE JASON MORRISON LIC. NO. 1 MWD 376

SITE SUPERVISOR (sign. of driller or journeyman responsible for sitework if different from permittee)

LATITUDE 39.131965 LONGITUDE 76.888068

NOTES: ON approved Flags & PlatPhw

B 1 0384

SEQUENCE NO. (MDE USE ONLY)

STATE OF MARYLAND APPLICATION FOR PERMIT TO DRILL WELL please type

STATE PERMIT NUMBER

HO-95-2289 fill in this form completely

537265

Date Received (APA)

04 18 12

OWNER INFORMATION

Wertheimer Michael 10817 Hunting Lane Columbia MD 21044

LOCATION OF WELL

Howard Holiday Hills 5 53 Simpsonville 3/4

DRILLER INFORMATION

DAVID KELLY MWD 304 Jones Well Drilling Inc 3700 Bush Rd. Taneytown MD 21054 David Kelly 4-12-12

DIRECTION OF WELL FROM TOWN (CIRCLE BOX)

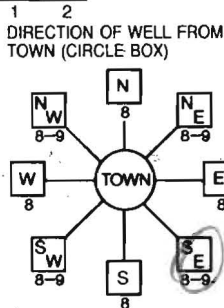

10817 Hunting Lane NEAR WHAT ROAD ON WHICH SIDE OF ROAD NORTH SOUTH WEST EAST 160 FT DISTANCE FROM ROAD ENTER FT OR MI TAX MAP: 0041 BLK: 5 PARCEL 0273

WELL INFORMATION APPROX. PUMPING RATE 0 AVERAGE DAILY QUANTITY NEEDED 0

USE FOR WATER (CIRCLE APPROPRIATE BOX)

- Domestic Potable Supply & Residential Irrigation, Farming, Industrial, Public Water Supply Well, Test, Observation, Monitoring, Geo-Thermal (circled) 2 holes closed loop

NOT TO BE FILLED IN BY DRILLER HEALTH DEPARTMENT APPROVAL

Howard 13 COUNTY NAME COUNTY NO. STATE SIGNATURE INSERT S DATE ISSUED 5/1/2011 Brian Baker 5/1/2012

APPROXIMATE DEPTH OF WELL 400 FEET

APPROXIMATE DIAMETER OF WELL 6 INCH NEAREST INCH

METHOD OF DRILLING (circle one)

- Bored, Jetted, Jetted & Driven, Air-Rotary, Air-PerCussion (circled), Rotary, Cable, Reverse-Rotary, Drive-Point

REPLACEMENT OR DEEPEMED WELLS (CIRCLE APPROPRIATE BOX)

- Not replace existing well (circled), Replace abandoned well, Replace well for standby, Deepen existing well

PERMIT NUMBER OF WELL TO BE REPLACED OR DEEPEMED

Not to be filled in by driller (MDE OR COUNTY USE ONLY)

APPROP. PERMIT NUMBER G

PERMIT No HO-95-2289

SHOW MAJOR FEATURES OF BOX & LOCATE WELL WITH AN X

SOURCES OF DRILLING WATER 1, 2, 3

WRITE THE BOX NUMBER FROM THE MAP HERE

E 76° 54' 00" N 39° 10' 30"

DRAW A SKETCH BELOW SHOWING LOCATION OF WELL IN RELATION TO NEARBY TOWNS AND ROADS AND GIVE DISTANCE FROM WELL TO NEAREST ROAD JUNCTION

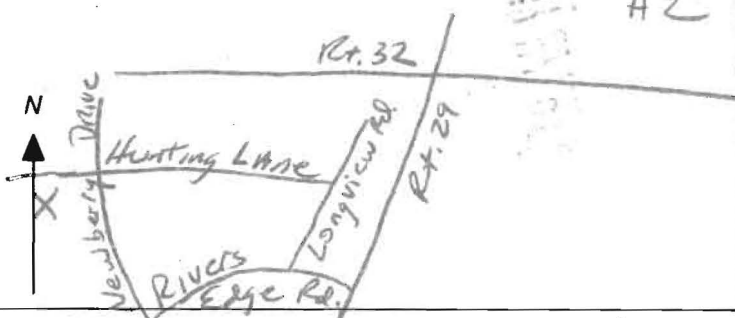

SPECIAL CONDITIONS

NOTE - APPROVING AUTHORITIES SHOULD USE SEPARATE SHEET IF NEEDED

Driller: Jones Well Drilling Inc.
 contact: David Kelly
 410-692-6987

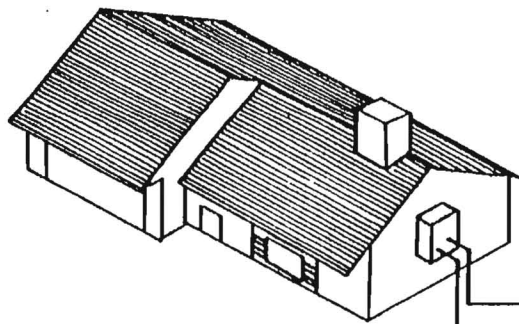

bury depth 5' below grade

Wyo-Ben bentonite-E2 GROUT
 GROUT (50 lb. bags)
 mixed with 24 gallons
 of water per
 manufacturer specs
 yields 27 gal. slurry
 with a 0.42 btu/ft-hr.
 thermal conductivity

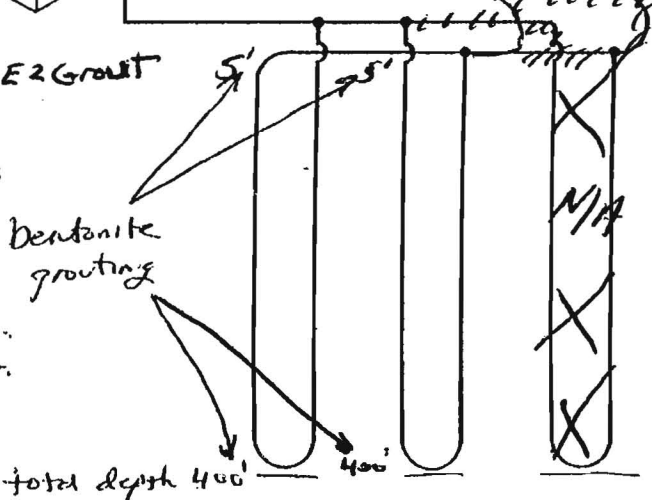

Earth Coil Type: Vertical - Single U-Bend

Water Flow: Parallel

Pipe Sizes: 1 1/4" double Loop

Bore Lengths: 400' x 2 holes (800' vertical bore)

Pipe Lengths: 800 x 2 (1600 vertical pipe)

FIGURE 4.5: Parallel Vertical Ground Heat Exchanger

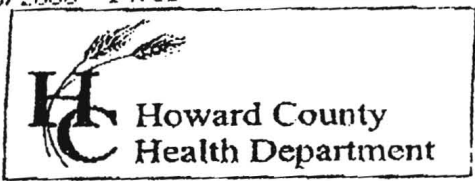

7178 Columbia Gateway Drive, Columbia MD 21046
 (410) 313-2640 Fax (410) 313-2648
 TDD (410) 313-2323 Toll Free 1-866-313-6300
 website: www.hchealth.org

Penny E. Borenstein, M.D., M.P.H., Health Officer

TO ALL INTERESTED PARTIES

When submitting a well permit application for a proposed well for new construction, please indicate one of the following:

Well Site Location:
10817 Hunting Lane
 Subdivision/Property Name Lot# Road Name

The well site has been staked by _____
 (professional land surveyor or company employing professional land surveyors)
 on _____ (date) and does not require a site inspection.

well site staked on 4/11/12 by HVAC contractor

The well driller, builder or property owner will call the Health Department to schedule a time to meet in the field to verify the proposed well site location.

This sheet, along with two copies of an acceptable well site plan, must be attached to the green well permit application.

Revised 3/11/05