

LAYOUT _____ INSP 4 _____
 INSP 2 _____ INSP 5 _____
 INSP 3 _____ INSP 6 _____

ISSUE DATE: _____

PERMIT

P _____

APPROVAL DATE: _____

A 520775

TAX ID #04-355873

**ON-SITE SEWAGE DISPOSAL SYSTEM
 HOWARD COUNTY HEALTH DEPARTMENT
 BUREAU OF ENVIRONMENTAL HEALTH**

_____ IS PERMITTED TO INSTALL ALTER

ADDRESS: _____ PHONE NUMBER: _____

SUBDIVISION: Pleasant Prospect Farm LOT NUMBER: parcel 14&21

ADDRESS: 4389 Jennings Chapel Road Donald Reuwer

SEPTIC TANK CAPACITY (GALLONS): 1000 OUTLET BAFFLE FILTER REQUIRED

PUMP CHAMBER CAPACITY (GALLONS): n/a COMPARTMENTED TANK REQUIRED

NUMBER OF BEDROOMS: 1

SQUARE FEET PER BEDROOM: 180

LINEAR FEET OF TRENCH REQUIRED: 76 HOUSE SERVED BY PUBLIC WATER

TRENCHES:	Trench to be 3.0 feet wide. Inlet 4.0 feet below original grade. Bottom maximum depth 8.0 feet below original grade. Effective area begins at 4.0 feet below original grade. 4.0 feet of stone below distribution pipe.
LOCATION:	Place the distribution box at the highest location in the approved SDA.
NOTES:	<u>Be</u> sure to have SDA staked and cleanouts every 70'

PLANS APPROVED: Kevin Bell Reviewed by: _____ DATE: 7/7/05

NOTES: PERMIT VOID AFTER 2 YEARS
 CONTRACTOR IS RESPONSIBLE FOR SCHEDULING A PRE-CONSTRUCTION INSPECTION FOR ALL INSTALLATIONS
 WATERTIGHT SEPTIC TANKS REQUIRED
 ALL PARTS OF SEPTIC SYSTEM SHALL BE 100 FEET FROM ANY WATER WELL UNLESS SPECIFICALLY AUTHORIZED
 MANHOLE RISERS REQUIRED ON ALL SEPTIC TANKS AND PUMP CHAMBERS UNLESS SPECIFICALLY AUTHORIZED
 CONTRACTOR RESPONSIBLE FOR COMPLIANCE WITH APPLICABLE REGULATIONS, GUIDELINES AND THE TERMS OF THIS PERMIT

**NEITHER THE HOWARD COUNTY COUNCIL NOR THE HEALTH DEPARTMENT IS
 RESPONSIBLE FOR THE SUCCESSFUL OPERATION OF ANY SYSTEM
 PERMITTEE RESPONSIBLE FOR OBTAINING FINAL APPROVAL ON THIS PERMIT
 ALL 410-313-1771 FOR INSPECTION OF SEPTIC SYSTEM**

NOT TO SCALE

TRENCH/DRAINFIELD DATA

WIDTH _____ INLET _____ BOTTOM _____

NUMBER OF TRENCHES _____

TOTAL LENGTH _____

ABSORPTION AREA _____

DISTRIBUTION BOX LEVEL _____

DISTRIBUTION BOX BAFFLE _____

DISTRIBUTION BOX PORT _____

SEPTIC TANK DATA

SEPTIC TANK 1 LEVEL _____

CAPACITY _____ GAL

SEAM LOC _____

TANK LID DEPTH _____

BAFFLES _____

BAFFLE FILTER _____

MANHOLE LOC _____

6" PORT LOC _____

WATERTIGHT TEST _____

SEPTIC TANK 2 LEVEL _____

CAPACITY _____ GAL

SEAM LOC _____

TANK LID DEPTH _____

BAFFLES _____

BAFFLE FILTER _____

MANHOLE LOC _____

6" PORT LOC _____

WATERTIGHT TEST _____

ROAD

PRE-CONSTRUCTION _____

INSTALLATION _____

FINAL INSPECTOR _____ DATE OF APPROVAL _____

4389 Jennings Chapel Rd

NOT TO SCALE

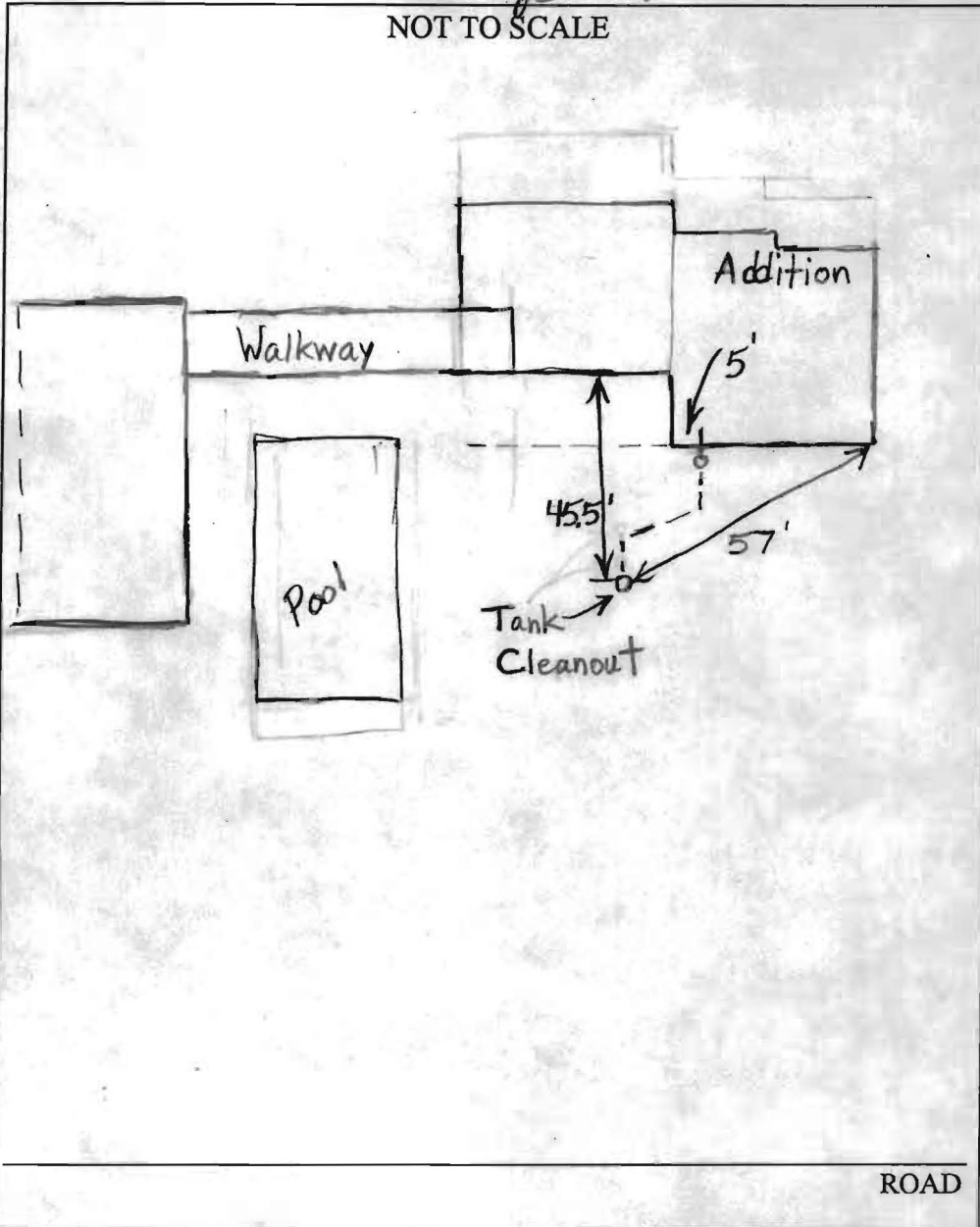

TRENCH/DRAINFIELD DATA

WIDTH	INLET	BOTTOM
_____	_____	_____
NUMBER OF TRENCHES _____		
TOTAL LENGTH _____		
ABSORPTION AREA _____		
DISTRIBUTION BOX LEVEL _____		
DISTRIBUTION BOX BAFFLE _____		
DISTRIBUTION BOX PORT _____		

SEPTIC TANK DATA

SEPTIC TANK 1 LEVEL _____

CAPACITY _____ GAL

SEAM LOC _____

TANK LID DEPTH _____

BAFFLES _____

BAFFLE FILTER _____

MANHOLE LOC _____

6" PORT LOC _____

WATERTIGHT TEST _____

SEPTIC TANK 2 LEVEL _____

CAPACITY _____ GAL

SEAM LOC _____

TANK LID DEPTH _____

BAFFLES _____

BAFFLE FILTER _____

MANHOLE LOC _____

6" PORT LOC _____

WATERTIGHT TEST _____

PRE-CONSTRUCTION _____

INSTALLATION _____

FINAL INSPECTOR _____ DATE OF APPROVAL _____

Howard County Health Department

Bureau of Environmental Health, Ellicott City, Maryland 410-313-2640

SEWAGE DISPOSAL PERMIT NO. A-520775 P-_____

PERMITTEE _____

LOCATION Pleasant Prospect Farm 4389 JENNINGS CHAPEL ROAD
DONALD REUWER

Do Not Cover Work Until Health Department Approval Appears On This Card

POST THIS CARD WHERE IT CAN BE SEEN FROM ROAD

STOP ALL CONSTRUCTION ON SEWAGE DISPOSAL SYSTEM AND CONTACT HEALTH DEPARTMENT BEFORE CONTINUING

WORK IS SATISFACTORY, CONTINUE

Inspector Date

Inspector Date

FINAL INSPECTION MADE, COVER ALL WORK

Inspector Date