

V388
10-10

PERMIT

SEWAGE DISPOSAL SYSTEM

DEPARTMENT OF HEALTH AND MENTAL HYGIENE

P 57352

A 57276A

DISTRICT 4th

HOWARD COUNTY HEALTH DEPARTMENT
BUREAU OF ENVIRONMENTAL HEALTH

INDEXED

DATE 10/23/96

~~461-9933~~ 313-2640

DATE SYSTEM APPROVED 1/6/97

INSPECTOR KM

Please confirm on Sept? is installed (PPV/PP) - YES - ~~SS~~
682-6926

Donald R. Reuwer, Jr. IS PERMITTED TO INSTALL ALTER

ADDRESS 10805 Hickory Ridge Road, Suite 215, Columbia, Maryland PHONE

SUBDIVISION _____ LOT Pool House ROAD 4349 Jennings Chapel Road

PROPERTY OWNER Donald R. Reuwer

ADDRESS _____

SEPTIC TANK CAPACITY 1000 GALLONS

NUMBER OF BEDROOMS _____

180 SQUARE FEET PER BEDROOM

LINEAR FEET OF TRENCH REQUIRED 180

TRENCHES - Trench to be 3 feet wide. Inlet 3.5 feet below original grade. Bottom maximum depth 5.5 feet below original grade. Effective area begins at 5.5 feet below original grade. 2 feet of stone below distribution pipe.

LOCATION - Place the distribution box at the perc hole #101. Run trenches along contour towards perc hole #107.

NOTES - No trench to exceed 100 feet in length. Provide 6" - 8" diameter cleanout and cap to grade or above on septic tank. OK K.M. 12/18/96

PLANS APPROVED BY Glen Savage DATE 12/16/96

COVER NO WORK UNTIL INSPECTED AND APPROVED

NEITHER THE HOWARD COUNTY COUNCIL NOR THE HEALTH DEPARTMENT IS RESPONSIBLE FOR THE SUCCESSFUL OPERATION OF ANY SYSTEM

NOTE: CLEANOUT REQUIRED EVERY 70 FEET OF SEWER LINE AND/OR AT 90° SWEEPS IN LINES FROM HOUSE TO DRAIN FIELDS, 90° ELBOWS NOT ACCEPTABLE.

NOTE: ALL PARTS OF SEPTIC SYSTEMS (I.E. TANK, DISTRIBUTION BOX TRENCHES) TO BE 100 FEET FROM WELL (UNLESS OTHERWISE SPECIFICALLY AUTHORIZED)

NOTE: IF DEEP TRENCH(ES) ARE USED CALL FOR INSPECTION BEFORE AND AFTER PLACING GRAVEL IN TRENCH(ES)

NOTE: NO DRY WELL SHALL EXCEED 15 FOOT IN DIAMETER NO ABSORPTION TRENCH TO EXCEED 100 FEET IN LENGTH

NOTE: ALL PIPE FROM HOUSE TO SEPTIC TANK MUST BE CAST IRON OR SCHEDULE 35/40 PVC OR ABS

PERMIT VOID AFTER TWO YEARS

NOTE: INSTALL STAND PIPE ON SEPTIC TANK AND DRY WELL STAND PIPES MUST BE 6 INCHES IN DIAMETER CAST IRON. CONCRETE OR TERRA COTTA OR PVA OR ABS ACCEPTED. IF TOP OF SEPTIC TANK IS DEEPER THAN 3 FEET. MANHOLE TO GRADE REQUIRED.

NOTE: DISTRIBUTION BOXES MUST HAVE BAFFLES

***INSTALLER IS RESPONSIBLE FOR OBTAINING FINAL APPROVAL ON THIS PERMIT**

57276A

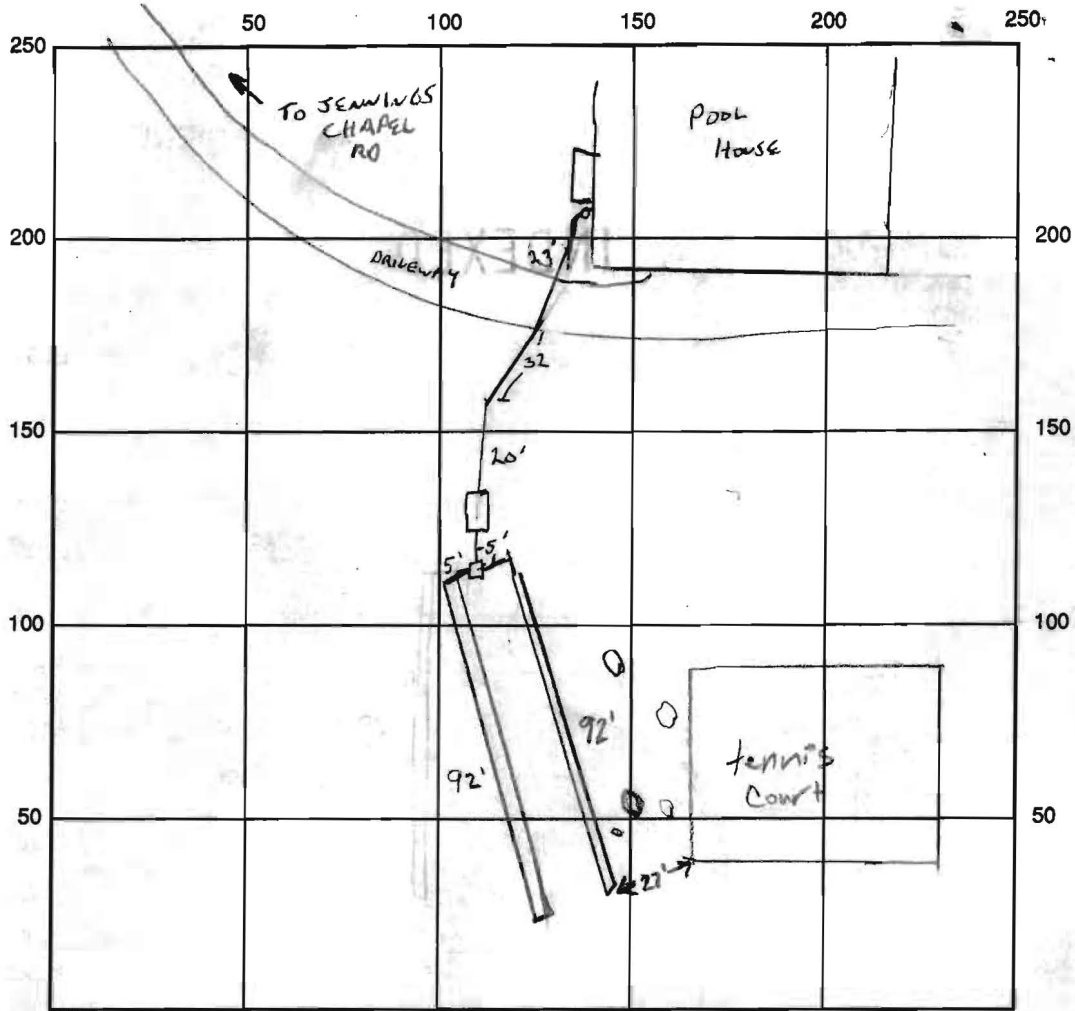

INDICATE NORTH - NAME ADJOINING ROADWAY AS BASE LINE

SEPTIC TANK LEVEL OK CLEANOUTS 1 AT BLOG, 1 ON TANK
 DISTRIBUTION BOX LEVEL OK - PRECAST W/ Baffle
 DRAIN FIELD/TITLE DEPTH 5.5 FT. TRENCH WIDTH 3 FT. INLET DEPTH 3.5 FT.
 EFFECTIVE GRAVEL DEPTH 2 FT. TOTAL LENGTH 2 x 92 FT. → 184
 NUMBER OF TRENCHES 2 ~~ONE SIDEWALL~~ BOTTOM AREA 552 SQ. FT.
 DRYWALL INSIDE DIAMETER — FT. EFFECTIVE DEPTH BELOW INLET — FT.
 ABSORBENT AREA — SQ. FT.

REMARKS: 1/3/97 50' COMPLETED IN 1ST TRENCH, OK TO COVER TO DIST. BOX. & COVER ALL EXCEPT ENDS OF 1ST TRENCH. &
1/6/97 OK to cover all work K.M.

DATE SYSTEM APPROVED 1/6/97 INSPECTOR Kimberly Maisto