

11/22/94  
ASAP

# PERMIT

## SEWAGE DISPOSAL SYSTEM

### DEPARTMENT OF HEALTH AND MENTAL HYGIENE

P 50407-A

A REPAIR

DISTRICT \_\_\_\_\_

DATE 11/22/94

DATE SYSTEM APPROVED 11/22/94

INSPECTOR DKS

#### HOWARD COUNTY HEALTH DEPARTMENT

BUREAU OF ENVIRONMENTAL HEALTH  
~~461-9933~~ 313-2640

INDEXED

Herman Sirk IS PERMITTED TO INSTALL \_\_\_\_\_ ALTER X

ADDRESS 2555 Jennings Chapel Road, Woodbine, Maryland 21797 PHONE 489-4724

SUBDIVISION \_\_\_\_\_ LOT \_\_\_\_\_ ROAD 2640 Jennings Chapel Road

PROPERTY OWNER Paul Shoffeitt

ADDRESS 2640 Jennings Chapel Road  
Woodbine, Maryland

**BUILDING PERMIT SIGNED  
AND RETURNED**  
925-03-800144251- ENCLOSED DEAR

SEPTIC TANK CAPACITY 1000 GALLONS

NUMBER OF BEDROOMS 3

\_\_\_\_\_ SQUARE FEET PER BEDROOM

LINEAR FEET OF TRENCH REQUIRED \_\_\_\_\_

REPAIR - PURPOSE - MOVE EXISTING SEPTIC TANK TO ACCOMMODATE BUILDING PERMIT (ADDITION)  
Call for inspection when tank is in place so sanitarian can approve the size and location. 11/16/94

septic tank replaced, existing septic tank to be pumped and removed.

New septic tank 14' from proposed addition. New line installed from house to s.t. to existing drywell.

PLANS APPROVED BY Jonna K. Goe DATE 11/22/94

COVER NO WORK UNTIL INSPECTED AND APPROVED

NEITHER THE HOWARD COUNTY COUNCIL NOR THE HEALTH DEPARTMENT IS RESPONSIBLE FOR THE SUCCESSFUL OPERATION OF ANY SYSTEM

NOTE: CLEANOUT REQUIRED EVERY 70 FEET OF SEWER LINE AND/OR AT 90° SWEEPS IN LINES FROM HOUSE TO DRAIN FIELDS, 90° ELBOWS NOT ACCEPTABLE.

NOTE: ALL PARTS OF SEPTIC SYSTEMS (I.E. TANK, DISTRIBUTION BOX TRENCHES) TO BE 100 FEET FROM WELL (UNLESS OTHERWISE SPECIFICALLY AUTHORIZED)

NOTE: IF DEEP TRENCH(ES) ARE USED CALL FOR INSPECTION BEFORE AND AFTER PLACING GRAVEL IN TRENCH(ES)

NOTE: NO DRY WELL SHALL EXCEED 15 FOOT IN DIAMETER NO ABSORPTION TRENCH TO EXCEED 100 FEET IN LENGTH

NOTE: ALL PIPE FROM HOUSE TO SEPTIC TANK MUST BE CAST IRON OR SCHEDULE 35/40 PVC OR ABS

PERMIT VOID AFTER TWO YEARS

NOTE: INSTALL STAND PIPE ON SEPTIC TANK AND DRY WELL STAND PIPES MUST BE 6 INCHES IN DIAMETER CAST IRON. CONCRETE OR TERRA COTTA OR PVA OR ABS ACCEPTED. IF TOP OF SEPTIC TANK IS DEEPER THAN 3 FEET. MANHOLE TO GRADE REQUIRED.

NOTE: DISTRIBUTION BOXES MUST HAVE BAFFLES

**\*INSTALLER IS RESPONSIBLE FOR OBTAINING FINAL APPROVAL ON THIS PERMIT**

**BLDG. PERMIT SIGNED  
AND RETURNED** 11/22/94  
Serial # 56413- Addition

P  
50407-A

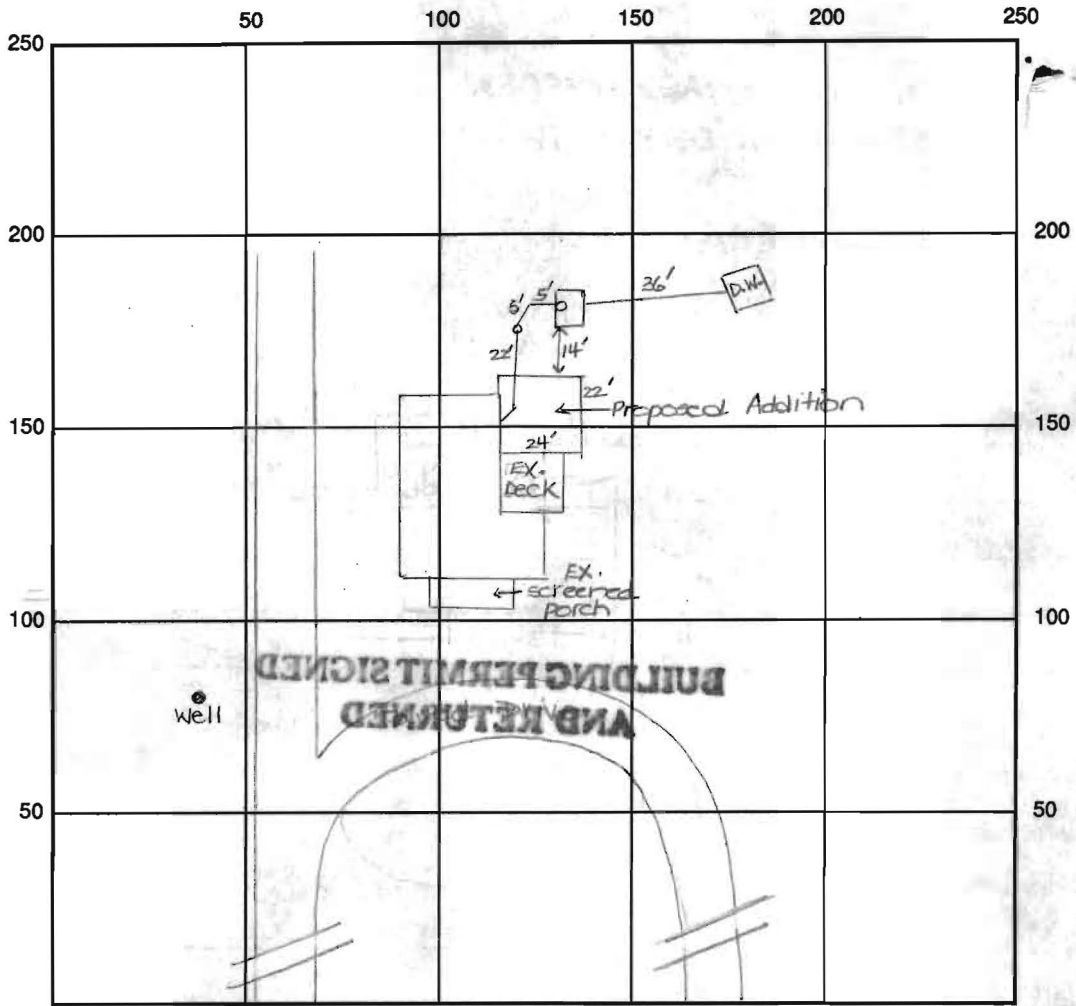

INDICATE NORTH - NAME ADJOINING ROADWAY AS BASE LINE

Jennings Chapel Road

SEPTIC TANK LEVEL OK-1000 gal CLEANOUTS one on s.t., one in line

DISTRIBUTION BOX LEVEL N/A

DRAIN FIELD/TITLE DEPTH Existing FT. TRENCH WIDTH — FT. INLET DEPTH — FT.

EFFECTIVE GRAVEL DEPTH — FT. TOTAL LENGTH — FT.

NUMBER OF TRENCHES — ONE SIDEWALL/BOTTOM AREA — SQ. FT.

DRYWALL INSIDE DIAMETER Existing FT. EFFECTIVE DEPTH BELOW INLET Existing FT.

ABSORBENT AREA Existing SQ. FT.

REMARKS: 11/22/94 A.M. Final- OK to cover all work. DKS

DATE SYSTEM APPROVED 11/22/94 INSPECTOR [Signature]

**Paul G. Shoffeitt**  
**2640 Jennings Chapel Road**  
**Woodbine, Maryland 21797**

Howard County Health Department  
Bureau of Environmental Health  
Private Well and Septic Program

August 16, 2005

I am writing to you regarding the recordation of lots on my farm (Chapel View Farm). The well for existing Lot Number 2, now Lot Number 3, on which my house now sits is placed at the edge of an easement. This easement is 50 feet wide. I would very much like to avoid having to drill another well and am writing to you to herein commit to assuring that my driveway (including all pavement) will be located so as to always be at least fifteen feet from this well.

Thank you for your consideration of this matter.

Sincerely,

A handwritten signature in black ink that reads "Paul G. Shoffeitt". The signature is written in a cursive style with a large, stylized initial "P".

Paul G. Shoffeitt