

# APPLICATION

SEWAGE DISPOSAL TESTING

A 1438  
P \_\_\_\_\_

MARYLAND STATE DEPARTMENT OF HEALTH

HOWARD COUNTY Septic tank to be 1000 gallon ELLICOTT CITY

will fill 400 sq ft of patten. Area. To be located DISTRICT 5  
between 30 ft and 85 ft from left fence line DATE 4/25/69  
and between 119 ft and 174 ft from Sheppard Lane  
on lot as seen standing on Sheppard Lane facing lot.

TO: THE COUNTY HEALTH OFFICER  
ELLICOTT CITY, MARYLAND

I, HEREBY, APPLY FOR THE NECESSARY TESTS IN ORDER TO CONSTRUCT (OR RECONSTRUCT) A SEWAGE DISPOSAL SYSTEM.

PROPERTY OWNER Bob Basler

ADDRESS Sheppard's Lane, Clarksville, Md. PHONE \_\_\_\_\_

PROPERTY LOCATION:

SUBDIVISION \_\_\_\_\_ LOT NO. \_\_\_\_\_

ROAD AND DESCRIPTION Sheppard's Lane - Holly Gutter Road - Sheppard's Lane  
2nd farm on right - former Hayland Farm - long lane paved  
E. E. Corner of farm on Sheppard's Lane

OCCUPANT \_\_\_\_\_ PHONE \_\_\_\_\_

PERSON TO CONSTRUCT SYSTEM \_\_\_\_\_

ADDRESS \_\_\_\_\_ PHONE \_\_\_\_\_

SIZE OF LOT 270 ACRES TYPE BLDG. 4

IF NOT SINGLE RESIDENCE DESCRIBE \_\_\_\_\_  
NUMBER OF SECTIONS  
(Single Fuly. Dwell.)

SIGNATURE OF APPLICANT Jack E. Boyd

APPROVED BY James T. Wright FOR TYPE FULL DATE 5/2/69

REJECTED BY \_\_\_\_\_ FOR \_\_\_\_\_ DATE \_\_\_\_\_

HOLD PENDING FURTHER TESTS \_\_\_\_\_ DATE \_\_\_\_\_

REASONS FOR REJECTION OR HOLDING \_\_\_\_\_

## THIS IS NOT A PERMIT

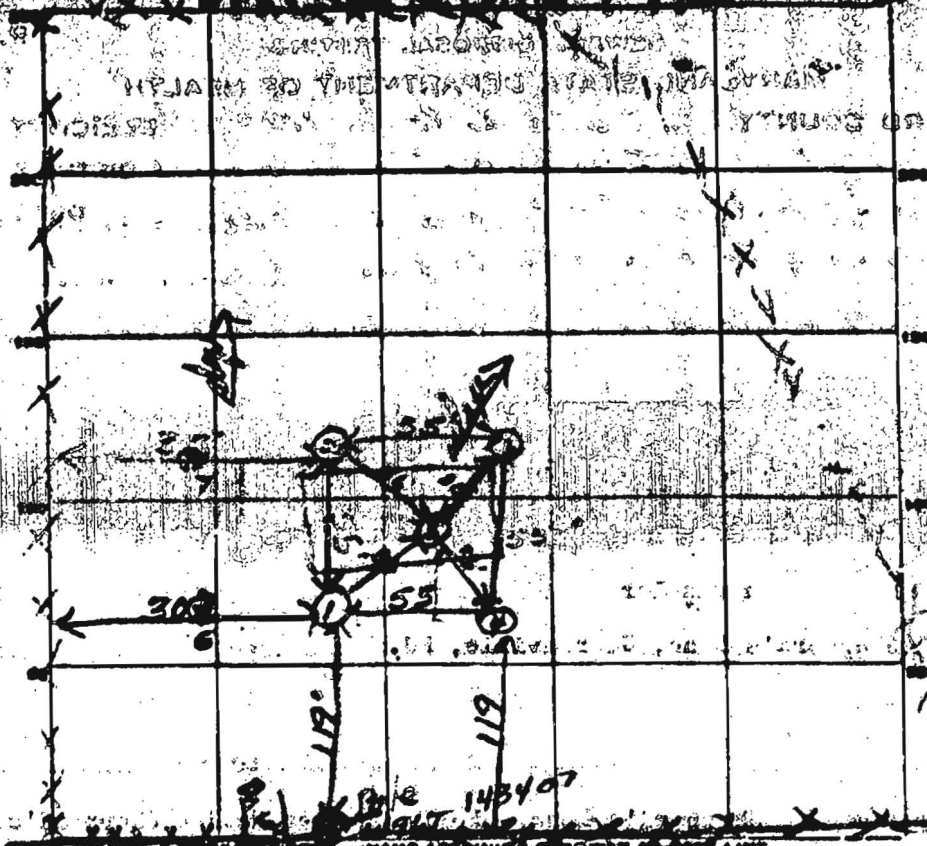

INDICATE POINTS - NAME ASSIGNING SURVEY AS-BE-ONE LINE.

STEP 1

DATE	TEST NO.	DEPTH	PRE-WET		TEST - 1" DROP		TIME
			START	STOP	START	STOP	
5/1/69	1	4'	9:28	9:47	9:40	9:45	3 min
	2	4'	9:46	9:56	9:56	10:13	17 min
	4	4'	10:15	10:16	10:16	10:17	1 min
	9	4'	10:18	10:20	10:20	10:22	2 min
	5	8	9:56	9:53	9:53	9:52	6 min
	6	4 1/2		1	2:28	2:31	3
	7	3 1/2		3		2:14	6

along 1/2 inch  
width 1/4 inch

SOIL AUGER FINDING \_\_\_\_\_  
 TESTED BY JW  
 REMARKS \_\_\_\_\_