

MARYLAND DEPARTMENT OF THE ENVIRONMENT, WATER MANAGEMENT ADMINISTRATION  
2500 BROENING HIGHWAY, BALTIMORE, MARYLAND 21224, (410) 631-3784

WATER WELL ABANDONMENT-SEALING REPORT FORM

SUBMIT COPIES OF COMPLETED FORM TO:

- \* COUNTY ENVIRONMENT AGENCY (contact MDE, WMA if address needed)
- \* WELL OWNER
- \* MDE, WATER MANAGEMENT ADMINISTRATION, WELL PROGRAM

DATE WELL ABANDONED: April 13, 2011 (month/day/year)

NO TAG not installed by EMI

\* PERMIT NUMBER OF ABANDONED WELL (if any)

\* PERMIT NUMBER OF REPLACEMENT WELL

\* PERSON ABANDONING WELL: Paul VanDoren

WELL DRILLERS LICENSE NUMBER: WRO - 062

\* OWNER'S NAME: First Evangelical Lutheran Church

CIRCLE: MWD/MSD/MGD

\* WELL LOCATION: Howard

SITE LOCATION MAP

COUNTY: \_\_\_\_\_  
NEAREST TOWN: Ellicott City  
TAX MAP 24 BLOCK 10 PARCEL 135  
SUBDIVISION: \_\_\_\_\_  
SECTION: \_\_\_\_\_ LOT: \_\_\_\_\_  
NEAREST ROAD: 3604 Chattam Road

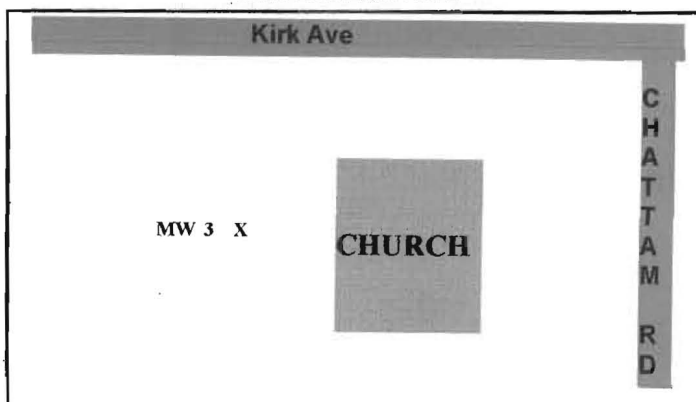

\* TYPE OF WELL BEING ABANDONED:

☒ DRILLED ☐ JETTED  
☐ BORED/AUGERED ☐ HAND DUG  
☐ OTHER (specify) \_\_\_\_\_

LOG OF SEALING MATERIAL

\* USE CODE:

☐ DOMESTIC ☐ MUNICIPAL/PUBLIC  
☐ IRRIGATION ☐ INDUSTRIAL  
☒ TEST/OBSERVATION ☐ GEOTHERMAL

MATERIAL	FEET	
	FROM	TO
ASPHALT	0'	1'
HYDRATED BENTONITE CHIPS	1'	51'
VOLUME OF MATERIAL USED		
BENTONITE 300 lbs 30 gal Water		

\* TYPE OF CASING:

☐ STEEL ☒ PLASTIC  
☐ CONCRETE ☐ OTHER (specify) \_\_\_\_\_

\* SIZE OF CASING: 4 INCHES IN DIAMETER

\* DEPTH OF WELL: 51' FEET DEEP

\* WAS ANY CASING REMOVED? ☒ YES ☐ NO  
if yes, length removed, in feet: 2'

\* WAS CASING RIPPED OR PERFORATED? ☒ YES ☐ NO

SIGNATURE-MASTER WELL DRILLER OR SUPERVISING SANITARIAN

047

LICENSE #

MWD/MSD/MGD April 27, 2011

CIRCLE ONE

DATE