

## Bureau of Environmental Health

8930 Stanford Boulevard, Columbia, MD 21045

Main: 410-313-2640 | Fax: 410-313-2648

TDD 410-313-2323 | Toll Free 1-866-313-6300

[www.hchealth.org](http://www.hchealth.org)

Facebook: [www.facebook.com/hocohealth](https://www.facebook.com/hocohealth)

Twitter: HowardCoHealthDep

**Maura J. Rossman, M.D., Health Officer**

June 4, 2015

Walter and Joyce Albaugh, owners  
12489 West Nuggett Court  
Highland, MD 20777

RE: Percolation Test Results for Highland Acres, Lot 13 (12489 West Nuggett Ct), A546300.

Dear Mr. and Mrs. Albaugh,

Percolation testing was conducted on April 24, 2015 on the referenced property. In all, six locations were tested for percolation rate and/or the soil profile descriptions were described. All six locations FAIL the evaluation as potential locations for disposal of wastewater.

Initially, two locations were excavated at stakes marked as 14 and 15 and set by the consulting engineer. I described soil materials applied as 'fill' at both locations. At location 14, the depth of fill was described to a depth of 35 inches and at location 15 the fill was described to a depth of 21 inches. Also, at location 14, saturated soil and water seeps occurred in the soil layer beginning at 62 inches, and at location 15 the saturated soil and water seeps occurred at 66 inches depth. As a septic system distribution pipe cannot be placed in 'fill' materials [Code of Maryland Annotated Regulations (COMAR), 26.04.02.05.T.], and a soil buffer of 4 feet (48 inches) is required above the observed water table [COMAR, 26.04.02.04.C(1)], both locations FAIL due to insufficient soil buffer.

In an attempt to locate suitable soils, four locations were excavated at progressively higher elevations than 14 and 15. The locations were designated as 141, 142, 143, and 144. At locations 141 and 142 the 'fill' was described to depths of 33 inches and 34 inches, and observed water table occurred at 66 inches and 60 inches, respectively. A soil buffer of 4 feet between the distribution pipe invert and the water table is not possible at either location.

At location 143, the 'fill' was described to 23 inches depth and the water table occurred at 84 inches. Testing was conducted at 34 inches depth, and the timed rate of infiltration exceeded 60 minutes. Location 143 is not suitable for a conventional subsurface septic system infiltration field. The area represented by 143 is not large enough to accommodate a system designed on non-conventional percolation rates.

At location 144, 'fill' was described to 42 inches depth, and the water table appeared to occur at 108 inches. A test hole was dug at 55 inches depth and during testing, the hole filled completely with water.

Neither Sand Mounds nor At-Grade Mounds may be considered for areas represented by the excavations described above as these types of septic systems cannot be approved on soil materials described as 'fill'.

Included as an attachment is a mark-up of the Percolation Test Plan on which the added locations are indicated. Areas represented by the locations described in this report, and areas at lower elevations than the locations observed are not suitable for disposal of wastewater

If you have questions related to this inquiry, you may reply to me via email,  
[rbricker@howardcountymd.gov](mailto:rbricker@howardcountymd.gov) , or call my desk, 410-313-2691.

Respectfully,

A handwritten signature in cursive script that reads "Robert Bricker".

Robert Bricker, CPSS, REHS/R.S.

Environmental Sanitarian II

Well and Septic Program, Bureau of Environmental Health

Howard County Health Department

8930 Stanford Boulevard

Columbia, MD 21045

Copy: Robert H. Vogel, PE  
File

LIAM G. RADHE SR  
ELLEN RADHE T/E  
GH LAND ACRES"  
LOT 19  
TM: 40  
PARCEL: 241  
L 3556 / F 279  
ZONED: RR-DEO

WEST NUGGET COURT  
LOCAL PUBLIC ROAD  
50' R/W

PETRILLO DRIVE  
LOCAL PUBLIC ROAD  
50' R/W

LOT 13  
44,070 SF

PROR. SEPTIC  
RESERVATION  
AREA 10,260 S.F.

ROBERT GONZALES  
STEPHANE GONZALES T/E  
"WATERMAN ESTATES"  
LOT 5 / PLT 7481  
TM: 40  
PARCEL: 250  
L 8653 / F 683  
ZONED: RR-DEO

X. PIT  
WELL ±

BUILDING  
W. NUGGET CT  
#2489

LDING

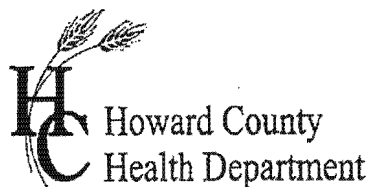

# APPLICATION

## FOR PERCOLATION TESTING AND SITE EVALUATION

TEST DATE(S) \_\_\_\_\_ TEST TIME \_\_\_\_\_ A/P \_\_\_\_\_

AGENCY REVIEW: \_\_\_\_\_ DATE \_\_\_\_\_

DO NOT WRITE ABOVE THIS LINE

I HEREBY APPLY FOR THE NECESSARY TESTING/EVALUATION PRIOR TO ISSUANCE OF SEWAGE DISPOSAL SYSTEM PERMIT(S) TO:

CHECK AS NEEDED:

- ☒ CONSTRUCT NEW SEPTIC SYSTEM(S)  
☐ REPAIR/ADD TO AN EXISTING SEPTIC SYSTEM  
☐ REPLACE AN EXISTING SEPTIC SYSTEM

CHECK AS NEEDED:

- ☒ NEW STRUCTURE(S)  
☐ ADDITION TO AN EXISTING STRUCTURE  
☐ REPLACE AN EXISTING STRUCTURE

CHECK ONE:

- ☐ CREATE NEW LOT(S)  
☒ BUILD ON AN EXISTING LOT IN A SUBDIVISION  
☐ BUILD ON AN EXISTING PARCEL OF RECORD

IS THE PROPERTY WITHIN 2500' OF ANY RESERVOIR?

- ☐ YES  
☒ NO

THE TYPE OF STRUCTURE IS:

- ☒ RESIDENTIAL WITH UNKNOWN PROPOSED BEDROOMS IN THE COMPLETED STRUCTURE (NOTE UNKNOWN IF APPROPRIATE)  
☐ COMMERCIAL (PROVIDE DETAIL OF NUMBERS AND TYPES OF EMPLOYEES/ CUSTOMERS ON ACCOMPANYING PLAN)  
☐ INSTITUTIONAL/GOVERNMENT (PROVIDE DETAIL OF NUMBERS AND TYPES OF EMPLOYEES/USERS ON ACCOMPANYING PLAN)

PROPERTY OWNER(S) WALTER AND JOYCE ALBAUGH

DAYTIME PHONE \_\_\_\_\_ CELL \_\_\_\_\_ FAX \_\_\_\_\_

MAILING ADDRESS 12489 W. NUGGET COURT, HIGHLAND, MD 20777  
STREET CITY/TOWN STATE ZIP

APPLICANT ROBERT. H. VOGL ENGINEERING, INC

DAYTIME PHONE 410-461-7600 CELL \_\_\_\_\_ FAX 410-461-8901

MAILING ADDRESS 8407 MAIN ST. ELLICOTT CITY MD 21043  
STREET CITY/TOWN STATE ZIP

APPLICANT'S ROLE: DEVELOPER BUILDER BUYER RELATIVE/FRIEND REALTOR CONSULTANT

PROPERTY LOCATION

SUBDIVISION/PROPERTY NAME HIGHLAND ACRES LOT NO. 13

PROPERTY ADDRESS 12485 NUGGET COURT, HIGHLAND 20777  
STREET TOWN/POST OFFICE

TAX MAP PAGE(S) 40 GRID 18 PARCEL(S) 241 PROPOSED LOT SIZE 44,070 SF

AS APPLICANT, I UNDERSTAND THE FOLLOWING: THE SYSTEM INSTALLED SUBSEQUENT TO THIS APPLICATION IS ACCEPTABLE ONLY UNTIL PUBLIC SEWERAGE IS AVAILABLE. THIS APPLICATION IS COMPLETE WHEN ALL APPLICABLE FEES AND A SUITABLE SITE PLAN HAVE BEEN RECEIVED. I ACCEPT THE RESPONSIBILITY FOR COMPLIANCE WITH ALL M.O.S.H.A. AND "MISS UTILITY" REQUIREMENTS. APPROVAL IS BASED UPON SATISFACTORY REVIEW OF A PERC CERTIFICATION PLAN. TEST RESULTS WILL BE MAILED TO APPLICANT.

SIGNATURE OF APPLICANT

HOWARD COUNTY HEALTH DEPARTMENT, BUREAU OF ENVIRONMENTAL HEALTH, WELL AND SEPTIC PROGRAM  
7178 COLUMBIA GATEWAY DRIVE COLUMBIA, MARYLAND 21046 (410) 313-2640 FAX (410) 313-2648  
TDD (410) 313-2323 TOLL FREE 1-877-4MD-DHMH



A/P \_\_\_\_\_

DATE	TEST #	DEPTH	START	BREAK 1" DROP	STOP 2" DROP	TIME OF 2ND INCH	P/F/H

REMARKS \_\_\_\_\_

SANITARIAN \_\_\_\_\_ BACKHOE \_\_\_\_\_ OTHERS \_\_\_\_\_

TEST HOLES USED IN SDA \_\_\_\_\_ AVG. PERC TIME \_\_\_\_\_ SQ. FT/BR \_\_\_\_\_

TRENCH WIDTH \_\_\_\_\_ INLET DEPTH \_\_\_\_\_ MAX. BOT DEPTH \_\_\_\_\_ EFFECTIVE S/W \_\_\_\_\_



west Nuggett Ct

Well

born fel

1fg, ss  
common mica  
many roots

brn sl, 1 fsk  
many mica  
flp (red L)  
90% channers  
oriented in  
various planes

Red-yellow  
± lt. grey scl  
Qm, few mic  
fzf (grey)

brn L & brns  
com. mice many  
1 f sbk mice  
few channers  
oriented in  
various planes

Red L SS  
Qm, few mica  
w/ gel-brn  
St, many mica  
Mtd (dk red-gr)

grey-brown L  
m, SS  
few mice  
m1p (dk red-br)  
m2p (blk)

grey cl	dm
"mp (red)	
water	

grey & red-ye  
clay, 0 m  
few fine.  
/BR mic  
S/W C24 (red

4" brn 2, 1 mg  
SS. common mica, many roots

24 8% channels, few roots

brn & red sl  
many mica  
relict thin platy  
few channels  
oriented in  
various planes

brn L, 14sbk  
few mica  
" few channers

Red L, 164k (30% brnL)

SS, few mica  
low zfs

few fine roots

born sl & red	DATE	TEST #	
---------------	------	--------	--

common mica	few micas	TEST #
Øm, SS	4/24/5	141
few channers		
oriented		
in various planes		

palabr L	4/11/11		
----------	---------	--	--

7mslok SS

few mic  
" m10/dk red-brown)

0.1	0.2	0.3	0.4	0.5	0.6	0.7	0.8	0.9	1.0
0.1	0.2	0.3	0.4	0.5	0.6	0.7	0.8	0.9	1.0

grey d, em			
(10/100)			

water seeds

water temp			
grey & red - vol			

REMARKS #141, F11

few fine mica  
SANITARIAN R. Brice

TEST HOLES USED IN SDA\_

TRENCH WIDTH

TRENCH WIDTH \_\_\_\_\_

North

Pettrillo Drive

知

DATE	TEST #	DEPTH	START	BREAK 1" DROP	STOP 2" DROP	TIME OF 2ND INCH	P/F/H
4/24/5	141	33" 66"	Visual		insufficient buffer		F
4/24/5	142	34" 60"	Visual		insufficient buffer		F

REMARKS #141, Fill to 33" ; #142, Fill to 34"

SANITARIAN R. Bricker BACKHOE Fogles OTHERS Walters

TEST HOLES USED IN SDA \_\_\_\_\_ AVG. PERC TIME \_\_\_\_\_

TRENCH WIDTH \_\_\_\_\_ INLET DEPTH \_\_\_\_\_ MAX. BOT DEPTH \_\_\_\_\_ EFFECTIVE \_\_\_\_\_

various places  
04" red L SS  
Øm, few mica  
w/yel-brn  
St, many mica  
Mtd (dk red-grey)  
4" grey-brn L  
Øm, SS  
few mica  
m 1 p (dk red-brn)  
4" m 2 p (blk)  
grey cl Øm  
" m 1 p (red)  
\* water  
grey & red-yel  
clay, Øm  
few mica  
SQ. 57/BR  
C24 (red)  
ECTIVE SWW



**Bricker, Robert**

---

**From:** Bricker, Robert  
**Sent:** Tuesday, November 25, 2014 11:03 AM  
**To:** 'Rob Vogel' (rvogel@vogeleng.com); Eric Salmi (esalmi@vogeleng.com)  
**Subject:** Albaugh Property proposal

Rob and Eric, Please be advised that I have received the perc proposal for the Albaugh Property, 12489 W Nugget Court. I do not have either a receipt for payment of perc fee or an Application form in my possession. The property may be tested only during a declared wet-season test period. I may consider scheduling only after receiving the completed Application form and evidence that the required fee is paid.

ROBERT BRICKER, REHS/R.S., L.E.H.S.  
ENVIRONMENTAL SANITARIAN II  
BUREAU OF ENVIRONMENTAL HEALTH, WELL AND SEPTIC PROGRAM  
8930 STANFORD BLVD., COLUMBIA, MD 21045

Phone: Desk, 410-313-2691; Program, 410-313-1771; Bureau, 410-313-1774  
Fax: 410-313-2648

E-mail: [rbricker@howardcountymd.gov](mailto:rbricker@howardcountymd.gov)

4/16, 9:55 a.m.

Received call from Mrs. Albaugh who instructs me to speak with "Kurt" at Fogle's (410-295-5670) to schedule a perc test next Wednesday or Friday.

4/16 10:16 a.m.

I call Fogle's, Kurt's not in the office, I am speaking with ~~Kurt~~ Megan (sp?). She confirms that she has spoken with Mrs Albaugh, but is expecting a phone call from her surveyor. I am able to confirm a Perc Test Date as next Wednesday (April 22) at 9-9:30 a.m.

4/16 10:31, Sent email notice of perc date confirmation to Rob Vogel.



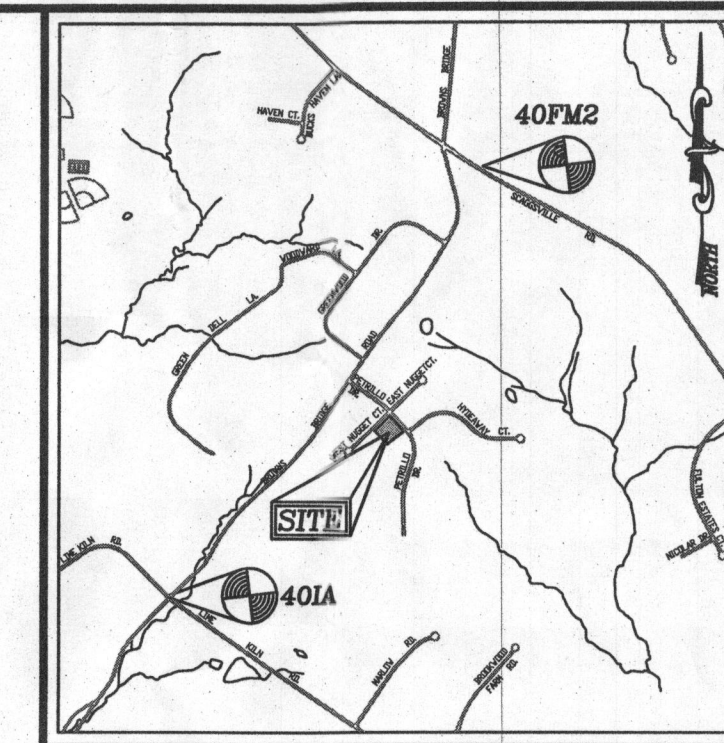

VICINITY MAP  
SCALE: 1"=2,000'  
AEC MAP COORDINATE: PAGE 5051, J5

#### GENERAL NOTES:

1. THE SUBJECT PROPERTY IS ZONED RR-DEO IN ACCORDANCE WITH 10/06/13 COMPREHENSIVE ZONING.
2. PROPERTY OUTLINE SHOWN HERE ON IS IN ACCORDANCE WITH DEED AND PLATS AND IS NOT BASED ON A FIELD RUN BOUNDARY SURVEY.
3. TOPOGRAPHY SHOWN HEREON IS OBTAINED FROM CURRENT HOWARD COUNTY GIS DATA.
4. SOIL TYPES SHOWN HEREON ARE IN ACCORDANCE WITH THE HOWARD COUNTY SOIL SURVEY.
5. THE PURPOSE OF THIS PERCOLATION CERTIFICATION PLAN IS TO CREATE AND DEFINE WELL AND SEPTIC RESERVE AREAS FOR SUBDIVISION IN ACCORDANCE WITH STATE AND COUNTY CODES.
6. THE LOT SHOWN HEREON COMPLY WITH THE MINIMUM OWNERSHIP WIDTH AND LOT AREA AS REQUIRED BY THE MARYLAND DEPARTMENT OF THE ENVIRONMENT.
7. ALL WELLS AND SEPTIC SYSTEMS WITHIN 100' FROM THE PROPERTY BOUNDARIES HAVE BEEN SHOWN.
8. ANY CHANGE TO A PRIVATE SEWERAGE EASEMENT SHALL REQUIRE A REVISED PERCOLATION CERTIFICATION PLAN.
9. EXISTING WELL AND SEPTIC LOCATIONS ARE BASED ON FIELD NOTES PROVIDED BY HOWARD COUNTY HEALTH DEPARTMENT.
10. THIS AREA DESIGNATES A MINIMUM 10,000 SQ FT PRIVATE SEWAGE EASEMENT REQUIRED BY THE MARYLAND STATE DEPARTMENT OF THE ENVIRONMENT FOR INDIVIDUAL SEWAGE DISPOSAL IMPROVEMENTS OF ANY NATURE IN THIS AREA ARE RESTRICTED UNTIL PUBLIC SEWAGE IS AVAILABLE. THESE EASEMENTS SHALL BE NULL AND VOID UPON CONNECTION TO A PUBLIC SYSTEM. THE COUNTY HEALTH OFFICER SHALL HAVE AUTHORITY TO GRANT ADJUSTMENTS TO THE PRIVATE SEWAGE EASEMENT. RECORDATION OF A MODIFIED SEWAGE EASEMENT SHALL NOT BE NECESSARY.

#### OWNER

WALTER AND JOYCE ANN ALBAUGH  
12489 W. NUGGETT COURT  
HIGHLAND, MARYLAND 20777

#### PERCOLATION TEST PLAT

ALBAUGH PROPERTY  
HIGHLAND ACRES - LOT 13  
PLAT BOOK 9 - PAGE 92

TAX MAP 40, BLOCK 18  
5TH ELECTION DISTRICT

PARCEL 241  
HOWARD COUNTY, MARYLAND

**ROBERT H. VOGEL**  
ENGINEERS • SURVEYORS • PLANNERS  
3407 MAIN STREET  
ELICOTT CITY, MD 21043  
TEL: 410.461.7666  
FAX: 410.461.8961



DESIGN BY: EDS/RVE  
DRAWN BY: RVE  
CHECKED BY: RHV  
DATE: SEPTEMBER 2014  
SCALE: AS SHOWN  
W.O. NO.: 14-30

PROFESSIONAL CERTIFICATE  
I HEREBY CERTIFY THAT THESE DOCUMENTS  
WERE PREPARED OR APPROVED BY ME, AND  
THAT I AM A DULY LICENSED PROFESSIONAL  
ENGINEER UNDER THE LAWS OF THE STATE  
OF MARYLAND, LICENSE NO. 16193  
EXPIRATION DATE 10-27-2018

1 SHEET  
OF 1

APPROVED: FOR PRIVATE WATER AND PRIVATE SEWAGE SYSTEMS

COUNTY HEALTH OFFICER \_\_\_\_\_ DATE \_\_\_\_\_

PERCOLATION CERTIFICATION:  
I CERTIFY THAT THE LOCATIONS SHOWN HEREON ARE BASED ON FIELD  
LOCATIONS DONE UNDER MY DIRECT SUPERVISION, AND ARE CORRECT,  
TO THE BEST OF MY PROFESSIONAL KNOWLEDGE AND BELIEF.

THOMAS M. HOFFMAN, JR.  
LAND SURVEYOR No. 267

10-8-14  
DATE

#### PLAN SCALE

SCALE: 1"=40'

#### MAPPED SOILS TYPES

SYMBOL	NAME / DESCRIPTION	GROUP	HYDRIC	HYDRIC INCLUSIONS	K-FACTOR	HYDROLOGIC	PERCENT	CIRCUIT SLOPE
GbA	GLADSTONE LOAM, 0 TO 3 PERCENT SLOPES	B	NO	NO	0.20	YES	NO	NO
GbB	GLADSTONE LOAM, 3 TO 8 PERCENT SLOPES	B	NO	NO	0.20	YES	NO	NO
GnB	GLENVILLE-BAILE SILT LOAMS, 0 TO 8 PERCENT SLOPES	C	PARTIALLY*	PARTIALLY*	0.37	NO	PARTIALLY*	PARTIALLY*
W	WATER	---	---	---	---	---	---	---

TAKEN FROM: USDA, SCS-WEB SOIL SURVEY, HOWARD COUNTY  
\*BAILE COMPONENT OF GnB, ERODIBILITY FACTOR IS 0.32 AND IS CONSIDERED HYDRIC



#### LEGEND

EXISTING CONTOUR	---
EXISTING TREES TO REMAIN	~
SOIL BOUNDARY	---
EXISTING WELL	W
PROPERTY LINE	---
PROP. WELL AREA	---
EXISTING SEPTIC EASEMENT	---
PROP. SEPTIC EASEMENT	---



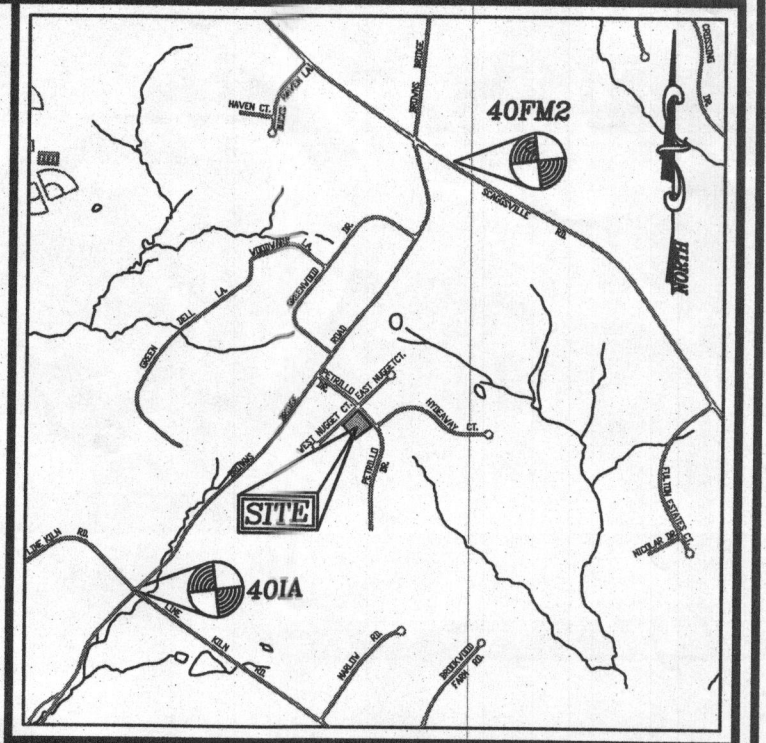

VICINITY MAP  
SCALE: 1"=2,000'  
ADC MAP COORDINATE: PAGE 5051, J5

#### GENERAL NOTES:

1. THE SUBJECT PROPERTY IS ZONED RR-DEO IN ACCORDANCE WITH 10/06/13 COMPREHENSIVE ZONING.
2. PROPERTY OUTLINE SHOWN HERE ON IS IN ACCORDANCE WITH DEED AND PLATS AND IS NOT BASED ON A FIELD RUN BOUNDARY SURVEY.
3. TOPOGRAPHY SHOWN HEREON IS OBTAINED FROM CURRENT HOWARD COUNTY GIS DATA.
4. SOIL TYPES SHOWN HEREON ARE IN ACCORDANCE WITH THE HOWARD COUNTY SOIL SURVEY.
5. THE PURPOSE OF THIS PERCOLATION CERTIFICATION PLAN IS TO CREATE AND DEFINE WELL AND SEPTIC RESERVE AREAS FOR SUBDIVISION IN ACCORDANCE WITH STATE AND COUNTY CODES.
6. THE LOT SHOWN HEREON COMPLY WITH THE MINIMUM OWNERSHIP WIDTH AND LOT AREA AS REQUIRED BY THE MARYLAND DEPARTMENT OF THE ENVIRONMENT.
7. ALL WELLS AND SEPTIC SYSTEMS WITHIN 100' FROM THE PROPERTY BOUNDARIES HAVE BEEN SHOWN.
8. ANY CHANGE TO A PRIVATE SEWERAGE EASEMENT SHALL REQUIRE A REVISED PERCOLATION CERTIFICATION PLAN.
9. EXISTING WELL AND SEPTIC LOCATIONS ARE BASED ON FIELD NOTES PROVIDED BY HOWARD COUNTY HEALTH DEPARTMENT.
10. THIS AREA DESIGNATES A MINIMUM 10,000 SQ FT PRIVATE SEWAGE EASEMENT REQUIRED BY THE MARYLAND STATE DEPARTMENT OF THE ENVIRONMENT FOR INDIVIDUAL SEWAGE DISPOSAL. IMPROVEMENTS OF ANY NATURE IN THIS AREA ARE RESTRICTED UNTIL PUBLIC SEWAGE IS AVAILABLE. THESE EASEMENTS SHALL BE NULL AND VOID UPON CONNECTION TO A PUBLIC SYSTEM. THE COUNTY HEALTH OFFICER SHALL HAVE AUTHORITY TO GRANT ADJUSTMENTS TO THE PRIVATE SEWAGE EASEMENT. RECORDATION OF A MODIFIED SEWAGE EASEMENT SHALL NOT BE NECESSARY.

#### OWNER

WALTER AND JOYCE ANN ALBAUGH  
12489 W. NUGGETT COURT  
HIGHLAND, MARYLAND 20777

#### PERCOLATION TEST PLAT

ALBAUGH PROPERTY  
HIGHLAND ACRES - LOT 13  
PLAT BOOK 9 - PAGE 92

TAX MAP 40, BLOCK 18  
5TH ELECTION DISTRICT

PARCEL 241  
HOWARD COUNTY, MARYLAND

**ROBERT H. VOGEL**  
**ENGINEERING, INC.**  
ENGINEERS • SURVEYORS • PLANNERS  
8407 MAIN STREET  
ELLICOTT CITY, MD 21043  
TEL: 410.461.7666  
FAX: 410.461.8961



DESIGN BY: EDS / RVE  
DRAWN BY: RVE  
CHECKED BY: RHV  
DATE: SEPTEMBER 2014  
SCALE: AS SHOWN  
W.O. NO.: 14-30

PROFESSIONAL CERTIFICATE  
I HEREBY CERTIFY THAT THESE DOCUMENTS  
WERE PREPARED OR APPROVED BY ME, AND  
THAT I AM A FULLY LICENSED PROFESSIONAL  
ENGINEER UNDER THE LAWS OF THE STATE  
OF MARYLAND, LICENSE NO. 16193  
EXPIRATION DATE: 09-27-2018

1 SHEET  
OF 1

APPROVED: FOR PRIVATE WATER AND PRIVATE SEWAGE SYSTEMS

COUNTY HEALTH OFFICER

DATE

#### PERCOLATION CERTIFICATION:

I CERTIFY THAT THE LOCATIONS SHOWN HEREON ARE BASED ON FIELD LOCATIONS DONE UNDER MY DIRECT SUPERVISION, AND ARE CORRECT, TO THE BEST OF MY PROFESSIONAL KNOWLEDGE AND BELIEF.

THOMAS M. HOFFMAN, JR.  
LAND SURVEYOR No. 267

10.8.14  
DATE

PLAN SCALE  
SCALE: 1"=40'

#### MAPPED SOILS TYPES

SYMBOL	NAME / DESCRIPTION	GROUP	HYDRIC	TOXIC INCLUSIONS	K-FACTOR	PERCENT FINE SAND	PERCENT SILT
GbA	GLADSTONE LOAM, 0 TO 3 PERCENT SLOPES	B	NO	NO	0.20	YES	NO
GbB	GLADSTONE LOAM, 3 TO 8 PERCENT SLOPES	B	NO	NO	0.20	YES	NO
GbC	GLENVILLE-BAILE SILT LOAMS, 0 TO 8 PERCENT SLOPES	C	PARTIALLY*	PARTIALLY*	0.37	NO	PARTIALLY*
W	WATER						

TAKEN FROM: USDA, SCS-WEB SOIL SURVEY, HOWARD COUNTY  
\*BAILE COMPONENT OF GbB, ERODIBILITY FACTOR IS 0.32 AND IS CONSIDERED HYDRIC

#### LEGEND

EXISTING CONTOUR	-----	PERC TEST LOCATIONS	+
EXISTING TREES TO REMAIN	~~~~~	PROP. WELL	W
SOIL BOUNDARY	-----		
EXISTING WELL	W		
PROPERTY LINE	-----		
PROP. WELL AREA	~~~~~		
EXISTING SEPTIC EASEMENT	~~~~~		
PROP. SEPTIC EASEMENT	~~~~~		