

C1 46734		SEQUENCE NO. (MDE USE ONLY)		STATE OF MARYLAND WELL COMPLETION REPORT FILL IN THIS FORM COMPLETELY PLEASE TYPE		THIS REPORT MUST BE SUBMITTED WITHIN 45 DAYS AFTER WELL IS COMPLETED.	
1 2 3 6 (THIS NUMBER IS TO BE PUNCHED IN COLS. 3-6 ON ALL CARDS)						COUNTY NUMBER	
ST/CO USE ONLY DATE Received MM 08 24 100		DATE WELL COMPLETED MM 08 DD 18 YY 2016		Depth of Well 22 300 26 (TO NEAREST FOOT)		PERMIT NO. FROM "PERMIT TO DRILL WELL" OK 8/26/16 SC Ho - 15 - 0287	
OWNER <u>Harris</u>		last name <u>17529 Timber Leigh Way</u>		first name <u>Charles S Jaret</u>		TOWN <u>Woodbine</u>	
WELL SITE ADDRESS		SUBDIVISION <u>Timberleigh Ridge</u>		SECTION		LOT <u>7</u>	

WELL LOG Not required for driven wells			GROUTING RECORD WELL HAS BEEN GROUTED (Circle Appropriate Box) Y N 44 44			C3 1 2		
STATE THE KIND OF FORMATIONS PENETRATED, THEIR COLOR, DEPTH, THICKNESS AND IF WATER BEARING			TYPE OF GROUTING MATERIAL (Circle one) CEMENT CM BENTONITE CLAY BC			PUMPING TEST		
DESCRIPTION (Use additional sheets if needed)			NO. OF BAGS <u>15</u> NO. OF POUNDS <u>225</u>			HOURS PUMPED (nearest hour) <u>8</u> <u>9</u>		
FEET FROM TO check if water bearing			GALLONS OF WATER <u>285</u>			PUMPING RATE (gal. per min.) <u>11</u> <u>15</u>		
Top Soil 0 2 Sandy Silt 2 38 grey schist 38 300 ✓			DEPTH OF GROUT SEAL (to nearest foot) from <u>0</u> TOP 52 ft. to <u>300</u> 58 BOTTOM 58 ft. (enter 0 if from surface)			METHOD USED TO MEASURE PUMPING RATE		
			CASING RECORD casing types insert appropriate code below ST CO STEEL CONCRETE PL OT PLASTIC OTHER			WATER LEVEL (distance from land surface)		
			MAIN CASING TYPE Nominal diameter top (main) casing (nearest inch)! Total depth of main casing (nearest foot) <u>P1</u> <u>6</u> <u>40</u> 60 61 63 64 66 70			BEFORE PUMPING <u>17</u> <u>20</u> ft. WHEN PUMPING <u>22</u> <u>25</u> ft.		
			OTHER CASING (if used) diameter depth (feet) inch from to			TYPE OF PUMP USED (for test) A air P piston T turbine 27 27 27 C centrifugal R rotary O other (describe below) 27 27 27 J jet S submersible 27 27		
			SCREEN RECORD screen type or open hole (insert appropriate code below) ST BR HO STEEL BRASS OPEN HOLE PL OT PLASTIC OTHER			PUMP INSTALLED DRILLER INSTALLED PUMP YES NO (CIRCLE) (YES or NO)		
NUMBER OF UNSUCCESSFUL WELLS: <u>0</u>			C2 DEPTH (nearest ft.) 1 2 <u>110</u> <u>38</u> <u>300</u> 8 9 11 15 17 21			IF DRILLER INSTALLS PUMP, THIS SECTION MUST BE COMPLETED FOR ALL WELLS.		
WELL HYDROFRACTURED Y N			2 3 4 5 6 7 8 9 10 11 12 13 14 15 16 17 18 19 20 21 22 23 24 25 26 27 28 29 30 31 32 33 34 35 36 37 38 39 40 41 42 43 44 45 46 47 48 49 50 51 52 53 54 55 56 57 58 59 60 61 62 63 64 65 66 67 68 69 70 71 72 73 74 75 76 77 78 79 80 81 82 83 84 85 86 87 88 89 90 91 92 93 94 95 96 97 98 99 100			TYPE OF PUMP INSTALLED PLACE (A,C,J,P,R,S,T,O) IN BOX 29. <u>29</u>		
CIRCLE APPROPRIATE LETTER A A WELL WAS ABANDONED AND SEALED WHEN THIS WELL WAS COMPLETED E ELECTRIC LOG OBTAINED P TEST WELL CONVERTED TO PRODUCTION WELL			SLOT SIZE 1 2 3 DIAMETER OF SCREEN (NEAREST INCH) 56 60 from to			CAPACITY: GALLONS PER MINUTE (to nearest gallon) <u>31</u> <u>35</u>		
I HEREBY CERTIFY THAT THIS WELL HAS BEEN CONSTRUCTED IN ACCORDANCE WITH COMAR 26.04.04 "WELL CONSTRUCTION" AND IN CONFORMANCE WITH ALL CONDITIONS STATED IN THE ABOVE CAPTIONED PERMIT, AND THAT THE INFORMATION PRESENTED HEREIN IS ACCURATE AND COMPLETE TO THE BEST OF MY KNOWLEDGE.			GRAVEL PACK IF WELL DRILLED WAS FLOWING WELL INSERT F IN BOX 68 <u>68</u>			PUMP HORSE POWER <u>37</u> <u>41</u>		
DRILLERS LIC. NO.1 <u>MWD 572</u> <u>Samuel A. Connelly</u> DRILLERS SIGNATURE (MUST MATCH SIGNATURE ON APPLICATION)			MDE USE ONLY (NOT TO BE FILLED IN BY DRILLER) T (E.R.O.S.) W Q			PUMP COLUMN LENGTH (nearest ft.) <u>43</u> <u>47</u>		
LIC. NO.1 <u>WR 064</u>			TELESCOPE CASING LOG INDICATOR OTHER DATA			CASING HEIGHT (circle appropriate box and enter casing height) + above } LAND SURFACE - below } <u>2</u> (nearest foot) 49 50 51		
SITE SUPERVISOR (sign. of driller or journeyman responsible for sitework if different from permittee)						LATITUDE <u>39.300785</u> LONGITUDE <u>72.125611</u> (DEFAULT COORD. WGS 84)		

Pursuant to §10-624 of the State Govt. Article of the Maryland Code personal info. requested on this form is used in processing this form pursuant to COMAR 26.04.04. Failure to provide the info. may result in this form not being processed. You have the right to inspect, amend, or correct this form. The Maryland Department of the Environment is subject to the Maryland Public Information Act. This form may be made available on the Internet via MDE's website and is subject to inspection or copying, in whole or in part, by the public and other governmental agencies, if not protected by federal or state law.

MDE/WMA/PER.071

B 1	SEQUENCE NO. (MDE USE ONLY) <div style="font-size: 2em; font-weight: bold;">46384</div>	STATE OF MARYLAND APPLICATION FOR PERMIT TO DRILL WELL please type <div style="font-size: 1.5em;">558809</div>	STATE PERMIT NUMBER <div style="font-size: 1.5em;">HO - 15 - 0287</div> fill in this form completely
Date Received (APA) <div style="font-size: 1.5em;">08/29/16</div>		B 3 LOCATION OF WELL <div style="font-size: 1.5em;">Howard</div> <div style="font-size: 1.5em;">Timberleigh Ridge</div> <div style="font-size: 1.5em;">Woodbine</div>	
OWNER INFORMATION <div style="font-size: 1.5em;">Harris Charles + Janet</div> <div style="font-size: 1.5em;">17529 Timberleigh Way</div> <div style="font-size: 1.5em;">Woodbine MD 21797</div>		COUNTY 21 SUBDIVISION 42 SECTION 44 46 LOT 48 50 NEAREST TOWN 71	
DRILLER INFORMATION <div style="font-size: 1.5em;">Samuel A. Connelly</div> <div style="font-size: 1.5em;">Connelly + Associates, Inc.</div> <div style="font-size: 1.5em;">260 Interstate Ct. Frederick, MD 21704</div> <div style="font-size: 1.5em;">Samuel A. Connelly</div> <div style="font-size: 1.5em;">7/29/16</div>		B 4 SOURCES OF DRILLING WATER 1. private 2. 3. <div style="font-size: 1.5em;">17529 Timberleigh Way</div> <div style="font-size: 1.5em;">500+</div> <div style="font-size: 1.5em;">13</div> <div style="font-size: 1.5em;">13</div> <div style="font-size: 1.5em;">319</div>	
B 2 WELL INFORMATION APPROX. PUMPING RATE (GAL. PER MIN.) 8 12 AVERAGE DAILY QUANTITY NEEDED (GAL. PER DAY) 14 20		ON WHICH SIDE OF ROAD (CIRCLE APPROPRIATE BOX) NORTH WEST EAST SOUTH DISTANCE FROM ROAD ENTER FT OR MI 38 39	
USE FOR WATER (CIRCLE APPROPRIATE BOX) <input type="checkbox"/> DOMESTIC POTABLE SUPPLY & RESIDENTIAL IRRIGATION <input type="checkbox"/> FARMING (LIVESTOCK WATERING & AGRICULTURAL IRRIGATION) <input checked="" type="checkbox"/> INDUSTRIAL, COMMERCIAL, DEWATERING <input type="checkbox"/> PUBLIC WATER SUPPLY WELL <input type="checkbox"/> TEST, OBSERVATION, MONITORING <input type="checkbox"/> OPEN LOOP GEOTHERMAL <input checked="" type="checkbox"/> CLOSED LOOP GEOTHERMAL		NOT TO BE FILLED IN BY DRILLER HEALTH DEPARTMENT APPROVAL <div style="font-size: 1.5em;">Howard</div> <div style="font-size: 1.5em;">13</div> <div style="font-size: 1.5em;">8/1/16</div> <div style="font-size: 1.5em;">S. L. C. H.</div> <div style="font-size: 1.5em;">8/1/17</div>	
APPROXIMATE DEPTH OF WELL <div style="font-size: 1.5em;">300</div> FEET APPROXIMATE DIAMETER OF WELL <div style="font-size: 1.5em;">6</div> INCH		PROPOSED LOCATION OF WELL ON LOT SHOW PERMANENT STRUCTURES SUCH AS BUILDINGS, SEPTIC SYSTEM, ROADS AND/OR LANDMARKS AND INDICATE NOT LESS THAN TWO DISTANCE MEASUREMENTS TO WELL 	
METHOD OF DRILLING (circle one) BORED (or Augered) JETTED Jetted & DRIVEN AIR-ROTARY AIR-PERCussion ROTARY (Hydraulic Rotary) CABLE REVERSE-ROTARY Drive-POINT other		REPLACEMENT OR DEEPENED WELLS (CIRCLE APPROPRIATE BOX) <input checked="" type="checkbox"/> THIS WELL WILL NOT REPLACE AN EXISTING WELL <input type="checkbox"/> THIS WELL WILL REPLACE A WELL THAT WILL BE ABANDONED AND SEALED <input type="checkbox"/> THIS WELL WILL REPLACE A WELL THAT WILL BE USED AS A STANDBY-CONTACT LOCAL APPROVING AUTHORITY FOR POLICY ON STANDBY WELLS <input type="checkbox"/> THIS WELL WILL DEEPEEN AN EXISTING WELL PERMIT NUMBER OF WELL TO BE REPLACED OR DEEPEENED (IF AVAILABLE) 41 52	
Not to be filled in by driller (MDE OR COUNTY USE ONLY) APPROP. PERMIT NUMBER <div style="font-size: 1.5em;">G</div> PERMIT No. <div style="font-size: 1.5em;">HO - 15 - 0287</div>			
SPECIAL CONDITIONS NOTE APPROVING AUTHORITIES SHOULD USE SEPARATE SHEET IF NEEDED			

DO NOT REMOVE THIS TAG
DEPARTMENT OF THE ENVIRONMENT
WELL PERMIT NUMBER

H0-15-0287

INFORMATION-GIVE NUMBER AND WRITE
1800 WASHINGTON BLVD
BALTIMORE MARYLAND. 21230

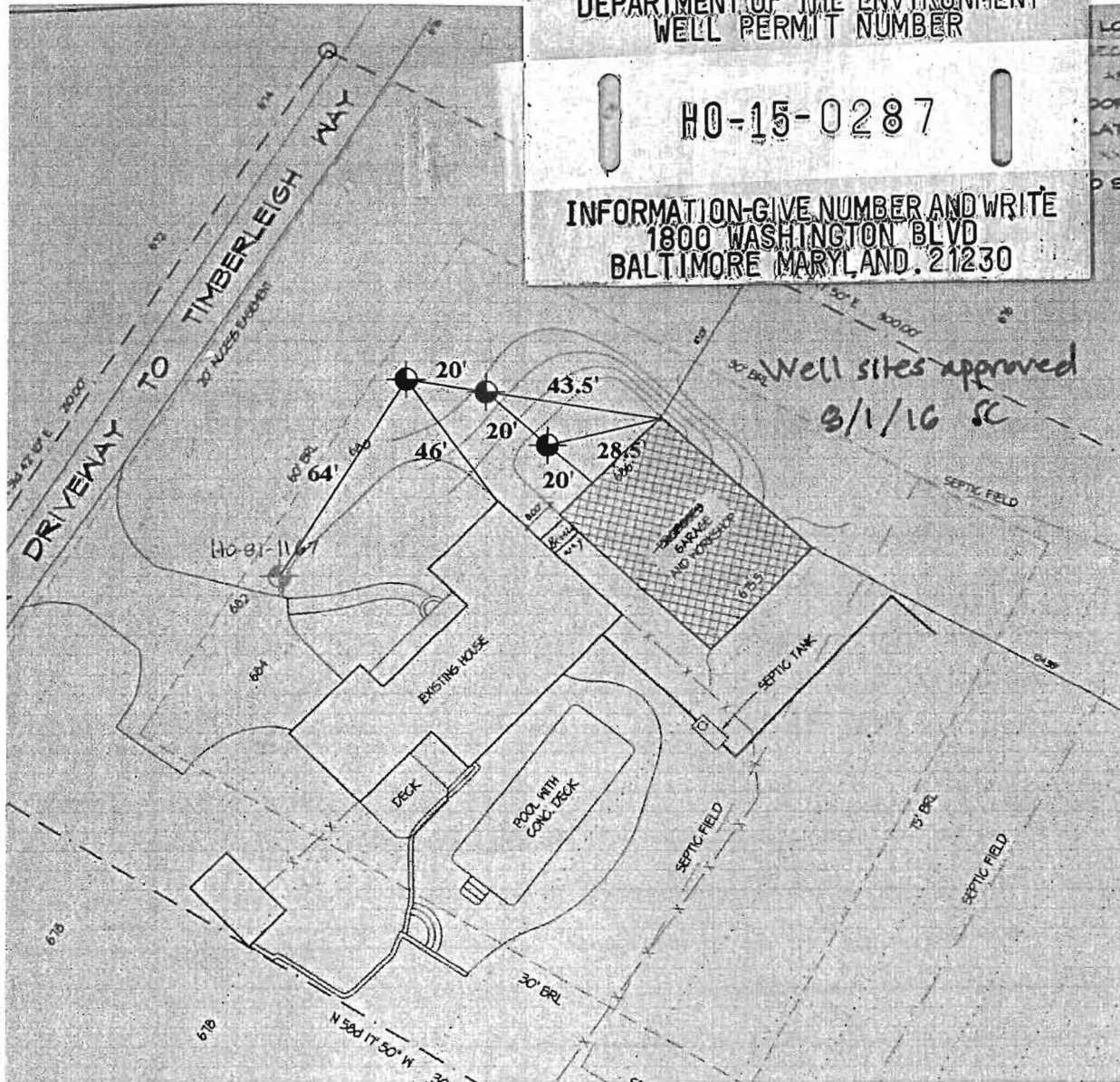

L E G E N D

- PROPOSED GEOTHERMAL WELL LOCATION
- APPROXIMATE DOMESTIC WELL LOCATION (H0-91-1167)

GRAPHICAL SCALE

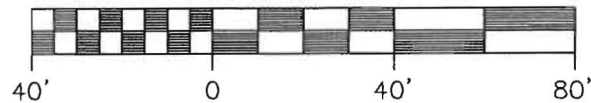

Connelly GeoThermal
Partnering with Mother Earth

260 Interstate Court (301) 696-8820
Frederick, Maryland 21704 (301) 696-0327 fax

HARRIS RESIDENCE
17529 TIMBERLEIGH WAY, WOODBINE, MARYLAND

PROPOSED GEOTHERMAL WELL
LOCATION PLAN

Scale:
AS SHOWN

Fig.

Date:
JULY 2016

Drawn By:
J.A.

Checked By:
E.S.

Project No.:
121028

1

Geothermal Closed Loop / Address:

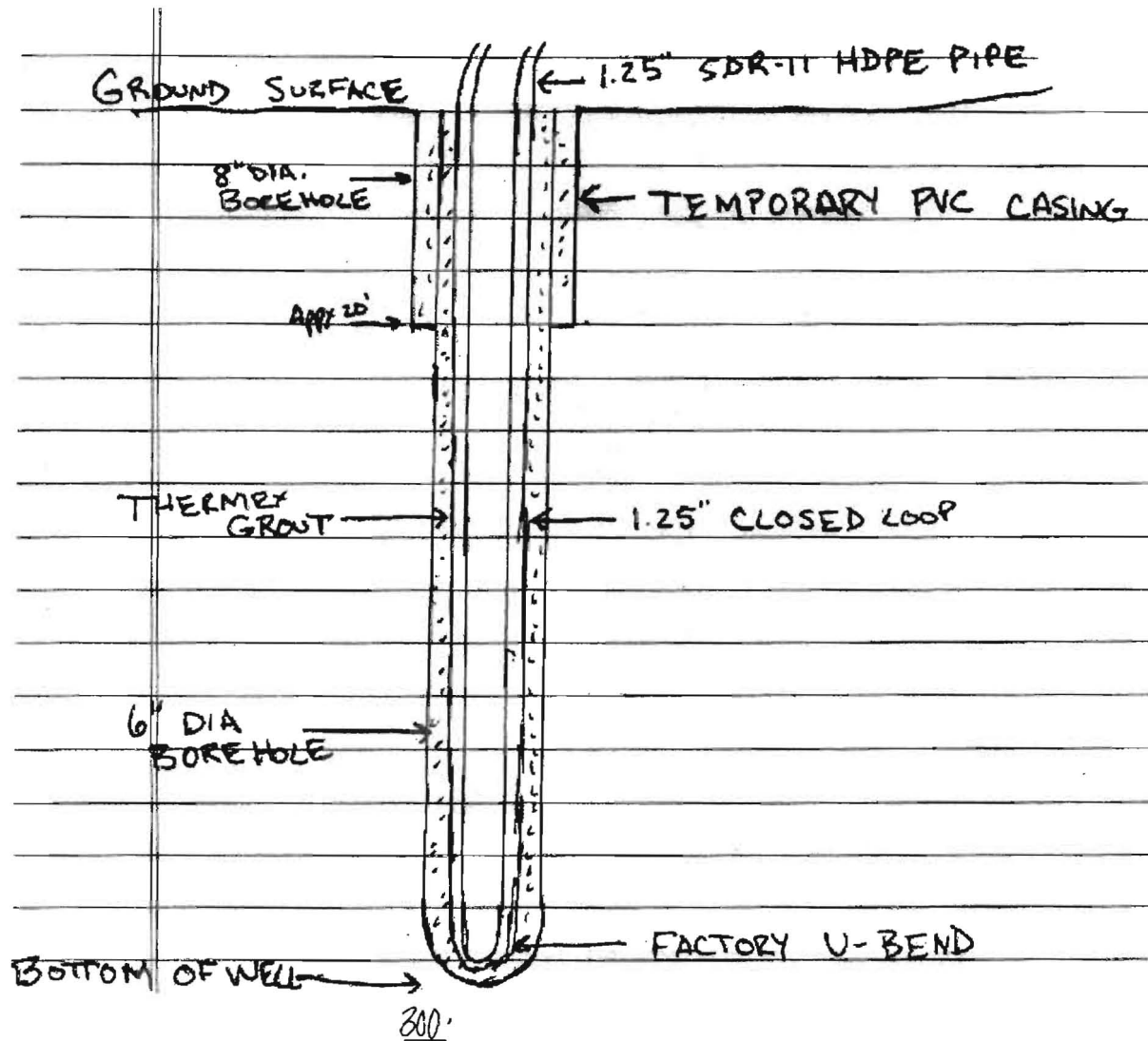

Grout information for this property is as follows:

Thermex grout mixture of 50 lb. grout to 19 gallons water, placed in the well using the tremie method, from bottom to top.

FILE INQUIRY NOTES

[illegible]