

Bureau of Environmental Health
8930 Stanford Boulevard, Columbia, MD 21045
Main: 410-313-2640 | Fax: 410-313-2648
TDD 410-313-2323 | Toll Free 1-866-313-6300
www.hchealth.org
Facebook: www.facebook.com/hocohealth

Maura J. Rossman, M.D., Health Officer

RECEIPT DATE: 1/17/18

ONSITE SEWAGE DISPOSAL SYSTEM

P 562401

APPROVAL DATE: 02/05/18

PERMIT:

REPAIR

A

PROPERTY ADDRESS: 15760 Union Chapel Road

SUBDIVISION:

LOT:

TAX ID: 04-310160

CONTRACTOR: Hatfield's Equipment

EMAIL: ken@hatfieldsequipment.com

CONTRACTOR ADDRESS: P.O. Box 519 Annapolis Junction, Maryland 20701

PHONE: 301-490-4289

PROPERTY OWNER: Robert Botterill

EMAIL:

OWNER ADDRESS: 15760 Union Chapel Road, Woodbine, MD 21797

PHONE:

SEPTIC TANK SIZE (GALLONS): 1500

PUMP CHAMBER CAPACITY (GALLONS):

PUMP SIZE:

NUMBER OF BEDROOMS: 4

HOUSE SQ. FT.

APPLICATION RATE: 0.8

DISTRIBUTION SYSTEM: GRAVITY FED ☒

LOW PRESSURE DOSED ☐

TRENCHES:	LINEAR FEET REQUIRED: <u>124'</u>	INLET DEPTH: <u>4'</u>
	TRENCH WIDTH: <u>2'</u>	MAXIMUM BOTTOM DEPTH: <u>10'</u>
	MINIMUM SPACE BETWEEN TRENCHES: <u>10'</u>	EFFECTIVE AREA BEGINNING DEPTH: <u>5.5'</u>
LOCATION:	TO BE STAKED BY SANITARIAN DURING PRE-CONSTRUCTION INSPECTION.	
NOTES:	Install 3-42' trenches. Existing tank must be pumped + abandoned.	

ISSUED BY: Sarah Collins

ISSUE DATE: 2/1/18

EXPIRATION DATE: 2/1/19

NOTE: CONTRACTOR MUST SCHEDULE A PRE-CONSTRUCTION INSPECTION PRIOR TO BEGINNING ANY INSTALLATION

NOTE: CONTRACTOR MUST SCHEDULE AN INSPECTION AND GAIN APPROVAL OF ALL COMPONENTS PRIOR TO COVERING

NOTE: STONE MUST BE APPROVED BY HEALTH DEPARTMENT AND GRAVEL TICKET MUST BE AVAILABLE FOR REVIEW.

NOTE: WATERTIGHT SEPTIC TANKS REQUIRED

NOTE: ALL PARTS OF SEPTIC SYSTEM SHALL BE AT LEAST 100 FEET DOWNGRADIENT FROM ANY WATER WELL

NOTE: MANHOLE RISERS REQUIRED ON ALL SEPTIC TANKS AND PUMP CHAMBERS

NOTE: AN ELECTRICAL PERMIT IS REQUIRED FOR INSTALLATION OF ANY ELECTRICAL COMPONENTS OF THE SYSTEM

☐ ELECTRICAL PERMIT ISSUED E

NOTE: THE HCHD DOES NOT WARRANTY ANY SYSTEM AND CANNOT GUARANTEE THE PERFORMANCE OF THIS SYSTEM AS DESIGNED. BY ACCEPTING THIS PERMIT, THE OWNER AND/OR APPLICANT ACKNOWLEDGE THAT THE SPECIFICATIONS DETAILED IN THIS DESIGN ARE ONE POSSIBLE OPTION AND THAT THE HCHD WILL REVIEW OTHER PROPOSALS. YOU HAVE THE OPTION TO SEEK THE ADVICE OF A QUALIFIED DESIGN CONSULTANT OR PROFESSIONAL ENGINEER FOR FURTHER GUIDANCE.

NOTE: MDE RECOMMENDS SEPTIC TANKS, BAT, AND OTHER PRETREATMENT UNITS BE PUMPED AT A FREQUENCY ADEQUATE TO ENSURE THAT SOLIDS ARE NOT DISCHARGED TO THE DISPOSAL AREA

NEITHER THE HOWARD COUNTY COUNCIL NOR THE HEALTH DEPARTMENT IS RESPONSIBLE FOR THE SUCCESSFUL OPERATION OF ANY SYSTEM.

PERMITTEE RESPONSIBLE FOR OBTAINING FINAL APPROVAL ON THIS PERMIT.

CALL 410-313-1771 TO SCHEDULE INSPECTIONS.

NOT TO SCALE

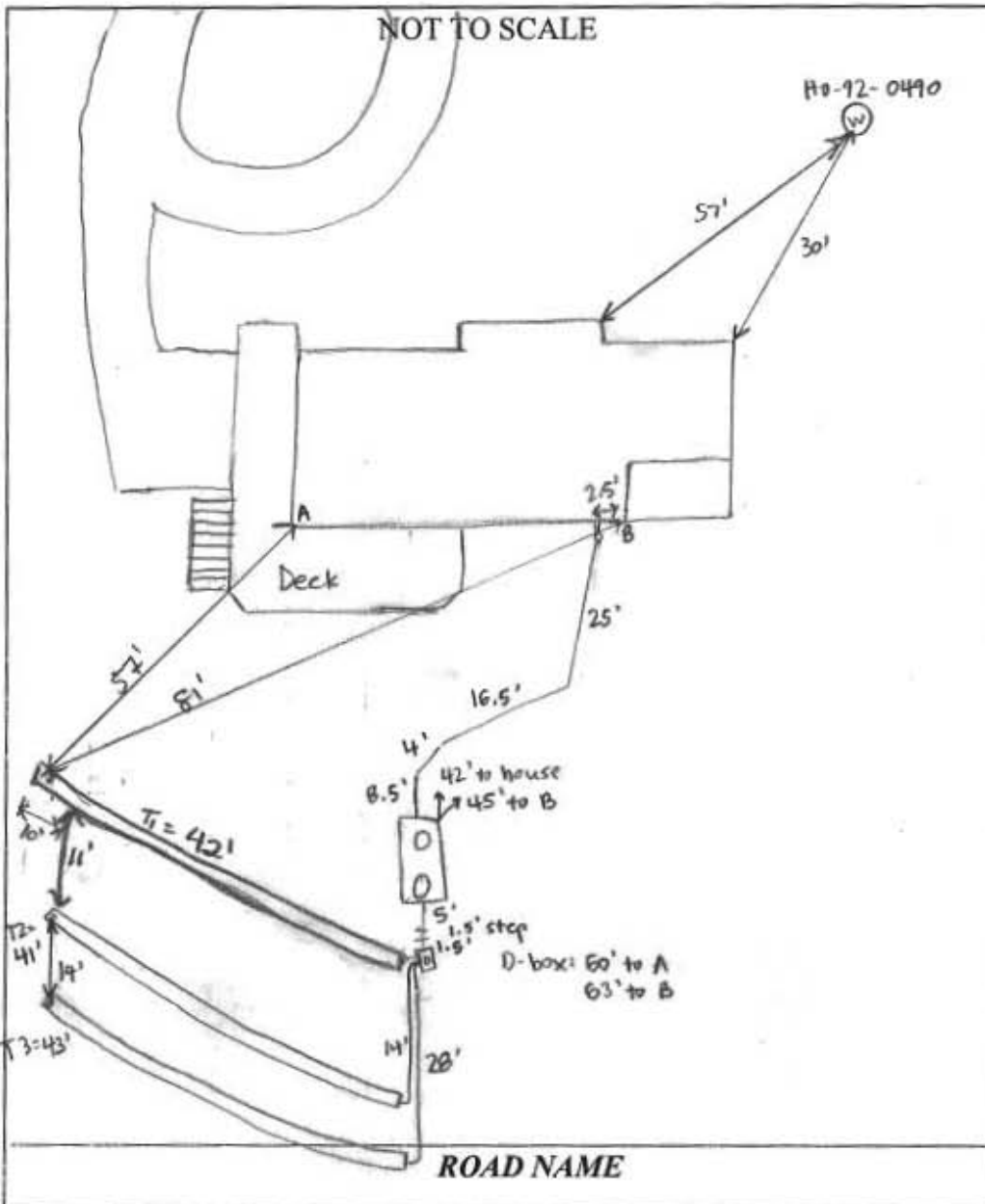

TRENCH/DRAINFIELD DATA

WIDTH	INLET	BOTTOM
2'	4'	10'
NUMBER OF TRENCHES	3	
TOTAL LENGTH	126'	
ABSORPTION AREA	250 sqft + Side wall	
DISTRIBUTION BOX LEVEL	YES	
DISTRIBUTION BOX BAFFLE	YES	
DISTRIBUTION BOX PORT	YES	

SEPTIC TANK DATA

SEPTIC TANK I LEVEL	YES	
MANUFACTURER	BABYLON	
CAPACITY	1500	GAL
SEAM LOC	TOP	
TANK LID DEPTH	1.5-2'	
BAFFLES	YES	
BAFFLE FILTER	NO	
MANHOLE LOC	FRONT + REAR	
6" PORT LOC	NONE	
WATERTIGHT TEST	NO	
SLOTTED	YES	
DATE ON LID	12-31-17	

PUMP/SEPTIC TANK LEVEL

MANUFACTURER	
CAPACITY	GAL
SEAM LOC	
TANK LID DEPTH	
BAFFLES	
BAFFLE FILTER	
MANHOLE LOC	
6" PORT LOC	
WATERTIGHT TEST	
SLOTTED	
DATE ON LID	

PRE-CONSTRUCTION:

2/1/18 Shot contour, determined location for 3x42' trenches. Did not paint out fully, equipment in the way. Pulled 100' off well - may set tank part 100' are painted on ground. (SC)

INSTALLATION: 2/2/18 Tank set, house connection made. D-box set, Hatfield's digging T3. 2' wide, 10' bottom. Using laser to check depth. Old tank pumped. (SC) 2/2/18 T3 finished and left open at ends. Hatfield's adding stone to T2. 10' bottom, 2' wide. 3.5-4' to stone. Old tank filled in with dirt. (SC) 2/5/18 Installed Remaining Trench. D Box leveled. OK to Backfill. Used Laser Level to complete T2.

FINAL INSPECTOR

DATE OF APPROVAL 02/05/2018