

C1 36796

SEQUENCE NO. (MDE USE ONLY)

STATE OF MARYLAND WELL COMPLETION REPORT

THIS REPORT MUST BE SUBMITTED WITHIN 45 DAYS AFTER WELL IS COMPLETED.

(THIS NUMBER IS TO BE PUNCHED IN COLS. 3-6 ON ALL CARDS)

COUNTY NUMBER 13

ST/CO USE ONLY DATE RECEIVED

DATE WELL COMPLETED 7-20-16

Depth of Well 500 (TO NEAREST FOOT)

8/3/16 (Knew)

PERMIT NO. FROM "PERMIT TO DRILL WELL" HO-15-0268

OWNER WARREN, BRENDA Fleming; WELL SITE ADDRESS 1411 W. WATSONVILLE RD; TOWN MT AIRY; SUBDIVISION G.L.M. - Lee Farm; SECTION; LOT 1

WELL LOG

Not required for driven wells

STATE THE KIND OF FORMATIONS PENETRATED, THEIR COLOR, DEPTH, THICKNESS AND IF WATER BEARING

Table with columns: DESCRIPTION, FEET (FROM, TO), check if water bearing. Rows include Top Soil, Brown shale, Brown slate, Tan slate, Gray slate, Brown slate, Gray slate, Brown slate, Gray slate, Flint Gray slate, Gray slate.

GROUTING RECORD

WELL HAS BEEN GROUTED (Circle Appropriate Box) Y N; TYPE OF GROUTING MATERIAL (Circle one) CM BENTONITE CLAY BC; NO. OF BAGS 4; NO. OF POUNDS 200; GALLONS OF WATER 92; DEPTH OF GROUT SEAL (to nearest foot) 36 ft.

CASING RECORD

MAIN CASING TYPE ST (STEEL); Nominal diameter top (main) casing (nearest inch) 6; Total depth of main casing (nearest foot) 40; OTHER CASING (if used) none.

SCREEN RECORD

screen type or open hole ST (STEEL); DEPTH (nearest ft.) 38; DIAMETER OF SCREEN (NEAREST INCH) 50.

PUMPING TEST

HOURS PUMPED (nearest hour) 6; PUMPING RATE (gal. per min.) 1.1; METHOD USED TO MEASURE PUMPING RATE Bucket; WATER LEVEL (distance from land surface) BEFORE PUMPING 54 ft., WHEN PUMPING 146 ft.; TYPE OF PUMP USED (for test) S submersible.

PUMP INSTALLED

DRILLER INSTALLED PUMP (CIRCLE) (YES or NO) YES NO; TYPE OF PUMP INSTALLED PLACE (A,C,J,P,R,S,T,O) IN BOX 29; CAPACITY: GALLONS PER MINUTE (to nearest gallon) 31 36; PUMP HORSE POWER 37 41; PUMP COLUMN LENGTH (nearest ft.) 43 47; CASING HEIGHT (circle appropriate box and enter casing height) + above, - below; LAND SURFACE 2 (nearest foot).

NUMBER OF UNSUCCESSFUL WELLS: 0

WELL HYDROFRACTURED YES (Y) NO (N)

CIRCLE APPROPRIATE LETTER: A A WELL WAS ABANDONED AND SEALED WHEN THIS WELL WAS COMPLETED; E ELECTRIC LOG OBTAINED; P TEST WELL CONVERTED TO PRODUCTION WELL.

I HEREBY CERTIFY THAT THIS WELL HAS BEEN CONSTRUCTED IN ACCORDANCE WITH COMAR 26.04.04 "WELL CONSTRUCTION" AND IN CONFORMANCE WITH ALL CONDITIONS STATED IN THE ABOVE CAPTIONED PERMIT, AND THAT THE INFORMATION PRESENTED HEREIN IS ACCURATE AND COMPLETE TO THE BEST OF MY KNOWLEDGE.

DRILLERS LIC. NO.: MWD 040; DRILLERS SIGNATURE: George F. Spentley; LIC. NO.: JSD 038; DRILLERS SIGNATURE: Bruce Shampson

SITE SUPERVISOR (sign. of driller or journeyman responsible for sitework if different from permittee)

Table with columns: DEPTH (nearest ft.), DIAMETER OF SCREEN (NEAREST INCH). Rows include 1-21, 23-36, 38-51.

GRAVEL PACK IF WELL DRILLED WAS FLOWING WELL INSERT F IN BOX 66

MDE USE ONLY (NOT TO BE FILLED IN BY DRILLER): TELESCOPE CASING, LOG INDICATOR, OTHER DATA.

LATITUDE 39.362361; LONGITUDE 77.110489 (DEFAULT COORD. WGS 84)

Pursuant to §10-624 of the State Govt. Article of the Maryland Code personal info. requested on this form is used in processing this form pursuant to COMAR 26.04.04. Failure to provide the info. may result in this form not being processed. You have the right to inspect, amend, or correct this form.

B 1 1 2 3 4 5 6 38333	SEQUENCE NO. (MDE USE ONLY)	STATE OF MARYLAND APPLICATION FOR PERMIT TO DRILL WELL 558756 please type	STATE PERMIT NUMBER HO-15-0268 <small>70 fill in this form completely 79</small>
Date Received (APA) 06 14 16 <small>8 MM DD YY 13</small>	OWNER INFORMATION 13240 15 Last Name <u>WARREN</u> Owner First Name <u>BRENDA FLEMING</u> 34 36 Street or RFD <u>20803 LAVENDAR PLACE</u> 55 <u>LEXINGTON PARK MD 20653</u> 57 Town 70 State 72 Zip 76	B 3 LOCATION OF WELL <u>CC#</u> Howard 8 COUNTY 21 Elm-Lee Farm 23 SUBDIVISION 42 SECTION <u>44</u> 46 LOT <u>1</u> 48 50 Mt. Airy 52 NEAREST TOWN 71	DRILLER INFORMATION George F. Easterday M W D 040 Driller's Name 76 License No. 81 L. Franklin Easterday, Inc. Firm Name 9285 Brown Church Rd., Mt. Airy, Md. 21771 Address George F. Easterday 6/9/2016 Signature Date
B 2 WELL INFORMATION 1 2 APPROX. PUMPING RATE <u>5</u> (GAL. PER MIN.) 8 12 AVERAGE DAILY QUANTITY NEEDED <u>500</u> (GAL. PER DAY) 14 20	B 4 SOURCES OF DRILLING WATER 1. wells 2. 3.	611 W. Watersville Road 11 STREET ADDRESS 30 ON WHICH SIDE OF ROAD (CIRCLE APPROPRIATE BOX) NORTH WEST <input checked="" type="checkbox"/> EAST SOUTH 34 200 37 DISTANCE FROM ROAD FT. ENTER FT OR MI 38 39 TAX MAP: <u>2</u> BLK: <u>14</u> PARCEL <u>10</u>	
USE FOR WATER (CIRCLE APPROPRIATE BOX) <input checked="" type="checkbox"/> DOMESTIC POTABLE SUPPLY & RESIDENTIAL IRRIGATION <input type="checkbox"/> FARMING (LIVESTOCK WATERING & AGRICULTURAL IRRIGATION) <input type="checkbox"/> INDUSTRIAL, COMMERCIAL, DEWATERING <input type="checkbox"/> PUBLIC WATER SUPPLY WELL <input type="checkbox"/> TEST, OBSERVATION, MONITORING <input type="checkbox"/> OPEN LOOP GEOTHERMAL <input type="checkbox"/> CLOSED LOOP GEOTHERMAL		NOT TO BE FILLED IN BY DRILLER HEALTH DEPARTMENT APPROVAL Howard (13) COUNTY NAME COUNTY NO. STATE SIGNATURE INSERT S → 41 DATE ISSUED <u>6/22/16</u> <u>Ed. Call</u> <u>6/22/17</u> 43 MM DD YY 48 CO SIGNATURE EXP. DATE	
APPROXIMATE DEPTH OF WELL <u>300</u> FEET 24 28 APPROXIMATE DIAMETER OF WELL <u>6</u> INCH NEAREST INCH		PROPOSED LOCATION OF WELL ON LOT SHOW PERMANENT STRUCTURES SUCH AS BUILDINGS, SEPTIC SYSTEM, ROADS AND/OR LANDMARKS AND INDICATE NOT LESS THAN TWO DISTANCE MEASUREMENTS TO WELL	
METHOD OF DRILLING (circle one) BORED (or Augered) JETTED Jetted & DRIVEN 30 AIR-ROTARY AIR-PERCussion ROTARY (Hydraulic Rotary) 37 CABLE REVERSE-ROTARY DRIVE-POINT other			
REPLACEMENT OR DEEPEMED WELLS (CIRCLE APPROPRIATE BOX) <input checked="" type="checkbox"/> THIS WELL WILL NOT REPLACE AN EXISTING WELL <input type="checkbox"/> THIS WELL WILL REPLACE A WELL THAT WILL BE ABANDONED AND SEALED 39 <input checked="" type="checkbox"/> THIS WELL WILL REPLACE A WELL THAT WILL BE USED AS A STANDBY-CONTACT LOCAL APPROVING AUTHORITY FOR POLICY ON STANDBY WELLS <input type="checkbox"/> THIS WELL WILL DEEPEAN AN EXISTING WELL PERMIT NUMBER OF WELL TO BE REPLACED OR DEEPEMED (IF AVAILABLE) 41 _____ 52			
Not to be filled in by driller (MDE OR COUNTY USE ONLY) APPROP. PERMIT NUMBER _____ G _____ PERMIT No. <u>HO-15-0268</u> 70 71 72 73 74 75 76 77 78 79			
SPECIAL CONDITIONS NOTE: APPROVING AUTHORITIES SHOULD USE SEPARATE SHEET IF NEEDED.			

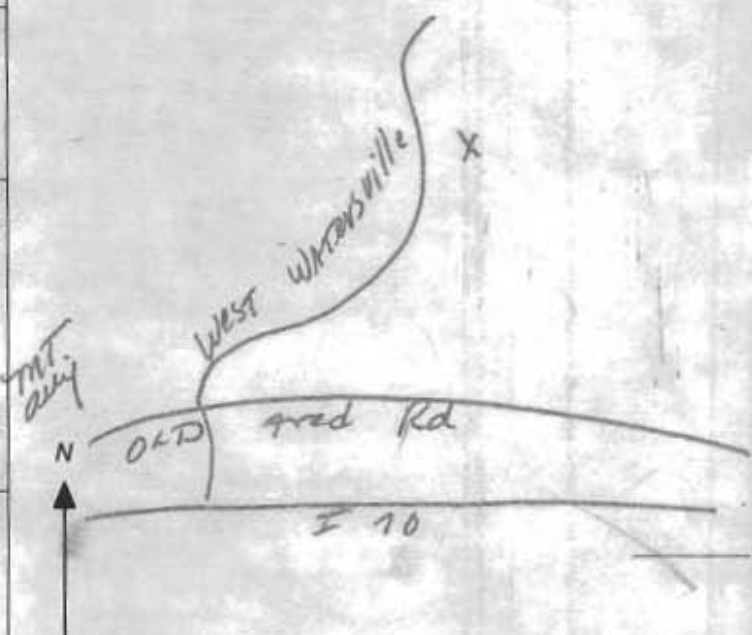

Date 7-21-16Review     

FIELD DATA SHEET  
HYDROGEOLOGIC AREA (7) WELL YIELD TEST

Maryland Well Permit No. HO-15-0268 Election District     Location of Property (road) 611 W. WATERSVILLE RdSubdivision ELM LEE FARM Lot 1 Block      Plat      Sec.     Well Driller Easterday Owner Brenda Fleming WarrenDepth of Well 500 15pm  
Distance of Measuring Point (M.P.) above ground 2  
Static Water Level (S.W.L.) below M.P. 54 PS 400

## I. High Rate Pumping -- reservoir drawdown

Time pump started 4:45 Pumping rate 20  
Total time 15 to reach pumping water level 145 ft. below M.P.PS 400  
579

## II. Recovery pump test data - observations to be recorded every 15 minutes.

TIME	WATER LEVEL Below M.P.	PUMPING RATE Time to fill / gal. bucket	FLOW METER READING (if used)	CALCULATED FLOW (gallons per min.)
5:00	145	35		1.7
5:15	145	35		1.7
5:30	145	35		1.7
5:45	145	35		1.7
6:00	145	35		1.7
6:15	145	40		1.5
6:30	145	40		1.5
6:45	145	47		1.25
7:00	146	47		1.25
7:15	146	47		1.25
7:30	146	47		1.25
7:45	146	53		1.1
8:00	146	53		1.1
8:15	146	53		1.1
8:30	146	53		1.1
8:45	146	53		1.1
9:00	146	53		1.1
9:15	146	53		1.1
9:30	146	53		1.1
9:45	146	53		1.1
10:00	146	53		1.1
10:15	146	53		1.1
10:30	146	53		1.1
10:45	146	53		1.1
11:00	146	53		1.1

**HOWARD COUNTY HEALTH DEPARTMENT  
BUREAU OF ENVIRONMENTAL HEALTH  
WELL & SEPTIC PROGRAM  
TEL: (410)313-1771 FAX: (410)313-2648**

Information Form for the Installation of the Well Pump, Pitless Adapter, and Supply Piping

NOTE: The installer is responsible for requesting an inspection prior to 9 am on the day of the desired inspection. No work is to be covered until approved by the Health Department. All installations must comply with the National Standard Plumbing Code (NSPC, as amended locally) and COMAR 26.04.04 (MD Well Construction Regulations). Submission of a complete form is required prior to Use and Occupancy approval.

Company Name: Burgan Inc Telephone #: 410-259-8924  
Address: 640 Kelcey Mill Rd  
Westminster MD 21157

(Must circle one) Licensed Plumber Licensed Well Driller Licensed Well Pump Installer

License # and name of individual responsible for the field installation:  
Name (Print): Jim Burgan License# 64802

\*A licensed individual must perform the actual installation. Apprentices must be under the supervision of a licensed journeyman or master plumber, pump installer or well driller. Licenses may be subjected to field verification. Unlicensed individuals may be reported to the appropriate licensing agency.

Name of Property Owner: Brenda Flenght Telephone #: 301-487-5852  
Subdivision: \_\_\_\_\_ Lot #: \_\_\_\_\_ Well Tag #: HO-13-0268/01/02/2018 ⊕  
Site Address: 591 West Watersville Rd  
MT Airy MD

<u>Submersible Pump Data</u>	<u>Pitless Adapter</u>	<u>Well Cap and Electric Conduit</u>
Make: <u>National</u>	Make: <u>American Grundfos</u>	Two piece watertight cap: <u>✓</u>
Model #: <u>115411P</u>	Model#: <u>PT800</u>	Screened, vented well cap: <u>✓</u>
Pump Capacity: <u>5</u> GPM	Depth: <u>500</u> (36" min)	Cap secured to casing: <u>✓</u>
Well Yield: <u>1.5</u> GPM	NSF/WSC approved: <u>✓</u>	Conduit min 18" B.G.: <u>✓</u>
Depth of well encountered at time of pump installation: <u>500</u> (feet)		Conduit secured to well cap: <u>✓</u>
If pump capacity exceeds well yield, a low water cut off switch is required by NSPC 1990 Section 17.8.4		
Torque arrestors, Cable guards, or other acceptable method used- Must circle one		
Safety rope, if used, attached to brass rope adapter or other acceptable method <u>inside of well casing</u> ✓		

<u>Piping to house</u>	<u>House Connection</u>
Type: <u>1" FPS</u>	PVC sleeve to undisturbed soil at wall penetration: <u>✓</u>
PSI: <u>200</u> (160 psi min)	Length of sleeve (5' minimum from foundation): <u>10'</u>
Depth of supply line: <u>42"</u> (36" min)	Sleeve sealed properly: <u>✓</u>

The water supply line is required to be at least ten feet from the septic tank, pump chamber, sewage piping, distribution box, drainfields, and sewage reserve area. If this cannot be accomplished, contact this office for approval prior to installation.

Signature of company representative responsible for installation: \_\_\_\_\_ date: 3/28/18

For Health Department Use Only - Not to be completed by Installer

Date Insp. Requested: 01/02/2018 Date Insp. Approved: 01/02/2018 Inspector: Ⓧ

Inspection Data: Pitless adapter watertight & water supply line at least 36" below grade	<u>✓</u>	<u>54"</u>	<u>01/02/2018</u> ⊕
Two piece cap installed and attached to casing securely	<u>✓</u>		
Elec. conduit extends at least 18" below grade/attached to cap properly	<u>✓</u>	<u>41"</u>	<u>01/02/2018</u> ⊕
Safety rope not outside of well cap/casing	<u>✓</u>		
Correct well tag attached properly and casing 8" above finished grade	<u>✓</u>	<u>19"</u>	<u>01/02/2018</u> ⊕
Water supply line sleeved adequately at house connection	<u>✓</u>	<u>9"</u>	<u>01/02/2018</u> ⊕
Adequate grout observed below pitless adapter	<u>✓</u>		

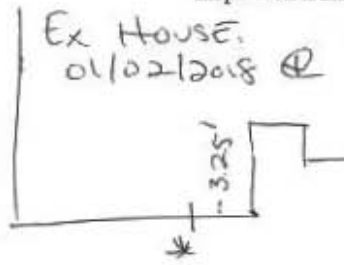

ok Inv.  
4.75' from  
TOW

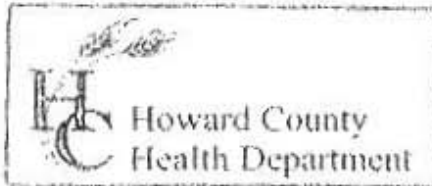

3525 H Ellicott Mills Drive, Ellicott City, MD 21043  
(410) 313-2640 Fax (410) 313-2648  
TDD (410) 313-2323 Toll Free 1-866-313-6300  
website: www.hchealth.org

Penny E. Borenstein, M.D., M.P.H., Health Officer

TO ALL INTERESTED PARTIES

When submitting a well permit application for a proposed well for new construction, please indicate one of the following:

- The well site has been staked by VAN MAR ASSOCIATES,  
(professional land surveyor or company employing professional land surveyors)  
on 6-6-16 (date) and does not require a site inspection.
- The well driller, builder or property owner will call the Health Department to schedule a time to meet in the field to verify the proposed well site location.

This sheet, along with two copies of an acceptable well site plan, must be attached to the green well permit application.

Revised 6/10/03

611 Watersville Road  
WARREN RESIDENCE

DO NOT REMOVE THIS TAG  
DEPARTMENT OF THE ENVIRONMENT  
WELL PERMIT NUMBER

H0-15-0268

INFORMATION-GIVE NUMBER AND WRITE  
1800 WASHINGTON BLVD  
BALTIMORE MARYLAND, 21230

Well sites approved  
6/21/16 SC

Well sites staked  
by Van Mar  
Associates

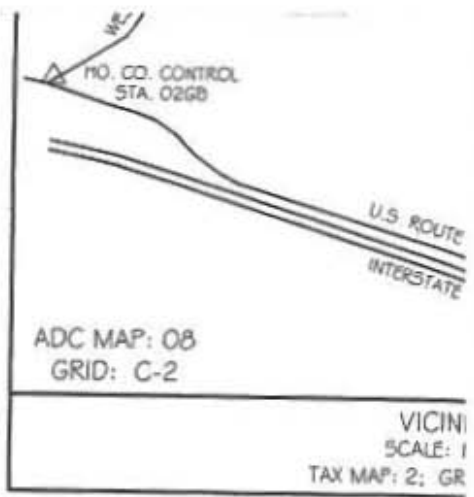

ADC MAP: 08  
GRID: C-2

VICIN  
SCALE: 1  
TAX MAP: 2; GR

GENERAL NOTES:

- THE LOTS SHOWN HEREON COMPLY WITH THE AREA AS REQUIRED BY THE MARYLAND STATE REGULATIONS.
- COORDINATES ARE BASED ON THE MARYLAND PROJECTED BY HOWARD COUNTY GEODETIC 02GB.  
STA. 02HC N. 612,924.256  
STA. 02GB N. 614,978.569
- THIS AREA DESIGNATES A 10,000 SQUARE FEET (OR) SHARED DRAIN FIELDS ASSOCIATED WITH A REQUIRED BY THE MARYLAND STATE DEPARTMENT INDIVIDUAL SEWAGE DISPOSAL (COMAR 26. IN THIS AREA ARE RESTRICTED UNTIL PUBLIC EASEMENTS SHALL BECOME NULL AND VOID SEWAGE SYSTEM. THE COUNTY HEALTH OFFICER GRANT VARIANCES FOR ENCROACHMENTS IF RECORDATION OF A MODIFIED SEWAGE EASEMENT B.R.L. - REPRESENTS BUILDING RESTRICTION  
  - REPRESENTS CONCRETE MONUMENT
  - REPRESENTS IRON REBAR SET (UNLESS OTHERWISE NOTED)
- PUBLIC WATER AND SEWER ARE NOT AVAILABLE SEWER WILL BE PROVIDED UNTIL PUBLIC UTILITIES THE SUBJECT PROPERTY IS ZONED "RC-DEO" ZONING PLAN.
- DRIVEWAYS SHALL BE PROVIDED PRIOR TO THE PERMIT FOR ANY NEW DWELLINGS TO INSURE EMERGENCY VEHICLES PER THE FOLLOWING:
  - WIDTH - 12' (16' SERVING MORE THAN ONE LOT)
  - SURFACE - 6" OF COMPACTED GRAVEL WITH COATING (1-1/2" MIN.);
  - GEOMETRY - MAX. 15% GRADE, 25' TURNING RADIUS;
  - STRUCTURES (CULVERTS / BRIDGE) SHALL BE CAPABLE OF SUPPORTING GROSS TONS (H25 LOADING);
  - DRAINAGE ELEMENTS - CAPABLE OF SUPPORTING WITH NO MORE THAN ONE FOOT DEPTH OF WATER;
  - MAINTENANCE - SUFFICIENT TO MAINTAIN THE DRIVEWAY IN GOOD CONDITION.
- THIS PLAT IS BASED ON A FIELD RUN MONUMENT IN FEBRUARY, 1985 BY VANMAR ASSOCIATES.
- AREAS AS STATED ON THIS PLAT ARE TO BE CONSIDERED UNLESS OTHERWISE NOTED.
- THIS PLAT IS IN COMPLIANCE WITH THE AMENDMENT SUBDIVISION AND LAND DEVELOPMENT REGULATIONS DEVELOPMENT OR CONSTRUCTION OF THIS LOT AND BUFFER REGULATION IN EFFECT AT THE TIME OF BUILDING/GRADING PERMIT.
- THERE ARE NO HISTORIC SITES, CEMETERIES OR OTHER PROPERTY.
- DEVELOPER RESERVES UNTO ITSELF, ITS SUCCESSORS AND EASEMENTS SHOWN ON THIS PLAN FOR WATER AND PUBLIC UTILITIES LOCATED IN, ON OVER AND UNDER CONVEYANCES OF THE AFORESAID LOTS / PARCELS. EASEMENTS HEREIN RESERVED, WHETHER OR NOT CONVEYING SAID LOTS / PARCELS. DEVELOPER RESERVES UNTO ITSELF, ITS SUCCESSORS AND EASEMENTS HEREIN RESERVED TO MAINTAIN AND OPERATE THE PUBLIC UTILITIES AND THEIR ACCEPTANCE SHALL ACCEPT THE EASEMENTS AND RECORD THEM IN THE LAND RECORDS OF HOWARD COUNTY.



NOTE: ALL LOTS IN THIS SUBDIVISION ARE SUBJECT TO THE MHIU



### Certificate of Analysis

Acct. No. 11683 - 1-1

#### Field Record

Site visit performed on: Tuesday, May 29, 2018 11:42 AM  
by: Dennis Crockett State ID No. 7975DC  
Affiliation: Fredericktowne Labs, Inc.  
Property Owner: NSB Enterprises  
Property Address: 591 W. Watersville Road  
Mt. Airy, MD 21771  
Sample Source: Pressure Tank  
Treatment Devices Noted: No Treatment Devices  
Well No.: HO-15-0268  
Field pH: 7.4  
Free Res. Cl.: <0.1 mg/l  
Temp: 14.1° C

#### Laboratory Report

Sample Received at laboratory: 5/29/2018 1:25 PM

#### Bacteriological results:

<u>Total Colif. (/100ml)</u>	<u>E.coli. (/100ml)</u>	<u>Start</u>		<u>End</u>		<u>Method</u>	<u>Analyst</u>
		<u>Date</u>	<u>Time</u>	<u>Date</u>	<u>Time</u>		
<1	<1	05/29/18	13:41	05/30/18	07:59	9223B	JD

Bacteriological analysis of this sample indicates the water is safe for human consumption and meets federal, state and local requirements. Analysis was performed according to the 20th edition of Standard Methods

#### Inorganic Chemical results:

<u>Parameter</u>	<u>Result</u>	<u>Units</u>	<u>MCL</u>	<u>Date of Analysis</u>	<u>Method</u>	<u>Analyst</u>
Nitrate-Nitrogen	9.4	mg/l	10	5/29/2018	300.0	PH
Sand	<2	mg/l	5	5/29/2018	0.065mmFilter	JD
Turbidity	1.9	NTU'	<10	5/29/2018	180.1	KB

Reported by:

*Eddy Mellott* 5/31/18  
Name Date

Fredericktowne Labs, Inc. is a State Certified Water Quality Laboratory  
Maryland Cert. No. 116 Virginia Cert. No. 00444  
MDOT WBE Cert. No.: 91-158

**INTERIM CERTIFICATE OF POTABILITY**

**Expiration Date – DECEMBER 22, 2018**

June 22, 2018

Homeowner  
591 West Watersville Road  
Mt. Airy, MD 21771

**RE: Elm-Lee Farm, Lot 1  
591 W. Watersville Road  
Building Permit: B17003209  
Well Permit: HO-15-0268**

Dear Homeowner:

This is to advise you that the septic system installation and water well construction for the above referenced property have been inspected and approved. Final approval of the septic system was granted on **1/4/2018**. Final approval of the well line connection to the dwelling was granted on **1/2/2018**. The well construction was completed on **7/20/2016**. Water samples were collected on **5/29/2018**.

The water sample results indicate that the water samples submitted for testing were free of coliform and fecal coliform bacteria at the time of sampling and are bacteriologically safe for drinking. This certifies that the initial sampling requirements of COMAR 26.04.04 "Well Regulations" have been met for the water supply system installed under well permit HO-15-0268. Although the submitted sample results are in compliance with COMAR standards, the Health Department does not guarantee water supplies.

This Interim Certificate of Potability will expire **six months** from the date of issuance. Submission of a second bacteriological test indicating the water is free of coliform and fecal coliform bacteria is required prior to the expiration date, after which time a Final Certificate of Potability will be issued. **Failure to submit an additional sample and obtain a Final Certificate of Potability will result in a Notice of Violation and is punishable as a misdemeanor under the Annotated Code of Maryland, Environment Article, 9-1311, subject to a fine of up to \$500 or imprisonment not to exceed three months.**

Please contact (410) 313-1773 to schedule a final water sample appointment or contact a Maryland certified water laboratory to schedule a water sample. A list of laboratories certified by the state of Maryland may be found at the following website:  
<http://www.mde.state.md.us/assets/document/WSP-Labs-2010apr16.pdf>

---

Maura J. Rossman, M.D., Health Officer

In closing, please refer to our "[Homeowner Fact Sheet](#)" which illustrates a better understanding for your Onsite Sewage Disposal System. You will also find a link to Maryland Department of the Environment's website which describes in further detail operation and maintenance of your septic system.

Approving Authority,

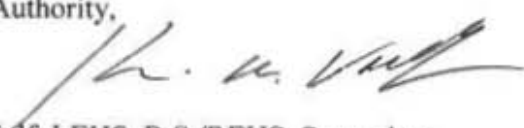
  
Kevin M. Wolf, LEHS, R.S./REHS, Supervisor  
Groundwater Management Section  
Well & Septic Program

cc: Howard County Dept. of Inspections, Licenses, and Permits  
Community Hygiene Program  
File

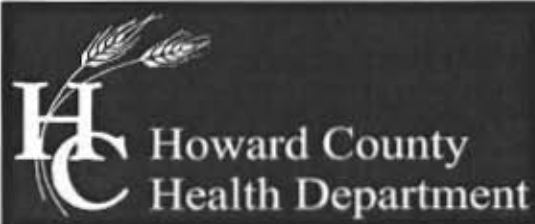

## Bureau of Environmental Health

8930 Stanford Blvd, Columbia, MD 21045  
Main: 410-313-2640 | Fax: 410-313-2648  
TDD 410-313-2323 | Toll Free 1-866-313-6300  
[www.hchealth.org](http://www.hchealth.org)

Facebook: [www.facebook.com/hocohealth](https://www.facebook.com/hocohealth)

Twitter: [HowardCoHealthDep](https://twitter.com/HowardCoHealthDep)

---

Maura J. Rossman, M.D., Health Officer

## MEMORANDUM

TO: Kent Sheubrooks, Chief  
Dept. Planning & Zoning

FROM: Kevin M. Wolf, L.E.H.S., Supervisor  
Groundwater Mgmt. Sec.  
Well & Septic Program

DATE: August 4, 2016

RE: 'All-Wells-Drilled' -- **F-16-058**  
**Elm Lee Farm Lot 1**

A handwritten signature in black ink, appearing to read 'KMW', enclosed in a hand-drawn oval.

---

The wells for the *Elm Lee Farm* have been drilled and received preliminary approval by the Health Department. The recordation of plat **F-16-058** should not be held up any longer due to issues involving well drilling. The developer of this project has fulfilled this prerequisite. If there are any questions involving this particular memorandum, I can be reached at (410) 313 – 2645 or [kwolf@howardcountymd.gov](mailto:kwolf@howardcountymd.gov)

KMW

C.c. Debbie VanSant, [DKV@vanmar.com](mailto:DKV@vanmar.com)  
File

MARYLAND DEPARTMENT OF THE ENVIRONMENT WATER MANAGEMENT ADMINISTRATION  
1800 Washington Blvd. Baltimore, Maryland 21230 (410) 537-3784

WATER WELL HYDROFRACTURE REPORT

WELL TAG NUMBER H0-15-02 DATE WORK PERFORMED (mm/dd/yyyy) 07/20/2016

WELL SITE ADDRESS 611 W. Watersville Road

TAX MAP 2 BLK 14 PARCEL 10 LATITUDE 39-362361 LONGITUDE 77-110489

CASING DEPTH 40 FT CASING TYPE (circle) ST OR PVC DIAMETER 6

WELL DEPTH 500 FT WATER LEVEL BEFORE FRAC 54 FT YIELD BEFORE FRAC 1/2 GPM

PACKER SETTINGS (circle) SINGLE OR MULTIPLE SET DEPTH OF SHALLOWEST PACKER 80 FT

SOURCE OF WATER WSSC

OBSERVATIONS

SET NUMBER	TOP ZONE (FT)	BOTTOM ZONE (FT)	MAX PRESSURE (PSI)	WATER VOLUME USED (GALLONS)
1 <u>1</u>	<u>80</u>	<u>500</u>	<u>1300</u>	<u>1000</u>
2 <u>2</u>	<u>140</u>	<u>500</u>	<u>1300</u>	<u>1000</u>
3				
4				
5				

WATER LEVEL AFTER FRAC 54 FT

YIELD AFTER FRAC 1.1 GPM

NOTE: YIELD TEST PROCEDURES CAN BE FOUND UNDER COMAR 26.04.04.26.G.

REGULATIONS FOR HYDROFRACTURING OF WATER WELLS CAN BE FOUND IN COMAR 26.04.04.28. FAILURE TO FOLLOW REGULATORY PROCEDURES WILL CONSTITUTE RECEIVING A WRITTEN VIOLATION WHICH MAY RESULT IN PENALTIES DESCRIBED IN COMAR 26.04.04.38.

This Notice is provided pursuant to 110-624 of the States Government Article of the Maryland code. The Personal Information Requested on this form is intended to be used in processing this form pursuant to COMAR 26.04.04. Failure to provide the information requested may result in the form not being processed. You have the right to inspect, amend, or correct this form. The Maryland Department of the Environment ("MDE") a public agency and subject to the Maryland Public Information Act. This form may be made available on the internet via MDE a website and subject to inspection or copying, in whole or in part, by the public and other government agencies. If not protected by Federal or State law.

Bruce Thompson  
DRILLER SIGNATURE

JSD 038  
LIC #