



# HOWARD COUNTY HEALTH DEPARTMENT

25618

DATE  
10/30/66

AS ~~3~~

Received From

Hatfields Equipment

PHONE #

P.O. Box 519 Annapolis Junction, MD 20701

For repair perc -

CASH

CHECK

1715 Underwood Rd

NO.

2412

one hundred sixty dollars

Dollars

\$

1165.00

Received By



# APPLICATION

## FOR PERCOLATION TESTING AND SITE EVALUATION

TEST DATE(S) \_\_\_\_\_ TEST TIME \_\_\_\_\_ AP 525618

AGENCY REVIEW: \_\_\_\_\_ DATE 10/30/06

DO NOT WRITE ABOVE THIS LINE

I HEREBY APPLY FOR THE NECESSARY TESTING/EVALUATION PRIOR TO ISSUANCE OF SEWAGE DISPOSAL SYSTEM PERMIT(S) TO:

CHECK AS NEEDED:

- CONSTRUCT NEW SEPTIC SYSTEM(S)
- REPAIR/ADD TO AN EXISTING SEPTIC SYSTEM
- REPLACE AN EXISTING SEPTIC SYSTEM

CHECK AS NEEDED:

- NEW STRUCTURE(S)
- ADDITION TO AN EXISTING STRUCTURE
- REPLACE AN EXISTING STRUCTURE

CHECK ONE:

- CREATE NEW LOT(S)
- BUILD ON AN EXISTING LOT IN A SUBDIVISION
- BUILD ON AN EXISTING PARCEL OF RECORD

IS THE PROPERTY WITHIN 2500' OF ANY RESERVOIR?

- YES
- NO

THE TYPE OF STRUCTURE IS:

- RESIDENTIAL WITH \_\_\_\_\_ PROPOSED BEDROOMS IN THE COMPLETED STRUCTURE (NOTE *UNKNOWN* IF APPROPRIATE)
- COMMERCIAL (PROVIDE DETAIL OF NUMBERS AND TYPES OF EMPLOYEES/ CUSTOMERS ON ACCOMPANYING PLAN)
- INSTITUTIONAL/GOVERNMENT (PROVIDE DETAIL OF NUMBERS AND TYPES OF EMPLOYEES/USERS ON ACCOMPANYING PLAN)

PROPERTY OWNER(S) Charles Snyder

DAYTIME PHONE 410 442 1573 CELL \_\_\_\_\_ FAX \_\_\_\_\_

MAILING ADDRESS 8957 Twelve Sons Ct Jessup Md 20794  
STREET CITY/TOWN STATE ZIP

APPLICANT Hatfield's Equipment

DAYTIME PHONE 301-854-6172 CELL 410 984-0047 FAX 301

MAILING ADDRESS PO Box 519 Annapolis Junction Md 20701  
STREET CITY/TOWN STATE ZIP

APPLICANT'S ROLE: DEVELOPER  septic contractor BUILDER  BUYER  RELATIVE/FRIEND  REALTOR  CONSULTANT

PROPERTY LOCATION  
SUBDIVISION/PROPERTY NAME 1715 Underwood Rd LOT NO. \_\_\_\_\_

PROPERTY ADDRESS 1715 Underwood Rd Sykesville  
STREET TOWN/POST OFFICE

TAX MAP PAGE(S) \_\_\_\_\_ GRID \_\_\_\_\_ PARCEL(S) \_\_\_\_\_ PROPOSED LOT SIZE \_\_\_\_\_

AS APPLICANT, I UNDERSTAND THE FOLLOWING: THE SYSTEM INSTALLED SUBSEQUENT TO THIS APPLICATION IS ACCEPTABLE ONLY UNTIL PUBLIC SEWERAGE IS AVAILABLE. THIS APPLICATION IS COMPLETE WHEN ALL APPLICABLE FEES AND A SUITABLE SITE PLAN HAVE BEEN RECEIVED. I ACCEPT THE RESPONSIBILITY FOR COMPLIANCE WITH ALL M.O.S.H.A. AND "MISS UTILITY" REQUIREMENTS. APPROVAL IS BASED UPON SATISFACTORY REVIEW OF A PERC CERTIFICATION PLAN.

TEST RESULTS WILL BE MAILED TO APPLICANT. \_\_\_\_\_  
SIGNATURE OF APPLICANT

HOWARD COUNTY HEALTH DEPARTMENT, BUREAU OF ENVIRONMENTAL HEALTH, WELL AND SEPTIC PROGRAM  
3525-H ELLICOTT MILLS DRIVE, ELLICOTT CITY, MARYLAND 21043-4544 (410) 313-1771 FAX (410) 313-2648  
TDD (410) 313-2323 TOLL FREE 1-877-4MD-DHMH

A/P (A)

Heavy Br Cl  
Loam and  
Topsoil  
Trace Rock

2'  
Red Br Sa  
Cl Loam  
Trace Rock

3'  
Red Br Sa  
Loam, Some  
clay, Trace  
Rock

4.5'  
Beige Sa Loam  
14' x 15% Saprolite

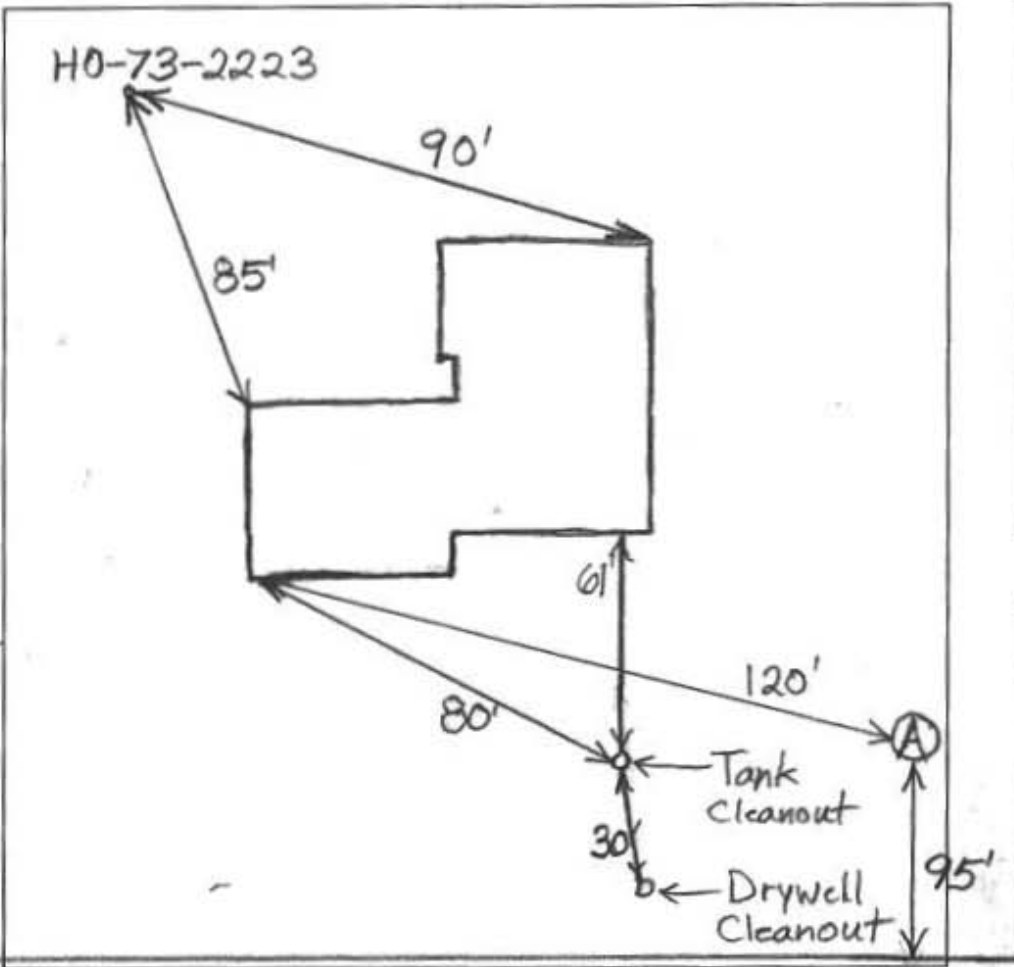

Underwood Road

DATE	TEST #	DEPTH	START	BREAK 1' DROP	STOP 2' DROP	TIME OF 2nd INCH	P/F/H
11/8/06	A	6' / 14'		1 3/4		3 1/2	P

REMARKS Water Poured in Bottom of Hole - Rate O.K.  
 SANITARIAN B. Baker BACKHOE Hatfields OTHERS \_\_\_\_\_  
 TEST HOLES USED IN SDA A AVG. PERC TIME 3 1/2 SQ. FT/BR 180  
 TRENCH WIDTH 2' INLET DEPTH 5' MAX. BOT DEPTH 9' EFFECTIVE SW 4'