

C1 0209 SEQUENCE NO. (DENV USE ONLY)  
 (THIS NUMBER IS TO BE PUNCHED IN COLS. 3-6 ON ALL CARDS)

STATE OF MARYLAND  
 WELL COMPLETION REPORT  
 FILL IN THIS FORM COMPLETELY  
 PLEASE PRINT OR TYPE

THIS REPORT MUST BE SUBMITTED WITHIN 45 DAYS AFTER WELL IS COMPLETED.  
 COUNTY NUMBER A39162

ST/CO USE ONLY  
 DATE Received: [ ] [ ] [ ] [ ] [ ] [ ]  
 DATE WELL COMPLETED: 07/1/87

Depth of Well  
165 (TO NEAREST FOOT)

PERMIT NO.  
 FROM "PERMIT TO DRILL WELL"  
HO-88-0763

OWNER Hilltop Development Corporation  
 STREET OR RFD Detville Dr. TOWN Hilltop  
 SUBDIVISION Waterman Estates SECTION I LOT 22

**WELL LOG**  
 Not required for driven wells

STATE THE KIND OF FORMATIONS PENETRATED, THEIR COLOR, DEPTH, THICKNESS AND IF WATER BEARING

DESCRIPTION (Use additional sheets if needed)	FEET		Check if water bearing
	FROM	TO	
<u>Sand Stone</u>	<u>0</u>	<u>54</u>	
<u>Gray Micr Rock</u>	<u>54</u>	<u>165</u>	

**GROUTING RECORD**  
 WELL HAS BEEN GROUTED (Circle Appropriate Box)  
 TYPE OF GROUTING MATERIAL  
 GEMENT CM BENTONITE GLAY BC  
 NO. OF BAGS 4 NO. OF POUNDS 1024  
 GALLONS OF WATER 66  
 DEPTH OF GROUT SEAL (to nearest foot)  
 from 0 ft. to 39 ft.  
 (enter 0 if from surface)

**CASING RECORD**  
 casing types insert appropriate code below  
 ST STEEL  CO CONCRETE  
 PL PLASTIC  OT OTHER  
 MAIN CASING TYPE ST Nominal diameter top (main) casing (nearest inch) 2 Total depth of main casing (nearest foot) 60

**OTHER CASING (if used)**  
 diameter inch depth (feet) from to

**SCREEN RECORD**  
 screen type or open hole insert appropriate code below  
 ST STEEL  BR BRASS  HO OPEN HOLE  
 PL PLASTIC  OT OTHER

**C2**

EACH SCREEN	DEPTH (nearest ft.)	
	1	2
1	<u>10</u>	<u>54</u>
2		<u>165</u>
3		

SLOT SIZE 1 \_\_\_\_\_ 2 \_\_\_\_\_ 3 \_\_\_\_\_  
 DIAMETER OF SCREEN \_\_\_\_\_ (NEAREST INCH)  
 from \_\_\_\_\_ to \_\_\_\_\_

CIRCLE APPROPRIATE LETTER  
 A A WELL WAS ABANDONED AND SEALED WHEN THIS WELL WAS COMPLETED  
 E ELECTRIC LOG OBTAINED  
 P TEST WELL CONVERTED TO PRODUCTION WELL

I HEREBY CERTIFY THAT THIS WELL HAS BEEN CONSTRUCTED IN ACCORDANCE WITH COMAR 26.04.04 "WELL CONSTRUCTION" AND IN CONFORMANCE WITH ALL CONDITIONS STATED IN THE ABOVE CAPTIONED PERMIT, AND THAT THE INFORMATION PRESENTED HEREIN IS ACCURATE AND COMPLETE TO THE BEST OF MY KNOWLEDGE.

DRILLERS IDENT. NO. 739

DRILLERS SIGNATURE (MUST MATCH SIGNATURE ON APPLICATION)

SITE SUPERVISOR (sign of driller or journeyman responsible for sitework if different from permittee)

GRAVEL PACK IF WELL DRILLED WAS FLOWING WELL INSERT F IN BOX 68

OEP USE ONLY (NOT TO BE FILLED IN BY DRILLER)  
 T (E.R.O.S.) 70 [ ] 72 [ ]  
 W Q 74 [ ] 75 [ ] 76 [ ]  
 TELESCOPE CASING LOG INDICATOR OTHER DATA

**C3**

**PUMPING TEST**  
 HOURS PUMPED (nearest hour) 3  
 PUMPING RATE (gal. per min. to nearest gal.) 10  
 METHOD USED TO MEASURE PUMPING RATE Bucket  
 WATER LEVEL (distance from land surface)  
 BEFORE PUMPING 20  
 WHEN PUMPING 67  
 TYPE OF PUMP USED (for test)  
 A air  P piston  T turbine  
 C centrifugal  R rotary  O other (describe below)  
 J jet  S submersible

**PUMP INSTALLED**  
 DRILLER WILL INSTALL PUMP YES  NO   
 IF DRILLER INSTALLS PUMP, THIS SECTION MUST BE COMPLETED FOR ALL WELLS EXCEPT HOME USE  
 TYPE OF PUMP INSTALLED PLACE (A,C,J,P,R,S,T,O) IN BOX - SEE ABOVE:  
 CAPACITY: GALLONS PER MINUTE (to nearest gallon) \_\_\_\_\_  
 PUMP HORSE POWER \_\_\_\_\_  
 PUMP COLUMN LENGTH (nearest ft.) \_\_\_\_\_  
 CASING HEIGHT (circle appropriate box and enter casing height)  
 + above } LAND SURFACE  
 - below } 3 (nearest foot)

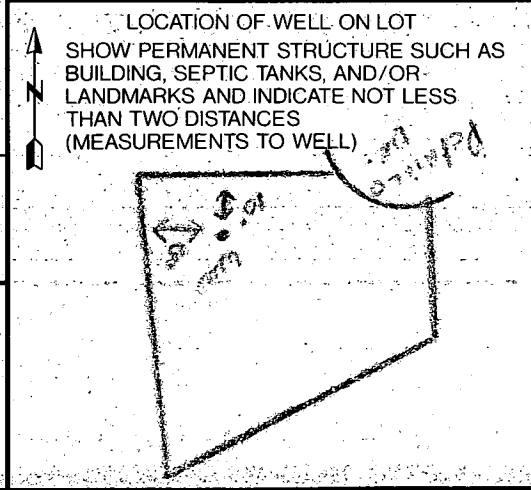

B 1 **5693** SEQUENCE NO. (DP USE ONLY)  
 (THIS NUMBER IS TO BE PUNCHED IN COLS. 3-6 ON ALL CARDS)

STATE OF MARYLAND  
 PERMIT TO DRILL WELL  
 please print or type

STATE PERMIT NUMBER  
**HO-44-0763**  
 fill in this form completely

Date Received (APA) **052489**  
**OWNER INFORMATION**  
**HILLTOP DEVELOPMENT**  
 15 Last Name 34 Owner First Name  
**PO BOX 208**  
 36 Street or RFD 55  
**CLARKSVILLE MD 21109**  
 57 Town 70 State 72 Zip 76

B 3 LOCATION OF WELL  
**HOWARD** COUNTY 21  
**WATERMAN ESTATES** SUBDIVISION 42  
 SECTION **1** LOT **11**  
**FULTON** NEAREST TOWN 71  
 MILES FROM TOWN (enter 0 if in town) **3** MI  
 73 76 77 78

**DRILLER INFORMATION**  
**Joseph L. Mayne** 238 License No. 80  
**Joseph L. Mayne Well Drilling** Firm Name  
**5512 Ridge Rd. Mt. Airy, Md. 21771** Address  
**Joseph L. Mayne** 5/22/89 Date  
 Signature

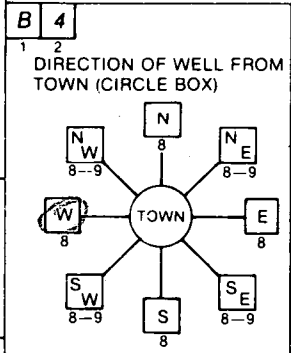

**Petrillo Drive** NEAR WHAT ROAD 30  
 NORTH  
 ON WHICH SIDE OF ROAD (CIRCLE APPROPRIATE BOX)  
 WEST EAST SOUTH  
 DISTANCE FROM ROAD **250** FT  
 34 37 ENTER FT or MI **FT**  
 38 39

B 2 WELL INFORMATION  
 APPROX. PUMPING RATE (GAL. PER MIN.) **5**  
 8 12  
 AVERAGE DAILY QUANTITY NEEDED (GAL. PER DAY) **500**  
 14 20

NOT TO BE FILLED IN BY DRILLER HEALTH DEPARTMENT APPROVAL  
**Howard** COUNTY NAME  
**A 39162** COUNTY NO.  
 STATE SIGNATURE \_\_\_\_\_ INSERT S  
 DATE ISSUED **061689** **Cray Williams** 12/16/89  
 43 48 CO SIGNATURE EXP. DATE  
 NORTH GRID **481000** EAST GRID **0819000**  
 50 55 57 63

USE FOR WATER (CIRCLE APPROPRIATE BOX)  
 HOME (SINGLE OR DOUBLE HOUSEHOLD UNIT ONLY)  
 FARMING (LIVESTOCK WATERING & AGRICULTURAL IRRIGATION)  
 INDUSTRIAL, COMMERCIAL, STATE AND FEDERAL GOV. OTHER (REQUIRES APPROPRIATION PERMIT)  
 PUBLIC OR PRIVATE WATER COMPANY (REQUIRES APPROPRIATION PERMIT AND STATE HEALTH DEPARTMENT APPROVAL)  
 TEST, OBSERVATION, MONITORING (MAY REQUIRE APPROPRIATION PERMIT)

APPROXIMATE DEPTH OF WELL **290** FEET  
 24 28

SHOW MAJOR FEATURES OF BOX & LOCATE WELL WITH AN X  
 SOURCES OF DRILLING WATER  
 1. WELL  
 2.  
 3.  
 WRITE THE BOX NUMBER FROM THE MAP HERE  
  
 DRAW A SKETCH BELOW SHOWING LOCATION OF WELL IN RELATION TO NEARBY TOWNS AND ROADS AND GIVE DISTANCE FROM WELL TO NEAREST ROAD JUNCTION  
**7/11/89**  
**WELL OK**  
**SEE OTHER SIDE**  
**JBH**

APPROXIMATE DIAMETER OF WELL **6** INCH  
 NEAREST INCH

METHOD OF DRILLING (circle one)  
 BORED (or Augered)  JETTED  Jetted & DRIVEN  
 AIR-ROTARY  AIR-PERCussion  ROTARY (Hydraulic Rotary)  
 CABLE  REVERSE-ROTARY  Drive-POINT  
 other \_\_\_\_\_

REPLACEMENT OR DEEPEMED WELLS (CIRCLE APPROPRIATE BOX)  
 THIS WELL WILL NOT REPLACE AN EXISTING WELL  
 THIS WELL WILL REPLACE A WELL THAT WILL BE ABANDONED AND SEALED  
 THIS WELL WILL REPLACE A WELL THAT WILL BE USED AS A STANDBY  
 THIS WELL WILL DEEPEM AN EXISTING WELL  
 PERMIT NUMBER OF WELL TO BE REPLACED OR DEEPEMED (IF AVAILABLE) \_\_\_\_\_

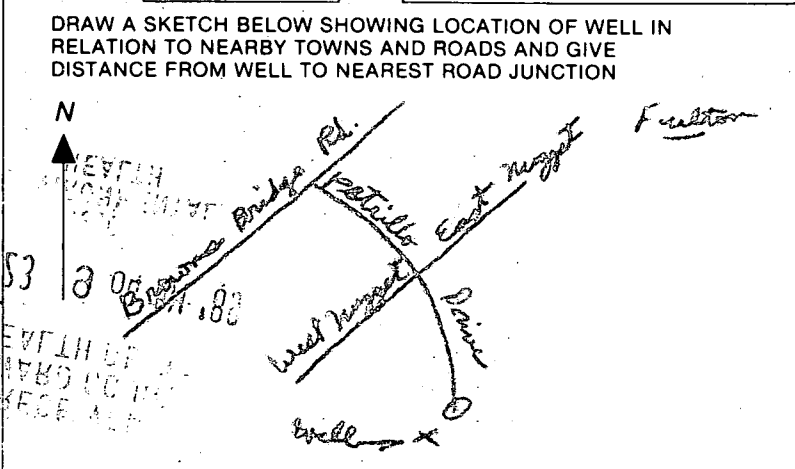

Not to be filled in by driller (OEP USE ONLY)  
 APPROP. PERMIT NUMBER \_\_\_\_\_ GAP \_\_\_\_\_  
 54 63  
 FORCE **CW** WRITE INITIALS IN BOX PERMIT No. **HO-44-0763**  
 67 68 70 71 72 73 74 75 76 77 78 79

SPECIAL CONDITIONS





1-24  
fax  
12-8-04

HOWARD COUNTY HEALTH DEPARTMENT  
BUREAU OF ENVIRONMENTAL HEALTH  
WATER AND SEWERAGE PROGRAM  
TEL: (410)313-2640 FAX: (410)313-2648

Information Form for the Installation of the Well Pump, Pitless Adapter, and Supply Piping

NOTE: The installer is responsible for requesting an inspection prior to 9 am on the day of the desired inspection. No work is to be covered until approved by the Health Department. All installations must comply with the National Standard Plumbing Code (NSPC, as amended locally) and COMAR 26.04.04 (Well Construction Regulations). Submission of a complete form is required prior to Use and Occupancy approval.

Company Name: Fogles Well Drilling Telephone #: 410-795-5670  
Address: 580 Cobcroft Rd  
Stylesville, Md 21154

(Must circle one) Licensed Plumber  Licensed Well Driller Licensed Well Pump Installer  
License # and name of individual responsible for the field installation:  
Name (Print): Allen Compton License# MSD009

\*A licensed individual must perform the actual installation. Apprentices must be under the direct supervision of a licensed journeyman or master plumber, pump installer or well driller. Licenses may be subjected to field verification.

Name of Property Owner: Douglas Homes Telephone #: \_\_\_\_\_  
Subdivision: Waterman Estates Lot #: 22 Well Tag #: HO - 88-0763  
Site Address: 12451 Petalio Dr

**Submersible Pump Data**  
Make: Grundfos  
Model #: FT75B05422  
Pump Capacity: 7 GPM  
Well Yield: GPM  
**Pitless Adapter**  
Make: Campbell  
Model #: N/A  
Depth: 36 (36" min)  
NSF approved: YES  
**Well Cap and Electric Conduit**  
Two piece watertight cap: YES  
Screened, vented well cap: YES  
Cap secured to casing: YES  
Conduit min 18" B.G.: YES

Depth of well encountered at time of pump installation: 165 (feet) 165  
If pump capacity exceeds well yield, a low water cut off switch is required by NSPC 1990 Section 17.8.  
Torque arrestors or Cable guards are required - Must circle one  
Safety rope, if used, attached to inside of well casing with eye bolt N/A

**Piping to house**  
Type: 1" Black Plastic  
PSI: 160 (160 psi min)  
Depth of supply line: 42 (36" min)  
**House Connection**  
PVC sleeved to undisturbed soil at wall penetration: YES  
Approximate length of sleeve: 5  
Sleeve caulked and sealed properly: YES

The water supply line is required to be at least ten feet from the septic tank, pump chamber, sewer piping, distribution box, drainfields, and sewage reserve area. If this cannot be accomplished, contact this office for approval prior to installation.

Signature of company representative responsible for installation: Allen Compton date: 11-2-04

For Health Department Use Only - Not to be completed by Installer

Date Insp. Requested: \_\_\_\_\_ Date Insp. Approved: 9/3/04 BB  
Inspection Data:  
Pitless adapter and water supply line at least 36" below grade   
Two piece cap installed and attached to casing securely   
Elec. conduit extends at least 18" below grade/attached to cap properly   
Safety rope installed inside of well casing   
Correct well tag attached properly and casing 8" above finished grade   
Water supply line sleeved adequately at house connection   
Adequate grout observed below pitless adapter

7/11/83

- ① 60 FT casing
- ② 38 FT open hole
- ③ 11 Bags
- ④ Got information from Johnny
- ⑤ Well OK

RECEIVED  
 HOWARD COUNTY  
 HEALTH DEPT.  
 JUL 23 9 04 AM '83  
 DIVISION OF  
 ENVIRONMENTAL  
 HEALTH

B. J. Hodger

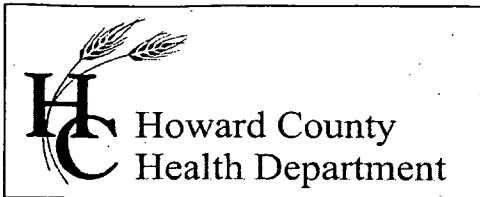

7178 Columbia Gateway Drive, Columbia Maryland 21046  
(410) 313-1771 Fax (410) 313-2648  
TDD (410) 313-2323 Toll Free 1-866-313-6300  
website: www.hchealth.org

Pennv E. Borenstein, M.D., M.P.H., Health Officer

December 21, 2004

Douglas Homes, Inc.  
P.O. Box 628  
Ellicott City, MD 21043

*240-568-0368*

RE: Waterman Estates, Lot 22  
12451 Petrillo Drive  
Highland, MD 20777  
BP #: B00147580  
Well Permit # HO-88-0763

Dear Sir:

This is to advise you that the septic system for the above referenced property has been installed and inspected. **Final approval of the septic system was granted on 09/02/2004. Final approval of the well line connection to the dwelling was approved on 09/03/2004.**

The water sample results indicate that the water samples submitted for testing were free of coliform and fecal coliform bacteria at the time of sampling and are bacteriologically safe for drinking. The water sample results were found to be in compliance with COMAR water quality standards.

#### INTERIM CERTIFICATE OF POTABILITY

This certifies that the initial sampling requirements of COMAR 26.04.04 "Well Regulations" have been met for the water supply system installed under well permit #HO-88-0763. Although the submitted sample results are in compliance with COMAR standards, the Health Department does not guarantee water supplies. Based upon satisfactory investigation and evaluation, the Howard County Health Department as authorized by the Maryland Department of the Environment accepts this well system as required by COMAR 26.04.04.

This certificate may become final upon completion of the second bacteriological test, which is to be taken by the county health department within six months of receipt of this letter. **Please contact (410) 313-1773 to schedule a final water sample appointment. Currently, there is no charge for this final sampling.**

Date of Water Samples: 12/07/2004 & 12/17/2004  
Date of Well Completion: 07/11/1989

Approving Authority,

*Brian Baker*

Brian Baker, R. S.  
Well & Septic Program

cc: Building Inspector's Office  
Community Health Services  
File