

C1 15504

SEQUENCE NO. (MDE USE ONLY)

STATE OF MARYLAND WELL COMPLETION REPORT

THIS REPORT MUST BE SUBMITTED WITHIN 45 DAYS AFTER WELL IS COMPLETED.

(THIS NUMBER IS TO BE PUNCHED IN COLS. 3-6 ON ALL CARDS)

COUNTY NUMBER

ST/CO USE ONLY DATE Received

DATE WELL COMPLETED 5-2-12

Depth of Well 600

PERMIT NO. FROM "PERMIT TO DRILL WELL" HO-95-2268

OWNER: GIANGRANDI, JUDITH; WELL SITE ADDRESS: 1600 WOODBINE Rd; TOWN: LISBON; SUBDIVISION: JAGWOOD FARM; SECTION: ; LOT: 3

WELL LOG

Table with columns: DESCRIPTION, FEET (FROM, TO), check if water bearing. Rows include Topsoil, Orange/brown rocky clay, Tan slate, Brown slate, Tan slate, Green slate, Tan slate, Green slate.

GRROUTING RECORD

WELL HAS BEEN GROUTED (Y); TYPE OF GROUTING MATERIAL: CEMENT (CM), BENTONITE CLAY (BC); NO. OF BAGS: 23; NO. OF POUNDS: 2,300; GALLONS OF WATER: 138; DEPTH OF GROUT SEAL: 0 to 57 ft.

CASING RECORD: MAIN CASING TYPE: ST (STEEL); Nominal diameter: 6; Total depth: 60.

OTHER CASING (if used): diameter, depth (feet) from to.

SCREEN RECORD: screen type or open hole: ST (STEEL); insert appropriate code below.

DEPTH (nearest ft.): 1 HO 58 600; 2 ; 3 ; 4 ; 5 ; 6 ; 7 ; 8 ; 9 ; 10 ; 11 ; 12 ; 13 ; 14 ; 15 ; 16 ; 17 ; 18 ; 19 ; 20 ; 21 ; 22 ; 23 ; 24 ; 25 ; 26 ; 27 ; 28 ; 29 ; 30 ; 31 ; 32 ; 33 ; 34 ; 35 ; 36 ; 37 ; 38 ; 39 ; 40 ; 41 ; 42 ; 43 ; 44 ; 45 ; 46 ; 47 ; 48 ; 49 ; 50 ; 51 ; 52 ; 53 ; 54 ; 55 ; 56 ; 57 ; 58 ; 59 ; 60 ; 61 ; 62 ; 63 ; 64 ; 65 ; 66 ; 67 ; 68 ; 69 ; 70 ; 71 ; 72 ; 73 ; 74 ; 75 ; 76 ; 77 ; 78 ; 79 ; 80 ; 81 ; 82 ; 83 ; 84 ; 85 ; 86 ; 87 ; 88 ; 89 ; 90 ; 91 ; 92 ; 93 ; 94 ; 95 ; 96 ; 97 ; 98 ; 99 ; 100

NUMBER OF UNSUCCESSFUL WELLS: 0; WELL HYDROFRACTURED: Y

CIRCLE APPROPRIATE LETTER: A (well abandoned), E (electric log), P (test well converted).

I HEREBY CERTIFY THAT THIS WELL HAS BEEN CONSTRUCTED IN ACCORDANCE WITH COMAR 26.04.04 "WELL CONSTRUCTION" AND IN CONFORMANCE WITH ALL CONDITIONS STATED IN THE ABOVE CAPTIONED PERMIT...

DRILLERS LIC. NO. 1: MW0040; DRILLERS SIGNATURE: George F. Estenley

LIC. NO. 1: WR0046; SIGNATURE: Frank Singleton

SITE SUPERVISOR (sign. of drifter or journeyman responsible for sitework if different from permittee)

GRAVEL PACK IF WELL DRILLED WAS FLOWING WELL INSERT F IN BOX 68

MDE USE ONLY (NOT TO BE FILLED IN BY DRILLER) T (E.R.O.S.) W Q

TELESCOPE CASING LOG INDICATOR OTHER DATA

PUMPING TEST

HOURS PUMPED (nearest hour): 6; PUMPING RATE (gal. per min.): 2.5; METHOD USED TO MEASURE PUMPING RATE: Bucket; WATER LEVEL (distance from land surface) BEFORE PUMPING: 54 ft; WHEN PUMPING: 201 ft; TYPE OF PUMP USED (for test): S (submersible)

PUMP INSTALLED

DRILLER INSTALLED PUMP (YES or NO): NO; IF DRILLER INSTALLS PUMP, THIS SECTION MUST BE COMPLETED FOR ALL WELLS; TYPE OF PUMP INSTALLED PLACE (A,C,J,P,R,S,T,O) IN BOX 29; CAPACITY: GALLONS PER MINUTE (to nearest gallon); PUMP HORSE POWER; PUMP COLUMN LENGTH (nearest ft.); CASING HEIGHT (circle appropriate box and enter casing height) above/below LAND SURFACE: 2 (nearest foot)

LATITUDE 39.335721; LONGITUDE 77.084836; (DEFAULT COORD. WGS 84); NOTES: 80' x 16' pop line woodbine Rd

C1 15504

SEQUENCE NO. (MDE USE ONLY)

STATE OF MARYLAND WELL COMPLETION REPORT

THIS REPORT MUST BE SUBMITTED WITHIN 45 DAYS AFTER WELL IS COMPLETED.

(THIS NUMBER IS TO BE PUNCHED IN COLS. 3-6 ON ALL CARDS)

FILL IN THIS FORM COMPLETELY PLEASE TYPE

COUNTY NUMBER

ST/CO USE ONLY DATE Received

DATE WELL COMPLETED

Depth of Well

PERMIT NO. FROM "PERMIT TO DRILL WELL" HO-95-2268

OWNER GIANGRANDI, JUDITH WELL SITE ADDRESS 1602 WOODBINE Rd TOWN LISBON SUBDIVISION JAGWOOD FARM SECTION LOT 3

WELL LOG

Not required for driven wells

STATE THE KIND OF FORMATIONS PENETRATED, THEIR COLOR, DEPTH, THICKNESS AND IF WATER BEARING

Table with columns: DESCRIPTION, FEET (FROM, TO), check if water bearing. Rows include Topsoil, Orange/brown rocky clay, Tan slate, Brown slate, Tan slate, Green slate, Tan slate, Green slate.

GROUTING RECORD

WELL HAS BEEN GROUTED (Y) (N) TYPE OF GROUTING MATERIAL (C) (M) (B) (C) NO. OF BAGS 23 NO. OF POUNDS 2300 GALLONS OF WATER 138 DEPTH OF GROUT SEAL 57 ft.

CASING RECORD

MAIN CASING TYPE (S) (T) (P) (L) (O) (J) Nominal diameter top (main) casing (nearest inch)! 6 Total depth of main casing (nearest foot) 60

OTHER CASING (if used)

Table for other casing with columns for diameter and depth.

SCREEN RECORD

screen type or open hole (S) (T) (B) (R) (H) (P) (L) (O) (J) (S)

DEPTH (nearest ft.)

Table for depth measurements with columns for casing types and depths.

C3

PUMPING TEST

HOURS PUMPED (nearest hour) 6 PUMPING RATE (gal. per min.) 2.5 METHOD USED TO MEASURE PUMPING RATE Bucket WATER LEVEL (distance from land surface) BEFORE PUMPING 54 ft. WHEN PUMPING 201 ft. TYPE OF PUMP USED (for test) (S) submersible

PUMP INSTALLED

DRILLER INSTALLED PUMP (YES or NO) IF DRILLER INSTALLS PUMP, THIS SECTION MUST BE COMPLETED FOR ALL WELLS. TYPE OF PUMP INSTALLED PLACE (A,C,J,P,R,S,T,O) IN BOX 29. CAPACITY: GALLONS PER MINUTE (to nearest gallon) 31 35 PUMP HORSE POWER 37 41 PUMP COLUMN LENGTH (nearest ft.) 43 47 CASING HEIGHT (circle appropriate box and enter casing height) (+) above ( ) below LAND SURFACE 2 (nearest) foot

LATITUDE 39.335721 LONGITUDE 77.084836 (DEFAULT COORD. WGS 84)

NOTES: 80' x 16' prop line woodbine Rd

NUMBER OF UNSUCCESSFUL WELLS: 0

WELL HYDROFRACTURED (Y) (N)

- CIRCLE APPROPRIATE LETTER A A WELL WAS ABANDONED AND SEALED WHEN THIS WELL WAS COMPLETED E ELECTRIC LOG OBTAINED P TEST WELL CONVERTED TO PRODUCTION WELL

I HEREBY CERTIFY THAT THIS WELL HAS BEEN CONSTRUCTED IN ACCORDANCE WITH COMAR 26.04.04 "WELL CONSTRUCTION" AND IN CONFORMANCE WITH ALL CONDITIONS STATED IN THE ABOVE CAPTIONED PERMIT, AND THAT THE INFORMATION PRESENTED HEREIN IS ACCURATE AND COMPLETE TO THE BEST OF MY KNOWLEDGE.

DRILLERS LIC. NO. 1 MW0040 George F. Estenley DRILLERS SIGNATURE (MUST MATCH SIGNATURE ON APPLICATION) LIC. NO. 1 WR0046 Frank Singleton

SITE SUPERVISOR (sign. of driller or journeyman responsible for sitework if different from permittee)

GRAVEL PACK IF WELL DRILLED WAS FLOWING WELL INSERT F IN BOX 68

MDE USE ONLY (NOT TO BE FILLED IN BY DRILLER) T (E.R.O.S.) W Q

TELESCOPE CASING LOG INDICATOR OTHER DATA

B 1 2366  
1 2 3 6

SEQUENCE NO.  
(MDE USE ONLY)

STATE OF MARYLAND  
APPLICATION FOR PERMIT TO DRILL WELL

STATE PERMIT NUMBER

W536751 please type

140-95-2268  
fill in this form completely

Date Received (APA)

03/01/12  
8 MM DD YY 13

OWNER INFORMATION 12103

Judith Giangrandi  
15 Last Name Owner First Name 34  
3886 Rosemar Drive  
36 Street or RFD 55  
Ellicott City Md 21043  
57 Town 70 State 72 Zip 76

B 3 LOCATION OF WELL

Howard  
8 COUNTY 21 CC#  
Jagwood Farm  
23 SUBDIVISION 42  
SECTION 44 46 LOT 48 50 3  
Lisbon  
52 NEAREST TOWN 71  
MILES FROM TOWN (enter 0 if in town) 2 M I  
73 76 77 78

DRILLER INFORMATION

George F. Easterday MW D 040  
76 Driller's Name 81 License No.  
L. Franklin Easterday, Inc.  
Firm Name  
9265 Brown Church Rd., MT. Airy, Md. 21771  
Address  
George F. Easterday 2/29/2012  
Signature Date

B 4

DIRECTION OF WELL FROM TOWN (CIRCLE BOX)

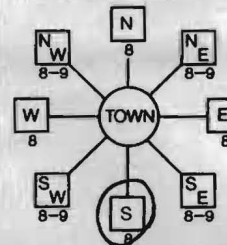

1600 Woodbine Road  
11 NEAR WHAT ROAD 30  
ON WHICH SIDE OF ROAD (CIRCLE APPROPRIATE BOX)  
NORTH  
WEST EAST  
SOUTH  
34 40037  
DISTANCE FROM ROAD Ft.  
ENTER FT OR MI 38 39  
TAX MAP: BLK: PARCEL

B 2 WELL INFORMATION  
1 2  
APPROX. PUMPING RATE 5  
(GAL. PER MIN.) 8 12  
AVERAGE DAILY QUANTITY NEEDED 500  
(GAL. PER DAY) 14 20

USE FOR WATER (CIRCLE APPROPRIATE BOX)

- DOMESTIC POTABLE SUPPLY & RESIDENTIAL IRRIGATION
- FARMING (LIVESTOCK WATERING & AGRICULTURAL IRRIGATION)
- INDUSTRIAL, COMMERCIAL, DEWATERING
- PUBLIC WATER SUPPLY WELL
- TEST, OBSERVATION, MONITORING
- GEO-THERMAL

NOT TO BE FILLED IN BY DRILLER HEALTH DEPARTMENT APPROVAL

Howard 13  
COUNTY NAME COUNTY NO.  
STATE SIGNATURE INSERT S  
DATE ISSUED 3/21/12 3/21/13  
43 MM DD YY 48 CO SIGNATURE EXP DATE  
NORTH GRID N/A 000 EAST GRID N/A 000  
50 55 57 63

APPROXIMATE DEPTH OF WELL 300 FEET  
24 28

APPROXIMATE DIAMETER OF WELL 6 INCH NEAREST INCH

METHOD OF DRILLING (circle one)

BORED (or Augered) JETTED Jetted & DRIVEN  
30 AIR-ROTary AIR-PERcussion ROTARY (Hydraulic Rotary)  
57 CABLE REVerse-ROTary DRive-POINT  
other

REPLACEMENT OR DEEPEINED WELLS (CIRCLE APPROPRIATE BOX)

- THIS WELL WILL NOT REPLACE AN EXISTING WELL
- THIS WELL WILL REPLACE A WELL THAT WILL BE ABANDONED AND SEALED
- THIS WELL WILL REPLACE A WELL THAT WILL BE USED AS A STANDBY-CONTACT LOCAL APPROVING AUTHORITY FOR POLICY ON STANDBY WELLS
- THIS WELL WILL DEEPEIN AN EXISTING WELL

PERMIT NUMBER OF WELL TO BE REPLACED OR DEEPEINED (IF AVAILABLE) 41 52

Not to be filled in by driller (MDE OR COUNTY USE ONLY)

APPROP. PERMIT NUMBER G  
PERMIT No. 140-95-2268  
70 71 72 73 74 75 76 77 78 79

SHOW MAJOR FEATURES OF BOX & LOCATE WELL WITH AN X

SOURCES OF DRILLING WATER

- 1. wells
- 2.
- 3.

WRITE THE BOX NUMBER FROM THE MAP HERE

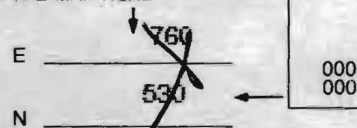

DRAW A SKETCH BELOW SHOWING LOCATION OF WELL IN RELATION TO NEARBY TOWNS AND ROADS AND GIVE DISTANCE FROM WELL TO NEAREST ROAD JUNCTION

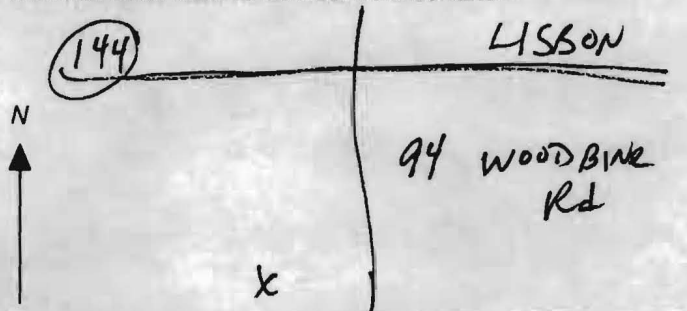

SPECIAL CONDITIONS

NOTE - APPROVING AUTHORITIES SHOULD USE SEPARATE SHEET IF NEEDED

**B 1** 1 2 3 6  
 2366 SEQUENCE NO. (MDE USE ONLY)  
 STATE OF MARYLAND  
 APPLICATION FOR PERMIT TO DRILL WELL  
 W536751 please type  
 STATE PERMIT NUMBER  
 40-95-2268  
 fill in this form completely

**OWNER INFORMATION** 12103  
 Date Received (ARA) 05/01/12  
 8 MM DD YY 13  
 Judith Giangrandi  
 15. Last Name Owner First Name 34  
 3886 Rosemar Drive  
 36 Street or RFD 55  
 Ellicott City Md 21043  
 57 Town 70 State 72 Zip 76

**LOCATION OF WELL**  
 B 3  
 8 COUNTY Howard 21 CC#  
 Jagwood Farm  
 23 SUBDIVISION 42  
 SECTION 44 46 LOT 48 50  
 Lisbon  
 52 NEAREST TOWN 71  
 MILES FROM TOWN (enter 0 if in town) 2 M I  
 73 76 77 78

**DRILLER INFORMATION**  
 George F. Easterday MW D 040  
 Driller's Name 76 License No. 81  
 L. Franklin Easterday, Inc.  
 Firm Name  
 9265 Brown Church Rd., MT. Airy, Md. 21771  
 Address  
 Signature: George F. Easterday Date: 2/29/2012

**B 4**  
 1 2  
 DIRECTION OF WELL FROM TOWN (CIRCLE BOX)  
 ON WHICH SIDE OF ROAD (CIRCLE APPROPRIATE BOX)  
 1600 Woodbine Road  
 11 NEAR WHAT ROAD 30  
 NORTH  
 WEST EAST  
 SOUTH  
 34 400 37  
 DISTANCE FROM ROAD  
 ENTER FT OR MI 38 39  
 TAX MAP: \_\_\_\_\_ BLK: \_\_\_\_\_ PARCEL \_\_\_\_\_

**WELL INFORMATION**  
 B 2  
 1 2  
 APPROX. PUMPING RATE (GAL. PER MIN.) 5  
 8 12  
 AVERAGE DAILY QUANTITY NEEDED (GAL. PER DAY) 500  
 14 20

**USE FOR WATER** (CIRCLE APPROPRIATE BOX)  
 DOMESTIC POTABLE SUPPLY & RESIDENTIAL IRRIGATION  
 FARMING (LIVESTOCK WATERING & AGRICULTURAL IRRIGATION)  
 INDUSTRIAL, COMMERCIAL, DEWATERING  
 PUBLIC WATER SUPPLY WELL  
 TEST, OBSERVATION, MONITORING  
 GEO-THERMAL

**NOT TO BE FILLED IN BY DRILLER HEALTH DEPARTMENT APPROVAL**  
 Howard (13)  
 COUNTY NAME COUNTY NO.  
 STATE SIGNATURE INSERT S →  
 DATE ISSUED 3/21/12  
 43 MM DD YY 48 CO SIGNATURE EXP. DATE 3/21/13  
 NORTH GRID 50 000 EAST GRID 57 000  
 55 63

APPROXIMATE DEPTH OF WELL 300 FEET  
 24 28

APPROXIMATE DIAMETER OF WELL 6 INCH  
 NEAREST INCH

**METHOD OF DRILLING** (circle one)  
 BORED (or Augered) JETTED Jetted & DRIVEN  
 30 AIR-ROTARY AIR-PERCussion ROTARY (Hydraulic Rotary)  
 17 CABLE REVerse-ROTary DRive-POINT  
 other \_\_\_\_\_

SHOW MAJOR FEATURES OF BOX & LOCATE WELL WITH AN X  
 SOURCES OF DRILLING WATER  
 1. wells  
 2.  
 3.  
 WRITE THE BOX NUMBER FROM THE MAP HERE 1600 Wood  
 E 760  
 N 530  
 000  
 000

**REPLACEMENT OR DEEPEMED WELLS** (CIRCLE APPROPRIATE BOX)  
 THIS WELL WILL NOT REPLACE AN EXISTING WELL  
 THIS WELL WILL REPLACE A WELL THAT WILL BE ABANDONED AND SEALED  
 THIS WELL WILL REPLACE A WELL THAT WILL BE USED AS A STANDBY-CONTACT LOCAL APPROVING AUTHORITY FOR POLICY ON STANDBY WELLS  
 THIS WELL WILL DEEPEMED AN EXISTING WELL  
 PERMIT NUMBER OF WELL TO BE REPLACED OR DEEPEMED (IF AVAILABLE) 41 \_\_\_\_\_ 52

DRAW A SKETCH BELOW SHOWING LOCATION OF WELL IN RELATION TO NEARBY TOWNS AND ROADS AND GIVE DISTANCE FROM WELL TO NEAREST ROAD JUNCTION 4691H7  
 (144) LISBON  
 94 Woodbine Rd  
 N  
 X

**Not to be filled in by driller (MDE OR COUNTY USE ONLY)**  
 APPROP. PERMIT NUMBER \_\_\_\_\_ G \_\_\_\_\_  
 PERMIT No. 40-95-2268  
 70 71 72 73 74 75 76 77 78 79

8:00 5-2-12

Page      of       
Date 5-2-12

Review                     

FIELD DATA SHEET  
HYDROGEOLOGIC AREA (3) WELL YIELD TEST

Maryland Well Permit No. HO-95-2268 Election District                     

Location of Property (road) 1600 WOODBINE ROAD

Subdivision                      Lot              Block              Plat              Sec.             

Well Driller EASTERN Day Owner JUDY GIANC RANDI

Depth of Well 600 16PM

Distance of Measuring Point (M.P.) above ground 2 ft

Static Water Level (S.W.L.) below M.P. 54.2

I. High Rate Pumping -- reservoir drawdown

Time pump started 7:50 AM Pumping rate 206 gpm

Total time 25 to reach pumping water level 201 ft. below M.P.

II. Recovery pump test data - observations to be recorded every 15 minutes.

TIME	WATER LEVEL Below M.P.	PUMPING RATE Time to fill <u>one</u> gal. bucket	<del>Flow Meter Reading</del> <u>Pump SET</u> (if used)	CALCULATED FLOW (gallons per min.)
8:15	201 FT	24 sec	480 FT	2.5
8:30	201 FT	24 sec		2.5
8:45	201 FT	24 sec		2.5
9:00	201 FT	24 sec		2.5
9:15	201 FT	24 sec		2.5
9:30	201 FT	24 sec		2.5
9:45	201 FT	24 sec		2.5
10:00	201 FT	24 sec		2.5
10:15	201 FT	24 sec		2.5
10:30	201 FT	24 sec		2.5
10:45	201 FT	24 sec		2.5
11:00	201 FT	24 sec		2.5
11:15	201 FT	24 sec		2.5
11:30	201 FT	24 sec		2.5
11:45	201 FT	24 sec		2.5
12:00	201 FT	24 sec		2.5
12:15	201 FT	24 sec		2.5
12:30	201 FT	24 sec		2.5
12:45	201 FT	24 sec		2.5
1:00	201 FT	24 sec		2.5
1:15	201 FT	24 sec		2.5
1:30	201 FT	24 sec		2.5
1:45	201 FT	24 sec		2.5
2:00	201 FT	24 sec		2.5
2:15	201 FT	24 sec	480 FT	2.5

Tested By Dickie



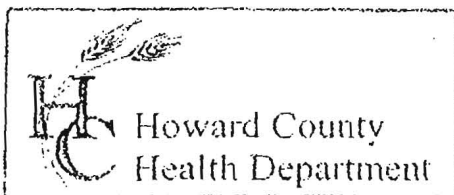

3525 H Ellicott Mills Drive, Ellicott City, MD 21043  
(410) 313-2640 Fax (410) 313-2648  
TDD (410) 313-2323 Toll Free 1-866-313-6300  
website: www.hchealth.org

Penny E. Borenstein, M.D., M.P.H., Health Officer

### TO ALL INTERESTED PARTIES

When submitting a well permit application for a proposed well for new construction, please indicate one of the following:

- The well site has been staked by VOGEL ENGINEERING,  
(professional land surveyor or company employing professional land surveyors)  
on 2-24-12 (date) and does not require a site inspection.
- The well driller, builder or property owner will call the Health Department to schedule a time to meet in the field to verify the proposed well site location.

This sheet, along with two copies of an acceptable well site plan, must be attached to the green well permit application.

Revised 6/10/03

1600 WOODBINE RD