

# APPLICATION

PERCOLATION TESTING

A 40709

P \_\_\_\_\_

HOWARD COUNTY HEALTH DEPARTMENT  
BUREAU OF ENVIRONMENTAL HEALTH  
P.O. BOX 476 ELLICOTT CITY, MARYLAND 21043  
TELEPHONE: 461-9933

DISTRICT 5th

DATE 12/1/87

TO: THE COUNTY HEALTH OFFICER  
ELLICOTT CITY, MARYLAND

I, HEREBY, APPLY FOR THE NECESSARY TEST IN ORDER TO CONSTRUCT (OR RECONSTRUCT) A SEWAGE DISPOSAL SYSTEM.

PROPERTY OWNER Winchester Homes, Inc. Real Estate Development Group ✓

ADDRESS 6301 Ivy Lane Greenbelt, MD 20770 PHONE 301-220-1117

PROSPECTIVE BUYER N/A

ADDRESS N/A PHONE \_\_\_\_\_

PROPERTY LOCATION:

SUBDIVISION Ashleigh Greene Section I LOT NO. 2

ROAD AND DESCRIPTION Intersection Hall Shop Road & Simpson Road 6994 Westcott Lane

TAX MAP 41 PARCEL # 139

SIZE OF LOT 3.0 AC TYPE BLDG Single Family  
(SINGLE FAMILY DWELLING OR COMMERCIAL)

THE SYSTEM INSTALLED UNDER THIS APPLICATION IS ACCEPTABLE ONLY UNTIL PUBLIC FACILITIES BECOME AVAILABLE. I FULLY UNDERSTAND THE FEE CONNECTED WITH THE FILING OF THIS PERC TEST APPLICATION IS NON-REFUNDABLE UNDER ANY CIRCUMSTANCES. I ALSO AGREE TO COMPLY WITH ALL M.O.S.H.A. REQUIREMENTS IN TESTING THIS LOT.

Burley G. Hamblee  
(SIGNATURE OF APPLICANT)

APPROVED BY Sid Muhl FOR Deputy DATE 3-10-89

REJECTED BY \_\_\_\_\_ FOR \_\_\_\_\_ DATE \_\_\_\_\_

HOLD PENDING FURTHER TESTS \_\_\_\_\_ DATE \_\_\_\_\_

REASONS FOR REJECTION OR HOLDING 2-17-88 Pending subdivision plat approval and  
perc hole locations JEN

BUDG. PERMIT SIGNED  
AND RETURNED 3-29-89

B.P. 200038

## THIS IS NOT A PERMIT

High 4  
Low 2

# Westcott Place

Lot 2

①  
SOIL PROFILE

0-4.0 Rd-br  
Sandy  
si clay  
4-12 Rd-br  
micaceous  
sa silty  
loam  
12.0 Bottom

②

0-5.0 Br si cl  
loam  
5-12.0 Red-brown  
micaceous  
sa silty  
12.0 Bottom

③

0-5 Rd-br si  
sa silty  
5-12.0 Rd-br  
sa silty  
12.0 Bottom

④

0-6.0 Rd-br si  
cl  
6.0-12.5 Rd-br  
mica  
sa silty  
12.5 Bottom

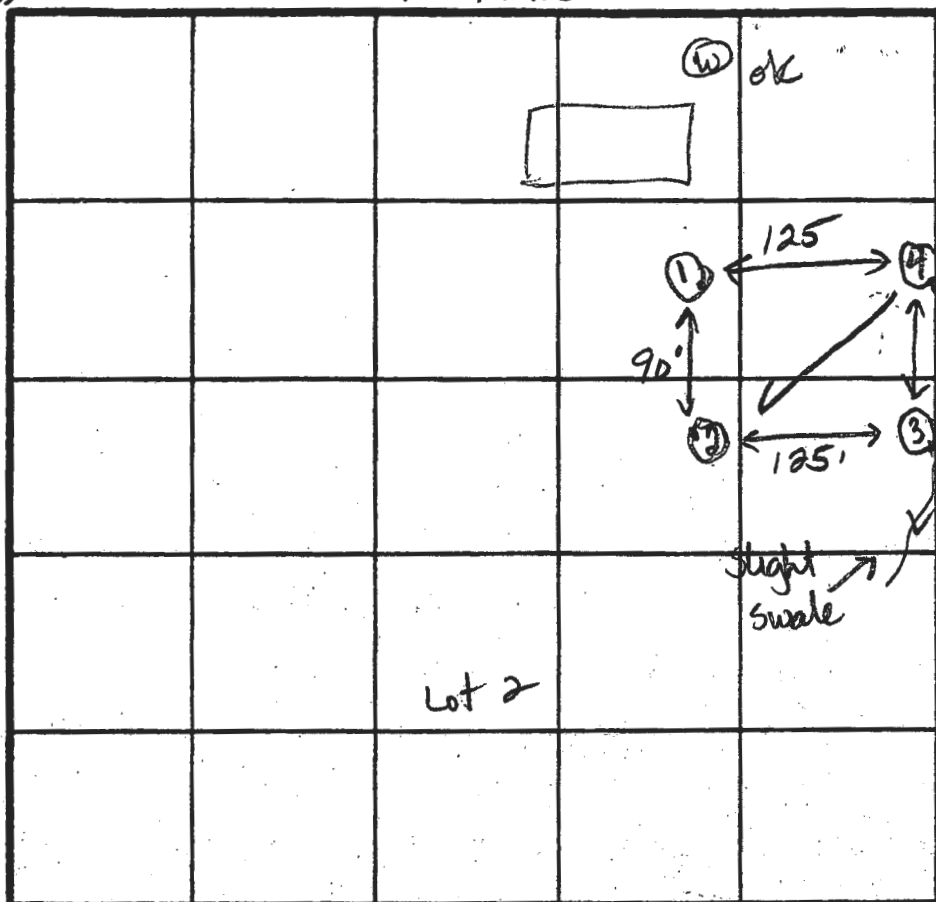

Lot 1

$\bar{x} = 5 \text{ min}$   
Inlet 4.0 ft  
Bottom 8.0 ft  
1180 sq. ft. / bdrm

INDICATE NORTH - NAME ADJOINING ROADWAY AS BASE LINE.

Hall Shop Road

DATE	TEST NO.	DEPTH	PRE-WET		TEST - 1" DROP		TIME
			START	STOP	START	STOP	
2-17-88	1	6.5 S	11:28	11:32	11:32	11:36	4
		12.0 D	Bottom (see profile)				
	2	6.0 S	11:29	11:36	11:36	11:40	4
		12.0 D	Bottom (see profile)				
	see Lot 1 3	4.0 S	11:16	11:19	11:19	11:23	4 min
	5	4.5 D	Bottom				11 min
	see Lot 1 4	4.5 S	11:22	11:26	11:26	11:37	11 min
		7.5 M	11:23	11:25	11:25	11:27	2 min
✓		12.5 D	Bottom				

REMARKS All holes moved from plat locations.

TYPE OF SOIL 0-4 Rd-br sa silty cl, 4-12 Rd-br mica sa silty loam

TESTED BY J E Nadeau ALSO PRESENT Jack F, Skippy