

3/28/72
Ready

File Final

PERMIT

SEWAGE DISPOSAL SYSTEM

MARYLAND STATE DEPARTMENT OF HEALTH

HOWARD COUNTY

INDEXED

P 16803

A 16389

ELLICOTT CITY

DISTRICT 3

DATE 2/15/72

Jack Fyock

IS PERMITTED TO INSTALL X ALTER

ADDRESS Ten Oaks Road, Glenelg, Md. PHONE 286-2939

A SEWAGE DISPOSAL SYSTEM LOCATED AT

SUBDIVISION ROAD Triadelphia Rd. (See LOT

Appl. for clearer directions)

PROPERTY OWNER Albert V. Kappes & Wife (Jr.)

ADDRESS

SPECIFICATIONS 3 Bedrooms

DRAIN FIELD DEPTH FEET, BOTTOM AREA SQ. FT.

SEEPAGE PITS ABSORBENT SIDE-WALL AREA SQ. FT.

SEPTIC TANK CAPACITY 1,000 GALLONS

FOR GARBAGE GRINDER, INCREASE DISPOSAL AREA 22% & TANK CAPACITY 50%.

OTHER Dry Well - 340 sq. ft. sidewall area below the inlet. Dry well inlet to be 6 ft. below grade and bottom of dry well to be no deeper than 12 ft. below grade. Place the dry well 223 ft. from the back of existing house and 56 ft. from the fence which runs along the right side of the lot as seen when facing the lot from Triadelphia Rd.

NOTE: ALL PIPE FROM HOUSE TO SEPTIC TANK MUST BE CAST IRON.

PERMIT AFTER THREE YEARS.

NOTE: INSTALL STAND PIPE ON SEPTIC TANK AND DRY WELL.

PLANS APPROVED BY Raymond Hodges DATE 2/15/72

FILL SEPTIC TANK AND DISTRIBUTION BOX WITH WATER BEFORE CALLING FOR AN INSPECTION. COVER NO WORK UNTIL INSPECTED AND APPROVED.

NEITHER THE HOWARD COUNTY COMMISSIONERS NOR THE HEALTH DEPARTMENT IS RESPONSIBLE FOR THE SUCCESSFUL OPERATION OF ANY SYSTEM.

A 16389

Unit 7

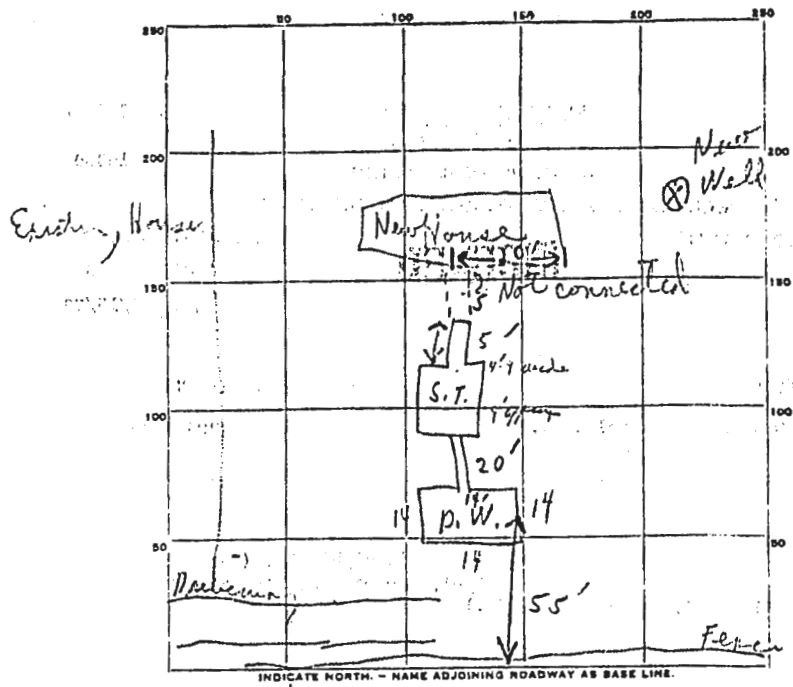

PERMIT CARD Sealed
 SEPTIC TANK, LEVEL OK ST OK P.W. OK
 DISTRIBUTION BOX, LEVEL _____
 TILE FIELD, DEPTH _____ FT. TRENCH WIDTH _____ FT.
 GRAVEL DEPTH _____ IN. TOTAL LENGTH _____ FT.
 NUMBER OF TRENCHES _____ TOTAL BOTTOM AREA _____
 OUTSIDE PERIMETER 56 FT. DEPTH BELOW INLET 7 FT.
 SEEPAGE PITS, INSIDE DIAMETER _____
 ABSORBENT AREA 392 SQ. FT.

$11\frac{1}{2}$
 $4\frac{1}{2}$
7'

56
7
392

REMARKS 3/28/72 cut new pipe 5' from Septic Tank
not connected to house.

DATE SYSTEM APPROVED 3/28/72 INSPECTOR C. J. Tucker

