

PUB. SEWER STATUS VERIFIED BY \_\_\_\_\_

ISSUE DATE: 9/25/06

P 526573

# PERMIT

APPROVAL DATE: 9/20/06

A UPGRADE

Tax ID # \_\_\_\_\_

## ON-SITE SEWAGE DISPOSAL SYSTEM HOWARD COUNTY HEALTH DEPARTMENT BUREAU OF ENVIRONMENTAL HEALTH

J A Smith IS PERMITTED TO INSTALL  ALTER

ADDRESS: 7080 KIT KAT Rd, ELKRIDGE PHONE NUMBER: 410-796-7532

SUBDIVISION: \_\_\_\_\_ LOT NUMBER: \_\_\_\_\_

ADDRESS: 5620 Trotter Road PROPERTY OWNER: Alan Donaldson

SEPTIC TANK CAPACITY (GALLONS): 250 500

PUMP CHAMBER CAPACITY (GALLONS): \_\_\_\_\_

NUMBER OF BEDROOMS: \_\_\_\_\_

SQUARE FEET PER BEDROOM: \_\_\_\_\_

LINEAR FEET OF TRENCH REQUIRED: \_\_\_\_\_

TRENCHES:	Trench to be _____ feet wide. Inlet _____ feet below original grade. Bottom maximum depth _____ feet below original grade. Effective area begins at _____ feet below original grade. _____ feet of stone below distribution pipe.
LOCATION:	_____
PURPOSE:	Additional septic tank to be added. This is in support of Building Permit B06003229. Call for inspection when ground is opened so sanitarian can recommend repair.

PLANS APPROVED: \_\_\_\_\_ DATE: \_\_\_\_\_

- NOTE: PERMIT VOID AFTER 2 YEARS
- NOTE: CONTRACTOR RESPONSIBLE FOR SCHEDULING A PRE-CONSTRUCTION INSPECTION FOR ALL INSTALLATIONS
- NOTE: WATERTIGHT SEPTIC TANKS REQUIRED
- NOTE: ALL PARTS OF SEPTIC SYSTEM SHALL BE 100 FEET FROM ANY WATER WELL
- NOTE: MANHOLE RISERS REQUIRED ON ALL SEPTIC TANKS AND PUMP CHAMBERS

**NEITHER THE HOWARD COUNTY COUNCIL OR THE HEALTH DEPARTMENT IS RESPONSIBLE FOR THE SUCCESSFUL OPERATION OF ANY SYSTEM PERMITTEE RESPONSIBLE FOR OBTAINING FINAL APPROVAL ON THIS PERMIT CALL 410-313-2640 FOR INSPECTION OF SEPTIC SYSTEM**

ex well

NOT TO SCALE

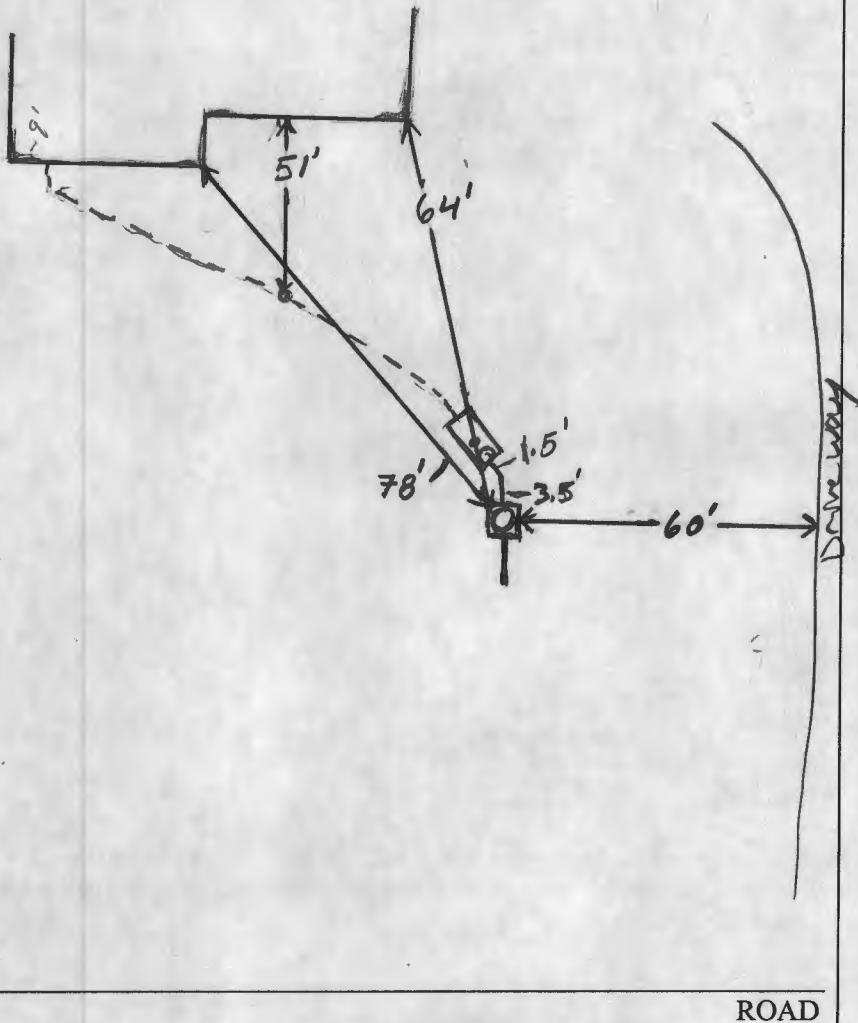

TRENCH/DRAINFIELD DATA		
WIDTH	INLET	BOTTOM
_____	_____	_____
NUMBER OF TRENCHES _____		
TOTAL LENGTH _____		
ABSORPTION AREA _____		
DISTRIBUTION BOX LEVEL _____		
DISTRIBUTION BOX BAFFLE _____		
DISTRIBUTION BOX PORT _____		

SEPTIC TANK DATA	
SEPTIC TANK 1 LEVEL	<u>Yes</u>
CAPACITY	<u>1000</u> GAL
SEAM LOC	<u>mid</u>
TANK LID DEPTH	<u>5.5'</u>
BAFFLES	<u>?</u>
BAFFLE FILTER	<u>?</u>
MANHOLE LOC	<u>Rear</u>
6" PORT LOC	<u>Center</u>
WATERTIGHT TEST	<u>NA</u>
SEPTIC TANK 2 LEVEL	<u>Level</u>
CAPACITY	<u>500</u> GAL
SEAM LOC	<u>Top</u>
TANK LID DEPTH	<u>6.6'</u>
BAFFLES	<u>Yes</u>
BAFFLE FILTER	<u>NO</u>
MANHOLE LOC	<u>Center</u>
6" PORT LOC	<u>None</u>
WATERTIGHT TEST	<u>NA</u>

mayer bro's

PRE-CONSTRUCTION \_\_\_\_\_

INSTALLATION 9/20/06 7500 gallon mayer bro's tanks installed  
O.K. Meets all setbacks. Plumbing O.K. Tanks set 6.6'  
deep with very large diameter cement rber. O.K. to  
Backfill (KW)

FINAL INSPECTOR [Signature] DATE OF APPROVAL 9/20/06

