

8/28/96
9:00

APPLICATION

PERCOLATION TESTING

A _____
P 57071

HOWARD COUNTY HEALTH DEPARTMENT
BUREAU OF ENVIRONMENTAL HEALTH
3525-H ELLICOTT MILLS DRIVE/ELLICOTT CITY, MARYLAND 21043
TELEPHONE: 313-2640

*PREVIEW OK
PROPERTY IS SEALED
BY PUBLIC WATER
NEW LOT TO BE SEALED
BY PUBLIC SEWER
RESIDUE W/ EXISTING HOUSE
TO BE PERC'D TO
REMAIN ON
PRIVATE SEPTIC*

DISTRICT _____
DATE 8/13/96

TO: THE COUNTY HEALTH OFFICER
ELLICOTT CITY, MARYLAND

I HEREBY APPLY FOR THE NECESSARY TEST PRIOR TO APPLICATION FOR PERMIT TO CONSTRUCT (OR RECONSTRUCT) A SEWAGE DISPOSAL SYSTEM.

PROPERTY OWNER Norwood Richard Hudson

ADDRESS 15866 Frederick Rd. PHONE 410-442-5814

AGENT OR PROSPECTIVE BUYER _____

ADDRESS _____ PHONE _____

PROPERTY LOCATION:

SUBDIVISION 5605 Waterloo Rd. LOT NO. _____

ROAD AND DESCRIPTION _____

TAX MAP _____ PARCEL # _____

SIZE OF LOT 3 acres TYPE BLDG. Single Family
(SINGLE FAMILY DWELLING OR COMMERCIAL)

THE SYSTEM INSTALLED UNDER THIS APPLICATION IS ACCEPTABLE ONLY UNTIL PUBLIC FACILITIES BECOME AVAILABLE. I FULLY UNDERSTAND THE FEE CONNECTED WITH THE FILING OF THIS PERC TEST APPLICATION IS NON-REFUNDABLE UNDER ANY CIRCUMSTANCES. I ALSO AGREE TO COMPLY WITH ALL M.O.S.H.A. REQUIREMENTS IN TESTING THIS LOT. Norwood Richard Hudson
(SIGNATURE OF APPLICANT)

APPROVED BY _____ FOR _____ DATE _____

DISAPPROVED BY _____ FOR _____ DATE _____

HOLD PENDING FURTHER TESTS _____

REASONS FOR REJECTION OR HOLDING _____

PERCOLATION TEST PLAT/PRELIMINARY PLAT - TITLE OR I.D. # _____ DATE _____

SITE DEVELOPMENT PLAN/FINAL PLAT - TITLE OR I.D. # _____ DATE _____

THIS IS NOT A PERMIT

codales

COUNTY #

SOIL PROFILE

0' 1
 dark brown silty
 4.0 mottled silty
 grey mottles
 greenish matrix
 color water @ 7.0
 8.0

WATER TABLE

2
 dark red brn silty
 2.0 mottled silty
 grey mottles
 greenish grey matrix
 color H₂O @ 5.0

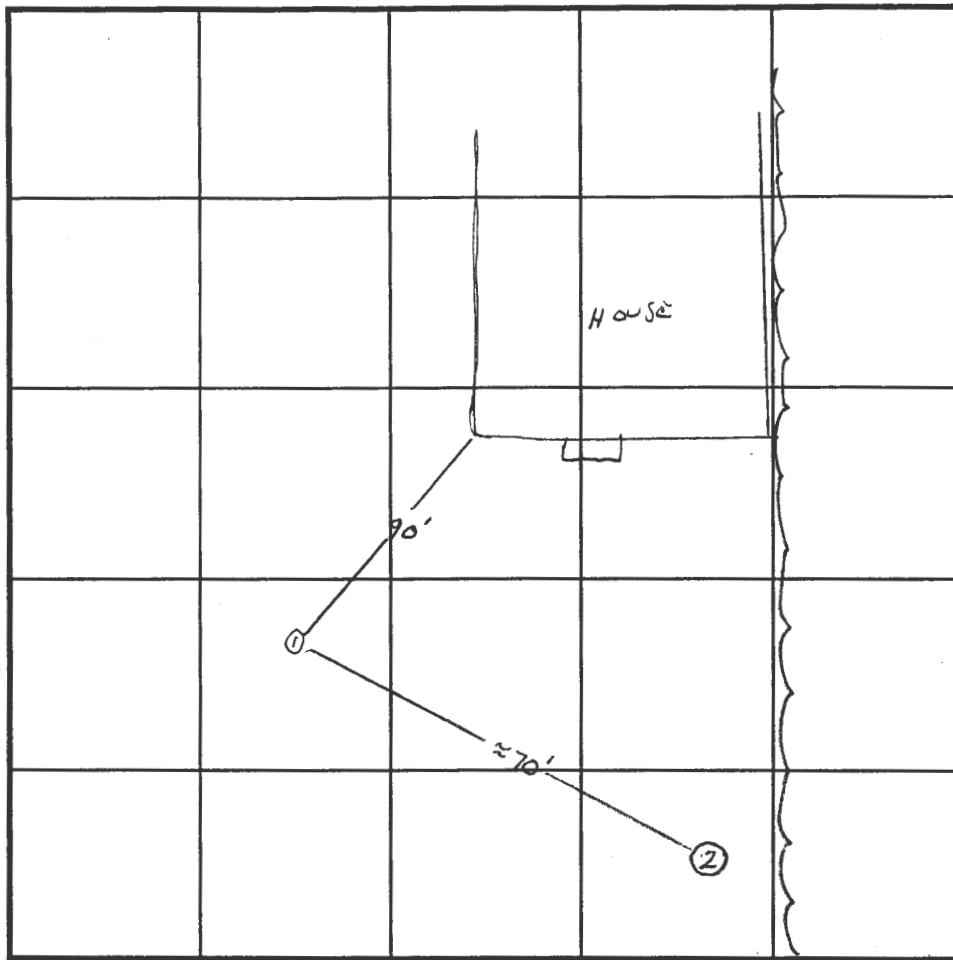

SOIL PROFILE

0'

INDICATE NORTH - NAME ADJOINING ROADWAY AS BASE LINE.
 MONTEDMERY RUN

DATE	TEST NO.	DEPTH	PRE-WET		TEST - 1" DROP		TIME
			START	STOP	START	STOP	
8/29/96	1	See profile - insufficient depth to water table					F
	2	See profile - insufficient depth to water table					F

REMARKS Due to insufficient depth to H₂O; limited site conditions, it would appear that there is not enough area for a 10,000 ft² septic easement.

TYPE OF SOIL _____
 TESTED BY G. SAVAGE / Amy McMillen ALSO PRESENT OWNER
 TRENCH DESIGN DATA: AVERAGE PERCOLATION TIME _____ TRENCH WIDTH _____
 INLET DEPTH _____ MAXIMUM BOTTOM DEPTH _____ SQ. FT./BEDROOM _____



HOWARD COUNTY HEALTH DEPARTMENT

Joyce M. Boyd, M.D., County Health Officer
August 14, 1996

Mr. and Mrs. Norwood R. Hudson
15866 Frederick Road
Lisbon, Maryland 21765

RE: Percolation Testing-Receipt Number: P57071
Proposed 2 Lot Subdivision
(Existing Lot To Remain On Private Septic)
5605 Waterloo Road
Tax Map: 31 Grid: 19 Parcel: 494

Dear Mr. and Mrs. Hudson:

A percolation test date has been reserved for 9:00 a.m., ^{THURS} ~~Wednesday~~, August ²⁹ ~~28~~, 1996.

A two lot subdivision is proposed in the Metropolitan Public Service District. The new lot is proposed for connection to the public sewer. The residue with the existing house is proposed to remain on private septic because of difficulties of access to the public sewer.

The applicant is advised to remain apprised of the policies of the Office of Planning and Zoning on this issue. Acceptance of this proposal by the Health Department is not an indication of acceptance by other agencies.

You will be responsible for having a contractor on-site to excavate test holes at the corners of proposed percolation area.

Please call this office between 8:00 a.m. and 5:00 p.m., Monday through Friday, to confirm your acceptance of this percolation test date.

Thank you for your cooperation in this matter.

Very truly yours,

Craig Williams, Program Director
Water and Sewerage Program

CW:jr
cc: Fisher, Collins and Carter, Inc.
Department of Planning and Zoning
File ✓

8/29/96

The following comments/suggestions were made to the owner on the perc date

- due to limited site conditions it would appear that insufficient area exists for a 10,000 ft² area.
- while they do have the option to test the high portion of the lot soils info provided on the perc plan suggest that this area may not pass either, Due to insufficient depth to H₂O table

I advised him that by testing the high portion of the lot, he would need wet season testing to confirm actual H₂O table elevations.

Based upon the above and the fact that MR Hudson is on a short time table, I advised him that hooking up to public ~~the~~ sewer would be his best option.

Amy McMelle
8/29/96

SOILS LEGEND		
SOIL	NAME	CLASS
AgC2	Aura gravelly loam, 5 to 10 percent slopes, moderately eroded	
AgE3	Aura gravelly loam, 10 to 30 percent slopes, severely eroded	B
CmB2	Chillum silt loam, 1 to 5 percent slopes, moderately eroded	C
* CuB	Cornus silt loam, local alluvium, 3 to 8 percent slopes	B
* luB	luka loam, local alluvium, 1 to 5 percent slopes	C
SuB2	Sunnyside fine sandy loam, 1 to 5 percent slopes, moderately eroded	B

NOTES:
 * Hydric soils and/or contains hydric inclusions
 ** May contain hydric inclusions
 † Generally only within 100-year floodplain areas

A49372

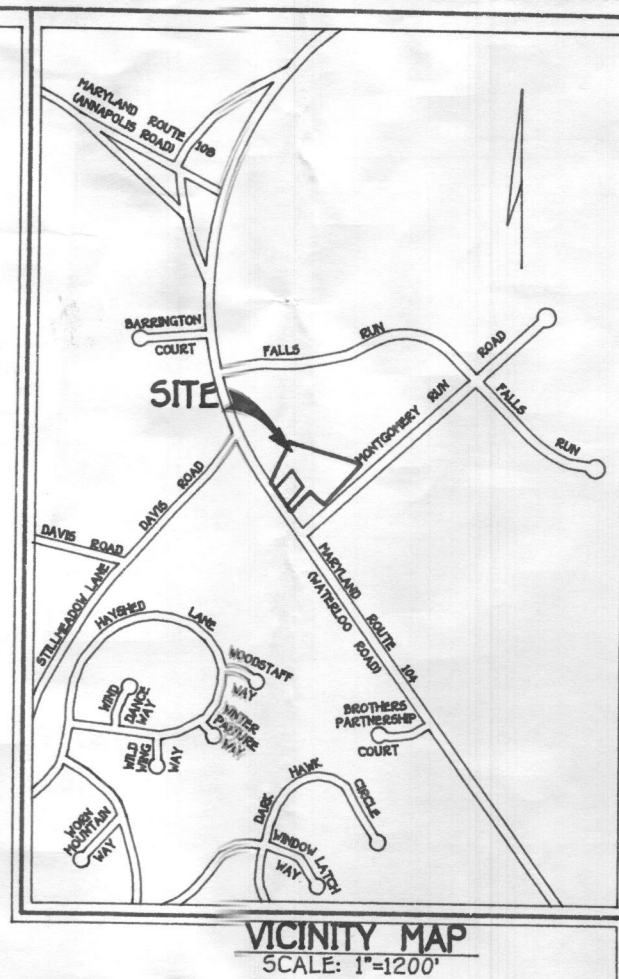

- GENERAL NOTES**
- SUBJECT PROPERTY ZONED R-20 PER 10/10/94 COMPREHENSIVE ZONING PLAN.
 - TOTAL TRACT AREA = 3120 AC.
 - NUMBER OF PROPOSED LOTS = 2
 - TOTAL AREA OF PROPOSED LOTS = 1540 AC.
 - PUBLIC WATER AND PUBLIC SEWER TO BE UTILIZED.
 - SOILS MAP No. _____
 - FIELD RUN TOPOGRAPHY PROVIDED BY FISHER, COLLINS & CARTER, INC. ON OR ABOUT JUNE, 1994.
 - EXISTING DWELLING ON LOT NO. 1 TO REMAIN.



SERVICE TO PROPOSED NEW LOT IS NOT A PROBLEM BUT, ENGINEER REPORTS SEWER ACCESS IS APPROXIMATELY 500' DEPENDING ROUTE OF ACCESS. APPLICANT REPORTS THAT HIS SELECTED PLUMBER DECLINED THE JOB DUE TO DIFFICULTIES OF ACCESS.

∴ PROPOSE TO EVALUATE EXISTING RESIDENCE FOR SEWAGE CAPACITY IS ACCEPTABLE TO HEALTH DEPARTMENT.

SU SOIL SERIES IS UNKNOWN AND MOST LIKELY SC TO SERIES IS PRESUMED TO BE MISLOCATED TOPOGRAPHIC POSITION WOULD SUGGEST THIS SOIL TYPE TO BE ≈ 150' CLOSER TO FRONT OF LOT,

EITHER WAY - EXCEPTIONALLY WET SUMMER PROVIDES CONDITIONS SUFFICIENT FOR WET SEASON ASSESSMENT OF THIS EXISTING PARCEL.

APPLICANT TO ATTEMPT TO EXCAVATE TEST HOLES WITH HIS OWN BACKHOE - MAXIMUM REACH OF 7' TEST HOLES TO BE RAMPED & SHOULD TO ALLOW ADDITIONAL EXCAVATION BY SHOULDER AUGER AS NECESSARY.

8/13/96 CW

Developer's Builder's Certificate
 I/we certify that the landscaping shown on this plan will be done according to this plan, Section 16.224 of the Howard County Code and the Howard County Landscape Manual. I/we further certify that upon completion of Certification of Landscape Installation accompanied by an executed one year guarantee of plant materials will be submitted to the Department of Planning and Zoning.

Name _____ Date _____

A49372

LANDSCAPING, TOPOGRAPHIC and SOILS PLAN

LOTS 1 AND 2
HUDSON PROPERTY
 ZONED R-20

TAX MAP 31 PARCEL 494 GRID 19
 FIRST ELECTION DISTRICT
 HOWARD COUNTY, MARYLAND
 AUGUST 7, 1996
 SHEET 1 OF 1

Scale: 1" = 50'
 SHEET 1 OF 1

OWNER AND DEVELOPER
 MR. & MRS. RICHARD HUDSON
 15966 FREDERICK ROAD
 LISBON, MARYLAND 21765

FISHER, COLLINS & CARTER, INC.
 CIVIL ENGINEERING CONSULTANTS & LAND SURVEYORS
 CENTRAL SQUARE OFFICE PARK - 10272 BALTIMORE NATIONAL FREE
 ELLICOTT CITY, MARYLAND 21114
 4102 401-2885