

Search Result for HOWARD COUNTY

View Map			View GroundRent Redemption			View GroundRent Registration			
Tax Exempt:			Special Tax Recapture:						
Exempt Class:			NONE						
Account Identifier:			District - 03 Account Number - 282082						
Owner Information									
Owner Name:			CICHETTI DANIEL J & WF				Use:		RESIDENTIAL
Mailing Address:			2665 THOMPSON DR MARRIOTTSVILLE MD 21104-1602				Principal Residence:		YES
							Deed Reference:		/00562/ 00071
Location & Structure Information									
Premises Address:			2665 THOMPSON DR MARRIOTTSVILLE 21104-0000				Legal Description:		6.05 A 2665 THOMPSON DR
Map:	Grid:	Parcel:	Sub District:	Subdivision:	Section:	Block:	Lot:	Assessment Year:	Plat No:
0016	0014	0178		2002				2019	Plat Ref:
Special Tax Areas:					Town:		NONE		
					Ad Valorem:		104		
					Tax Class:				
Primary Structure Built			Above Grade Living Area		Finished Basement Area		Property Land Area		County Use
1964			1,719 SF				6.0500 AC		
Stories	Basement	Type	Exterior	Full/Half Bath	Garage	Last Major Renovation			
1	YES	STANDARD UNIT	1/2 STONE FRAME	2 full					
Value Information									
			Base Value	Value	Phase-in Assessments				
				As of	As of		As of		
				01/01/2016	07/01/2018		07/01/2019		
Land:			221,300	221,300					
Improvements			185,300	185,300					
Total:			406,600	406,600	406,600				
Preferential Land:			0						
Transfer Information									
Seller:			Date:		Price:				
Type:			Deed1:		Deed2:				
Seller:			Date:		Price:				
Type:			Deed1:		Deed2:				
Seller:			Date:		Price:				
Type:			Deed1:		Deed2:				
Exemption Information									
Partial Exempt Assessments:			Class	07/01/2018		07/01/2019			
County:			000	0.00					
State:			000	0.00					
Municipal:			000	0.00		0.00			
Tax Exempt:			Special Tax Recapture:						
Exempt Class:			NONE						
Homestead Application Information									
Homestead Application Status: Approved 07/25/2012									
Homeowners' Tax Credit Application Information									
Homeowners' Tax Credit Application Status: No Application						Date:			

1. This screen allows you to search the Real Property database and display property records.
2. Click [here](#) for a glossary of terms.
3. Deleted accounts can only be selected by Property Account Identifier.
4. The following pages are for information purpose only. The data is not to be used for legal reports or documents. While we have confidence in the accuracy of these records, the Department makes no warranties, expressed or implied, regarding the information.

5/11/01
10:00

APPLICATION

PERCOLATION TESTING

A 515010A

Subdivision

P _____

HOWARD COUNTY HEALTH DEPARTMENT

BUREAU OF ENVIRONMENTAL HEALTH

3525-H ELLICOTT MILLS DRIVE/ELLICOTT CITY, MARYLAND 21043
TELEPHONE: 313-2640

DISTRICT _____

DATE _____

TO: THE COUNTY HEALTH OFFICER
ELLICOTT CITY, MARYLAND

I HEREBY APPLY FOR THE NECESSARY TEST PRIOR TO APPLICATION FOR PERMIT TO CONSTRUCT (OR RECONSTRUCT) A SEWAGE DISPOSAL SYSTEM.

PROPERTY OWNER Daniel & Barbara Cichetti

ADDRESS 2665 Thompson Dr. Marriottsville PHONE 410 442 1730

AGENT OR PROSPECTIVE BUYER Angela Cichetti Deppe

ADDRESS 6922 Hollenberry Rd Sykesville 21784 PHONE 410 795 8547

PROPERTY LOCATION:

SUBDIVISION Bramble Hollow LOT NO. 1

ROAD AND DESCRIPTION Thompson Dr.

TAX MAP 16 PARCEL # 178

SIZE OF LOT 3 acres TYPE BLDG. SFD
(SINGLE FAMILY DWELLING OR COMMERCIAL)

THE SYSTEM INSTALLED UNDER THIS APPLICATION IS ACCEPTABLE ONLY UNTIL PUBLIC FACILITIES BECOME AVAILABLE. I FULLY UNDERSTAND THE FEE CONNECTED WITH THE FILING OF THIS PERC TEST APPLICATION IS NON-REFUNDABLE UNDER ANY CIRCUMSTANCES. I ALSO AGREE TO COMPLY WITH ALL M.O.S.H.A. REQUIREMENTS IN TESTING THIS LOT.

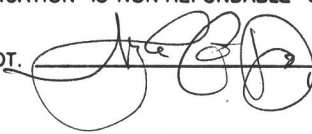

(SIGNATURE OF APPLICANT)

APPROVED BY _____ FOR _____ DATE _____

DISAPPROVED BY _____ FOR _____ DATE _____

HOLD PENDING FURTHER TESTS _____

REASONS FOR REJECTION OR HOLDING _____

PERCOLATION TEST PLAT/PRELIMINARY PLAT - TITLE OR I.D. # _____ DATE _____

SITE DEVELOPMENT PLAN/FINAL PLAT - TITLE OR I.D. # _____ DATE _____

THIS IS NOT A PERMIT

COUNTY #

SOIL PROFILE

0' (1) (2)
brn
cl salm
2 tan brn
sand
30-60%
Fraggs
1 8 1/2
9 1/2

(3)

tan brn
sac l/m

1 3 1/2
4

brn tan
gray
salm
10-15%
Fraggs
14 1/2

(5)

tan brn
orge
sac l/m

3

tan salm
20% Fraggs

5

tan salm
10-15%
Fraggs
13 1/2

NO STREAM
W/IN 100'EX.
HOUSEWELL
IN PIT

SLED

SOMEWHAT
FLAT

Proposed

Lot
Line

DUE TO DROUGHT CONDITIONS,
APPROVABLE HOLES MUST HAVE 8
FEET FROM OBSERVED
GROUNDWATER TO BOTTOM OF
PROPOSED SEPTIC SYSTEM

INDICATE NORTH - NAME ADJOINING ROADWAY AS BASE LINE.

THOMPSON DR

SOIL PROFILE

0' (1) (8)
tan
orge
sac l/m
2 1/2 3
tan
brn
sand
10% fraggs
12 15
WATER

orge c/l/m
tan salm
18-15%
Fraggs
13 1/2

3-4

1
13 1/2

DATE	TEST NO.	DEPTH	PRE-WET		TEST - 1" DROP		TIME	
			START	STOP	START	STOP		
6/18/01	1 V	8 1/2	FAIL - INSUFF DEPTH TO Rx					
	2 V	9 1/2	-	5 M TO (1)	FAIL			
	3 S/V	4 1/2 / 14 1/2	11:45	11:48	11:48	11:54	6	
	4 V	13 1/2	OK see profile					
	5 S/V	4 / 13 1/2	12:10 / 12:11:30	12:12:30	12:12:30	12:11 / 12:14:00	FAST 1 1/2 ±	
	6/6A V	9	FAIL Rx					
	7 S	4	11:58	12:00	12:00	12:02	2	
	7 V	15	H ₂ O @ 12 (4 HRS)					
	8 S	3 1/2	12:22	12:25	12:25	12:28	3	
	8 V	14	H ₂ O @ 13 (4 HRS)					

REMARKS

TYPE OF SOIL

TESTED BY

M. Ripkin

ALSO PRESENT

Owners, Ryack crew

TRENCH DESIGN DATA: AVERAGE PERCOLATION TIME

TRENCH WIDTH

INLET DEPTH

MAXIMUM BOTTOM DEPTH

SQ. FT./BEDROOM

APPLICATION

PERCOLATION TESTING

A 515070B

P _____

HOWARD COUNTY HEALTH DEPARTMENT
BUREAU OF ENVIRONMENTAL HEALTH

3525-H ELLICOTT MILLS DRIVE/ELLICOTT CITY, MARYLAND 21043
TELEPHONE: 313-2640

DISTRICT _____

DATE _____

TO: THE COUNTY HEALTH OFFICER
ELLICOTT CITY, MARYLAND

I HEREBY APPLY FOR THE NECESSARY TEST PRIOR TO APPLICATION FOR PERMIT TO CONSTRUCT (OR RECONSTRUCT) A SEWAGE DISPOSAL SYSTEM.

PROPERTY OWNER Daniel & Barbara Cichetti

ADDRESS 2665 Thompson Dr - Marriottville MD PHONE (410) 442-1730

AGENT OR PROSPECTIVE BUYER _____

ADDRESS _____ PHONE _____

PROPERTY LOCATION:

SUBDIVISION Bramble Hollow LOT NO. Ex ~~340~~ SFD (2)

ROAD AND DESCRIPTION Thompson Drive

TAX MAP 16 PARCEL # 178

SIZE OF LOT 3 acres TYPE BLDG. SFD
(SINGLE FAMILY DWELLING OR COMMERCIAL)

THE SYSTEM INSTALLED UNDER THIS APPLICATION IS ACCEPTABLE ONLY UNTIL PUBLIC FACILITIES BECOME AVAILABLE. I FULLY UNDERSTAND THE FEE CONNECTED WITH THE FILING OF THIS PERC TEST APPLICATION IS NON-REFUNDABLE UNDER ANY CIRCUMSTANCES. I ALSO AGREE TO COMPLY WITH ALL M.O.S.H.A. REQUIREMENTS IN TESTING THIS LOT.

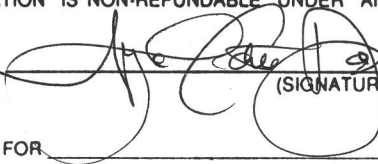

(SIGNATURE OF APPLICANT)

APPROVED BY _____ FOR _____ DATE _____

DISAPPROVED BY _____ FOR _____ DATE _____

HOLD PENDING FURTHER TESTS _____

REASONS FOR REJECTION OR HOLDING _____

PERCOLATION TEST PLAT/PRELIMINARY PLAT - TITLE OR I.D. # _____ DATE _____

SITE DEVELOPMENT PLAN/FINAL PLAT - TITLE OR I.D. # _____ DATE _____

THIS IS NOT A PERMIT

HD-216 (3/92)

COUNTY #

SOIL PROFILE
0'

3
brn sa
cl lm
tan gray
sand
10-20%
Frags
14
H₂O

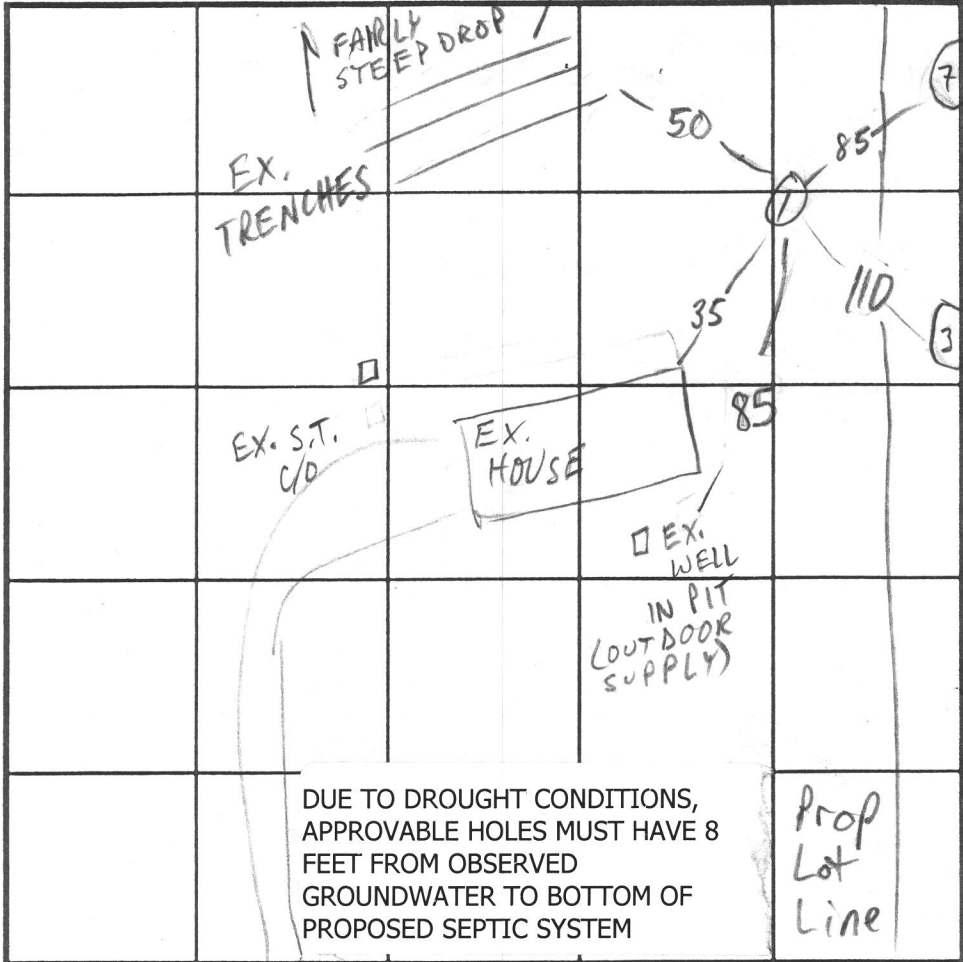

SOIL PROFILE
0'

Blank box for soil profile notes.

INDICATE NORTH - NAME ADJOINING ROADWAY AS BASE LINE.

DATE	TEST NO.	DEPTH	PRE-WET		TEST - 1" DROP		TIME
			START	STOP	START	STOP	
6/18/01	1 r	14					EST 2
			H ₂ O @ 14' after 30 min OK				

REMARKS _____

TYPE OF SOIL _____

TESTED BY M. Rifkin ALSO PRESENT Owners, Fyock crew

TRENCH DESIGN DATA: AVERAGE PERCOLATION TIME _____ TRENCH WIDTH _____

INLET DEPTH _____ MAXIMUM BOTTOM DEPTH _____ SQ. FT./BEDROOM _____

6/22/72
Ready - no mud for
6/4/72 partial
011

PERMIT

SEWAGE DISPOSAL SYSTEM

MARYLAND STATE DEPARTMENT OF HEALTH

HOWARD COUNTY

P 16927

A 06074

ELLICOTT CITY

DISTRICT 3

DATE 4/17/72

INDEXED

Jack Pyock IS PERMITTED TO INSTALL ☒ ALTER

ADDRESS Ton Oaks Road, Glenelg, Md. PHONE 286-2939

A SEWAGE DISPOSAL SYSTEM LOCATED AT

SUBDIVISION Harvey Thompson ROAD Thompson Drive LOT 10

PROPERTY OWNER Daniel J. Cichetti

ADDRESS 2665 Thompson Drive, Ellicott City, Md.

SPECIFICATIONS - 3 bedrooms

DRAIN FIELD DEPTH FEET, BOTTOM AREA SQ. FT.

SEEPAGE PITS ABSORBENT SIDE-WALL AREA SQ. FT.

SEPTIC TANK CAPACITY 1,000 GALLONS

FOR GARBAGE COVER INCREASE DISPOSAL AREA 22% & TANK CAPACITY 50%
Bottom Area with bottom at 5 1/2 ft.

OTHER Tile field - 1,200 sq. ft. for 3 bedrooms installed no deeper than 4 ft.
if 2 ft. wide 18 ft. wide if 3 ft. wide 24 ft. wide
Place the tile field 100 ft. to 150 ft. behind the house with the tile field
100 ft. or more from the well. The new septic tank in the back yard must be
over 50 ft. from the well. All sewer lines within a 50 ft. radius of the well
must be cast iron. The inlet to the septic tank must be no deeper than 1 ft.
below ground. 2

NOTE: ALL PIPE FROM SEPTIC TANK TO DRY WELL MUST BE CAST IRON.

PERMIT VOID AFTER THREE YEARS.

NOTE: INSTALL STAND PIPE ON SEPTIC TANK.

PLANS APPROVED BY R. Hodges & P. Wine DATE 3/9/72

FILL SEPTIC TANK AND DISTRIBUTION BOX WITH WATER BEFORE CALLING FOR AN INSPECTION. COVER NO WORK UNTIL INSPECTED AND APPROVED.

NEITHER THE HOWARD COUNTY COMMISSIONERS NOR THE HEALTH DEPARTMENT IS RESPONSIBLE FOR THE SUCCESSFUL OPERATION OF ANY SYSTEM.

4/26/72 - Size of System & depth changed
P.W. said OK to cut size of tile field
R.P.H. 7 06074

INDICATE NORTH. - NAME ADJOINING ROADWAY AS BASE LINE

PERMIT CARD

SEPTIC TANK, LEVEL OK

CLEANOUTS 121

DISTRIBUTION BOX. LEVEL OK

TILE FIELD, DEPTH 3 1/2 FT. TRENCH WIDTH 3 FT.

GRAVEL DEPTH 2 1/2 FT. TOTAL LENGTH 180 FT.

NUMBER OF TRENCHES _____ TOTAL BOTTOM AREA 540

SEEPAGE PITS. INSIDE DIAMETER _____ FT. DEPTH BELOW INLET _____ FT

ABSORBENT AREA 3604 SQ. FT. polyethylene

6-8-72
REMARKS covered last trench, in place of to cover part of 2nd trench but
to leave 5 ft. of dirt, middle & end to measure to top of gravel
trench 6 ft. deep. F.

6/9/72. OK to copy ~~long~~ and discuss

6/23/72 - Case 1 on house sewer installation on Mary Hous
To be put on a relation when relation provided & H
DATE SYSTEM APPROVED 6/23/72 INSPECTOR [Signature]

APPLICATION

SEWAGE DISPOSAL TESTING

MARYLAND STATE DEPARTMENT OF HEALTH

HOWARD COUNTY

ELLICOTT CITY

DISTRICT

DATE

027 A 06074
A 06074

P

11-14-62

TO: THE COUNTY HEALTH OFFICER
ELLICOTT CITY, MARYLAND

I, HEREBY, APPLY FOR THE NECESSARY TESTS IN ORDER TO CONSTRUCT (OR RECONSTRUCT) A SEWAGE DISPOSAL SYSTEM.

PROPERTY OWNER

Elmer Evans

ADDRESS

Thompson Drive Marietta

PHONE

AT 6-88474

PROPERTY LOCATION:

SUBDIVISION

Harvey Thompson

LOT NO.

10

ROAD AND DESCRIPTION

Thompson Drive - lot is 1/2 mile south of Rt 40 on left.

OCCUPANT

PHONE

PERSON TO CONSTRUCT SYSTEM

ADDRESS

PHONE

SIZE OF LOT

6 acres plus

TYPE BLDG.

2

IF NOT SINGLE RESIDENCE DESCRIBE

NUMBER OF BEDROOMS
will be 3 BR when all the
is installed.

SIGNATURE OF APPLICANT

Elmer E. Evans

APPROVED BY

FOR

(KIND OF SYSTEM)

DATE

REJECTED BY

FOR

(KIND OF SYSTEM)

DATE

HOLD PENDING FURTHER TESTS

11-16-62

DATE

REASONS FOR REJECTION OR HOLDING

11-16-62 Per Plan. To fit on a lot of home - but no standard fill.
3-8-72 Hold for review 3-9-72 RHDPA did a report & the fill must be installed in accordance with the system installed before any fill permit is approved

THIS IS NOT A PERMIT

A 06074

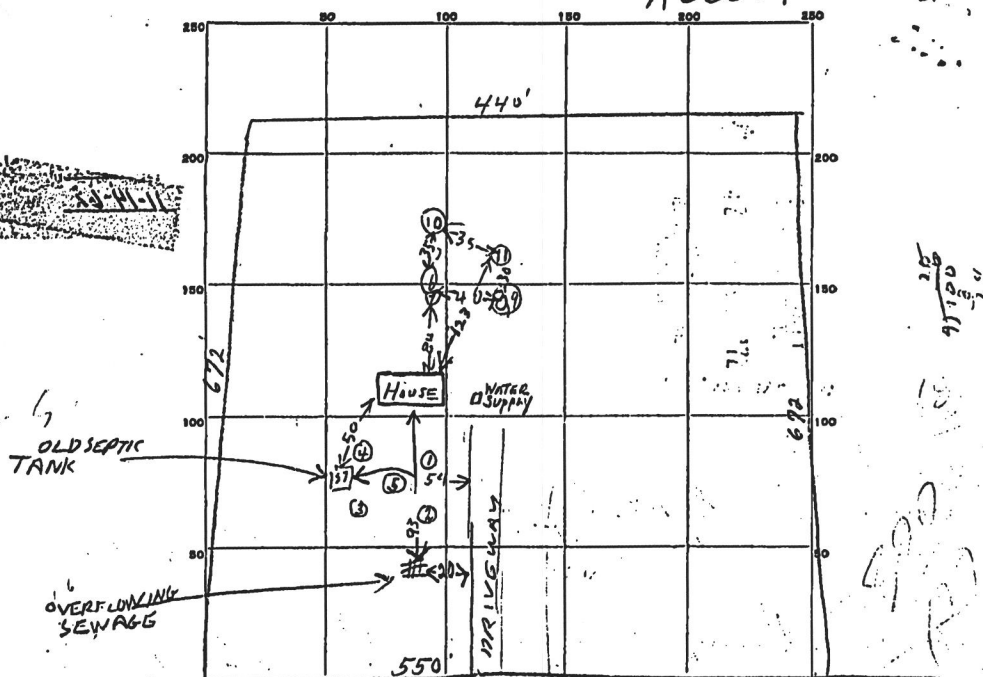

INDICATE NORTH - NAME ADJOINING ROADWAY AS BASE LINE.

THOMPSON DRIVE

DATE	TEST NO.	DEPTH	PRE-WET		TEST - 1" DROP		TIME
			START	STOP	START	STOP	
11-16-62	1	3	9:51	9:56	9:56	10:08	12 min.
	2	3	10:09	overtime 1 hr.		7/8"	
	3	3	10:01	overtime 52 min.		3/4"	
	4	3'	Water in bottom of hole				spring results
	5	8'	2 FT of water in bottom				
11-16-62	6	4	942	945	945	948	3
	7	9	ALL SANDY BUT UNDERGROUND WATER AT 9 FT				
	8	4	947	950	950	954	4
	9	8'	ALL SAND NO WATER SEEN				
	10	3 1/2	955	958	958	1000	12
	11	4 1/2	1001	1002	1002	1014	2

SOIL AUGER FINDING

TESTED BY J.H.

REMARKS 3/8/72 Hold for Review - Hold test today on level ground
 11-16-62 House level with roller
 ALSO PRESENT Elmer Evans LOT NO. 10

LAYOUT 2/25/09 INSP 4 _____
INSP 2 2/26/09 INSP 5 _____
INSP 3 _____ INSP 6 _____

ISSUE DATE: 2/23/09

PERMIT

P 530315

APPROVAL DATE: 2/26/09

A Repair

TAX ID # 03-282082

ON-SITE SEWAGE DISPOSAL SYSTEM HOWARD COUNTY HEALTH DEPARTMENT BUREAU OF ENVIRONMENTAL HEALTH

Fogles' Septic IS PERMITTED TO INSTALL ☒ ALTER ☐

ADDRESS: 580 Ubrecht Rd. PHONE NUMBER: 410-795-3432

SUBDIVISION: _____ LOT NUMBER: _____

ADDRESS: 2665 Thompson Dr. PROPERTY OWNER: Don Cichetti

SEPTIC TANK CAPACITY (GALLONS): Ex 1000 OUTLET BAFFLE FILTER REQUIRED ☐

PUMP CHAMBER CAPACITY (GALLONS): N/A COMPARTMENTED TANK REQUIRED ☐

NUMBER OF BEDROOMS: 3

SQUARE FEET PER BEDROOM: 0.8

LINEAR FEET OF TRENCH REQUIRED: 94

TRENCHES:	Trench to be <u>3</u> feet wide. Inlet <u>4</u> feet below original grade. Bottom maximum depth <u>7</u> feet below original grade. Effective area begins at <u>4</u> feet below original grade. <u>3</u> feet of stone below distribution pipe.
LOCATION:	
NOTES:	

PLANS APPROVED: (SC) DATE: 2-26-09

NOTE: PERMIT VOID AFTER 2 YEARS

NOTE: CONTRACTOR RESPONSIBLE FOR SCHEDULING A PRE-CONSTRUCTION INSPECTION FOR ALL INSTALLATIONS

NOTE: WATERTIGHT SEPTIC TANKS REQUIRED

NOTE: ALL PARTS OF SEPTIC SYSTEM SHALL BE 100 FEET FROM ANY WATER WELL

NOTE: MANHOLE RISERS REQUIRED ON ALL SEPTIC TANKS AND PUMP CHAMBERS UNLESS SPECIFICALLY AUTHORIZED

NEITHER THE HOWARD COUNTY COUNCIL NOR THE HEALTH DEPARTMENT IS
RESPONSIBLE FOR THE SUCCESSFUL OPERATION OF ANY SYSTEM
PERMITTEE RESPONSIBLE FOR OBTAINING FINAL APPROVAL ON THIS PERMIT
CALL 410-313-2640 FOR INSPECTION OF SEPTIC SYSTEM

Thompson Drive

NOT TO SCALE

Public H₂O

Ea. House.

Pool Area

Bull Run Valve
To Existing System

TRENCH/DRAINFIELD DATA
 WIDTH INLET BOTTOM
 3' 4' 7'
 NUMBER OF TRENCHES 2
 TOTAL LENGTH 100
 ABSORPTION AREA 300' x 50'
 DISTRIBUTION BOX LEVEL Yes
 DISTRIBUTION BOX BAFFLE Yes
 DISTRIBUTION BOX PORT Yes

SEPTIC TANK DATA
 SEPTIC TANK 1 LEVEL ?
 MANUFACTURER ?
 CAPACITY 1000 GAL
 SEAM LOC mid.
 TANK LID DEPTH ~2'
 BAFFLES
 BAFFLE FILTER
 MANHOLE LOC Rear (new)
 6" PORT LOC Front
 WATERTIGHT TEST
 SLOTTED
 PUMP/SEPTIC TANK LEVEL
 MANUFACTURER
 CAPACITY GAL
 SEAM LOC
 TANK LID DEPTH
 BAFFLES
 BAFFLE FILTER
 MANHOLE LOC
 6" PORT LOC
 WATERTIGHT TEST
 SLOTTED

PRE-CONSTRUCTION
 2/25/09 - 30' tall (2)
 47' trenches on
 best contour parallel
 to old trenches. Shot

contour, slope is 12" over 50'. Told contractor to split the difference and keep invert & bottom level. Check rear baffle & install manhole. Contractor asked to install bull run valve. That's OK (50)

INSTALLATION 2/26/09 system installed per start order. Ea. Drainfields 100% constructed. Bull-Run valve installed but will not be used for long time. OK to backfill (150)

FINAL INSPECTOR

Ku

DATE OF APPROVAL

2/26/09

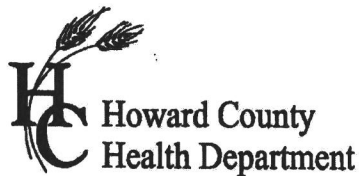

APPLICATION

FOR PERCOLATION TESTING AND SITE EVALUATION

TEST DATE(S) _____ TEST TIME _____

AP 530315

AGENCY REVIEW: _____

DATE 2/23/09

DO NOT WRITE ABOVE THIS LINE

I HEREBY APPLY FOR THE NECESSARY TESTING/EVALUATION PRIOR TO ISSUANCE OF SEWAGE DISPOSAL SYSTEM PERMIT(S) TO:

CHECK AS NEEDED:

- ☐ CONSTRUCT NEW SEPTIC SYSTEM(S)
☐ REPAIR/ADD TO AN EXISTING SEPTIC SYSTEM
☒ REPLACE AN EXISTING SEPTIC SYSTEM

CHECK ONE:

- ☐ CREATE NEW LOT(S)
☐ BUILD ON AN EXISTING LOT IN A SUBDIVISION
☐ BUILD ON AN EXISTING PARCEL OF RECORD

CHECK AS NEEDED:

- ☐ NEW STRUCTURE(S)
☐ ADDITION TO AN EXISTING STRUCTURE
☐ REPLACE AN EXISTING STRUCTURE

IS THE PROPERTY WITHIN 2500' OF ANY RESERVOIR?

- ☐ YES
☒ NO

THE TYPE OF STRUCTURE IS:

- ☒ RESIDENTIAL WITH 4 PROPOSED BEDROOMS IN THE COMPLETED STRUCTURE (NOTE **UNKNOWN** IF APPROPRIATE)
☐ COMMERCIAL (PROVIDE DETAIL OF NUMBERS AND TYPES OF EMPLOYEES/ CUSTOMERS ON ACCOMPANYING PLAN)
☐ INSTITUTIONAL/GOVERNMENT (PROVIDE DETAIL OF NUMBERS AND TYPES OF EMPLOYEES/USERS ON ACCOMPANYING PLAN)

PROPERTY OWNER(S) Dan Cichetti

DAYTIME PHONE 443 386-2026

CELL _____

FAX _____

MAILING ADDRESS 2665 Thompson Dr Marriottsville MD 21104
STREET CITY/TOWN STATE ZIP

APPLICANT Fogle's Septic Clean, Inc / Kurt Cassell

DAYTIME PHONE 410 795-5670

CELL 410 984-5211

FAX 410 795-3432

MAILING ADDRESS 580 Obrecht Rd Sykesville, MD 21784
STREET CITY/TOWN STATE ZIP

APPLICANT'S ROLE: DEVELOPER BUILDER BUYER RELATIVE/FRIEND REALTOR CONSULTANT

PROPERTY LOCATION

SUBDIVISION/PROPERTY NAME _____ LOT NO. _____

PROPERTY ADDRESS Same as above
STREET

TOWN/POST OFFICE _____

TAX MAP PAGE(S) _____ GRID _____ PARCEL(S) _____ PROPOSED LOT SIZE _____

AS APPLICANT, I UNDERSTAND THE FOLLOWING: THE SYSTEM INSTALLED SUBSEQUENT TO THIS APPLICATION IS ACCEPTABLE ONLY UNTIL PUBLIC SEWERAGE IS AVAILABLE. THIS APPLICATION IS COMPLETE WHEN ALL APPLICABLE FEES AND A SUITABLE SITE PLAN HAVE BEEN RECEIVED. I ACCEPT THE RESPONSIBILITY FOR COMPLIANCE WITH ALL M.O.S.H.A. AND "MISS UTILITY" REQUIREMENTS. APPROVAL IS BASED UPON SATISFACTORY REVIEW OF A PERC CERTIFICATION PLAN.

TEST RESULTS WILL BE MAILED TO APPLICANT.

Kurt A. Cassell

SIGNATURE OF APPLICANT

HOWARD COUNTY HEALTH DEPARTMENT, BUREAU OF ENVIRONMENTAL HEALTH, WELL AND SEPTIC PROGRAM
7178 COLUMBIA GATEWAY DRIVE COLUMBIA, MARYLAND 21046 (410) 313-1771 FAX (410) 313-2648
TDD (410) 313-2323 TOLL FREE 1-877-4MD-DHMH

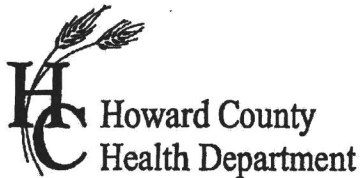

APPLICATION

FOR PERCOLATION TESTING AND SITE EVALUATION

TEST DATE(S) _____ TEST TIME _____ A/P _____
AGENCY REVIEW: _____ DATE _____

DO NOT WRITE ABOVE THIS LINE

I HEREBY APPLY FOR THE NECESSARY TESTING/EVALUATION PRIOR TO ISSUANCE OF SEWAGE DISPOSAL SYSTEM PERMIT(S) TO:

CHECK AS NEEDED:

- ☐ CONSTRUCT NEW SEPTIC SYSTEM(S)
- ☐ REPAIR/ADD TO AN EXISTING SEPTIC SYSTEM
- ☐ REPLACE AN EXISTING SEPTIC SYSTEM

CHECK AS NEEDED:

- ☐ NEW STRUCTURE(S)
- ☐ ADDITION TO AN EXISTING STRUCTURE
- ☐ REPLACE AN EXISTING STRUCTURE

CHECK ONE:

- ☐ CREATE NEW LOT(S)
- ☐ BUILD ON AN EXISTING LOT IN A SUBDIVISION
- ☐ BUILD ON AN EXISTING PARCEL OF RECORD

IS THE PROPERTY WITHIN 2500' OF ANY RESERVOIR?

- ☐ YES
- ☐ NO

THE TYPE OF STRUCTURE IS:

- ☐ RESIDENTIAL WITH _____ PROPOSED BEDROOMS IN THE COMPLETED STRUCTURE (NOTE **UNKNOWN** IF APPROPRIATE)
- ☐ COMMERCIAL (PROVIDE DETAIL OF NUMBERS AND TYPES OF EMPLOYEES/CUSTOMERS ON ACCOMPANYING PLAN)
- ☐ INSTITUTIONAL/GOVERNMENT (PROVIDE DETAIL OF NUMBERS AND TYPES OF EMPLOYEES/USERS ON ACCOMPANYING PLAN)

PROPERTY OWNER(S) Dan Cichetti

DAYTIME PHONE _____ CELL _____ FAX _____

MAILING ADDRESS 2665 Thompson Dr
STREET CITY/TOWN STATE ZIP

APPLICANT _____

DAYTIME PHONE _____ CELL _____ FAX _____

MAILING ADDRESS _____
STREET CITY/TOWN STATE ZIP

APPLICANT'S ROLE: DEVELOPER BUILDER BUYER RELATIVE/FRIEND REALTOR CONSULTANT

PROPERTY LOCATION
SUBDIVISION/PROPERTY NAME _____ LOT NO. _____

PROPERTY ADDRESS _____
STREET TOWN/POST OFFICE

TAX MAP PAGE(S) _____ GRID _____ PARCEL(S) _____ PROPOSED LOT SIZE _____

AS APPLICANT, I UNDERSTAND THE FOLLOWING: THE SYSTEM INSTALLED SUBSEQUENT TO THIS APPLICATION IS ACCEPTABLE ONLY UNTIL PUBLIC SEWERAGE IS AVAILABLE. THIS APPLICATION IS COMPLETE WHEN ALL APPLICABLE FEES AND A SUITABLE SITE PLAN HAVE BEEN RECEIVED. I ACCEPT THE RESPONSIBILITY FOR COMPLIANCE WITH ALL M.O.S.H.A. AND MISS UTILITY" REQUIREMENTS. APPROVAL IS BASED UPON SATISFACTORY REVIEW OF A PERC CERTIFICATION PLAN.

TEST RESULTS WILL BE MAILED TO APPLICANT.

SIGNATURE OF APPLICANT _____

HOWARD COUNTY HEALTH DEPARTMENT, BUREAU OF ENVIRONMENTAL HEALTH, WELL AND SEPTIC PROGRAM
7178 COLUMBIA GATEWAY DRIVE COLUMBIA, MARYLAND 21046 (410) 313-1771 FAX (410) 313-2648
TDD (410) 313-2323 TOLL FREE 1-877-4MD-DHMH

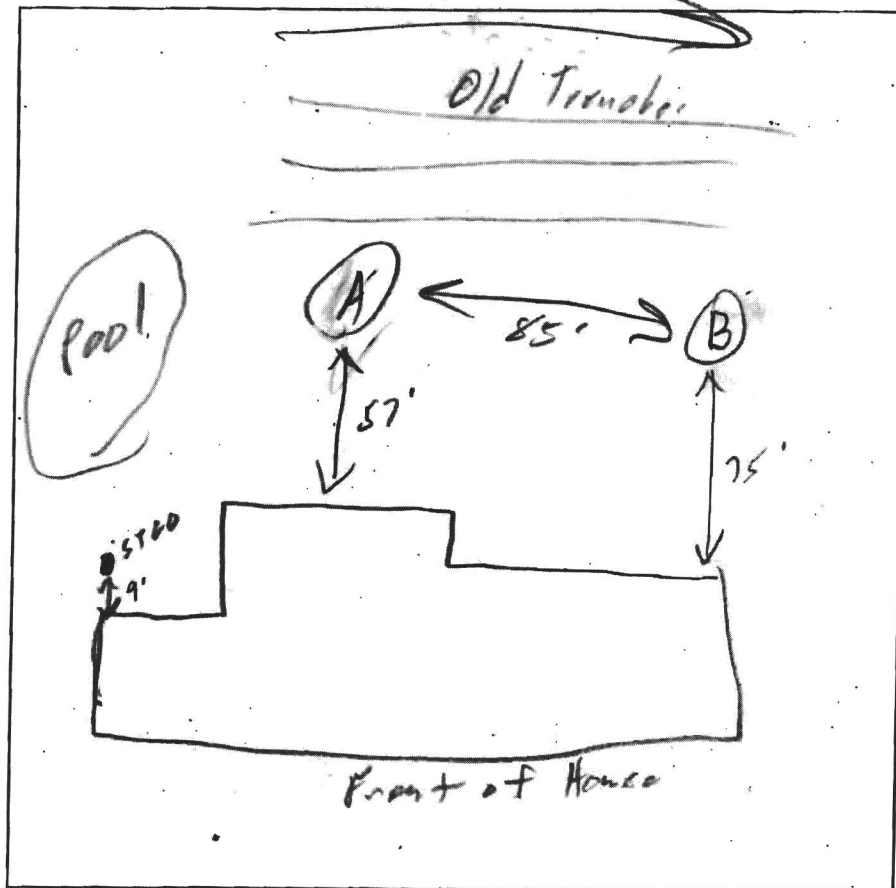

①
Orange Brown
Clay loam
3'
Orange Tan
S. Loam Brown
M. 64
↓
15'

②
Orange Tan
clay loam
3'
Tan
S. Loam
↓
12'

DATE	TEST #	DEPTH	START	BREAK 1" DROP	STOP 2" DROP	TIME OF 2ND INCH	P/F/H
2/25/09	A	3.5' / 13'	10:58	11:06	11:23	15	P
	B	✓ / 12		No Water coming in After 30 min			

REMARKS:

SANITARIAN SD BACKHOE Take OTHERS NoneTEST HOLES USED IN SDA 2 AVG. PERC TIME 15 SQ. FT/BRTRENCH WIDTH 3 INLET DEPTH 4 MAX. BOT DEPTH 7 EFFECTIVE SAW 3

94' of Trench.

*6/23/72
Ready - Road - 400
C. J. Fyock
permitted
011*

PERMIT

SEWAGE DISPOSAL SYSTEM

MARYLAND STATE DEPARTMENT OF HEALTH

HOWARD COUNTY

03-282082

INDEXED

P 16927

A 06074

ELLICOTT CITY

DISTRICT 3

DATE 4/17/72

Jack Fyock

IS PERMITTED TO INSTALL ☒ ALTER

ADDRESS Tan Oaks Road, Glenelig, Md. PHONE 286-2939

A SEWAGE DISPOSAL SYSTEM LOCATED AT _____

SUBDIVISION Harvey Thompson ROAD Thompson Drive LOT 10

PROPERTY OWNER Daniel J. Cichetti

ADDRESS 2665 Thompson Drive, Ellicott City, Md.

SPECIFICATIONS - 3 bedrooms

DRAIN FIELD _____ DEPTH _____ FEET, BOTTOM AREA _____ SQ. FT.

6/22/72
Ready - no mud for
6/22/72
Partial
G.H.

PERMIT

SEWAGE DISPOSAL SYSTEM

MARYLAND STATE DEPARTMENT OF HEALTH

HOWARD COUNTY

P 18927

A 06074

ELLICOTT CITY

DISTRICT 3

DATE 4/17/72

INDEXED

Jack Pyock

IS PERMITTED TO INSTALL ☒ ALTER

ADDRESS Ten Oaks Road, Glenside, Md.

PHONE 286-2929

A SEWAGE DISPOSAL SYSTEM LOCATED AT

SUBDIVISION Harvey Thompson

ROAD Thompson Drive

LOT 10

PROPERTY OWNER Daniel J. Cichetti

ADDRESS 2685 Thompson Drive, Ellicott City, Md.

SPECIFICATIONS - 3 bedrooms

DRAIN FIELD DEPTH FEET, BOTTOM AREA SQ. FT.

SEEPAGE PITS ABSORBENT SIDE-WALL AREA SQ. FT.

SEPTIC TANK CAPACITY 1,000 GALLONS

FOR GARBAGE GRINDER, INCREASE DISPOSAL AREA 22% & TANK CAPACITY 30%
Bottom Area with bottom at 5 1/2 ft.

OTHER Tile field - 1,200 sq. ft. for 3 bedrooms installed no deeper than 4 ft.
if 2 ft. wide 15 ft. gravel if 3 ft. wide 2 ft. gravel
Place the tile field 100 ft. to 150 ft. behind the house with the tile field
100 ft. or more from the well. The new septic tank in the back yard must be
over 50 ft. from the well. All sewer lines within a 50 ft. radius of the well
must be cast iron. The inlet to the septic tank must be no deeper than 1 ft.
below ground.

NOTE: ALL PIPE FROM SEPTIC TANK TO DRY WELL MUST BE CAST IRON.

PERMIT VOID AFTER THREE YEARS.

NOTE: INSTALL STAND PIPE ON SEPTIC TANK.

PLANS APPROVED BY R. Hodges & P. Wine DATE 3/9/72

FILL SEPTIC TANK AND DISTRIBUTION BOX WITH WATER BEFORE CALLING FOR AN INSPECTION. COVER NO WORK
UNTIL INSPECTED AND APPROVED.

4/26/72 - Size of System & depth changed
NEITHER THE HOWARD COUNTY COMMISSIONERS NOR THE HEALTH DEPARTMENT IS RESPONSIBLE FOR THE
SUCCESSFUL OPERATION OF ANY SYSTEM.

P.W. said OK to cut size of tile field

A 06074



HOWARD COUNTY HEALTH DEPARTMENT

Diane L. Matuszak, M.D., M.P.H., County Health Officer

July 17, 2001

Daniel and Barbara Cichetti
2665 Thompson Drive
Marriottsville, MD 21104

RE: PERCOLATION TEST RESULTS
Bramble Hollow, 2-Lot Subdivision
A 515010-A
Thompson Drive

Dear Mr. & Mrs. Cichetti

Percolation testing conducted June 18, 2001 on the referenced property indicated limited satisfactory soil conditions. The primary limiting factors were shallow depths to bedrock and shallow depths to water table. Copies of the test results are enclosed.

Further review is contingent upon submission by a registered engineer/surveyor of a percolation certification plan showing the following:

- 1) actual locations and elevations of all excavated test holes
- 2) a suitable house site
- 3) notation of the intended use of public water
- 4) all existing wells and septic systems on the property
- 5) locations of any other relevant features such as streams, swales, or existing structures
- 6) a note must be included certifying that all existing wells and septs within 100 feet of property boundaries have been shown
- 7) a note indicating that depicted topography reflects field-matched information

Proper abandonment (filling and sealing) of the existing well will likely be necessary to provide adequate sewage reserve capacity. Such abandonment should be scheduled to occur prior to submittal of the record plat, and such schedule should be noted on the plan.

The percolation certification plat should be submitted within 60 days to allow field verification if necessary. If you have any questions regarding this matter, please contact me at the above address or by calling (410) 313-2640.

Very truly yours,

Mark E. Rifkin, R.S.
Water and Sewerage Program

MR

Enclosures

cc: Angela Cichetti Deppe
File



HOWARD COUNTY HEALTH DEPARTMENT

Diane L. Matuszak, M.D., M.P.H., County Health Officer

April 11, 2001

Mr. and Mrs. Daniel Cichetti
2665 Thompson Drive
Marriottsville, Maryland 21104

RE: Percolation Test Date

Application: A515010
Proposal: Subdivision
Property ID: Bramble Hollow, Lots 1 and 2
Thompson Drive
Tax Map: 16 Parcel #178

Dear Mr. and Mrs. Cichetti:

"Wet season" percolation testing has been tentatively scheduled for the above referenced property for **Friday, May 11, 2001 at 10:00 a.m.**

Please be advised that while percolation test dates have been assigned for spring wet season, 2001, due to severely depressed groundwater levels, you may wish to postpone percolation testing until a bonafide spring wet season – see attached for further explanation. Upon receipt of this letter, please contact this office at (410) 313-2640 to accept or decline the assigned percolation test date(s).

You shall be responsible for having a contractor on site to excavate the percolation test holes **(to a minimum depth of 14 feet)** as proposed and as required by the Health Department representative at the time of testing.

In the event of uncertain weather (i.e., precipitation or extremes of temperature), please contact this office prior to 9:00 a.m. on the test date to determine whether or not percolation testing can be performed on that date. If it is not feasible to perform the test, a new test date shall be assigned.

Percolation test results may be expected by mail two to three weeks after the completion of the percolation testing. Thank you in advance for your cooperation in this matter.

Sincerely,

Donna K. Clark, R.S.
Water and Sewerage Program

DKC

cc: file

Bureau of Environmental Health

3525-H Ellicott Mills Drive • Ellicott City, Maryland 21043-4544

Water and Sewerage, Permits (410) 313-1771 Community Environmental Health Program (410) 313-1773
(410) 313-2640 TDD(410) 313-2323 TOLL FREE - 1-877-4MD-DHMH

orig 06074
APPLICATION

SEWAGE DISPOSAL TESTING

MARYLAND STATE DEPARTMENT OF HEALTH
HOWARD COUNTY

ELLICOTT CITY

DISTRICT

DATE

TO: THE COUNTY HEALTH OFFICER
ELLICOTT CITY, MARYLAND

I, HEREBY, APPLY FOR THE NECESSARY TESTS IN ORDER TO CONSTRUCT (OR RECONSTRUCT) A SEWAGE DISPOSAL SYSTEM.

PROPERTY OWNER

ADDRESS

PROPERTY LOCATION

SUBDIVISION

LOT NO.

ROAD AND DESCRIPTION

OCCUPANT

PHONE

PERSON TO CONSTRUCT SYSTEM

ADDRESS

PHONE

SIZE OF LOT

TYPE BLDG.

IF NOT SINGLE RESIDENCE DESCRIBE

SIGNATURE OF APPLICANT

APPROVED BY

FOR

KIND OF SYSTEM

DATE

REJECTED BY

FOR

KIND OF SYSTEM

DATE

HOLD PENDING FURTHER TESTS

DATE

REASONS FOR REJECTION OR HOLDING

3-8-72 Hold for review 3-9-72 RH SPA shall a report to the fact and be installed in full
with the system installed before any file permit is approved

THIS IS NOT A PERMIT

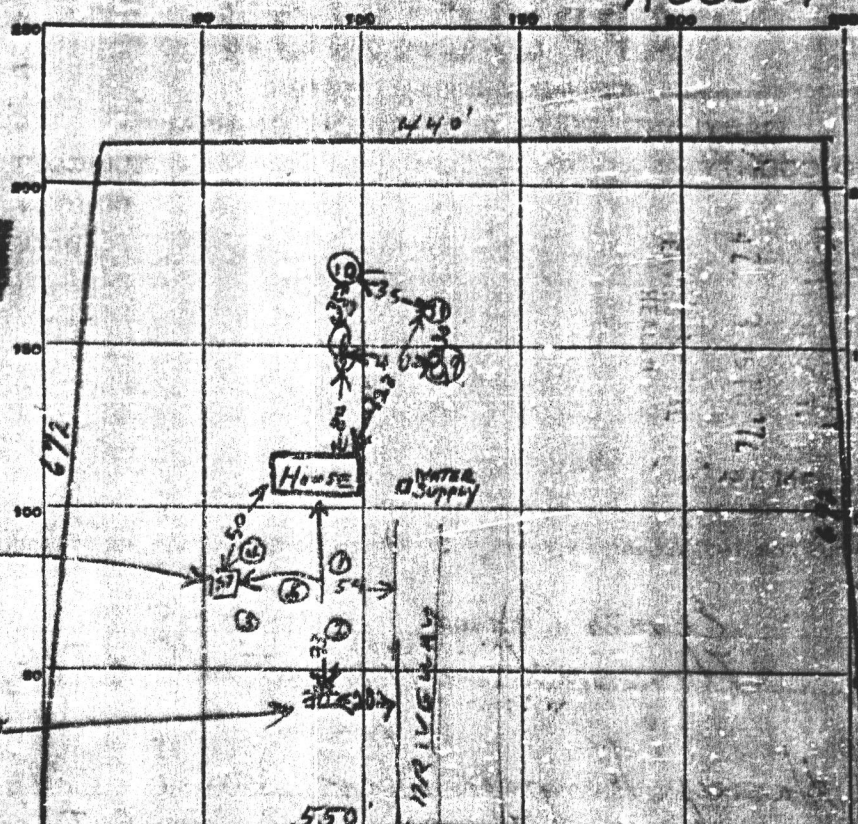

INDICATE NORTH. - NAME ADJOINING ROADWAY AS BASE LINE.

THOMPSON DRIVE

DATE	TEST NO.	DEPTH	PRE-WET		TEST - 1" DIAM		TIME	
			START	STOP	START	STOP		
1/6-62	1	3	9:51	9:56	9:56	10:09	12	
	2	3	10:09	overturn 1 hr 3/4"				
	3	3	10:01	overturn 52 min 1/4"				
	4	3'	Water in bottom. Test hole					
	5	8'	2 FT of water in bottom					
3/2/72	6	4	942	945	945	948	3	
	7	9	ALL SANDY BUT UNDERGROUND WATER AT 9 FT					
	8	4	947	950	950	954	4	
	9	8 1/2	ALL SANDY NO WATER SEEN					
	10	3 1/2	955	958	958	1000	12	
	11	4 1/2	1001	1002	1002	1004	2	

SOIL AUGER FINDING

SOIL AUGER FINDING.

TESTED BY

REMARKS 3/9/72 Hold for Review 1st tested today on 1st ground
11-16-62 Hand level with hole
 ALSO PRESENT Elmer Evans LOT NO. 10

properties have access to public water - existing house is hooked to public water
 "Branch follow"
 Scale 1 in = 50 ft
 Property owner: Daniel & Barbara Cichetti

no well within 200'
 proposed subdivision
 property line

no well within 200'

