

JUL 06 2020

PERMIT NUMBER: B 20002166

DATE ACCEPTED:

LICENSES & PERMITS DIVISION

RESIDENTIAL BUILDING PERMIT APPLICATION

HOWARD COUNTY DEPARTMENT OF INSPECTIONS, LICENSES, AND PERMITS

3430 COURT HOUSE DRIVE, ELLICOTT CITY, MD 21043 - PHONE: (410) 313-2455 OPTION #4

www.howardcountymd.gov

BUILDING SITE ADDRESS REQUIRED

Street Address: 12541 WESTLAND CT		Unit:
City: FULTON	State: MD	Zip Code: 20759
Subdivision/Village/Complex Name: WESTLAND FARM EST PH 2		SDP/WP/BA #:
Lot: 8	Tax Map: 45	Parcel: 28
Grading Permit #:		

DESCRIPTION OF WORK REQUIRED

Existing Use: RESIDENTIAL	Proposed Use: RESIDENTIAL	Estimated Cost: \$20,000.00
Trade Work to Be Completed (Separate Permits Required): <input type="checkbox"/> Mechanical (HVACR) <input checked="" type="checkbox"/> Electrical <input type="checkbox"/> Plumbing <input type="checkbox"/> None		
SFD/ INSTALL 16'X36' INGROUND SWIMMING CONCRETE POOL (3'-6' DEPTH) W/ AUTOCOVER, 7'X7' SPA WITHIN POOL (CONST 200 LF FENCE TO CODE IF REQUIRED)		

PROPERTY OWNER INFORMATION REQUIRED

Owner(s) Name(s) (As it appears on tax records): OMUDHOME OGBRU		Primary Residence: <input checked="" type="checkbox"/> Yes <input type="checkbox"/> No
Owner's Street Address: 12541 WESTLAND CT		
City: FULTON	State: MD	Zip Code: 20756
Phone:	Email:	

APPLICANT NAME REQUIRED - INDIVIDUAL WHO SIGNS THIS APPLICATION

Business Name: SCHWALLENBERG'S PERMIT SERVICES INC		Contact Name: JAMES SCHWALLENBERG
Street Address: 1910 TOPANGO PL		
City: CROFTON	State: MD	Zip Code: 21114
Phone: (410) 980-9868	Email: DIANE.JAMESPERMITS@GMAIL.COM	

CONTRACTOR INFORMATION REQUIRED

Business Name: ANTHONY & SYLVAN POOLS		
Licensee's Name: ANTHONY & SYLVAN CORP		License #: 129792
Street Address: 8260 PRESTON COURT, STE 1		
City: JESSUP	State: MD	Zip Code: 20794
Phone: (877) 729-7946	Email:	

ARCHITECT/ENGINEER INFORMATION INDIVIDUAL WHO SIGNED PLANS, IF APPLICABLE

Business Name:	Name:
Street Address:	
City:	State:
Phone:	Email:

BUILDING CHARACTERISTICS REQUIRED

Primary Structure: <input checked="" type="checkbox"/> SF Dwelling <input type="checkbox"/> SF Townhouse <input type="checkbox"/> SF Duplex <input type="checkbox"/> Mobile Home <input type="checkbox"/> Multi-Family Dwelling (MF*)		Condo: <input type="checkbox"/> Yes <input checked="" type="checkbox"/> No
Utilities: <input checked="" type="checkbox"/> Electric <input type="checkbox"/> Gas	Water Supply: <input type="checkbox"/> Public <input checked="" type="checkbox"/> Private (Well)	Sewage Disposal: <input type="checkbox"/> Public <input checked="" type="checkbox"/> Private (Septic)
Heating System: <input checked="" type="checkbox"/> Electric <input type="checkbox"/> Natural Gas <input type="checkbox"/> Propane <input type="checkbox"/> Other:		Roadside Tree Project: <input checked="" type="checkbox"/> No <input type="checkbox"/> Yes: #
Sprinkler System: <input type="checkbox"/> NFPA 13 <input type="checkbox"/> NFPA 13R <input type="checkbox"/> NFPA 13D <input type="checkbox"/> None		Fire Alarm System: <input type="checkbox"/> Yes <input type="checkbox"/> No <input type="checkbox"/> Voice Evac

ADDITIONAL RESIDENTIAL INFORMATION (PLEASE SELECT/COMPLETE ALL THAT APPLY)

Model Name & Options:					
# of Bedrooms (SF):	# of efficiency units (MF*):	# of 1 BR (MF*):	# of 2 BR (MF*):	# of 3 BR (MF*):	
# Rooms:	# Full Baths:	# Half Baths:	# Fireplaces:		
Garage/Carport Info: <input type="checkbox"/> Attached Garage <input type="checkbox"/> Detached Garage <input type="checkbox"/> Integral Garage <input type="checkbox"/> Carport <input type="checkbox"/> None					
Basement/Foundation Info: <input type="checkbox"/> Slab on Grade <input type="checkbox"/> Post & Pier <input type="checkbox"/> Unfinished Basement <input type="checkbox"/> Finished Basement: <input type="checkbox"/> Full or <input type="checkbox"/> Partial					
1st Fl Width:	1st Fl Depth:	2nd Fl Width:	2nd Fl Depth:	Bsmt Width:	Bsmt Depth:
Energy Method: <input type="checkbox"/> Prescriptive <input type="checkbox"/> Performance <input type="checkbox"/> UA Alternative <input type="checkbox"/> ERI		Gross Area:	sq ft	Occupiable Area:	sq ft

AGREEMENT/ DISCALIMER REQUIRED

THE UNDERSIGNED HEREBY CERTIFIES AND AGREES AS FOLLOWS: (1) THAT HE/SHE IS AUTHORIZED TO MAKE THIS APPLICATION; (2) THAT THE INFORMATION IS CORRECT; (3) THAT HE/SHE WILL COMPLY WITH ALL REGULATIONS OF HOWARD COUNTY WHICH ARE APPLICABLE THERETO; (4) THAT HE/SHE WILL PERFORM NO WORK ON THE ABOVE REFERENCED PROPERTY NOT SPECIFICALLY DESCRIBED IN THIS APPLICATION; (5) THAT HE/SHE GRANTS COUNTY OFFICIALS THE RIGHT TO ENTER ONTO THIS PROPERTY FOR THE PURPOSE OF INSPECTING THE WORK PERMITTED AND POSTING NOTICES.

APPLICANT'S ORIGINAL SIGNATURE

DATE SIGNED

FOR OFFICE USE ONLY

CHECKS PAYABLE TO: DIRECTOR OF FINANCE OF HOWARD COUNTY

AGENCIES REQUIRED/APPROVALS:

<input checked="" type="checkbox"/> PR	<input checked="" type="checkbox"/> DPZ	<input checked="" type="checkbox"/> DED	<input checked="" type="checkbox"/> Health	<input type="checkbox"/> SHA	<input type="checkbox"/> CID
--	---	---	--	------------------------------	------------------------------

SUBMITTAL FEES:	PAYMENT:	ACCEPTED BY: MAIL
-----------------	----------	--------------------------

Omudhome + Annette Ogbru
 818-324-2662
 12541 Westland Ct.
 Fulton 20759
 Westland Farm Est PH 2
 Lot 8

Pool: 16' X 36' 576 sq ft
 Depth: 3'-6"
 Gallons: 20,000
 Spa (within rectangle) 7' X 7'
 Fence: If required 200'
 of pool code fence
 * AUTO POOL COVER

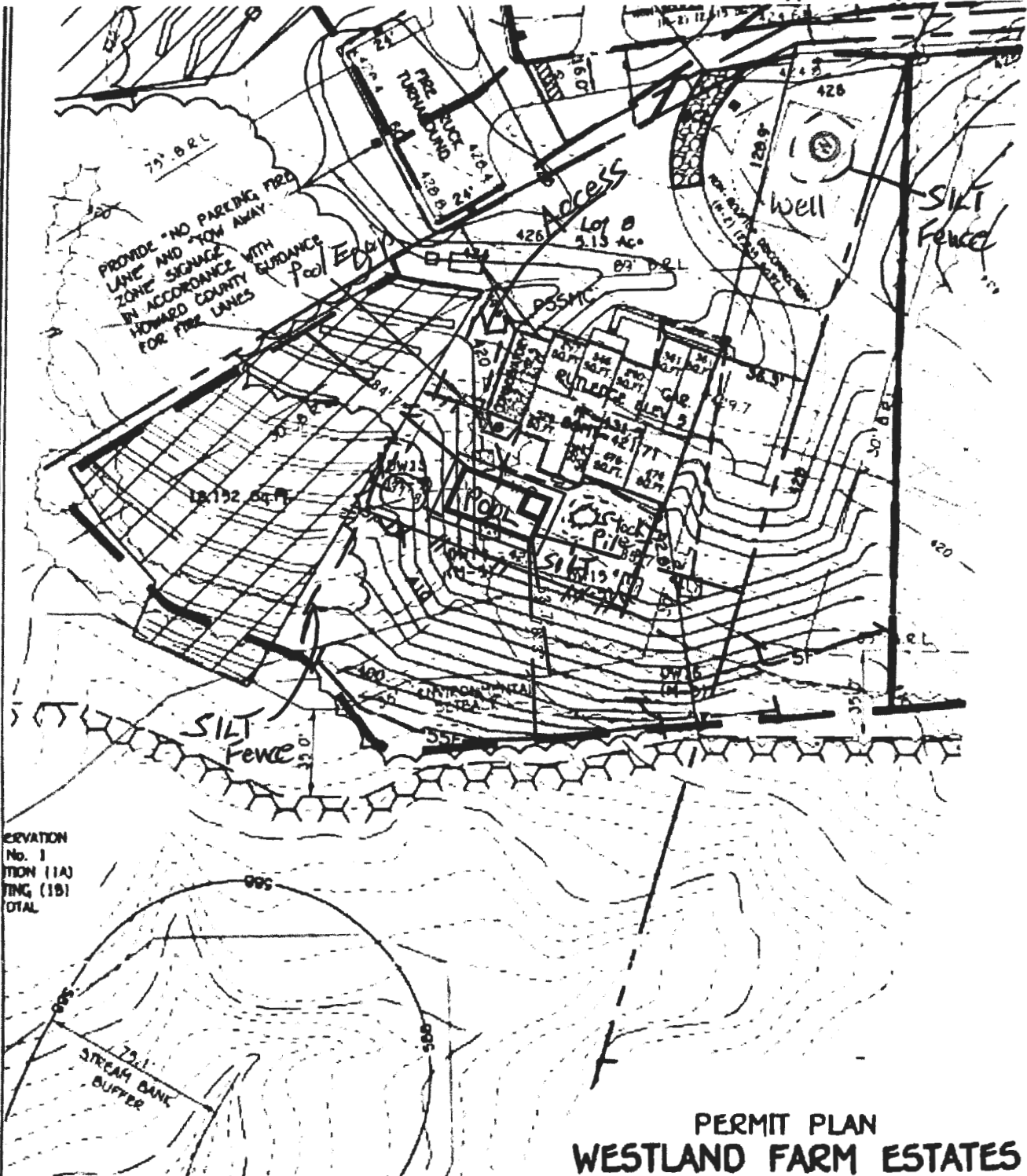

ELEVATION
 No. 1
 TION (1A)
 TING (1B)
 TOTAL

FISHER, COLLINS & CARTER, INC.
 CIVIL ENGINEERING CONSULTANTS & LAND SURVEYORS

CENTENNIAL SQUARE OFFICE PARK - 13272 BALTIMORE NATIONAL PARK
 ELICOTT CITY, MARYLAND 21042
 410.311.881 - 2004

PERMIT PLAN
 WESTLAND FARM ESTATES
 LOT 8
 12541 WESTLAND COURT

TAX MAP 045 PARCEL: 28
 ZONED: RR-DDO
 THIRD ELECTION DISTRICT HOWARD COUNTY, MARYLAND - 11